

teas,leuck
4/1/2005
c:\projects\74059d\03904po.dgn
PS 1

FAS RTE.	SECTION	COUNTY	TOTAL SHEETS	SHEET NO.
8736	(110) RS-4	JEFFERSON		9
FED. ROAD DIST. NO. 7	ILLINOIS	FED. AID PROJECT NO.		
CONTRACT NO. 74059				

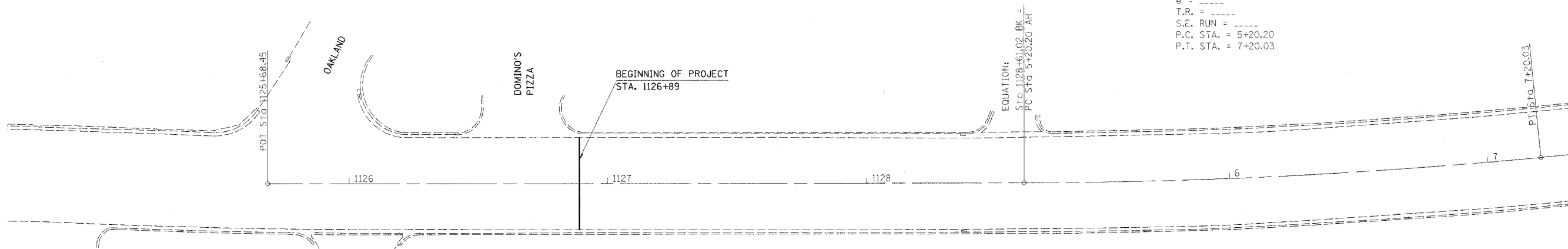
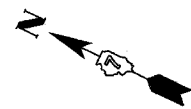

EXIST. CURVE 6+21
 PI STA. = 6+20.19
 Δ = 5° 35' 28" (LT)
 D = 2° 47' 53"
 R = 2,047.76'
 T = 99.99'
 L = 199.83'
 E = 2.44'
 e = -----
 T.R. = -----
 S.E. RUN = -----
 P.C. STA. = 5+20.20
 P.T. STA. = 7+20.03

EQUATION:
 STA. 1128+61.02 BK =
 PC STA. 5+20.20 AH

REVISIONS	
NAME	DATE

ILLINOIS DEPARTMENT OF TRANSPORTATION
PLAN SHEET
STA 1125 + 68.45 TO 7 + 00
 SCALE: VERT. _____
 DATE: _____ HORIZ. _____
 DRAWN BY _____
 CHECKED BY _____