

FAP ROUTE	SECTION	COUNTY	TOTAL SHEETS	SHEET NO.
692	12-1BR-1	MADISON	65	10
STA. 1436+50.00 TO STA. 1445+50.00				
CONTRACT NO.: 76386				

PLAN	REVISIONS	DATE
NO.	NO.	
BY	BY	
CHECKED	CHECKED	
DATE	DATE	

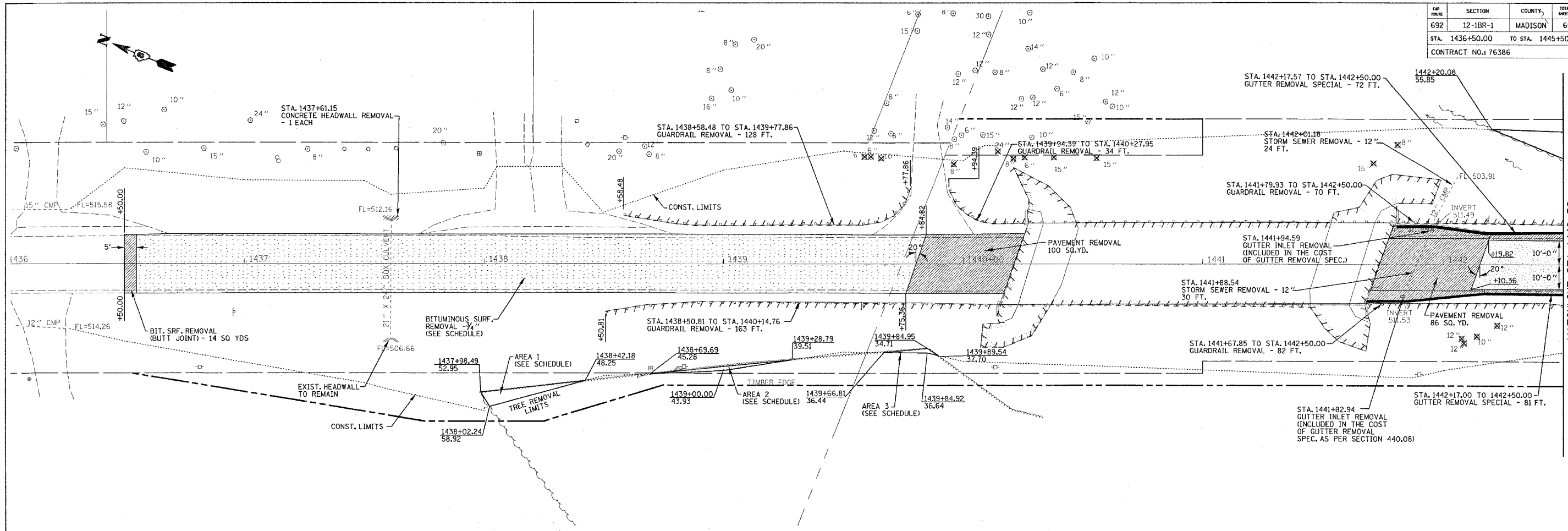

PROFILE	REVISIONS	DATE
NO.	NO.	
BY	BY	
CHECKED	CHECKED	
DATE	DATE	

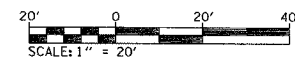
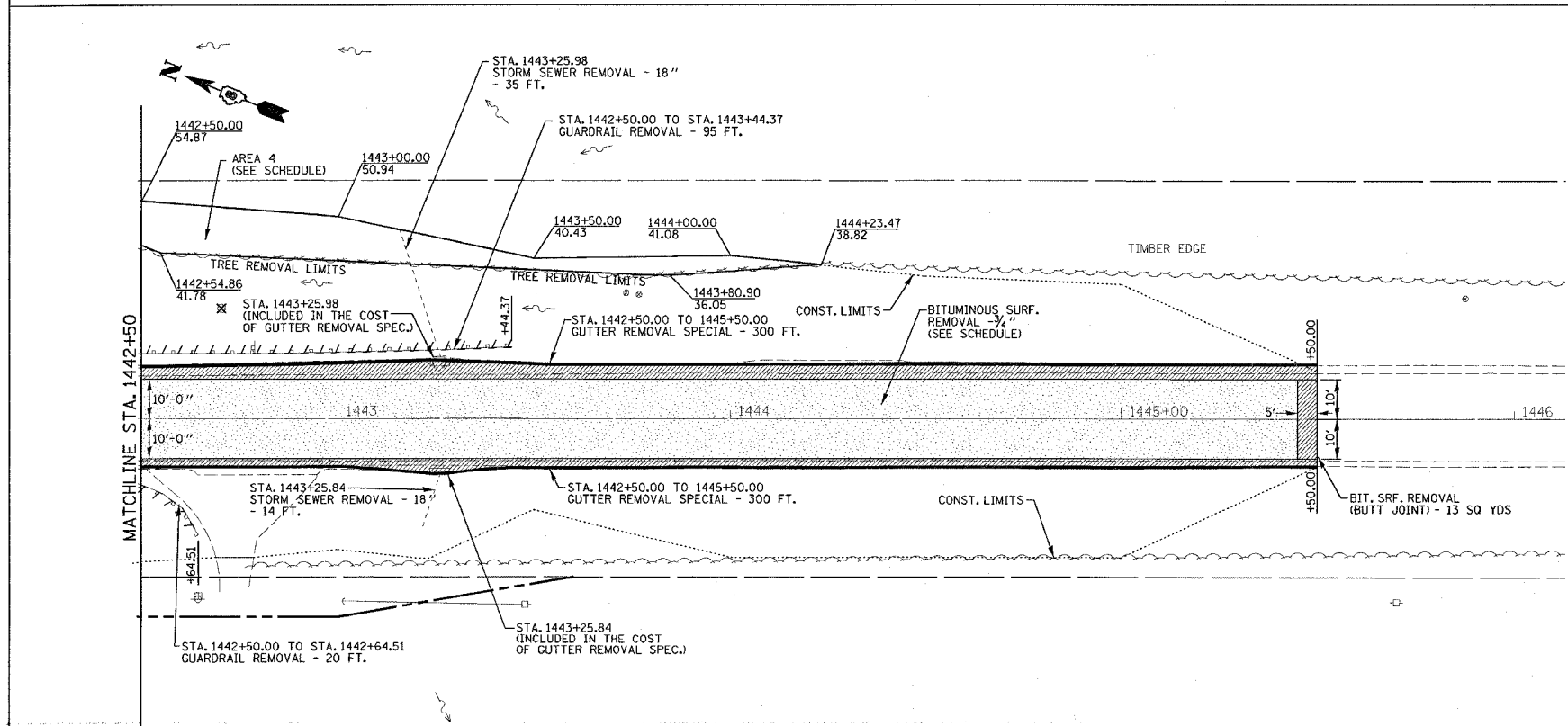

REVISIONS	
NAME	DATE

ILLINOIS DEPARTMENT OF TRANSPORTATION

**REMOVAL PLAN**

FAP 692  
SECTION 12-1BR-1  
MADISON COUNTY

DRAWN BY:

5/3/2005 Tuesday May 03, 2005 @ 8:05:42 AM C:\pwork\692\12-1BR-1\12-1BR-1.dwg L:\14-63