

FAP NO.	SECTION	COUNTY	TOTAL SHEETS	SHEET NO.
692	12-1BR-1	MADISON	65	18
STA. 1436+50.00		TO STA. 1445+50.00		
CONTRACT NO.: 76386				

PLAN	DESIGNED	DATE
	CHECKED	BY
NOTE BOOK NO.	ALIGNED	
	CHECKED	
NO.	PAID FILE NAME	

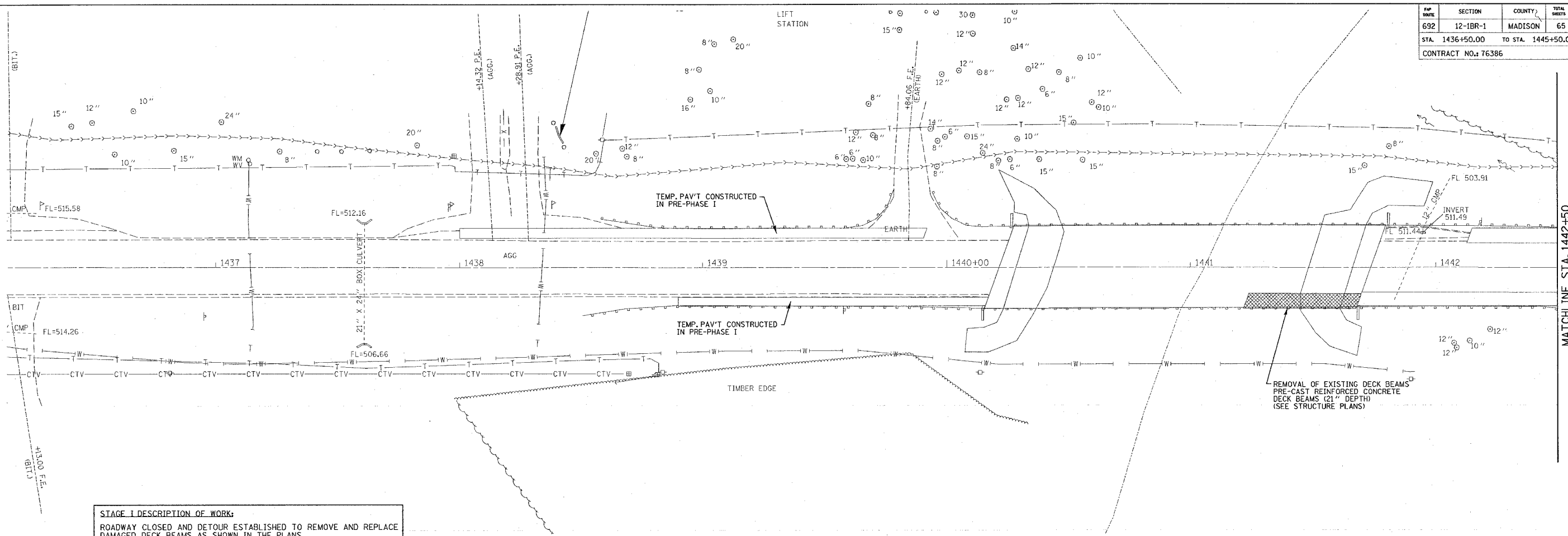

STAGE I DESCRIPTION OF WORK:
ROADWAY CLOSED AND DETOUR ESTABLISHED TO REMOVE AND REPLACE DAMAGED DECK BEAMS AS SHOWN IN THE PLANS.

PROFILE	DESIGNED	DATE
	CHECKED	BY
NOTE BOOK NO.	GRADES	
	CHECKED	
NO.	STRUCTURE NOTATION	
	ORD	

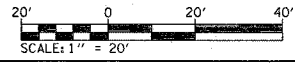
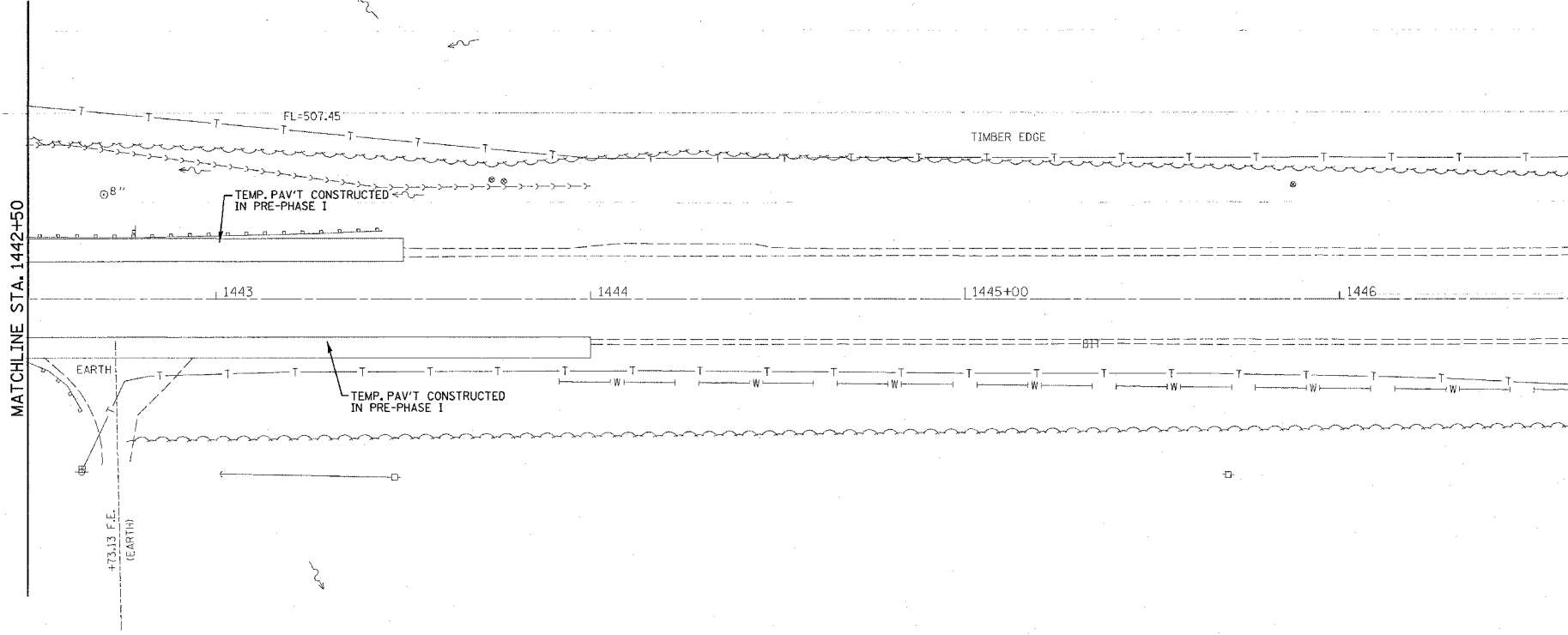

REVISIONS	
NAME	DATE

ILLINOIS DEPARTMENT OF TRANSPORTATION
STAGE CONSTRUCTION
STAGE 1
FAP 692
SECTION 12-1BR-1
MADISON COUNTY

DRAWN BY: