

FAP NO.	SECTION	COUNTY	TOTAL SHEETS	SHEET NO.
692	12-1BR-1	MADISON	65	20
STA. 1436+50.00		TO STA. 1445+50.00		
CONTRACT NO.: 76386				

DATE	
BY	
DESIGNED	
CHECKED	
IN CHARGE	
DATE	
BY	
DESIGNED	
CHECKED	
IN CHARGE	

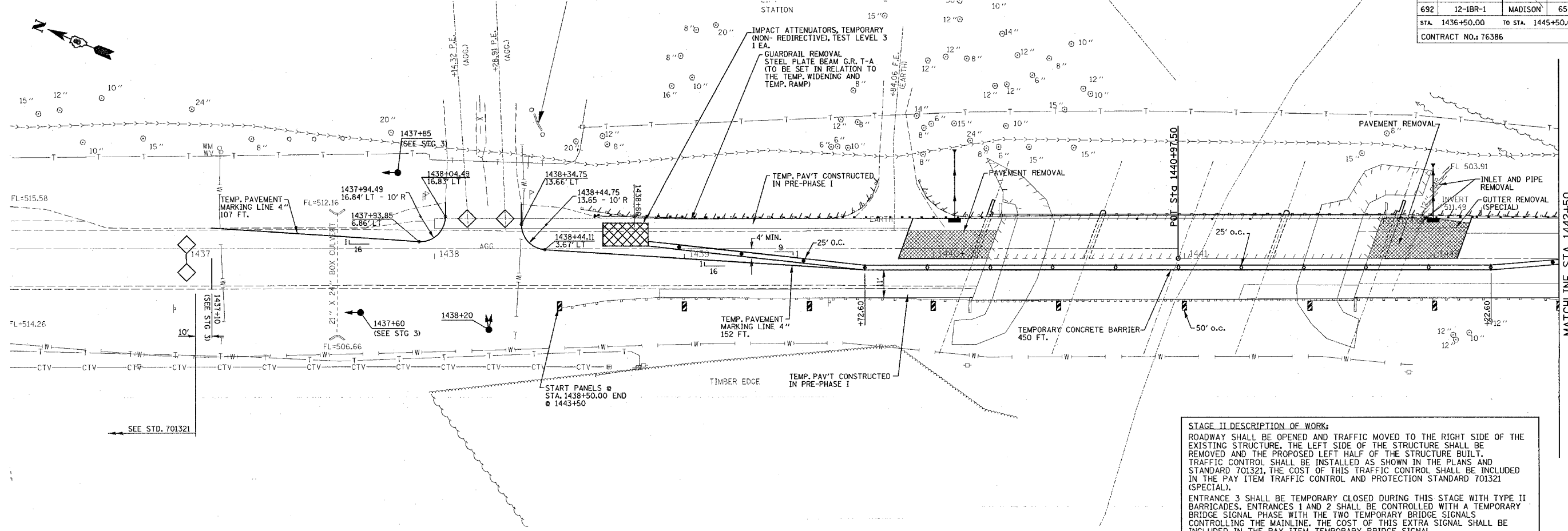

**STAGE II DESCRIPTION OF WORK:**  
ROADWAY SHALL BE OPENED AND TRAFFIC MOVED TO THE RIGHT SIDE OF THE EXISTING STRUCTURE. THE LEFT SIDE OF THE STRUCTURE SHALL BE REMOVED AND THE PROPOSED LEFT HALF OF THE STRUCTURE BUILT. TRAFFIC CONTROL SHALL BE INSTALLED AS SHOWN IN THE PLANS AND STANDARD 701321. THE COST OF THIS TRAFFIC CONTROL SHALL BE INCLUDED IN THE PAY ITEM TRAFFIC CONTROL AND PROTECTION STANDARD 701321 (SPECIAL).  
ENTRANCE 3 SHALL BE TEMPORARY CLOSED DURING THIS STAGE WITH TYPE II BARRICADES. ENTRANCES 1 AND 2 SHALL BE CONTROLLED WITH A TEMPORARY BRIDGE SIGNAL PHASE WITH THE TWO TEMPORARY BRIDGE SIGNALS CONTROLLING THE MAINLINE. THE COST OF THIS EXTRA SIGNAL SHALL BE INCLUDED IN THE PAY ITEM TEMPORARY BRIDGE SIGNAL.

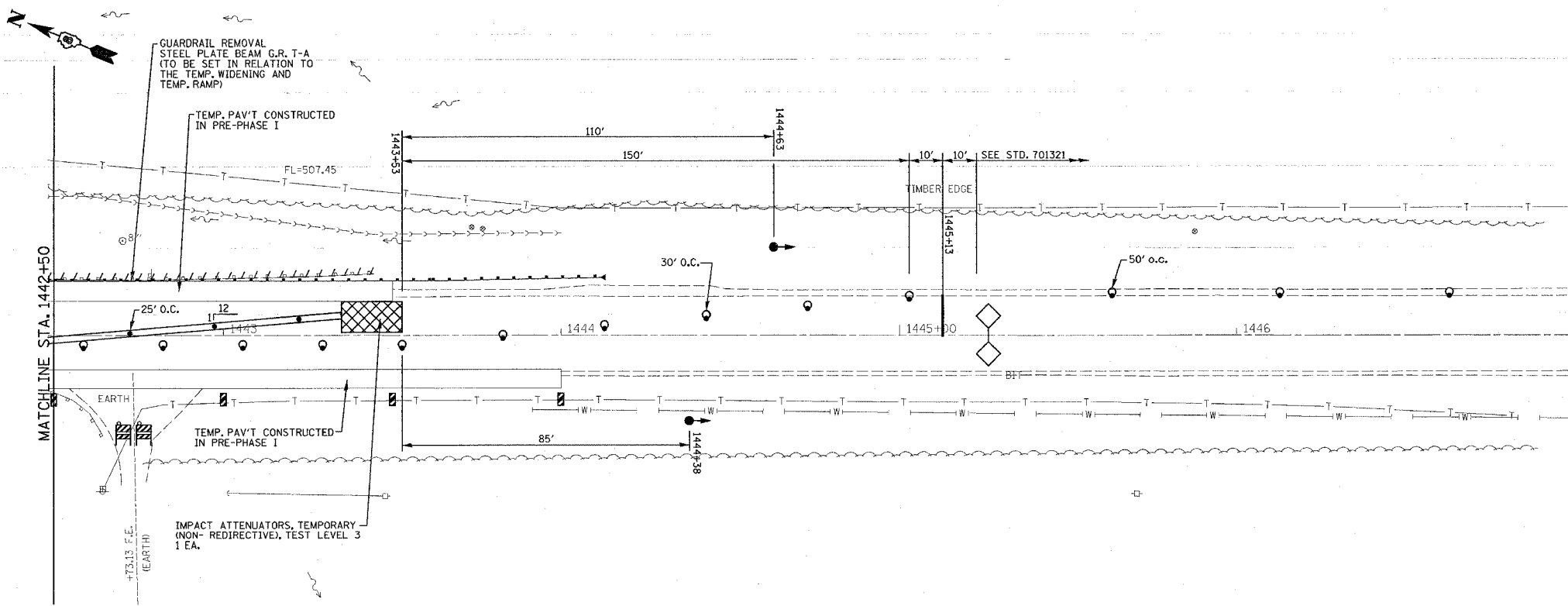

**LEGEND**

- ↑ SIGN
- DRUM W/ STEADY BURNING LIGHT
- TRAFFIC SIGNAL
- ◇ INDUCTOR LOOP DETECTOR
- ▣ DOUBLE VERTICAL PANEL
- ◊ TYPE C BIDIRECTIONAL REFLECTOR
- ▨ IMPACT ATTENUATOR
- STEADY BURNING LIGHTS AND DOUBLE VERTICAL PANELS

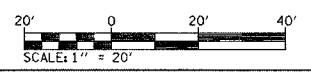

REVISIONS	
NAME	DATE

ILLINOIS DEPARTMENT OF TRANSPORTATION  
**STAGE CONSTRUCTION**  
**STAGE 2**  
FAP 692  
SECTION 12-1BR-1  
MADISON COUNTY

DRAWN BY:  
PLOT DATE: Monday March 14, 2005 @ 1:43:12 PM  
**STAGE CONSTRUCTION - FAP 692 (IL 160)**