

F.A.P. ROUTE NO.	SECTION	COUNTY	TOTAL SHEETS	SHEET NO.
02-00022-00-BT		COOK	26	7
STA. 29+29.90	TO STA.	33+95.28		
FED. ROAD DIST. NO.	ILLINOIS	FED AID PROJECT		
C-91-106-02		CMM-8003 (187)		

SCALE: 1" = 20'

CURVE NO.	4
RADIUS	453.34'
TANGENT LENGTH	108.93'
ARC LENGTH	213.80'
CHORD LENGTH	211.82'
DELTA	27°01'16"
BEARING	N12°38'19"E
P.C. STA.	31+85.47
P.T. STA.	33+12.44
P.T. STA.	33+99.27

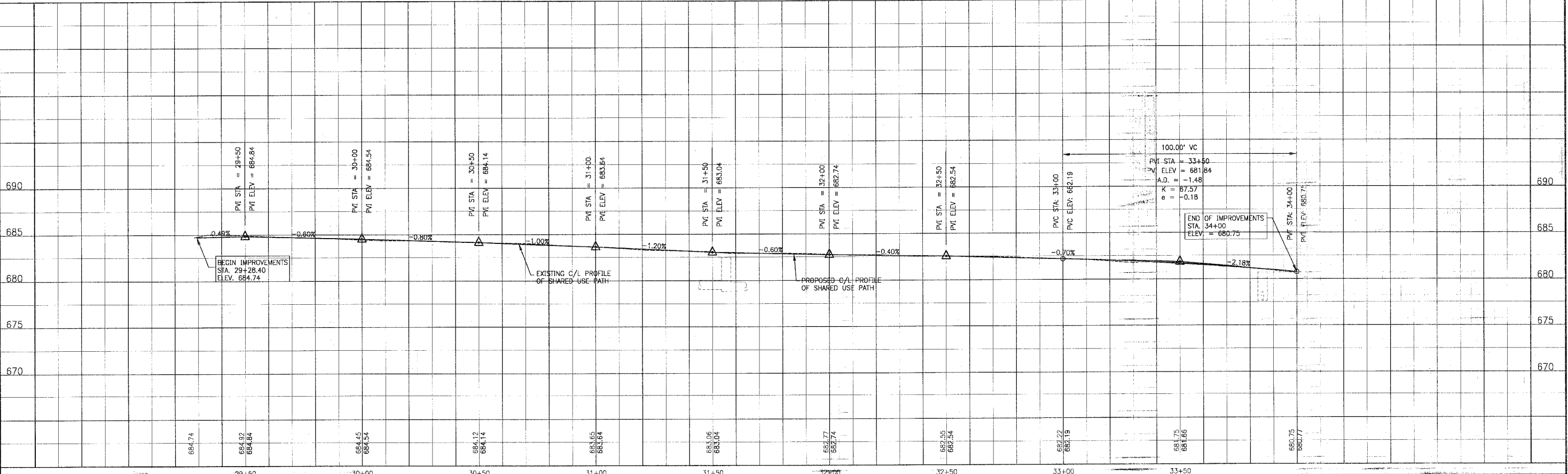
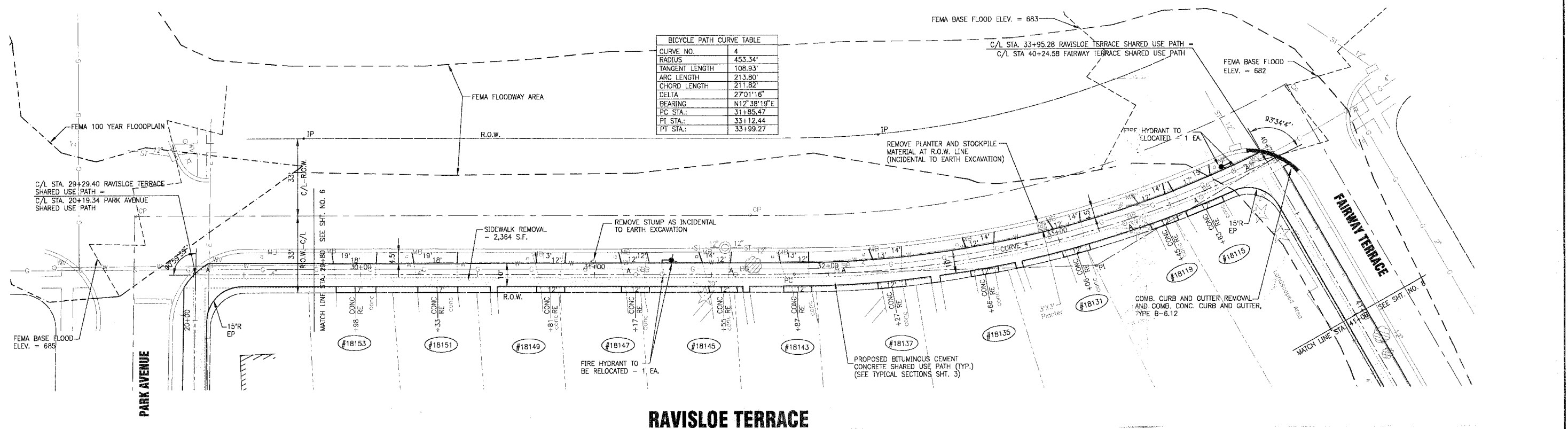

REV. NO.	DATE	DESCRIPTION
1	1/27/04	PER IDOT REVIEW

CONSULTANTS	REV. NO.	DATE	DESCRIPTION
	1	1/27/04	PER IDOT REVIEW

BAXTER & WOODMAN
Consulting Engineers

Crystal Lake, Illinois 815.459.1280
Burlington, Wisconsin 262.763.7834
DeKalb, Illinois 815.787.3111
Grayslake, Illinois 847.787.3111
Mokena, Illinois 708.478.2090

CITY OF COUNTRY CLUB HILLS
AMPHITHEATER SHARED USE PATH

RAVISLOE TERRACE
STA. 29+29.40 TO STA. 33+95.28
PLAN AND PROFILE

DESIGNED BY: SCALE VERT: 1"=5'
HORIZ: 1"=20'
PROJECT NO. 030103
SHEET NO. 7 OF 26

* REFER TO EQUIPMENT MANUFACTURER'S SHOP DRAWINGS