

F.A.P. ROUTE NO.	SECTION	COUNTY	TOTAL SHEETS	SHEET NO.
-	02-00022-00-BT	COOK	26	25
STA. 67+23.22	TO STA. 75+00		FED AID PROJECT	
FED. ROAD DIST. NO.	ILLINOIS	CMM-8003 (187)		
C-91-106-02	83742			

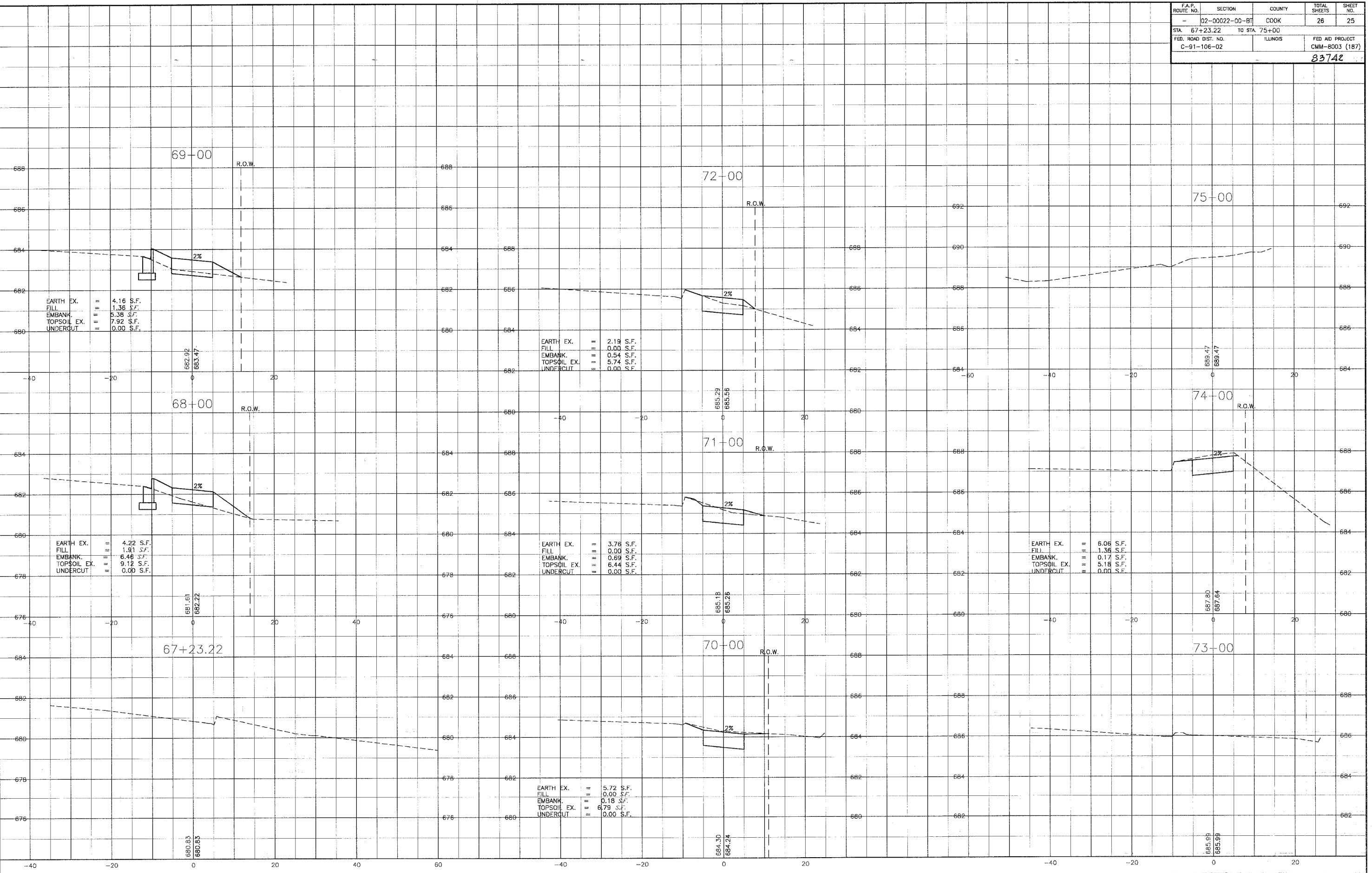

CONSULTANT: BAXTER & WOODMAN, INC.
 STATE OF ILLINOIS - PROFESSIONAL ENGINEERING
 LICENSE NO. 081-001111 - EXPIRES 12/31/2025

CONSULTANTS	REV. NO.	DATE	DESCRIPTION
	1	1-27-04	PER IDOT REVIEW

DRAWING FILE: 30103-xx.dwg
 PLOTTED BY: NJP 1 27 04 19:45

BAXTER & WOODMAN
 Consulting Engineers

Baxter & Woodman
 Crystal Lake, Illinois 815.459.1260
 Burlington, Wisconsin 262.763.7834
 DeKalb, Illinois 815.787.3111
 Graystone, Illinois 847.787.3111
 Mokena, Illinois 708.478.2090

CITY OF COUNTRY CLUB HILLS
AMPHITHEATER SHARED USE PATH

CROSS SECTIONS
PULASKI (CRAWFORD) AVENUE
STA. 67+23.22 TO STA. 75+00

DESIGNED BY: NJP
 DRAWN BY: LKB
 CHECKED BY: LDH
 DATE: 10-14-03

SCALE VERT: 1"=2'
 HORIZ: 1"=10'
 PROJECT NO: 030103
 SHEET NO: 25 OF 26