

F.A.P. COUNTY SECTION	COUNTY	TOTALS
ROUTE 199-00243-00-PV	KANE	SHTS.
336 CONTRACT NO.		268
LIGHTING PLAN		
F.H.W.A. REG.5 ILLINOIS PROJECT F-0336		

MATCH LINE STA. 353+50 SHEET NO. 145

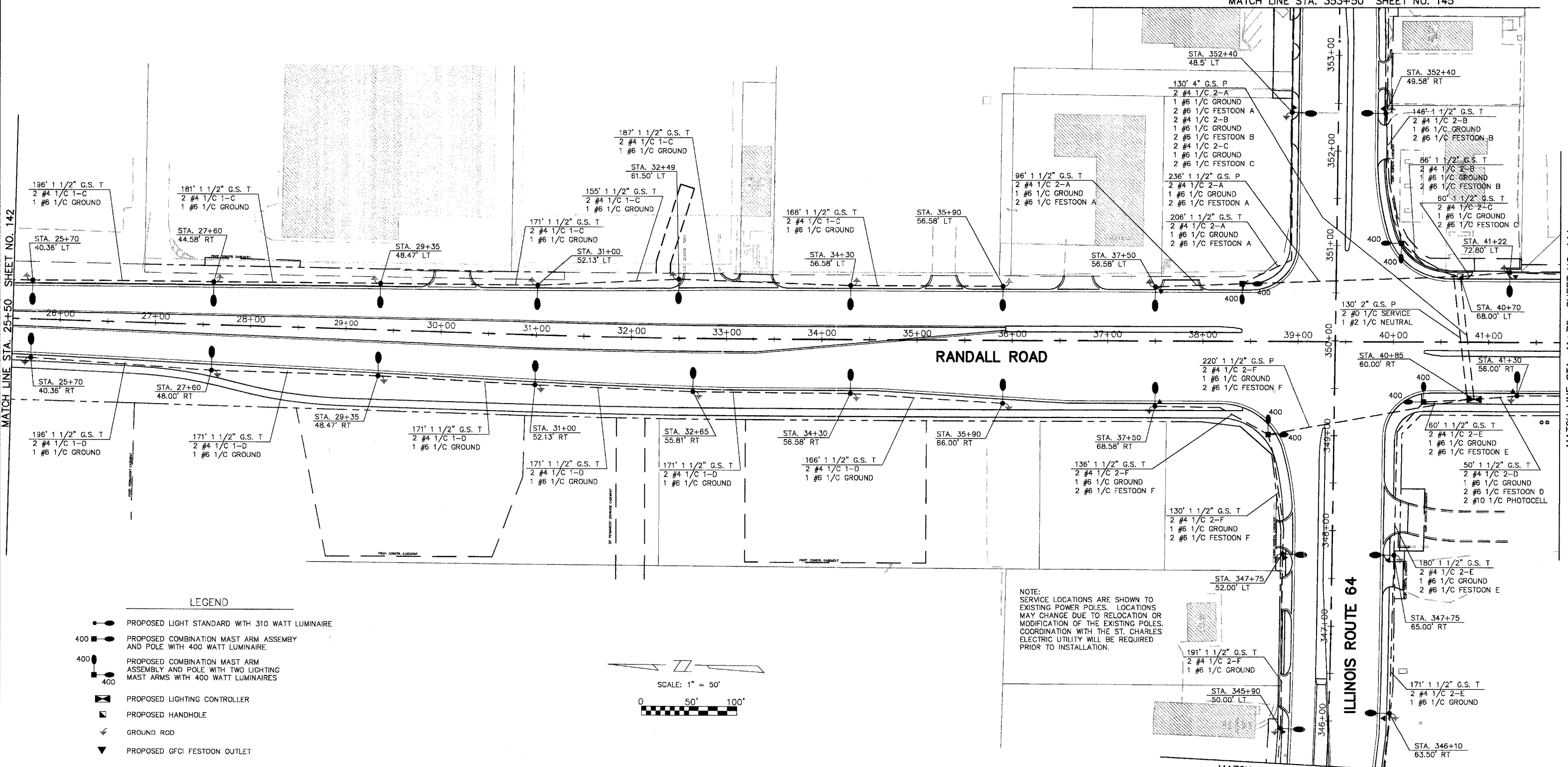

**LEGEND**

- PROPOSED LIGHT STANDARD WITH 310 WATT LUMINAIRE
- PROPOSED COMBINATION MAST ARM ASSEMBLY AND POLE WITH 400 WATT LUMINAIRE
- PROPOSED COMBINATION MAST ARM ASSEMBLY AND POLE WITH TWO LIGHTING MAST ARMS WITH 400 WATT LUMINAIRES
- PROPOSED LIGHTING CONTROLLER
- PROPOSED HANDHOLE
- GROUND ROD
- PROPOSED GFCI FESTOON OUTLET

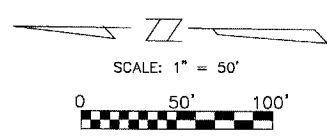

NOTE:  
 SERVICE LOCATIONS ARE SHOWN TO EXISTING POWER POLES. LOCATIONS MAY CHANGE DUE TO RELOCATION OR MODIFICATION OF THE EXISTING POLES. COORDINATION WITH THE ST. CHARLES ELECTRIC UTILITY WILL BE REQUIRED PRIOR TO INSTALLATION.

- GALVANIZED STEEL CONDUIT IN TRENCH (T), IN COMMON TRENCH (CT), EMBEDDED (EM), OR PUSHED (P) OF THE SIZE SPECIFIED WITH THE NUMBER AND SIZE OF CABLES SPECIFIED. CONDUIT LENGTHS INCLUDE 3 FEET OF VERTICAL CONDUIT AT EACH LIGHT STANDARD.
- EXISTING LIGHT STANDARD
- EXISTING LIGHT STANDARD TO BE REMOVED

MATCH LINE STA. 345+50 SHEET NO. 145

REVISIONS	
NAME	DATE
PER BEO REVIEW	10-7-04
PER BEO REVIEW	12-29-04

**STREET LIGHTING PLAN**

STATION 25+50 TO 41+75

**RANDALL ROAD**

SCALE: AS SHOWN  
 DATE: 5-26-04  
 DRAWN BY: JMH  
 CHECKED BY: DA

*Revised 6-8-05*