

F.A. ROUTE	SECTION	COUNTY	TOTAL SHEETS	SHEET NO.
1283	02-00059-00-BR	KANE	51	8
STA. 106+41		TO STA. 116+18		
FED. ROAD DIST.	ILLINOIS	FEDERAL AID PROJECT		
CONTRACT # 83783				

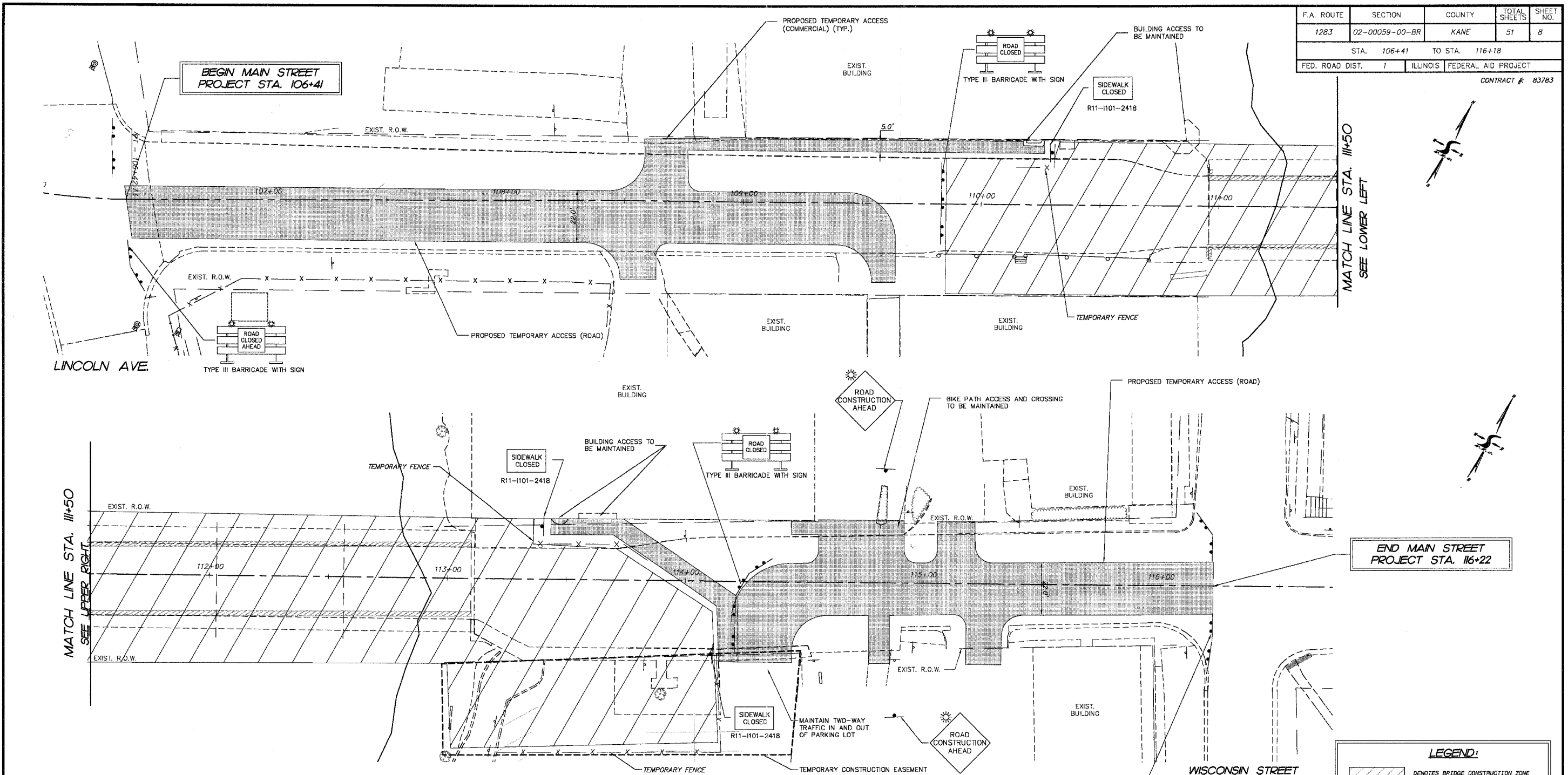

THE CONTRACTOR WILL BE ALLOWED TO CLOSE MAIN STREET TO THROUGH TRAFFIC FOR TWO SEPARATE DURATIONS OF THE PROJECT AS DETAILED IN THE SPECIFICATIONS.

THE DETOUR ROUTE SHALL BE POSTED PRIOR TO THE ROAD CLOSURES. SEE DETOUR PLAN FOR DETAILS.

THE CONTRACTOR SHALL MAINTAIN VEHICULAR, PEDESTRIAN AND BICYCLE ACCESS TO ADJUTING PROPERTIES AT ALL TIMES DURING CONSTRUCTION OPERATIONS.

PEDESTRIAN AND BICYCLE TRAFFIC CROSSING MAIN STREET SHALL BE MAINTAINED DURING CONSTRUCTION. SIGNAGE AND TEMPORARY FENCING SHALL BE AS INSTALLED AS SHOWN AND AS DIRECTED BY THE ENGINEER.

ALL TRAFFIC CONTROL WORK ASSOCIATED WITH BOTH ROAD CLOSURES, SIGNING, AND BARRICADING, SHALL BE INCLUDED IN THE LUMP SUM PAY ITEM FOR TRAFFIC CONTROL AND PROTECTION FOR TEMPORARY DETOUR.

TRAFFIC CONTROL GENERAL NOTES:

AT THE END OF EACH DAY OF CONSTRUCTION, THE CONTRACTOR SHALL PLACE (OR MAINTAIN PREVIOUSLY PLACED) SIGNING AND TEMPORARY FENCE OR TEMPORARY CONCRETE BARRIER TO PROHIBIT VEHICULAR AND PEDESTRIAN TRAFFIC IN THE BRIDGE CONSTRUCTION ZONE AREA. THE CONTRACTOR IS RESPONSIBLE FOR PROTECTING THE BRIDGE CONSTRUCTION AREA AT ALL TIMES. THIS WORK IS INCLUDED IN THE COST OF TRAFFIC CONTROL AND PROTECTION FOR TEMPORARY DETOUR AND TEMPORARY FENCE.

ALL SIGNING IS TO BE IN ACCORDANCE WITH THE FOLLOWING STATE STANDARDS: 701501, 701801, 702001, BLR-22 AND AS SHOWN IN THE PLANS.

THE WORK FOR THE TEMPORARY ACCESS SHALL BE IN ACCORDANCE WITH THE SPECIFICATION FOR AGGREGATE SURFACE COURSE FOR TEMPORARY ACCESS, AS DETAILED ON THE PLAN AND AS DIRECTED BY THE ENGINEER. THIS WORK SHALL BE PAID FOR AS TEMPORARY ACCESS (COMMERCIAL ACCESS), 8 EACH AND TEMPORARY ACCESS (ROAD), 2 EACH AND INCLUDE THAT NECESSARY WORK FOR BOTH CLOSURES. THE WORK FOR MAINTAINING THE PEDESTRIAN AND BICYCLE TRAFFIC SHALL NOT BE PAID FOR SEPARATELY BUT INCLUDED IN THE COST OF TEMPORARY ACCESS (ROAD).

DURING THE BORING OF THE WATER MAIN AND INSTALLATION OF OTHER WATER MAIN FACILITIES, THE CONTRACTOR WILL BE REQUIRED TO MAINTAIN ACCESS TO THE ADJACENT PROPERTIES. THIS WORK WILL NOT BE PAID FOR SEPARATELY, BUT BE INCLUDED IN THE COST OF THE ASSOCIATED WATER MAIN WORK.

THE EXISTING WATER MAIN ATTACHED TO THE BRIDGE MUST REMAIN IN SERVICE UNTIL THE PROPOSED WATER MAIN HIGH DENSITY POLYETHYLENE PRESSURE PIPE, DIRECTIONAL BORING, 16" IS COMPLETED AND PUT IN SERVICE.

REMOVAL OF ANY CONFLICTING PAVEMENT MARKINGS IN THE PARKING LOT SHALL BE INCLUDED IN THE COST OF THE TEMPORARY ACCESS (COMMERCIAL).

PAVEMENT MARKING TAPE, TYPE III REQUIRED PRIOR TO THE PLACEMENT OF PERMANENT STRIPING SHALL NOT BE PAID FOR SEPARATELY BUT INCLUDED IN THE COST OF TRAFFIC CONTROL AND PROTECTION FOR TEMPORARY DETOUR.

THIS PROJECT MAY REQUIRE UP TO 4 CHANGEABLE MESSAGE SIGNS.

WORK THIS SHEET WITH THE EROSION CONTROL PLAN, BRIDGE PLANS, AND THE EARTH EXCAVATION TABLE AND TEMPORARY EASEMENT DETAIL.

GENERAL SEQUENCE OF CONSTRUCTION:

STAGE I

1. CLOSE MAIN STREET TO THROUGH TRAFFIC.
2. BORE AND CONNECT WATER MAIN 16" AND OTHER WATER MAIN WORK ON EAST SIDE OF BRIDGE.
3. OPEN MAIN STREET TO VEHICULAR AND PEDESTRIAN TRAFFIC.

STAGE II

1. CLOSE MAIN STREET TO THROUGH TRAFFIC
2. PERFORM BRIDGE SUPERSTRUCTURE AND SUBSTRUCTURE DEMOLITION. PERFORM ROADWAY REMOVALS.
3. INSTALL STORM SEWER, RETAINING WALL FOUNDATION AND PERFORM EXCAVATION FOR ABUTMENTS.
4. CONSTRUCT ABUTMENTS AND PIERS
5. PLACE BEAMS, WEARING SURFACE, SIDEWALKS, RAILINGS ETC.

STAGE III

1. OPEN MAIN STREET TO THROUGH VEHICULAR, PEDESTRIAN AND BICYCLE TRAFFIC.
2. COMPLETE REMAINING ROADWAY, LIGHTING AND PUNCH LIST ITEMS.

LEGEND:

	DENOTES BRIDGE CONSTRUCTION ZONE
	DENOTES AREA OF SUGGESTED TEMPORARY AGGREGATE TO PROVIDE VEHICULAR AND PEDESTRIAN ACCESS TO ADJACENT PROPERTIES
	TYPE III BARRICADE
	SIGN
	TEMPORARY CONSTRUCTION FENCING

REVISIONS

1.	TEH	4-11-05
2.		
3.		
4.		
5.		
6.		
7.		
8.		

ILLINOIS DEPARTMENT OF TRANSPORTATION

VILLAGE OF CARPENTERSVILLE
 MAIN STREET OVER THE FOX RIVER
 MAINTENANCE OF TRAFFIC DETAILS

SCALE: VERT. N/A
 HORIZ. 1" = 20'
 DATE: 02-25-2005

DRAWN BY: WJH
 CHECKED BY: TEH