

F.A.P. R/E.	SECTION	COUNTY	TOTAL SHEETS	SHEET NO.
1283	02-00059-00-BR	KANE	51	9
STA.	TO STA.			
FED. ROAD DIST. NO. 1		ILLINOIS	HIGHWAY PROJECT	
CONTRACT #: 83783				

**ROAD CLOSURE GENERAL NOTES**

1. THE CONTRACTOR WILL BE ALLOWED TO CLOSE MAIN STREET FOR TWO SEPARATE DURATIONS AS DETAILED IN THE SPECIFICATIONS.
2. THE DETOUR ROUTE SHALL BE POSTED PRIOR TO THE ROAD CLOSURES. THE CONTRACTOR WILL BE ALLOWED TO LEAVE THE SIGNS IN PLACE BUT MUST COVER AND MAINTAIN THEM AS DIRECTED BY THE ENGINEER
3. ALL TRAFFIC CONTROL WORK ASSOCIATED WITH BOTH THE ROAD CLOSURES, SIGNING, TEMPORARY FENCING, TEMPORARY CONCRETE BARRIER, AND BARRICADING, SHALL BE INCLUDED IN THE LUMP SUM PAY ITEM FOR 'TRAFFIC CONTROL AND PROTECTION FOR TEMPORARY DETOUR'.
4. THE CONTRACTOR SHALL GIVE THE ENGINEER, VILLAGE AND IDOT A 72 HOUR NOTICE PRIOR TO PLACING THE ADVANCE NOTICE SIGNS.
5. ADVANCE NOTICE SIGNS " 17 " SHALL BE PLACED TWO WEEKS PRIOR TO INITIAL CLOSURE AND UPDATED TWO WEEKS PRIOR TO SECOND CLOSURE.
6. CHANGEABLE MESSAGE SIGNS SHALL BE PLACED ON THE NORTH AND SOUTH LEGS OF IL ROUTE 31, WEST LEG OF HUNTLEY ROAD, AND THE EAST LEG OF MAIN STREET ONE WEEK IN ADVANCE OF ROAD CLOSURES.



**SIGN LEGEND**

1		9	
2		10	
3		11	
4		12	
5		13	
6		14	
7		15	
8		16	
		17	

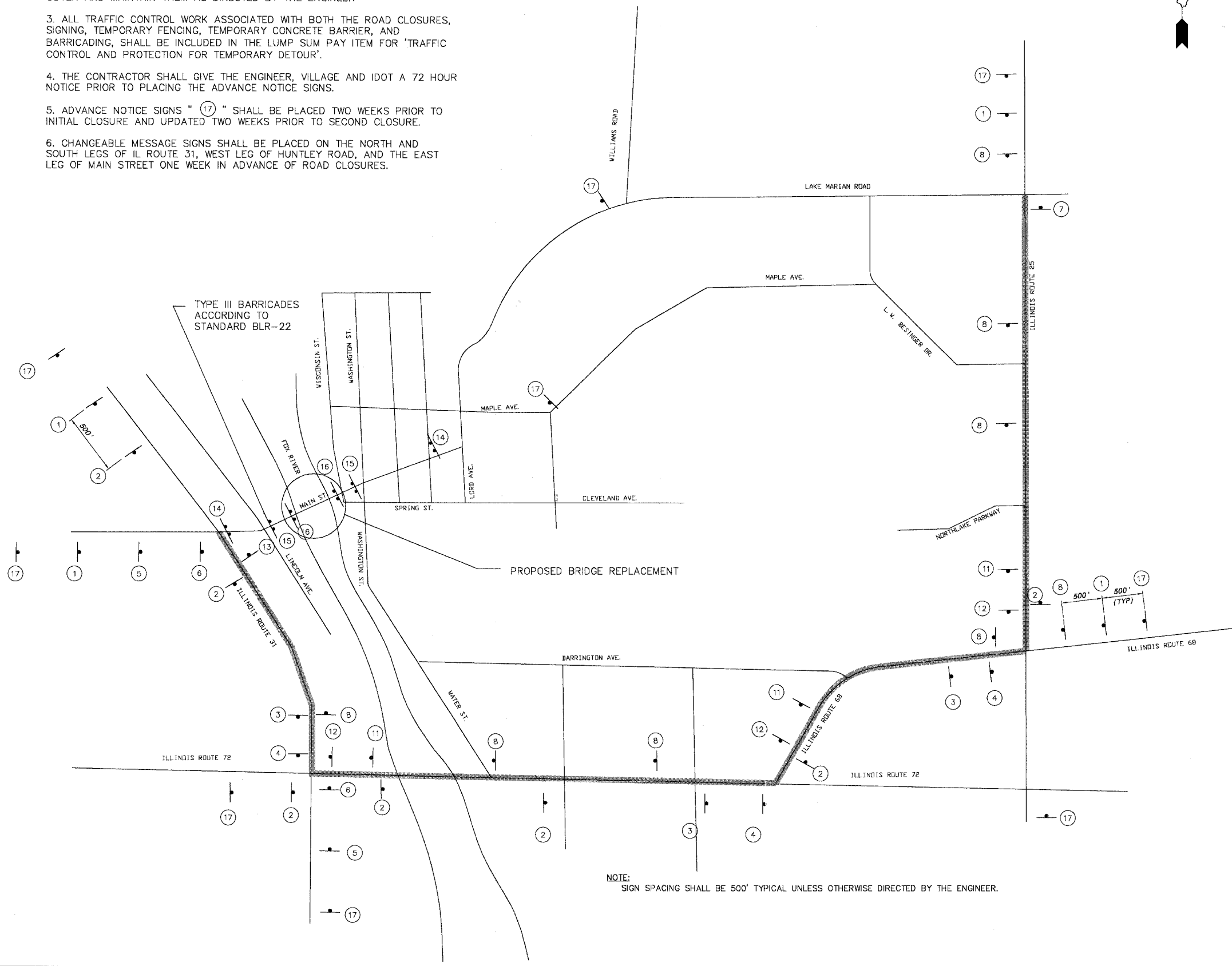

NOTE: SIGN SPACING SHALL BE 500' TYPICAL UNLESS OTHERWISE DIRECTED BY THE ENGINEER.

**LEGEND**

PROPOSED DETOUR ROUTE

REVISIONS	
NO.	DATE
1	
2	
3	
4	
5	
6	
7	
8	
9	
10	
11	
12	
13	
14	
15	
16	
17	

**SMITH ENGINEERING CONSULTANTS, INC.**  
 CIVIL/STRUCTURAL ENGINEERS AND SURVEYORS  
 4500 PRIME PARKWAY, SUITE 201  
 MCHENRY, ILLINOIS 60050  
 PH: 815-385-1770 FAX: 815-385-1781  
 www.smithengineering.com E-MAIL: nec@smithengineering.com  
 \* MCHENRY \* BURLINGTON \* YORKVILLE  
 ILLINOIS PROFESSIONAL DESIGN FIRM # 184-000108

ILLINOIS DEPARTMENT OF TRANSPORTATION  
**VILLAGE OF CARPENTERSVILLE**  
**MAIN STREET OVER THE FOX RIVER**  
**DETOUR PLAN**

SCALE: "NTS"  
 DATE 02-25-2005  
 DRAWN BY WJH  
 CHECKED BY TEH

PLOT FILE: STANDARD  
 VIEW: CE-9  
 COMP. FILE: 020107-DETOUR.dwg