

|                 |                |                |                 |           |
|-----------------|----------------|----------------|-----------------|-----------|
| F.A. ROUTE      | SECTION        | COUNTY         | TOTAL SHEETS    | SHEET NO. |
| 1283            | 02-00059-00-BR | KANE           | 51              | 50        |
| STA. 105+50     |                | TO STA. 110+96 |                 |           |
| FED. ROAD DIST. | 1              | ILLINOIS       | HIGHWAY PROJECT |           |

CONTRACT #: 83783

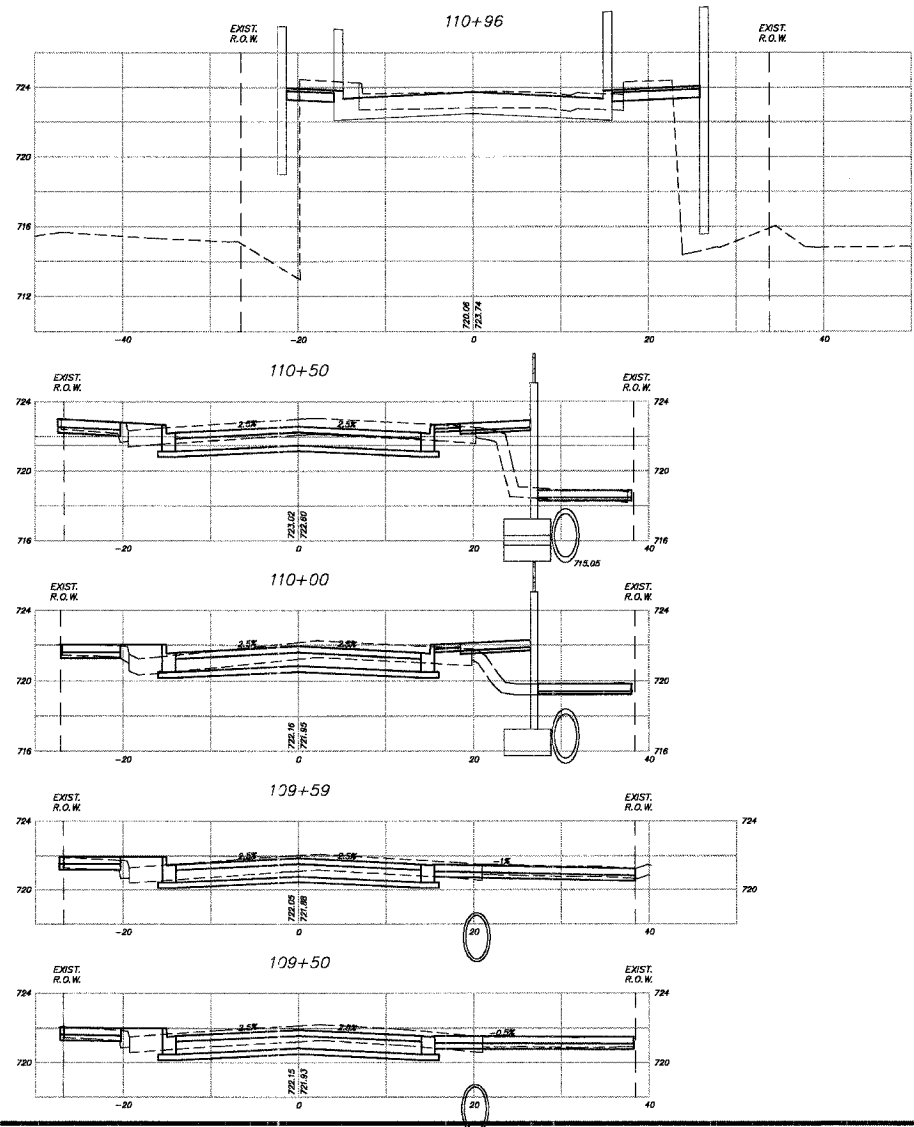
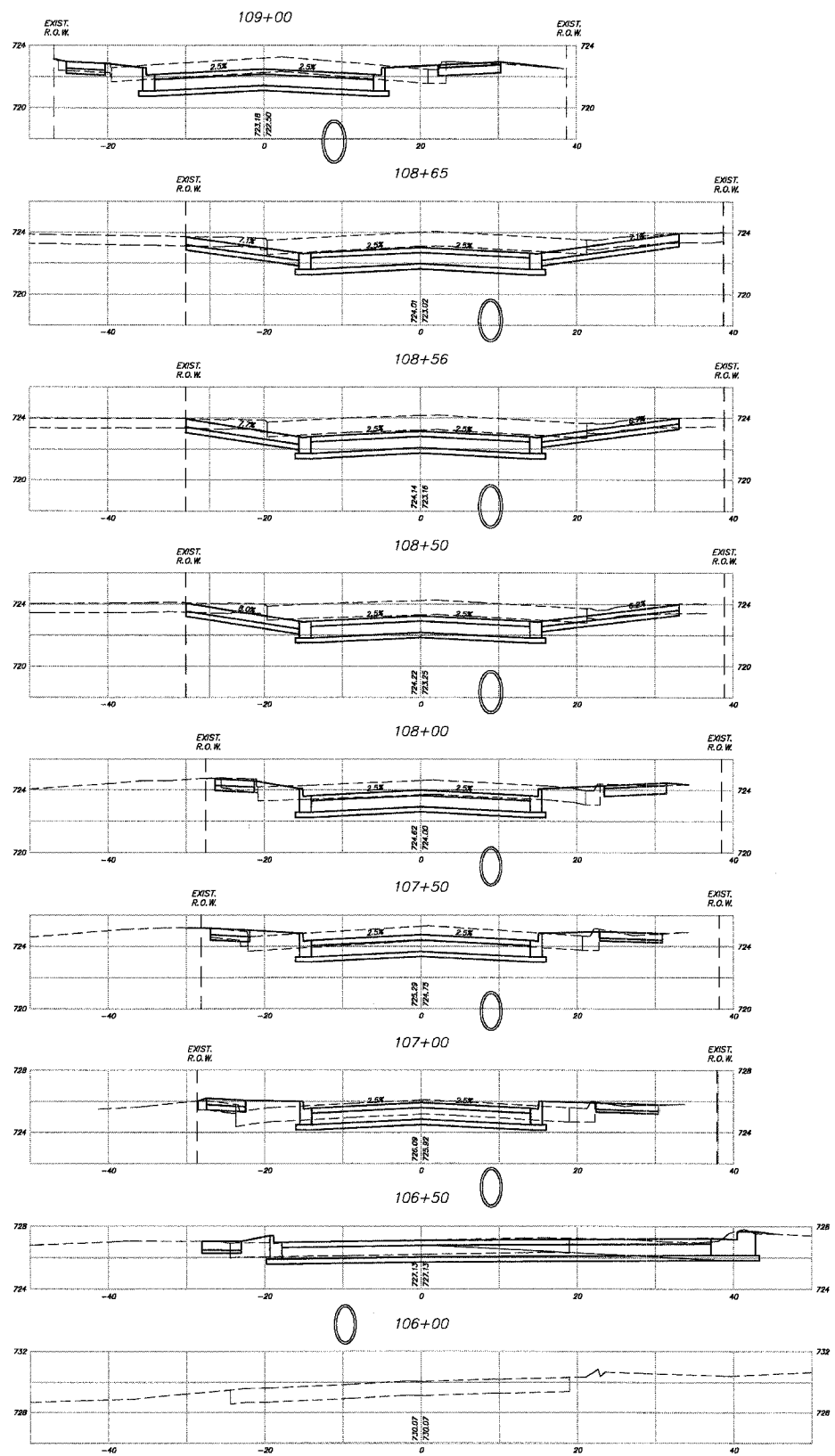

LWF, 02-25-2005  
 PLOT FILE: STANDARD  
 COMP. FILE: A-sec54.dwg

| REVISIONS |  |
|-----------|--|
| 1.        |  |
| 2.        |  |
| 3.        |  |
| 4.        |  |
| 5.        |  |
| 6.        |  |
| 7.        |  |
| 8.        |  |

**SMITH ENGINEERING CONSULTANTS, INC.**  
 CIVIL/STRUCTURAL ENGINEERS AND SURVEYORS  
 4500 PRIME PARKWAY, SUITE 201  
 MCKENNA, ILLINOIS 60050  
 PH: 815-395-1778 FAX: 815-395-1781  
 www.smithengineering.com E-MAIL: sec@smithengineering.com  
 \*McGONNEY \*HUNTLEY \*YORKVILLE  
 ILLINOIS PROFESSIONAL DESIGN FIRM # 184-000108

**ILLINOIS DEPARTMENT OF TRANSPORTATION**  
 VILLAGE OF CARPENTERSVILLE  
 MAIN STREET OVER THE FOX RIVER  
 CROSS SECTIONS

SCALE: VERT. 1"=5'  
 HORIZ. 1"=10'  
 DATE: 02-25-2005  
 DRAWN BY: WJH  
 CHECKED BY: TEH