

F.A.U. ROUTE	SECTION	COUNTY	TOTAL SHEETS	SHEET NO.
5349	04-00170-00-SP	DEKALB	17	1
COVER SHEET				
F.H.W.A. REG. 5 ILLINOIS FED. AID PROJECT				

STATE OF ILLINOIS  
DEPARTMENT OF TRANSPORTATION  
DIVISION OF HIGHWAYS  
**PLANS FOR PROPOSED  
FEDERAL AID HIGHWAY**  
NORMAL ROAD AT RIDGE DRIVE IMPROVEMENTS

INDEX TO SHEETS

SHEET NO.	DESCRIPTION
1	COVER SHEET
2	SUMMARY OF QUANTITIES
3	SCHEDULE OF QUANTITIES
4-5	TYPICAL SECTIONS
6-9	PLAN AND PROFILE, STRIPING PLANS
10-15	CROSS SECTIONS
16-17	CITY OF DEKALB STANDARD DETAILS

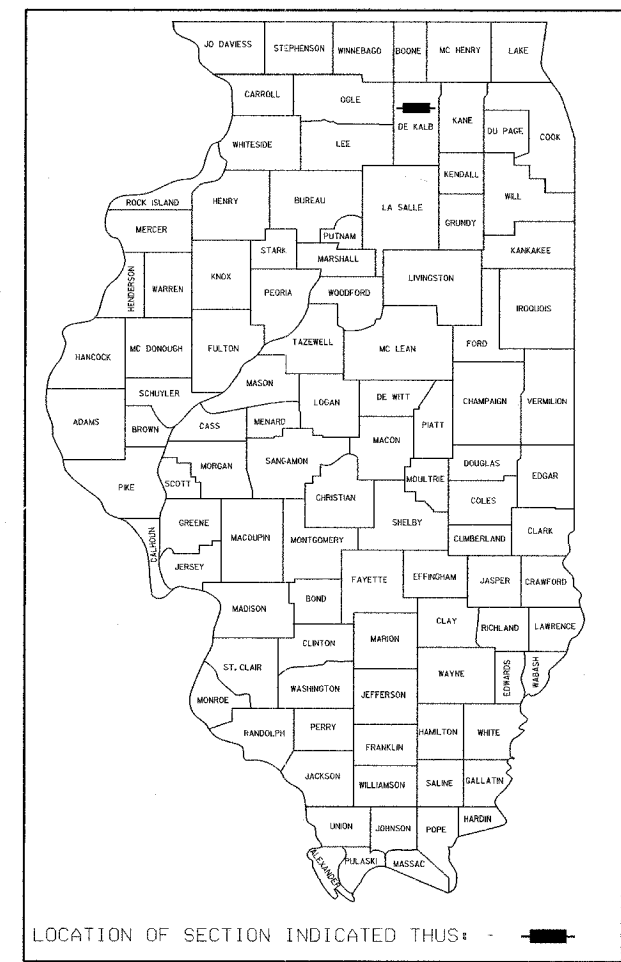

FAU ROUTE 5349  
SECTION NO. 04-00170-00-SP  
PROJECT NO. HS-5349(001)  
JOB NO. C-92-084-05  
CONTRACT NO. 85355

STATE STANDARDS

280001-02	TEMPORARY EROSION CONTROL SYSTEMS
424001-03	SIDEWALK RAMPS ACCESSIBLE TO THE DISABLED
442201-01	CLASS C AND CLASS D PATCHES
601001	SUB-SURFACE DRAINS
602001	CATCH BASIN TYPE C
602401	MANHOLE TYPE A
602501	VALVE VAULT TYPE A
604001-02	FRAME AND LIDS TYPE I
606001-02	CONCRETE CURB TYPE B AND COMBINATION CONCRETE CURB AND GUTTER
701301-02	LANE CLOSURE 2L, 2W, SHORT TIME OPERATIONS
701311-02	LANE CLOSURE 2L, 2W MOVING OPERATIONS- DAY ONLY
701501-03	URBAN LANE CLOSURE, 2L, 2W, UNDIVIDED
701801-03	LANE CLOSURE MULTILANE 1W OR 2W CROSSWALK OR SIDEWALK CLOSURE
702001-05	TRAFFIC CONTROL DEVICES
780001-01	TYPICAL PAVEMENT MARKINGS
781001-02	TYPICAL APPLICATIONS RAISED REFLECTIVE PAVEMENT MARKERS

PROJECT LOCATION

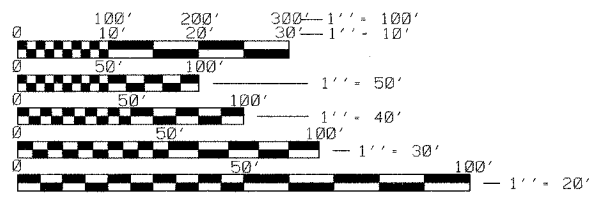
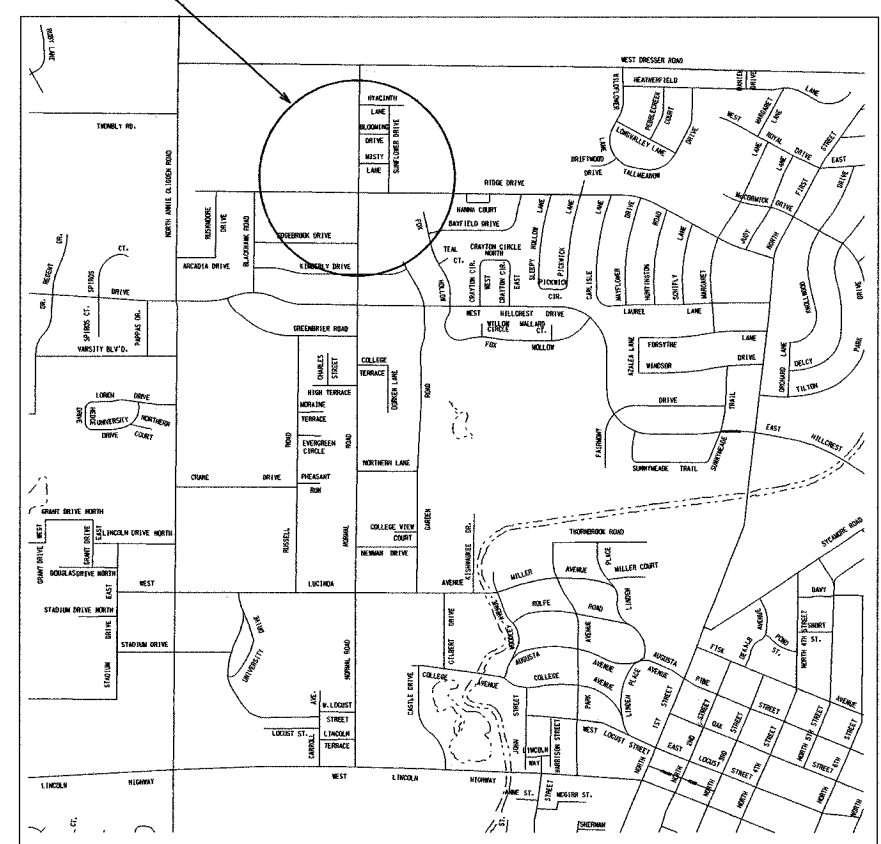

FULL SIZE PLANS HAVE BEEN PREPARED USING STANDARD ENGINEERING SCALES. REDUCED SIZED PLANS WILL NOT CONFORM TO STANDARD SCALES. IN MAKING MEASUREMENTS ON REDUCED PLANS, THE ABOVE SCALES MAY BE USED.

J.U.L.I.E.  
JOINT UTILITY LOCATION INFORMATION FOR EXCAVATION  
1-800-892-0123

ADT = 5035 (2005) NORMAL ROAD  
3620 (2005) RIDGE DRIVE  
< 12 TRUCKS  
URBAN MINOR COLLECTOR - NORMAL ROAD  
LOCAL ROAD - RIDGE DRIVE

LOCATION MAP  
SCALE: 1" = 1000'

PROJECT LENGTH = 1530' OR 0.29 MILE

STATE OF ILLINOIS  
DEPARTMENT OF TRANSPORTATION

APPROVED March 24, 2005  
Joel C. Maurer  
CITY OF DEKALB

PASSED MARCH 31 2005  
John L. John  
DISTRICT ENGINEER OF LOCAL ROADS AND STREETS

APPROVED March 31 2005  
August J. Montoya  
DISTRICT ENGINEER

DATE: March 24, 2005  
BY: Joel C. Maurer  
JOEL C. MAURER  
LICENSE EXPIRES: NOVEMBER 30, 2005

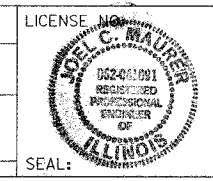

CONTRACT NO. 85355

F.A.U. ROUTE	SECTION	COUNTY	TOTAL SHEETS	SHEET NO.
5349	04-00170-00-SP	DEKALB	17	2
COVER SHEET				
F.H.W.A. REG. 5 ILLINOIS FED. AID PROJECT				

# SUMMARY OF QUANTITIES

CONSTRUCTION TYPE CODE: 1000-2A

PAY CODE	DESCRIPTION	UNITS	QUANTITY
20200100	EARTH EXCAVATION	CU YD	4 4 1 . 0
20800150	TRENCH BACKFILL	CU YD	5 2 . 0
21101615	TOPSOIL FURNISH AND PLACE, 4"	SQ YD	1 1 1 2 . 0
25000400	NITROGEN FERTILIZER NUTRIENT	POUND	1 4 . 0
25000500	PHOSPHORUS FERTILIZER NUTRIENT	POUND	1 4 . 0
25000600	POTASSIUM FERTILIZER NUTRIENT	POUND	1 4 . 0
25200110	SODDING, SALT TOLERANT	SQ YD	1 1 1 2 . 0
25200200	SUPPLEMENTAL WATERING	UNIT	3 . 0
28000500	INLET AND PIPE PROTECTION	EACH	5 . 0
31101800	SUB-BASE GRANULAR MATERIAL, TYPE B 10"	SQ YD	7 3 5 . 0
40600200	BITUMINOUS MATERIALS (PRIME COAT)	TON	4 . 0
40600300	AGGREGATE (PRIME COAT)	TON	2 3 . 0
40600640	LEVELING BINDER (HAND METHOD)TY 2	TON	1 0 . 0
40600990	TEMPORARY RAMPS	SQ YD	7 2 . 0
42300300	PCC DRIVEWAY PAVEMENT, 7"	SQ YD	9 5 . 0
42400200	PORT. CEMENT CONC. SIDEWALK, 5"	SQ FT	1 8 4 . 0
* 44000030	BIT CONC SURFACE REMOVAL, VARIABLE DEPTH	SQ YD	4 2 3 6 . 0
44000500	COMBINATION CURB AND GUTTER REMOVAL	FOOT	1 5 6 . 0
44000600	SIDEWALK REMOVAL	SQ FT	6 2 . 0
44201789	CLASS D PATCH TYPE 2 12"	SQ YD	2 3 . 0
* 44213200	SAW CUTS	FOOT	9 0 1 . 0
44300200	STRIP REFLECTIVE CRACK CONTROL TREATMENT	FOOT	1 8 0 2 . 0
50800105	REINFORCEMENT BARS	POUND	1 0 0 . 0
60107700	PIPE UNDERDRAINS, 6"	FOOT	6 0 . 0
60206905	CATCH BASINS, TYPE C, TYPE 1 FRAME, OPEN LID	EACH	2 . 0
* 60213300	CATCH BASIN, SPECIAL	EACH	6 . 0
60218300	MANHOLE, TYPE A, 4'-DIAMETER, TYPE 1 FRAME, OPEN LID	EACH	1 . 0
60255500	MANHOLE TO BE ADJUSTED	EACH	1 3 . 0
60404800	FRAME AND GRATE, TYPE 11	EACH	6 . 0
60406000	FRAME & LID, TY-1 OPEN LID	EACH	3 . 0
60406100	FRAME & LID, TY-1 CLOSED LID	EACH	5 . 0
60500050	REMOVING CATCH BASINS	EACH	2 . 0
* 60603800	COMBINATION CONCRETE CURB AND GUTTER, TYPE B-6.12	FOOT	1 0 7 5 . 0
70101700	TRAFFIC CONTROL AND PROTECTION	L SUM	1 . 0
70300100	SHORT-TERM PAVEMENT MARKING	FOOT	1 5 6 . 0
70301000	WORK ZONE PAVEMENT MARKING REMOVAL	SQ FT	7 9 . 0
78000100	THERMOPLASTIC PAVT MK LETTERS & SYMBOLS	SQ FT	4 7 . 0
78000200	THERMOPLASTIC PAVT MK LINE ,4"	FOOT	3 5 5 8 . 0
78000400	THERMOPLASTIC PAVT MK LINE, 6"	FOOT	8 1 9 . 0
78000600	THERMOPLASTIC PAVT MK LINE ,12"	FOOT	9 1 . 0
78000650	THERMOPLASTIC PAVT MK LINE,24"	FOOT	7 4 . 0
550A0340	STORM SEWERS, CLASS A, TYPE 2 12"	FOOT	2 0 8 . 0
550A0360	STORM SEWERS, CLASS A, TYPE 2 15"	FOOT	2 3 . 0
* X0321556	SANITARY MANHOLE TO BE ADJUSTED	EACH	5 . 0
* X0517100	STORM SEWERS, DUCTILE IRON PIPE 8"	FOOT	1 0 . 0
* X3560120	BITUMINOUS CONCRETE BASE COURSE WIDENING, SUPERPAVE 8"	SQ YD	5 5 3 . 0
* X4066424	BITUMINOUS CONCRETE SURFACE COURSE, SUPERPAVE, MIX "D", N50	TON	5 1 7 . 0
* X4066614	BITUMINOUS CONCRETE BINDER COURSE, SUPERPAVE, IL-19, N50	TON	6 2 . 0
* X4066765	LEVELING BINDER (MACHINE METHOD) SUPERPAVE N50	TON	2 8 . 0
* XX003424	CONNECTION TO EXISTING STRUCTURE	EACH	3 . 0

\* = NEED SPECIAL PROVISION OR DETAIL

F.A.U. ROUTE	SECTION	COUNTY	TOTAL SHEETS	SHEET NO.
5349	04-00170-00-SP	DEKALB	17	3
COVER SHEET				
F.H.W.A. REG. 5	ILLINOIS	FED. AID PROJECT		

### Bituminous Schedule

Locations	SubBase Granular Material, Ty B 10" (sq yd)	Bituminous Concrete Base Course Widening, Superpave 8" (sq yd)	Bituminous Material Prime Coat (ton)	Aggregate Prime Coat (ton)	Temporary Ramps (sq yd)	Bituminous Concrete Surface Removal Variable Depth (sq yd)	Leveling Binder (Machine Method), Superpave N50 (ton)	Leveling Binder Hand Method (ton)	Strip Refl. Crk. Control Treatment (foot)	Bituminous Concrete Surface Course, SuperPave, Mix "D", N50 (ton)	Bituminous Concrete Binder Course, SuperPave, IL-19, N50 (ton)	Saw Cuts (foot)
<b>Normal Road</b>												
STA 213+70 to STA 214+00	19.4	15			18.9	93.3			30.0	12.7	1.7	15.0
STA 214+00 to STA 217+50	330.6	252.8				1088.9	15.0		700.0	148.1	28.3	350.0
STA 217+50 to STA 219+26	83.1	63.6				547.6	4.0		352.0	74.5	7.1	176.0
STA 219+26 to STA 220+20						355.1				39.8		
STA 220+20 to STA 220+50					18.9	113.3				12.7		
<b>Ridge Drive</b>												
STA 349+50 to STA 349+83					21.1	253.0				28.3		
STA 350+17 to STA 350+74						421.2				47.2		
STA 350+74 to STA 351+20						173.8				19.5		
STA 351+20 to STA 352+00	48.9	31.1				271.1		160.0		33.8	3.5	80.0
STA 352+00 to STA 353+30	137.2	108.3				390.0		260.0		55	12.1	130.0
STA 353+30 to STA 354+32	103.3	76.7				306.0	3.5	204.0		19.3	8.6	102.0
STA 354+32 to STA 354+80	12.5	5.8				138.4	5.0	96.0		17	0.6	48.0
STA 354+80 to STA 355+10					13.3	84.3				9.4		
<b>Totals</b>	<b>735</b>	<b>553.3</b>	<b>3.6</b>	<b>22.9</b>	<b>72.2</b>	<b>4236.0</b>	<b>27.5</b>	<b>10.0</b>	<b>1802.0</b>	<b>517.3</b>	<b>61.9</b>	<b>901.0</b>

### Striping Schedule

Locations	Short-Term Pavement Marking (ft)	Work Zone Pavement Marking Removal (sq ft)	Thermoplastic Pav't Mk line, 4" (ft)	Thermoplastic Pav't Mk line, 6" (ft)	Thermoplastic Pav't Mk line, 12" (ft)	Thermoplastic Pav't Mk line, 24" (ft)	Thermoplastic Pav't Mk letters & symbols (sq ft)
<b>Normal</b>							
STA 214+40 TO 216+45	36.0	12.0	852.0		52.0		
STA 216+89 TO 219+50	48.0	16.0	651.0	227.0	11.0	25.0	31.2
STA 219+64 TO 220+35 X-WALKS				437.0			
STA 220+48 TO 223+40 (exist pavt)		27.0	931.0	155.0	28.0	25.0	15.6
<b>Ridge</b>							
STA 349+50 TO 349+60			20.0			24.0	
STA 350+49 TO 355+10	72.0	24.0	1104.0				
<b>Totals</b>	<b>156.0</b>	<b>79.0</b>	<b>3558.0</b>	<b>819.0</b>	<b>91.0</b>	<b>74.0</b>	<b>46.8</b>

#### 20200100- EARTH EXCAVATION

<b>Location</b>	<b>Volume (cu yds)</b>
STA 213+80 to 219+26, RT	277
NE quadrant of Normal and Ridge	18
STA 351+00 to 355+00, RT	146
<b>TOTAL</b>	<b>441</b>

#### 42300300- PCC DRIVEWAY PAVEMENT 7"

<b>RIDGE</b>	<b>AREA (sq yd)</b>
STA 350+93, RT	31
STA 353+78, RT	64
<b>TOTAL</b>	<b>95</b>

#### 42400200- PORTLAND CEMENT CONCRETE SIDEWALK 5"

<b>RIDGE</b>	<b>AREA (sq ft)</b>
NE Corner Ridge & Normal	184

#### 44000500-COMBINATION CURB & GUTTER REMOVAL

<b>NORMAL</b>	<b>Length (foot)</b>
STA 219+26 TO 219+31 RT	5

<b>RIDGE</b>	<b>Length (foot)</b>
STA 355+03 RT	5
STA 350+62 TO 351+20 RT	58
STA 353+00 LT	8
NE Corner Ridge & Normal	80
<b>TOTAL</b>	<b>166</b>

#### 44000600-SIDEWALK REMOVAL

<b>RIDGE</b>	<b>AREA (sq ft)</b>
NW Corner Ridge & Sunflower	62.0

#### 44201789-CLASS D PATHES TYPE 2 12"

<b>RIDGE</b>	<b>AREA (sq ft)</b>
NW quadrant of Ridge and Normal	9.0
SW quadrant of Ridge and Normal	14.0
<b>TOTAL</b>	<b>23.00</b>

#### 50800105-REINFORCEMENT BARS

<b>RIDGE</b>	<b>pound</b>
STA 350+93, RT	39.0
STA 353+78, RT	33.0

<b>NORMAL</b>	<b>pound</b>
STA 214+00, RT	7
STA 216+50, RT	7
STA 216+97, RT	7
STA 219+00, RT	7
<b>TOTAL</b>	<b>100</b>

#### 60603800-COMBINATION CONCRETE CURB & GUTTER B-6.12

<b>RIDGE</b>	<b>Length (foot)</b>
STA 350+62 TO 355+08 RT	446
STA 353+00 LT	8

<b>NORMAL</b>	<b>Length (foot)</b>
STA 213+88 TO 219+29 RT	541
NE Corner of Ridge & Normal	80
<b>TOTAL</b>	<b>1075</b>

### Sanitary & Storm Sewer Schedule

Locations	Trench Backfill (cu yd)	Inlet and Pipe Protection (each)	Pipe Underdrains, 6" (each)	Catch Basins, TY C, TIF, CL (each)	Catch Basin, Special (each)	Manhole, TY A, 4-Dia, TY 1 Frame, Open Lid (each)	Manholes To Be Adjusted (each)	Frames and Grates, Type 11 (each)	Frames and Lids, Type-1 Open (each)	Frames and Lids, Type-1 Closed (each)	Removing Catch Basins (each)	Storm Sewers, Class A, Type 2 12" (foot)	Storm Sewers, Class A, Type 2 15" (foot)	Sanitary Manhole To Be Adjusted (each)	Storm Sewers, Ductile Iron Pipe 8" (foot)	Connection to Existing Structure (each)
<b>Normal Road</b>																
STA 213+88, RT	1.4		10.0		1.0			1.0						1.0	10.0	1.0
STA 213+90, RT							1.0									
STA 214+20, CL																
STA 215+03, 18.58' RT	1.5		10.0		1.0			1.0					6.5	1.0		
STA 215+03, RT							1.0							1.0		
STA 216+97, CL										1.0				1.0		
STA 219+00, RT										1.0						
STA 219+45, CL										1.0						
STA 219+64, LT										1.0						
STA 219+95, RT										1.0						
STA 220+00, CL										1.0						
STA 220+20, RT										1.0						
<b>Ridge Drive</b>																
STA 349+63, LT																
STA 350+40, LT			10.0		1.0			1.0			1.0					
STA 350+42, LT																
STA 350+46, RT																
STA 351+71, LT																
STA 352+00, 23' RT		1.0		1.0												
STA 352+00, 23' RT TO STA 352+50, 18.58' RT	11.3											48.0				
STA 352+50, 18.58' RT			10.0		1.0			1.0								
STA 352+50, 18.58' RT TO 23' RT	1.4											6.0				
STA 352+50, 18.58' RT TO STA 353+38, 25' RT	20.8											88.0				
STA 352+50, 23' RT		1.0		1.0										1.0		
STA 353+38, 25' RT TO 353+49, 18' RT	2.4											12.0				
STA 353+38, 25' RT TO 353+56, 25' RT													16.0			
STA 353+38, 25' RT		1.0				1.0										
STA 353+39, RT											1.0					
STA 353+44, CL																
STA 353+49, 18' RT			10.0		1.0			1.0								
STA 353+52, LT																
STA 353+54, RT BEHIND CURB		1.0														
STA 353+56, 25' RT																
STA 353+97, RT		1.0														1.0
STA 353+97, RT TO 354+50, 18.58' RT	12.7											54.0				1.0
STA 354+50, 18.58' RT			10.0		1.0			1.0								
<b>Totals</b>	<b>51.5</b>	<b>5.0</b>	<b>60.0</b>	<b>2.0</b>	<b>6.0</b>	<b>1.0</b>	<b>13.0</b>	<b>6.0</b>	<b>3.0</b>	<b>5.0</b>	<b>2.0</b>	<b>208.0</b>	<b>22.5</b>	<b>5.0</b>	<b>10.0</b>	<b>3.0</b>

### Seeding Schedule

Locations	Topsoil Furnish & Place, 4" (sq yd)	Nitrogen Fertilizer Nutrient (pound)	Phosphorus Fertilizer Nutrient (pound)	Potassium Fertilizer Nutrient (pound)	Sodding, Salt Tolerant (sq yd)	Supplemental Watering (unit)
<b>Normal</b>						
STA 213+80 RT to 219+26 RT	670.0	8.3	8.3	8.3	670.0	2.0
NE quadrant of Normal and Ridge	42.0	0.5	0.5	0.5	42.0	0.1
<b>Ridge</b>						
STA 351+20 RT to 353+65 RT	212.2	2.6	2.6	2.6	212.2	0.6
STA 353+65 RT to 355+00 RT	187.4	2.3	2.3	2.3	187.4	0.6
<b>Totals</b>	<b>1111.6</b>	<b>13.8</b>	<b>13.8</b>	<b>13.8</b>	<b>1111.6</b>	<b>3.3</b>

<b>RIDGE</b>	<b>AREA (sq ft)</b>
NW Corner Ridge & Sunflower	62.0

#### 44201789-CLASS D PATHES TYPE 2 12"

<b>RIDGE</b>	<b>AREA (sq ft)</b>
NW quadrant of Ridge and Normal	9.0
SW quadrant of Ridge and Normal	14.0
<b>TOTAL</b>	<b>23.00</b>

#### 50800105-REINFORCEMENT BARS

<b>RIDGE</b>	<b>pound</b>
STA 350+93, RT	39.0
STA 353+78, RT	33.0

<b>NORMAL</b>	<b>pound</b>
STA 214+00, RT	7
STA 216+50, RT	7
STA 216+97, RT	7
STA 219+00, RT	7
<b>TOTAL</b>	<b>100</b>

#### 60603800-COMBINATION CONCRETE CURB & GUTTER B-6.12

<b>RIDGE</b>	<b>Length (foot)</b>
STA 350+62 TO 355+08 RT	446
STA 353+00 LT	8

<b>NORMAL</b>	<b>Length (foot)</b>
STA 213+88 TO 219+29 RT	541
NE Corner of Ridge & Normal	80
<b>TOTAL</b>	<b>1</b>

F.A.U. ROUTE	SECTION	COUNTY	TOTAL SHEETS	SHEET NO.
5349	04-00170-00-SP	DEKALB	17	4
TYPICAL SECTIONS				
F.H.W.A. REG. 5 ILLINOIS FED. AID PROJECT				

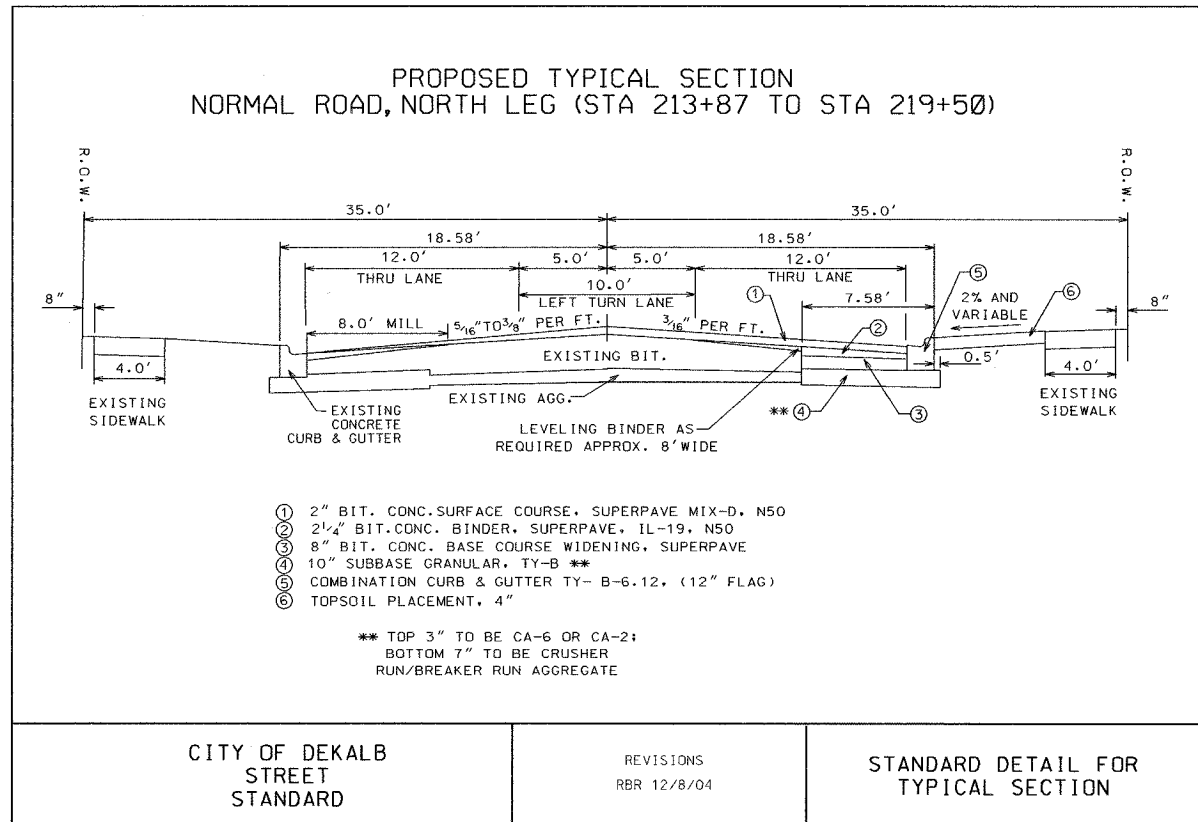
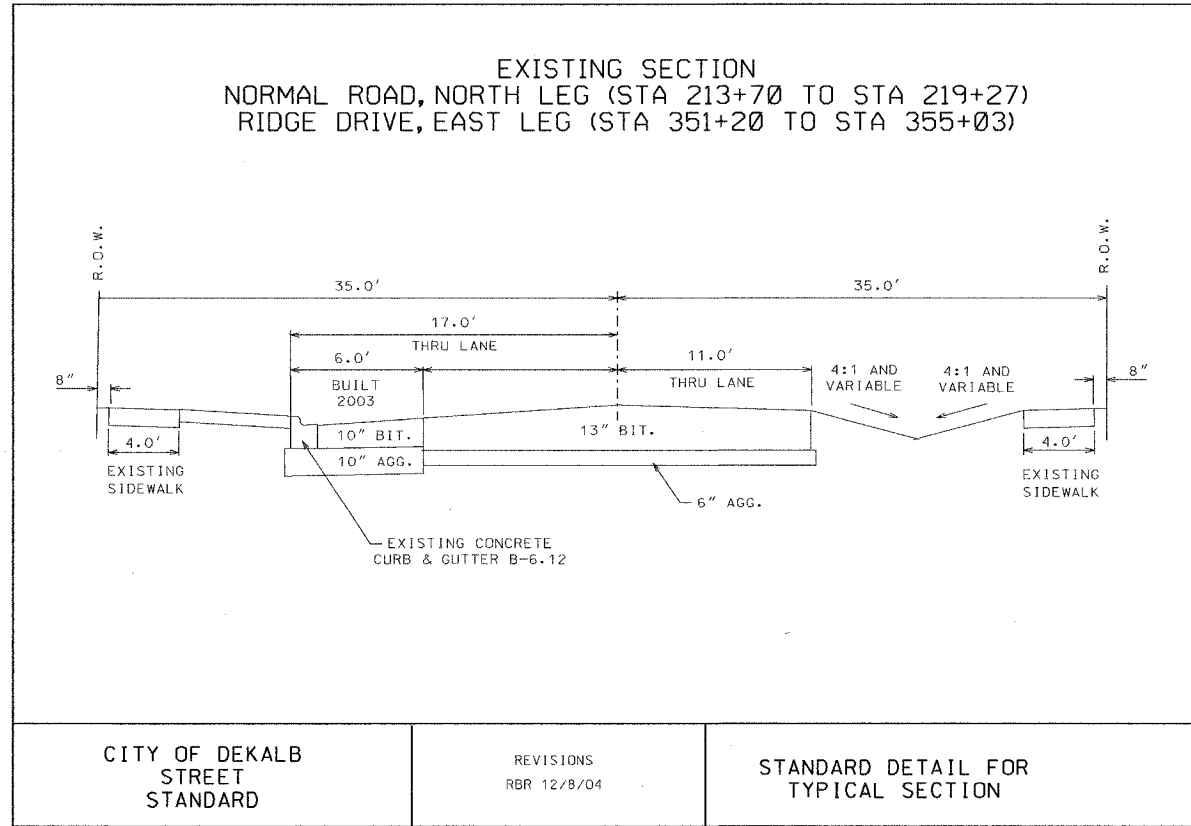
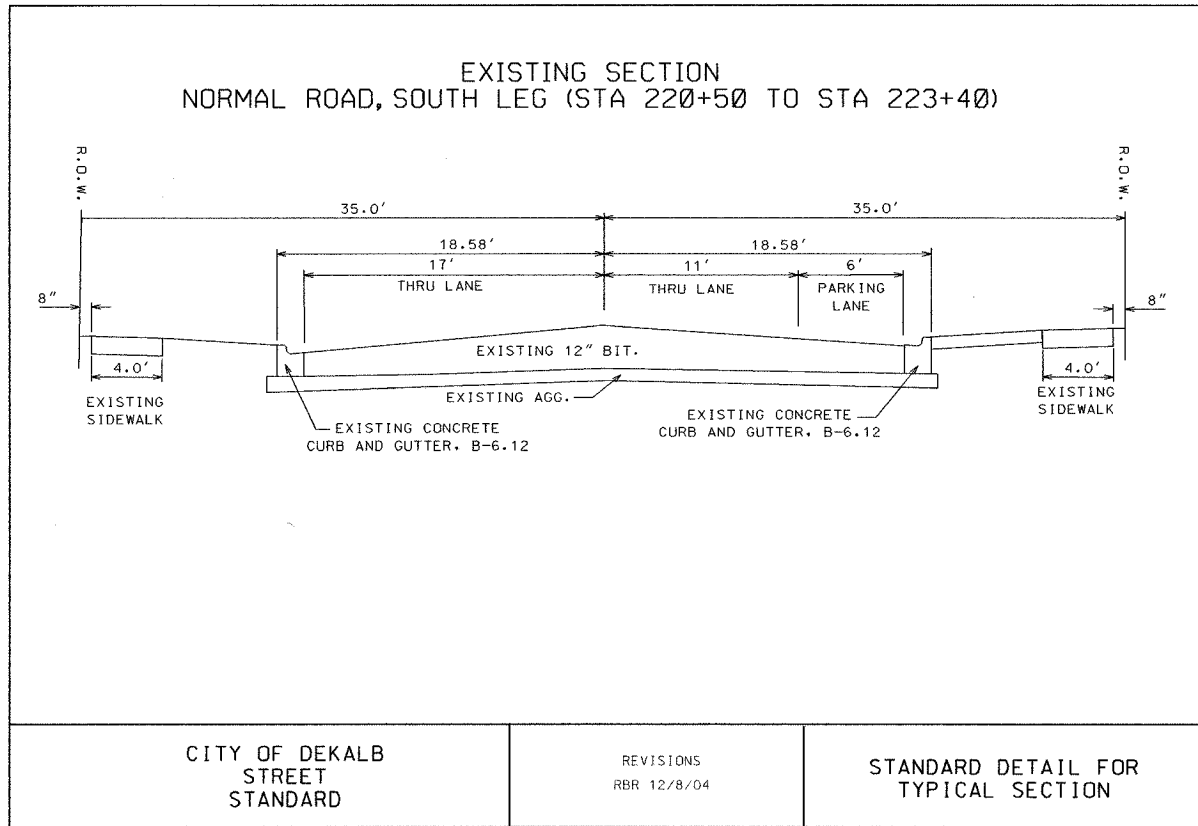

**PAVEMENT DESIGN DATA**  
NORMAL ROAD WIDENING

Design Period = 20 years (construction in 2005)  
 Structural Design Traffic = 10 years (2015)  
 Road/Street Classification: Class II-2 lane-ADT 6800  
 Percent of Structural Design Traffic in Design Lane  
 PV = 6664 (98%) SU = 102 (4.5%) MU = 34 (0.5%)  
 Flexible Traffic Factor (Modified AASHTO) = 0.25535  
 Structural No. = 3.45 for IBR = 3

Existing Pavement Section after resurfacing in 1995

2" Bituminous Conc. Surface (overlay)	2*0.4 = 0.80
1 1/2" Bituminous Surface	1.5*0.3 = 0.45
1 1/2" Bit. Conc. Binder	1.5*0.23 = 0.34
8" Bit. Base (BAM)	8*0.21 = 1.68
6" Subbase Granular, Ty-B	6*0.09 = 0.54
<b>Total Existing Structural No.</b>	<b>3.81</b>
Proposed Existing Section, 2" Bit Surf Overlay	2*0.40 = 0.80
<b>Proposed Existing Section Struct. No.</b>	<b>4.61</b>

Proposed Pavement Widening Section:

2" Bituminous Surface - Superpave	2*1/4*0.80 = 0.74
2 1/4" Bituminous Binder - Superpave	2*1/4*0.33 = 0.74
8" Bituminous Base Cse. (MS = 1700)	8*0.33 = 2.64
10" Aggregate Base Cse. Ty-B	10*0.11 = 1.10
<b>Proposed Structural No. =</b>	<b>5.28</b>

City of DeKalb requires Major Collector SN= 4.0 as a minimum

**MIXTURE REQUIREMENTS**

Mixture use:	Surface	Binder	Leveling Binder	Base Course Widening
PG	PG 64-22	PG 64-22	PG 64-22	PG 58-22
RAP % (max)	10%	15%	10%	25%
Design Air Voids	4.2% @ N-50	4.2% @ N-50	4.2% @ N-50	2.0% @ N-50
Mixture Composition	IL - 9.5	IL - 19.0	IL - 9.5	IL - 19.0
Gradation Mixture	or IL - 12.5			
Friction Aggregate	D			

F.A.U. ROUTE	SECTION	COUNTY	TOTAL SHEETS	SHEET NO.
5349	04-00170-00-SP	DEKALB	17	5
TYPICAL SECTIONS				
F.H.W.A. REG. 5 ILLINOIS FED. AID PROJECT				

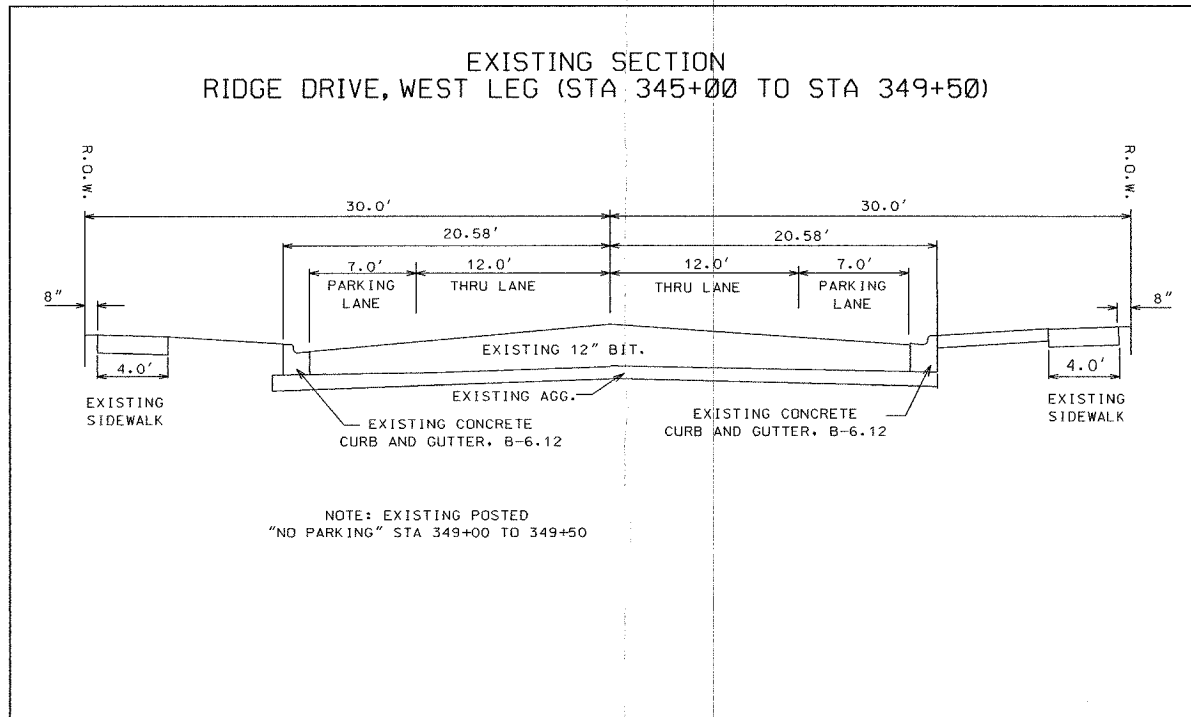

CITY OF DEKALB STREET STANDARD

REVISIONS RBR 12/8/04

STANDARD DETAIL FOR TYPICAL SECTION

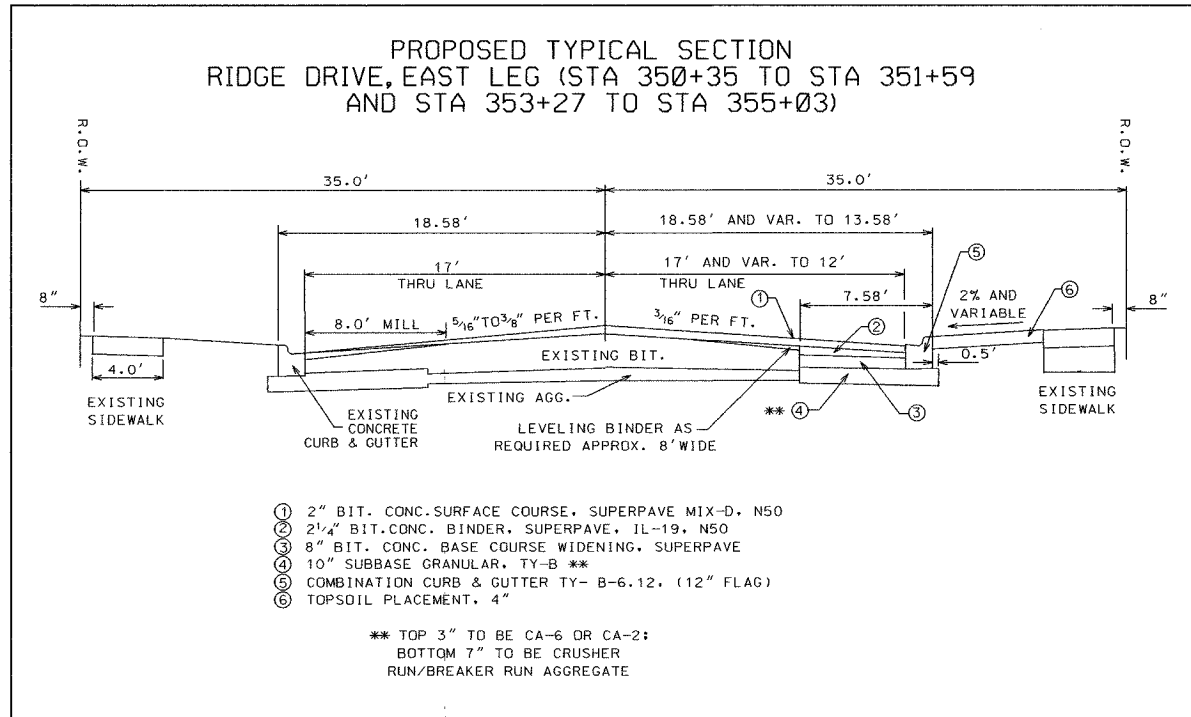

CITY OF DEKALB STREET STANDARD

REVISIONS RBR 2/28/05

STANDARD DETAIL FOR TYPICAL SECTION

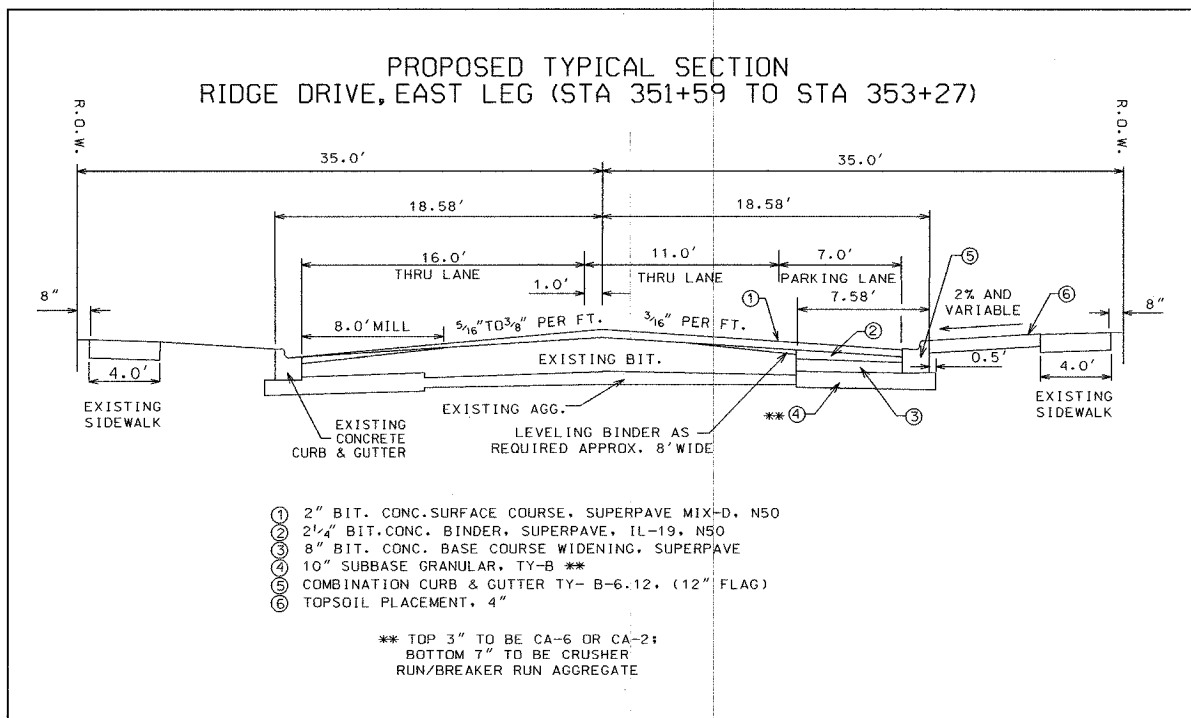

CITY OF DEKALB STREET STANDARD

REVISIONS RBR 2/28/05

STANDARD DETAIL FOR TYPICAL SECTION

PAVEMENT DESIGN DATA  
RIDGE DRIVE WIDENING

Design Period = 20 years (construction in 2005)  
 Structural Design Traffic = 10 years (2015)  
 Road/Street Classification: Class II-2 lane-ADT 6800  
 Percent of Structural Design Traffic in Design Lane  
 PV = 6664 (98%) SU = 102 (1.5%) MU = 34 (0.5%)  
 Flexible Traffic Factor (Modified AASHTO) = 0.25535  
 Structural No. = 3.45 for IBR = 3

Existing Pavement Section after resurfacing in 1995  
 2" Bituminous Conc. Surface (overlay) 2\*0.4 = 0.80  
 1 1/2" Bituminous Surface 1.5\*0.3 = 0.45  
 1 1/2" Bit. Conc. Binder 1.5\*0.23 = 0.34  
 8" Bit. Base (BAM) 8\*0.21 = 1.68  
 6" Subbase Granular, Ty-B 6\*0.09 = 0.54  
 Total Existing Structural No. 3.81  
 Proposed Existing Section, 2" Bit Surf Overlay 2\*0.40 = 0.80  
 Proposed Existing Section Struct. No. 4.61

Proposed Pavement Widening Section:  
 2" Bituminous Surface - Superpave 2\*0.40 = 0.80  
 2 1/4" Bituminous Binder - Superpave 2 1/4\*0.33 = 0.74  
 8" Bituminous Base Cse. (MS = 1700) 8\*0.33 = 2.64  
 10" Aggregate Base Cse, Ty-B 10\*0.11 = 1.10  
 Proposed Structural No. = 5.28

City of DeKalb requires Major Collector SN= 4.0 as a minimum

MIXTURE REQUIREMENTS

Mixture use:	Surface	Binder	Leveling Binder	Base Course Widening
PG	PG 64-22	PG 64-22	PG 64-22	PG 58-22
RAP % (max)	10%	15%	10%	25%
Design Air Voids	4.2% @ N-50	4.2% @ N-50	4.2% @ N-50	2.0% @ N-50
Mixture Composition	IL - 9.5 or IL - 12.5	IL - 19.0	IL - 9.5	IL - 19.0
Gradation Mixture Friction Aggregate	D			

F.A.U. ROUTE	SECTION	COUNTY	TOTAL SHEETS	SHEET NO.
5349	04-00170-00-SP	DEKALB	17	6
PLAN, PROFILE & STRIPING PLANS				
F.H.W.A. REG. 5	ILLINOIS	FED. AID	PROJECT	

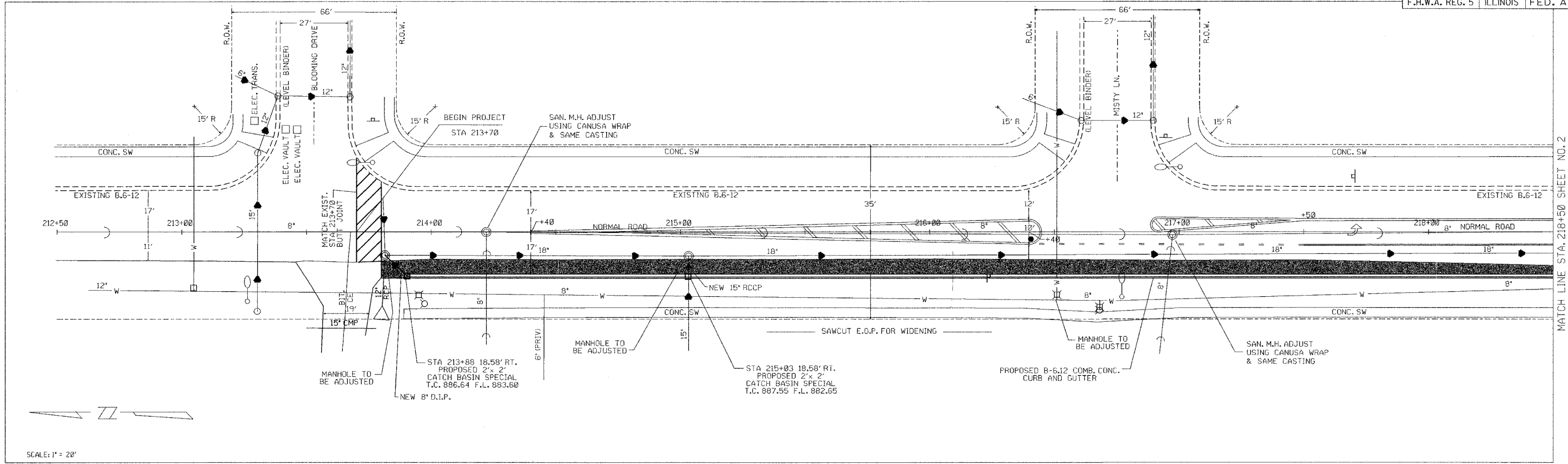

NORMAL ROAD

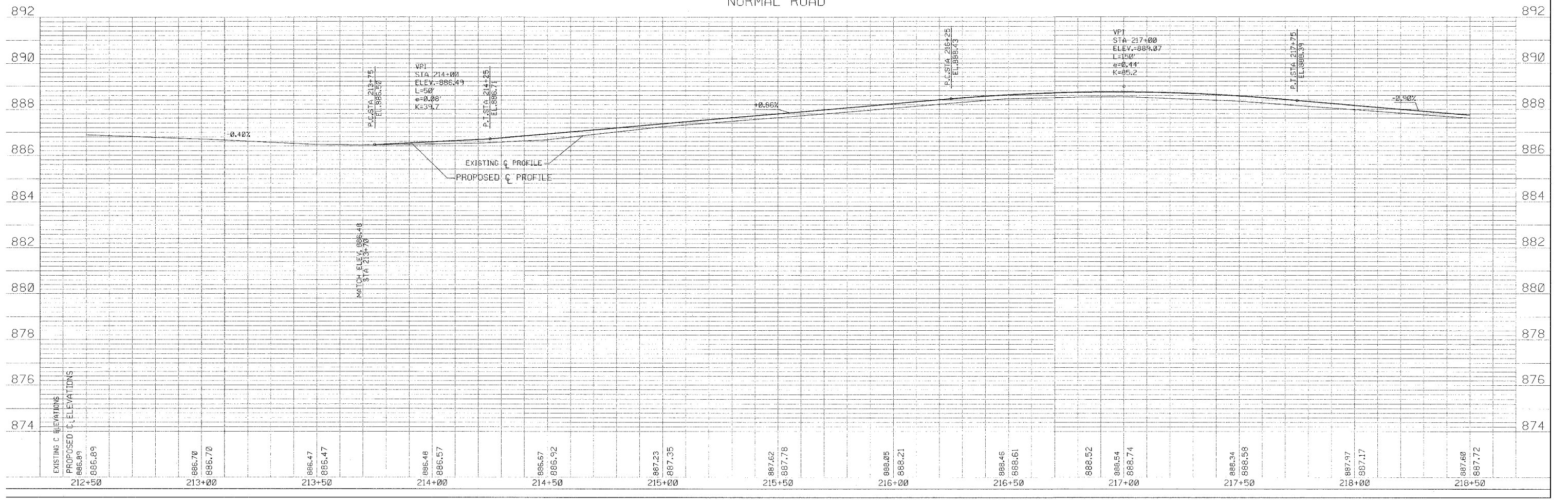

F.A.U. ROUTE	SECTION	COUNTY	TOTAL SHEETS	SHEET NO.
5349	04-00170-00-SP	DEKALB	17	7
PLAN, PROFILE & STRIPING PLANS				
F.H.W.A. REG. 5		ILLINOIS	FED. AID PROJECT	

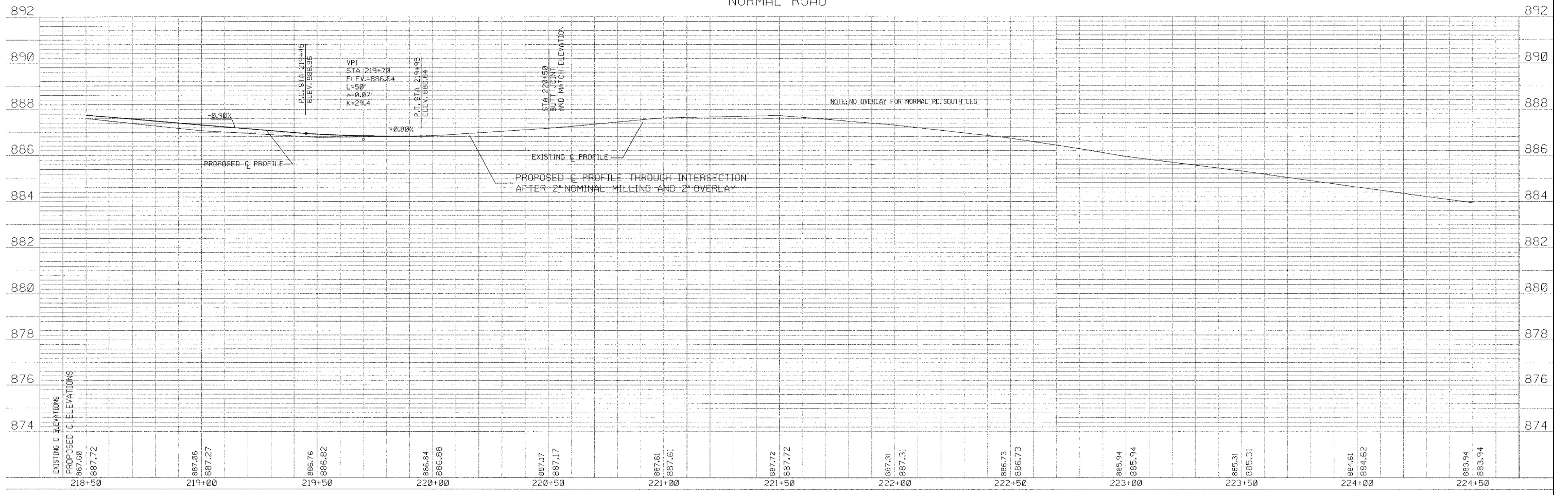
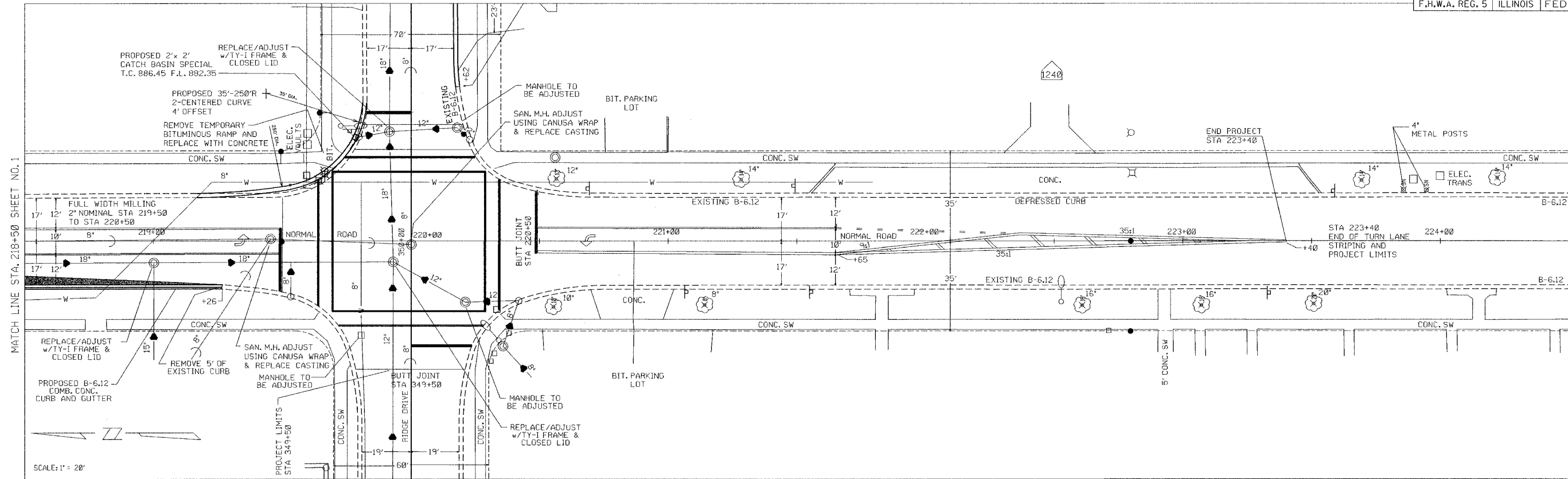

F.A.U. ROUTE	SECTION	COUNTY	TOTAL SHEETS	SHEET NO.
5349	04-00170-00-SP	DEKALB	17	8
PLAN, PROFILE & STRIPING PLANS				
F.H.W.A. REG. 5 ILLINOIS FED. AID PROJECT				

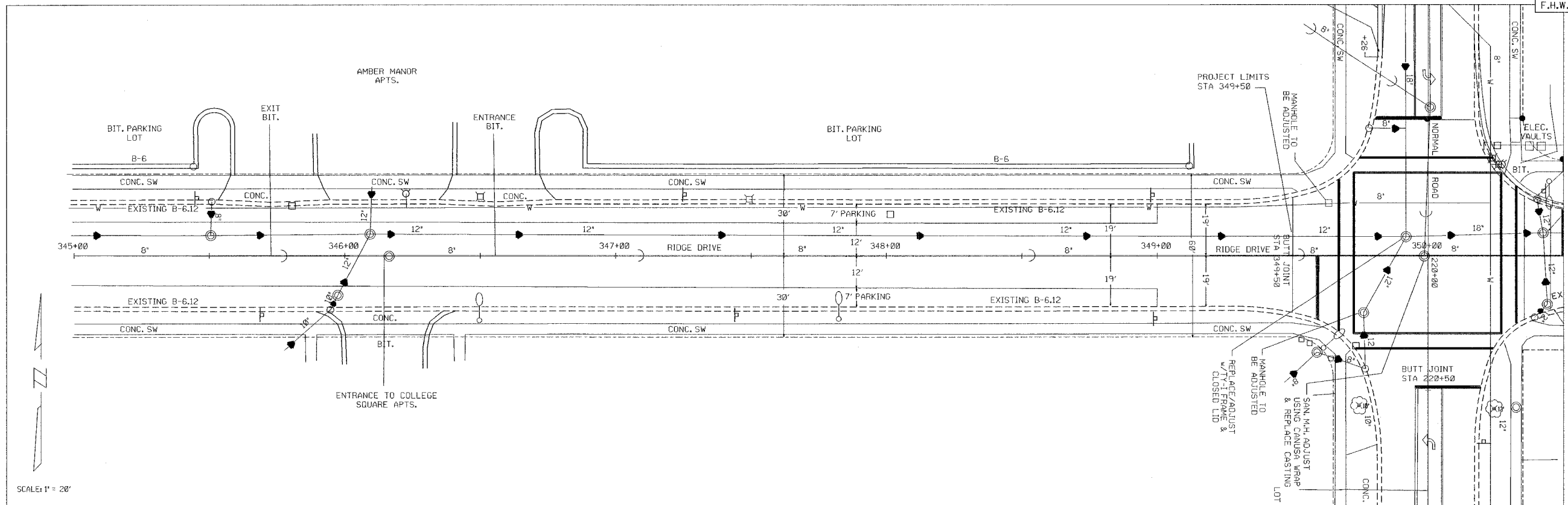

SCALE: 1" = 20'

RIDGE DRIVE

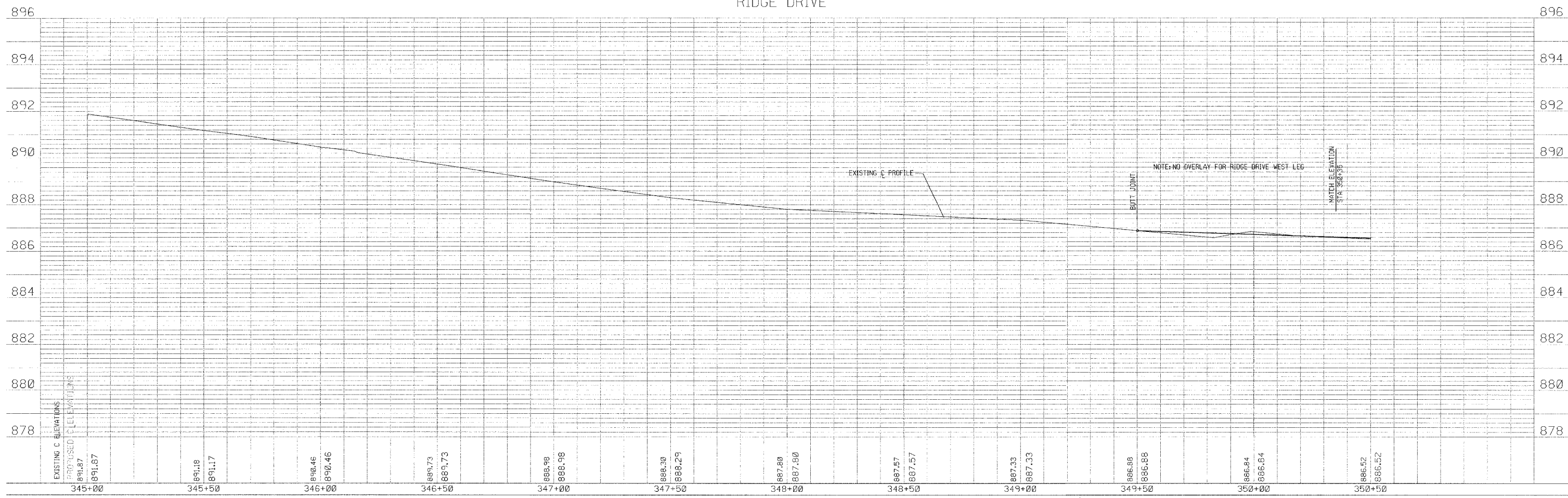





F.A.U. ROUTE	SECTION	COUNTY	TOTAL SHEETS	SHEET NO.
5349	04-00170-00-SP	DEKALB	17	10
CROSS SECTIONS		FED. AID PROJECT		
F.H.W.A. REG. 5		ILLINOIS		

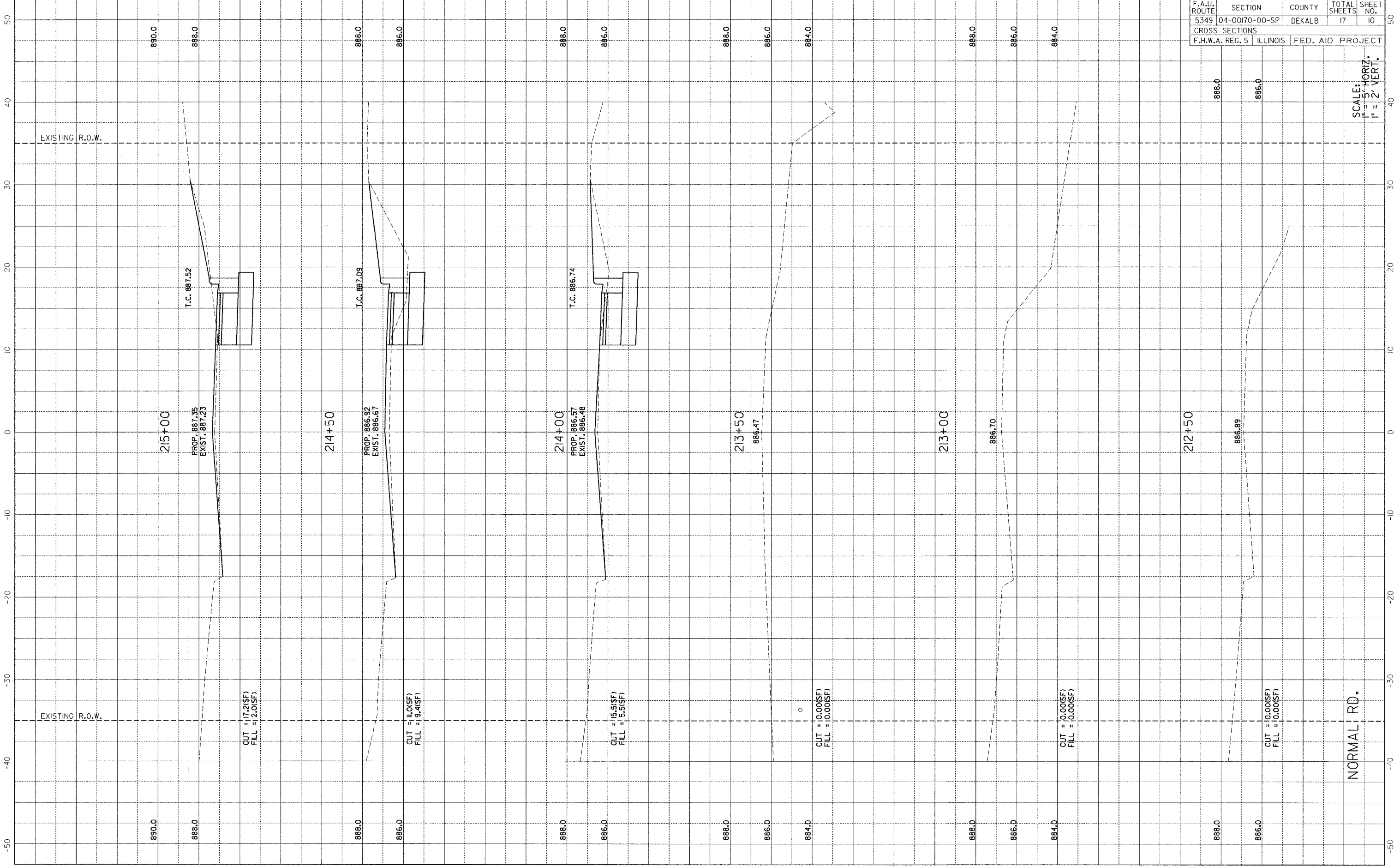

SCALE:  
 1" = 5' HORIZ.  
 1" = 2' VERT.

FILE NO.	DEKALB STANDARD	DETAILS	TOTAL SHEETS	SHEET NO.
ROUTE	SECTION	COUNTY	17	II
5349	04-00170-00-SP	DEKALB		
CROSS SECTIONS				
F.H.W.A. REG. 5	ILLINOIS	FED. AID PROJECT		

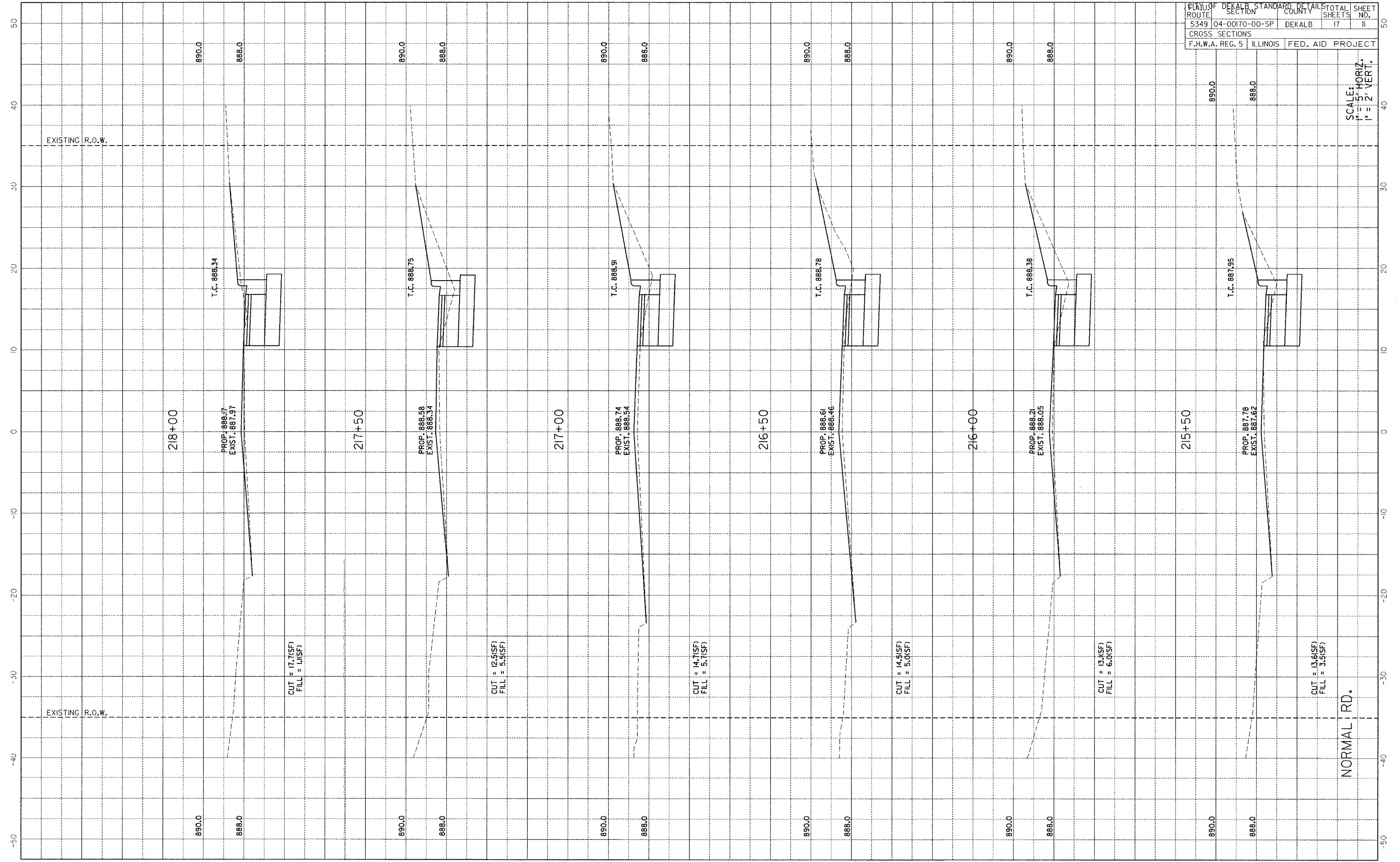

SCALE:  
 1" = 5' HORIZ.  
 1" = 2' VERT.

NORMAL RD.

F.A.U. ROUTE	SECTION	COUNTY	TOTAL SHEETS	SHEET NO.
5349	04-00170-00-SP	DEKALB	17	12
CROSS SECTIONS		F.H.W.A. REG. 5 ILLINOIS FED. AID PROJECT		

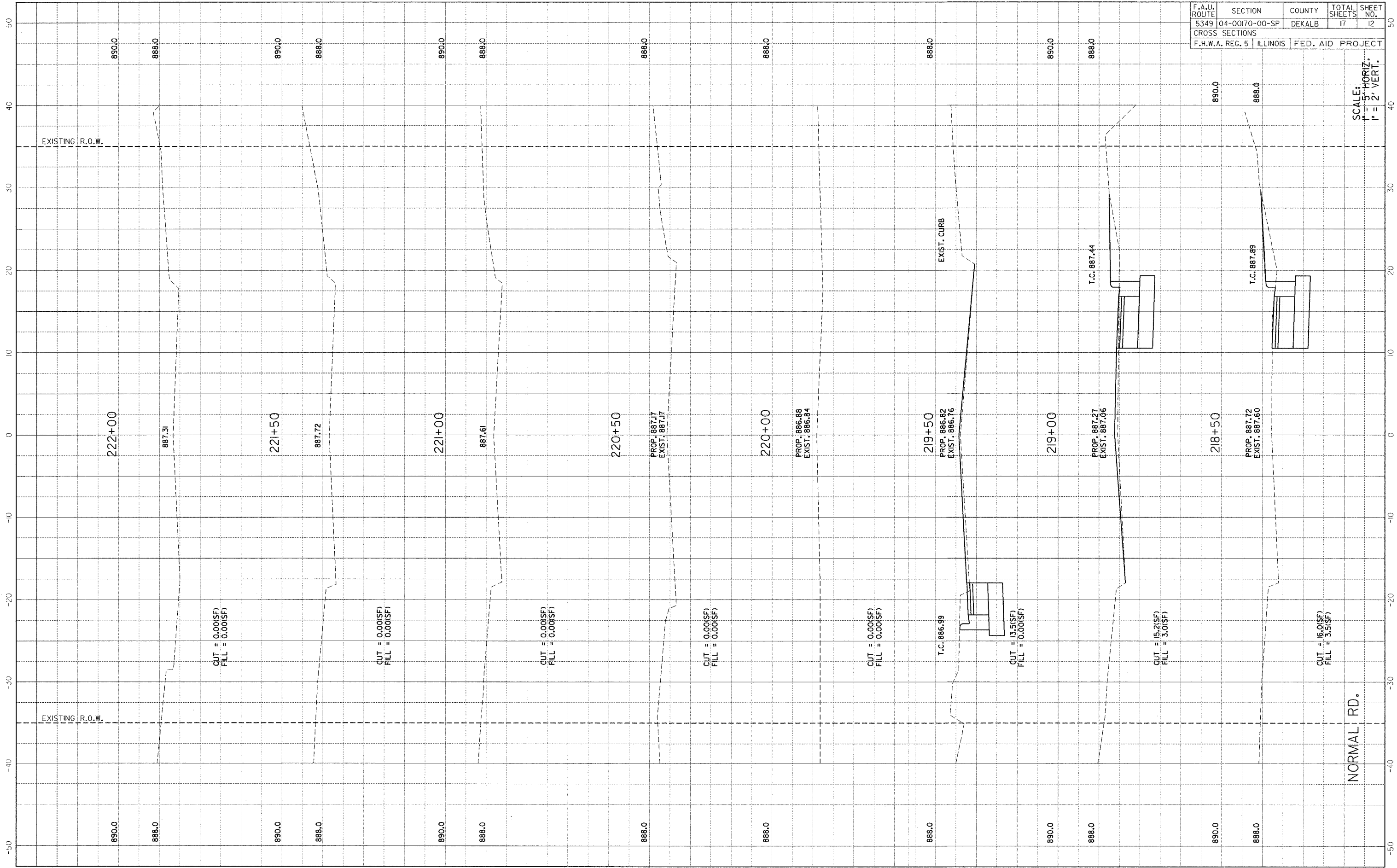

SCALE:  
1" = 5' HORIZ.  
1" = 2' VERT.

F.A.U. ROUTE	SECTION	COUNTY	TOTAL SHEETS	SHEET NO.
5349	04-00170-00-SP	DEKALB	17	13
CROSS SECTIONS STA 348+00 TO 350+50				
F.H.W.A. REG. 5 ILLINOIS		FED. AID PROJECT		

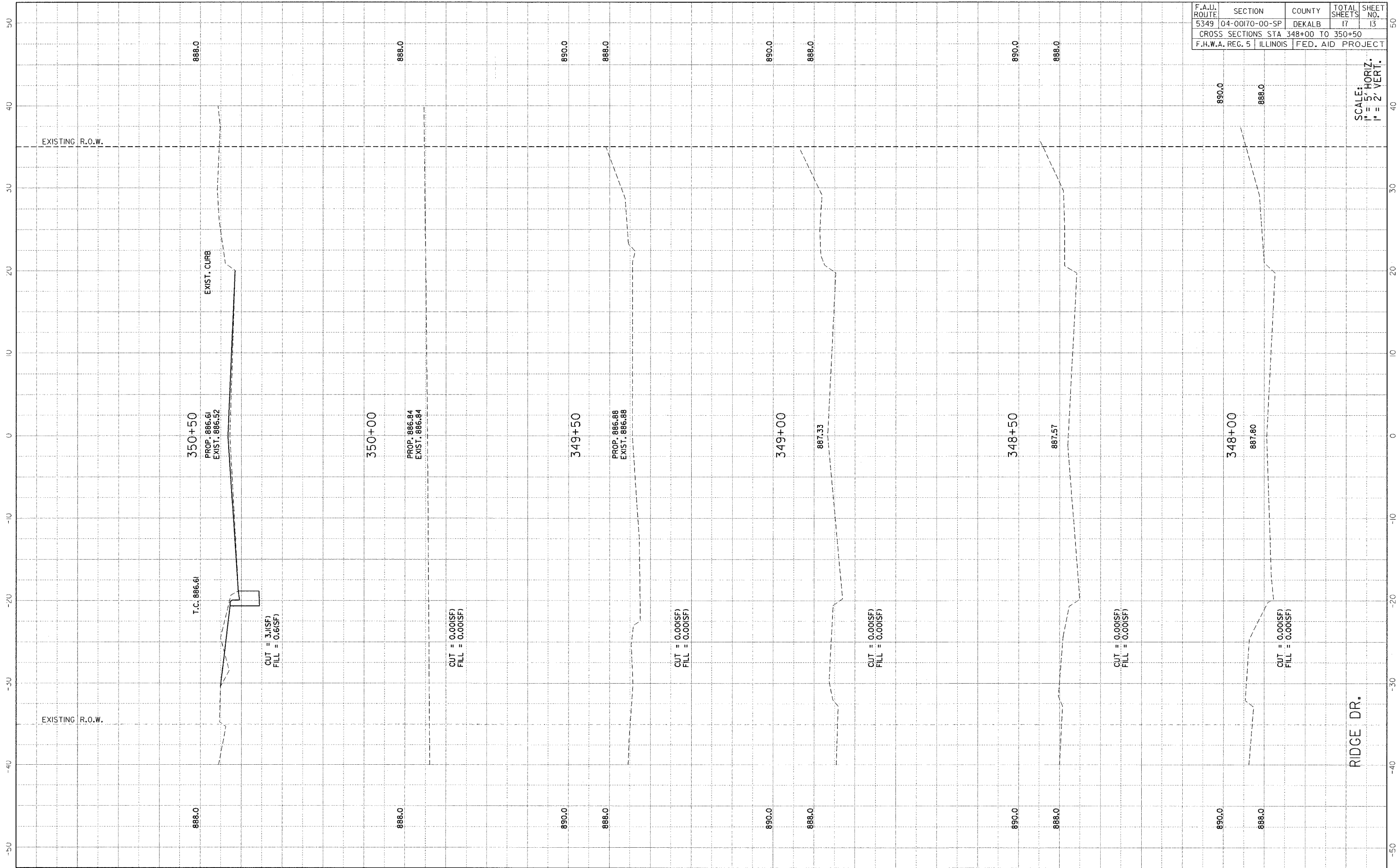

SCALE:  
 1" = 5' HORIZ.  
 1" = 2' VERT.

F.A.U. ROUTE	SECTION	COUNTY	TOTAL SHEETS	SHEET NO.
5349	04-00170-00-SP	DEKALB	17	14
CROSS SECTIONS STA 351+00 TO 353+50				
F.H.W.A. REG. 5		ILLINOIS	FED. AID PROJECT	

SCALE:  
 1" = 5' HORIZ.  
 1" = 2' VERT.

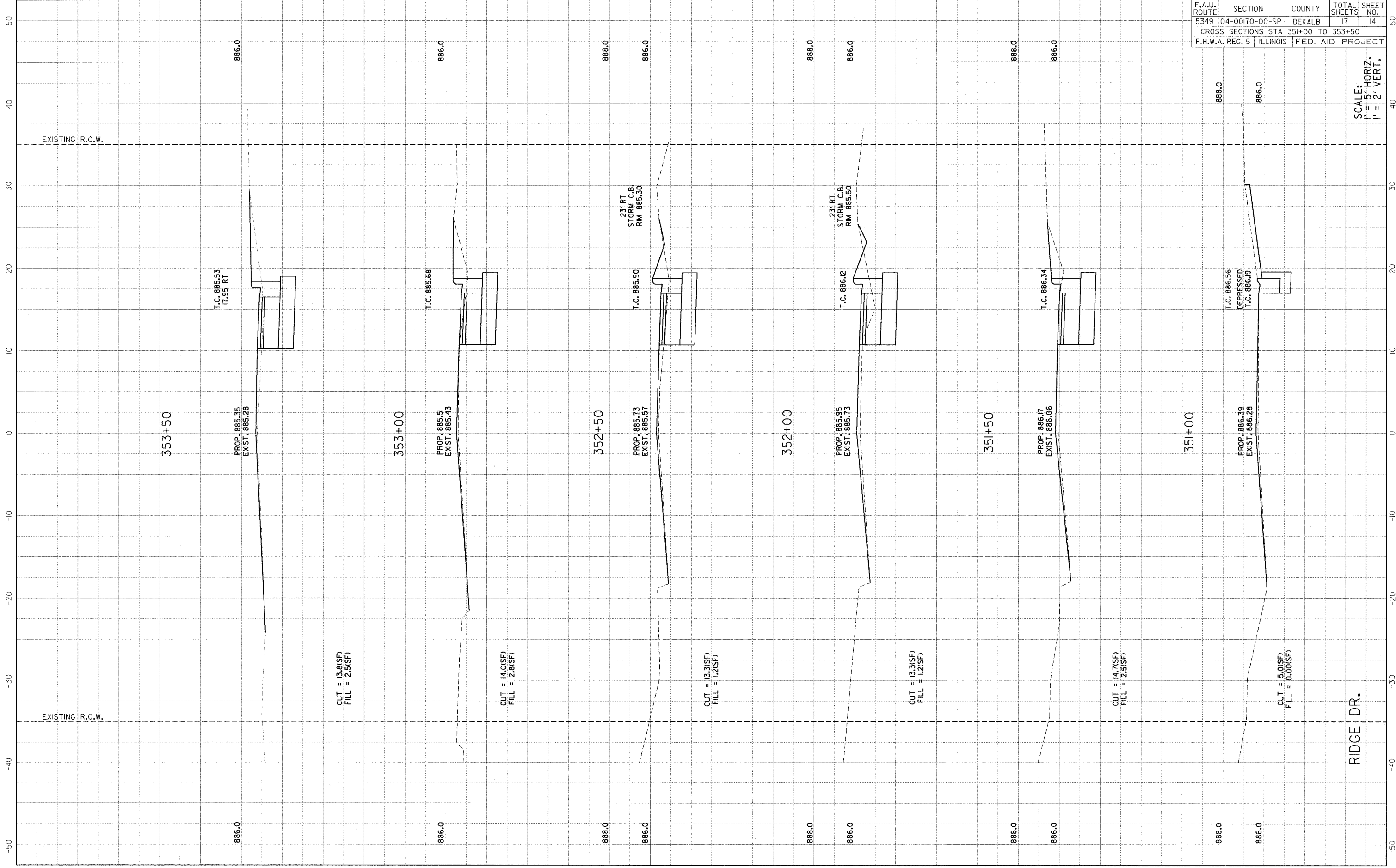

F.A.U. ROUTE	SECTION	COUNTY	TOTAL SHEETS	SHEET NO.
5349	04-00170-00-SP	DEKALB	17	15
CROSS SECTIONS STA 354+00 TO 356+00		F.H.W.A. REG. 5 ILLINOIS FED. AID PROJECT		

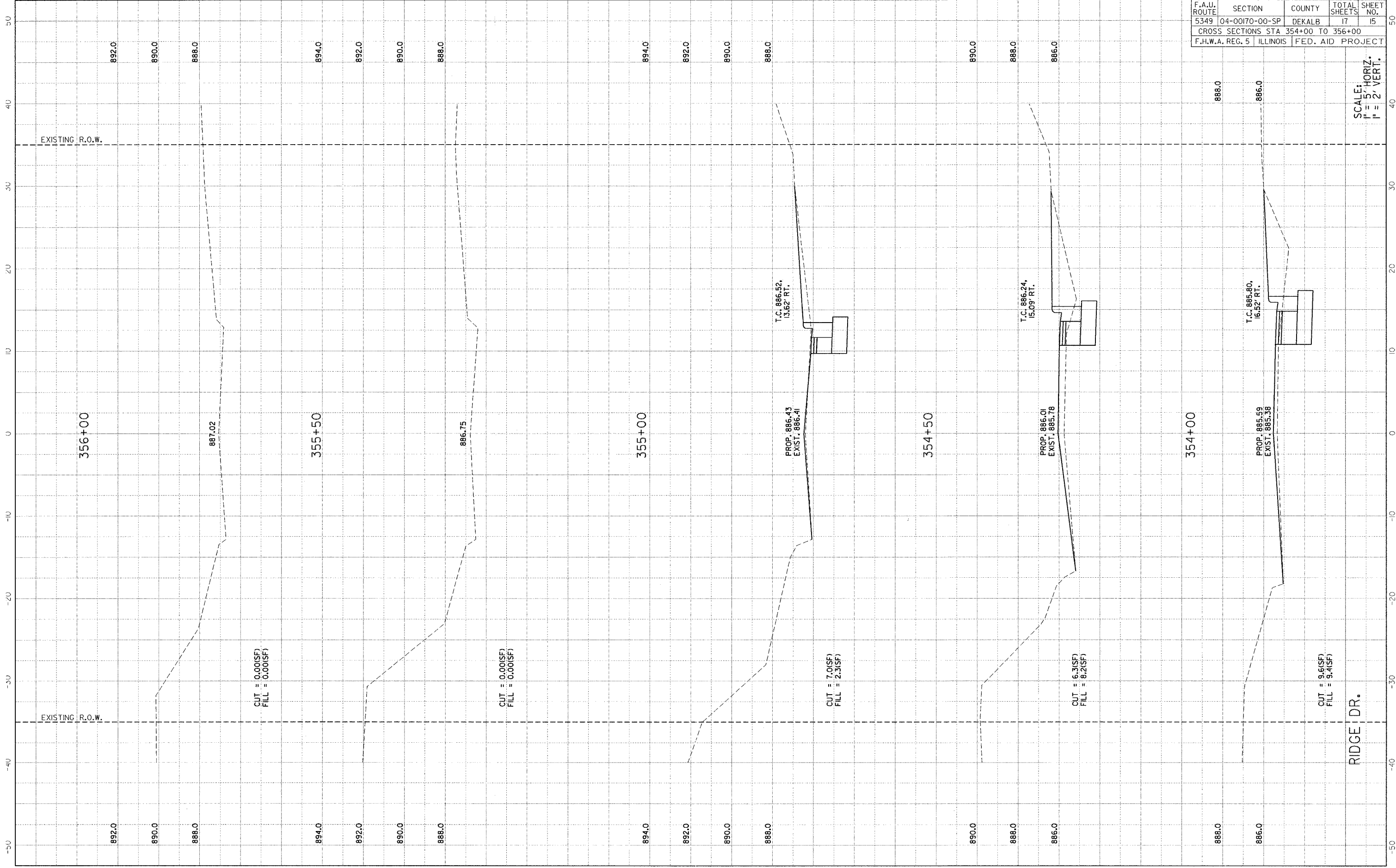

SCALE:  
 1" = 5' HORIZ.  
 1" = 2' VERT.

RIDGE DR.

F.A.U. ROUTE	SECTION	COUNTY	TOTAL SHEETS	SHEET NO.
5349	04-00170-00-SP	DEKALB	17	16
CITY OF DEKALB STANDARD DETAILS				
F.H.W.A. REG. 5 ILLINOIS FED. AID PROJECT				

##- open graded backfill

The height of the box may be constructed 6' short to allow for field adjustments.

X - The wall adjustments shall be made with square adjustments rings of the same dimensions of the structure

The inlet shall be cast in place or precast.

- The top of the structure shall be wrapped with a continuous nonwoven fabric made up of polypropylene fibers (ADS 4420). The fabric shall overlap the lip of the frame by 6' and extend downward 30' below the bottom of the frame.

Class SI concrete or precast concrete shall be used throughout.

optional construction joint

bedding

unless otherwise noted on plans

No. 4 bars at 12 cts.

The side walls may be built as precast segmented sections.

## - The only bedding and backfill material that will be allowed is  $\frac{3}{8}$ " or  $\frac{3}{4}$ " chips or washed concrete stone. The structure shall be backfilled to the height of 2' below the bottom of the casting flange.

All voids around the pipe entrance shall be sealed with mortar on both inside and outside.

Except as noted hereon, inlet special shall be constructed in accordance with section 602 of the standard specifications omitting articles 602.05 and 602.06.

Steps shall be omitted when the depth of the inlet is less than 5 ft.

Holes shall be made for under-drains and/or sump lines per plan locations during precast process.

STANDARD DETAIL FOR CATCH BASIN SPECIAL	REVISIONS 01-02-01 CEW	CITY OF DEKALB STORM SEWER STANDARD SS-203
---	---------------------------	--

### STANDARD DESIGN FRAME AND GRATE TYPE 11

CAST CURB PLATE  
NEENAH SPECIAL R-3281-B OR APPROVED EQUAL IS A STATE TYPE 11 GRATE WITH CURB PLATE REPLACING THE CURB BOX.

BOLT SLOT DETAIL

END VIEW

SECTION

5/8" DIA HOLE AND 5/8" X 5-1/2" SLOT FOR GALVANIZED 1/2" BOLT, NUT AND WASHER

CURB BOX ADJUSTABLE FROM 4-1/2" TO 9"

SECTION A-A

SECTION B-B  
CAST FRAME

HEAVY DUTY  
TOTAL WEIGHT: 485 LBS  
MANUFACTURER OR EQUAL: NEENAH R-3281-A

FOR DRIVEWAY/CROSSWALK APPLICATIONS, USE NEENAH R-3246-1 CURB PLATE

THE CAST GRATE MAY BE MADE OF EITHER GRAY IRON OR DUCTILE IRON CONFORMING TO THE STANDARD SPECIFICATIONS. DUCTILE IRON CASTING SHALL BE GRADE 65-45-12

DIAGONAL BAR GRATE IS REVERSIBLE FOR RIGHT OR LEFT HAND FLOW

SECTION C-C  
CAST GRATE  
TYPE R

STANDARD DETAIL FOR BARRIER CURB FRAME AND GRATE (STATE TYPE 11)	REVISIONS 2/13/04 RBR	CITY OF DEKALB STORM SEWER STANDARD SS-206
--	--------------------------	--

5" SIDEWALK 7" P.C.C. SIDEWALK (SEE NOTE BELOW) 5" SIDEWALK

TOOLED JOINT

2' CURB TRANSITION TYPICAL (ONLY USED WITH BARRIER TYPE CURB)

PORTLAND CEMENT CONCRETE COMBINATION CURB AND GUTTER

NOTE: SIDEWALK REPLACED THROUGH DRIVEWAY SHALL BE 7" THICK

3/4" EXPANSION JOINT FILLER CONFORMING TO AASHTO STANDARD M-213 PLACED ONLY AT SIDEWALK SIDE OF APPROACH

7" P.C.C. DRIVEWAY PAVEMENT WITH REINFORCING WIRE FABRIC OR FIBRE REINFORCING ADMIXTURE

2% - 10%

1/4" / FT SLOPE

7" SIDEWALK

#4 REBAR 5' O/C

3" COMPACTED SUBBASE

12" MINIMUM WIDTH OVER EXCAVATION BEHIND CURB TO BE FILLED FULL DEPTH WITH CONCRETE

SEC A-A

SEC B-B

STANDARD DETAIL FOR P.C.C. DRIVEWAYS	REVISIONS 04/25/03 RBR	CITY OF DEKALB STREET STANDARD ST-104
--------------------------------------	---------------------------	---



F.A.U. ROUTE	SECTION	COUNTY	TOTAL SHEETS	SHEET NO.
5349	04-00170-00-SP	DEKALB	17	17
CITY OF DEKALB STANDARD DETAILS				
F.H.W.A. REG. 5 ILLINOIS			FED. AID PROJECT	

