

① BY HANSON 06/03/05	F.A. RT. NO.	SECTION	COUNTY	TOTAL SHEET NO.
		04-00001-00-PV	DEKALB	43
		STA. 53+07.15	TO STA. 57+00.00	9
	FED. ROAD DIST. NO.	ILLINOIS FED. AID PROJECT		

PIPE NO.	U/S-D/S	LENGTH (FT)	SIZE (INCH)	CLASS/TYPE	U/S INV.	D/S INV.	SLOPE (%)	TB CU YD
9	11-12	25	30	A/2	871.68	871.61	0.3	5.8
9A	9A-9	30	12	A/2	873.30	873.21	0.3	5.2
10	12-14	25	30	A/2	871.51	871.34	0.7	16.5
11	14-EXIST.	82	18	A/2	873.89	873.48	0.5	9.5
12	13-14	25	12	A/2	872.04	871.84	0.8	8.5
13	19-14	314	36	A/2	873.60	871.34	0.7	0.0
14	15-19	25	12	A/2	874.08	873.88	0.8	19.5
15	16-17	52	36	A/2	874.00	873.84	0.3	0.0
16	17-18	25	36	A/2	873.84	873.77	0.3	13.4
17	18-19	25	36	A/2	873.77	873.70	0.3	22.9

STR. NO.	STATION	OFFSET	TYPE	F & G	*RIM EL.	INV. N	INV. S	INV. E	INV. W
9A	51+20.14	42.04' RT	CATCH BASIN TYPE C	TYPE 8	876.50	--	873.30	--	--
11	53+55.76	50.00' LT	MANHOLE TYPE A	TYPE 1-CL	877.41	871.68	871.78	--	--
12	53+55.76	25.00' LT	CATCH BASIN TYPE A	TYPE 3	876.72	871.51	871.61	--	--
13	53+55.76	25.00' RT	INLET TYPE A	TYPE 3	876.72	--	872.04	--	--
14	53+55.76	0.00	MANHOLE TYPE A, 6'	TYPE 1-CL	878.18	871.84	871.34	873.89	871.34
15	56+70.00	25.00' LT	CATCH BASIN TYPE C	TYPE 3	880.22	874.08	--	--	--
16	56+70.00	102.06' RT	36" END SECTION	--	--	874.00	874.00	--	--
17	56+70.00	50.00' RT	MANHOLE TYPE A	TYPE 1-CL	881.16	873.84	873.84	--	--
18	56+70.00	25.00' RT	CATCH BASIN TYPE A	TYPE 3	880.22	873.77	873.77	--	--
19	56+70.00	0.00	MANHOLE TYPE A, 6'	TYPE 1-CL	881.69	873.70	873.88	873.60	--

* FOR TYPE 3 F&G, RIM EL. IS GIVEN AT EOP

NOTE: SEE INTERSECTION DETAIL SHEETS FOR LAYOUT AND DIMENSIONS OF CROSS ROAD INTERSECTIONS.
SEE SANITARY AND WATER MAIN PLAN FOR FURTHER DETAILS.

HANSON Professional Services Inc.
 Copyright Hanson Professional Services, Inc. 2005

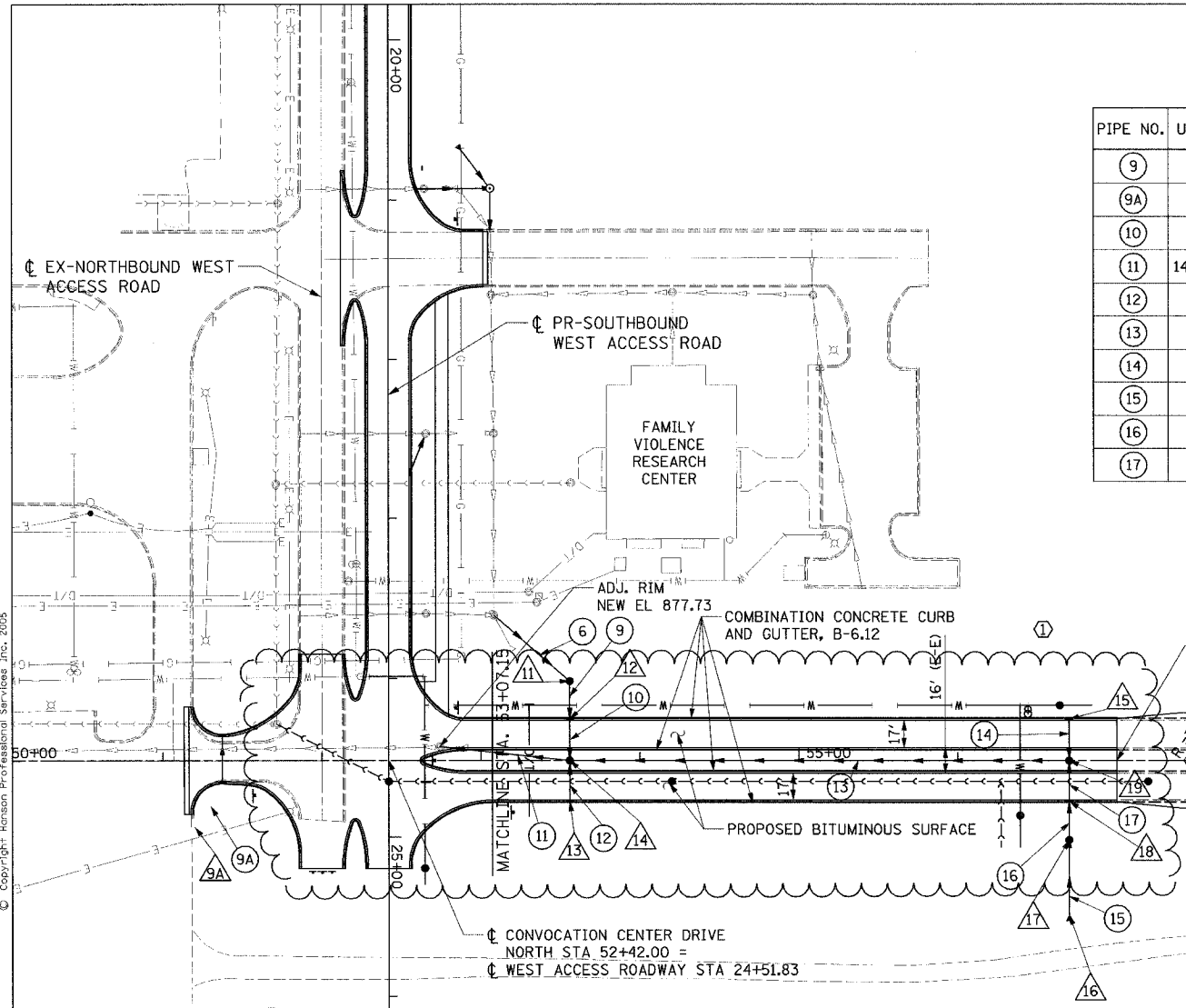

STA. 57+00.00
SEE CONVOCATION CENTER DRIVE NORTH CUL-DE-SAC DETAIL FOR CONSTRUCTION DETAILS.

CONVOCATION CENTER DRIVE NORTH

FUTURE CONSTRUCTION BY OTHERS

FUTURE CONSTRUCTION BY OTHERS

EXISTING DIRT ACCESS ROAD

