

F.A. RTE.	SECTION	COUNTY	TOTAL SHEETS	SHEET NO.
04-00001-00-PV	DEKALB	43	23	
STA.	TO STA.			
FED. ROAD DIST. NO.	ILLINOIS	FED. AID PROJECT		

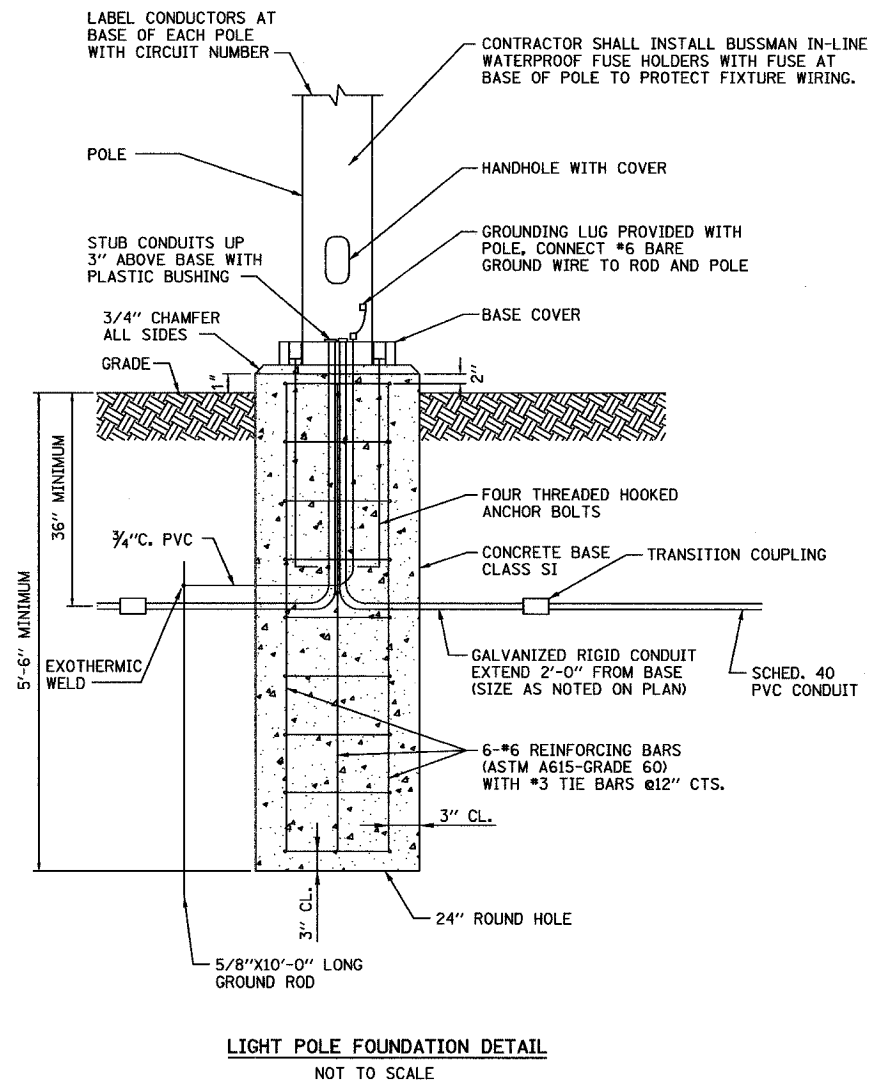

LIGHTING FIXTURE SCHEDULE						
FIXT. TYPE	DESCRIPTION	MANUFACTURER & CAT. NO.	LAMPS/WATTS	VOLTS	MOUNTING	REMARKS
F1	POLE MOUNTED MH ARCHITECTURAL ROADWAY LUMINAIRE, HEAVY GAUGE EXTRUDED ALUMINUM 25" DIA. ROUND HOUSING, FULLY GASKETED FOR WEATHER AND BUG TIGHTNESS, BAKED ON POLYESTER POWDER COAT FINISH, ANODIZED ALUMINUM IES TYPE III SEMI-CUTOFF OPTICS, CLEAR TEMPERED GLASS LENS, HORIZONTALLY MOUNTED MEDIUM BASE PORCELAIN SOCKET, HPF CWA TYPE BALLAST, DARK BRONZE PAINT FINISH.	KIM; 1A-CC25A3-400MH-DBP/KRS20-5180-DBP	1-400W MH ANSI CODE NO. M59 460 TOTAL INPUT WATTS	277	MOUNTED ON A 20'-0" ROUND NONTAPERED STEEL POLE	SUPPLY A 100 MPH RATED POLE AT 200% OF THE RATED EPA OF THE FIXTURE PROVIDED. SPECIFIED FIXTURE EPA RATING EQUALS 1.5 SQ FT EACH
F2	EXISTING RELOCATED ROADWAY LUMINAIRE. PROVIDE POLE WITH PLATINUM SILVER FINISH PAINT.	KIM; 1A-CC25A3-400MH-PSP (EXISTING) POLE - KRS20-5180-PSP	1-400W MH ANSI CODE NO. M59 460 TOTAL INPUT WATTS	277	MOUNTED ON A 20'-0" ROUND NONTAPERED STEEL POLE	SUPPLY A 100 MPH RATED POLE AT 200% OF THE RATED EPA OF THE FIXTURE PROVIDED. SPECIFIED FIXTURE EPA RATING EQUALS 1.5 SQ FT EACH

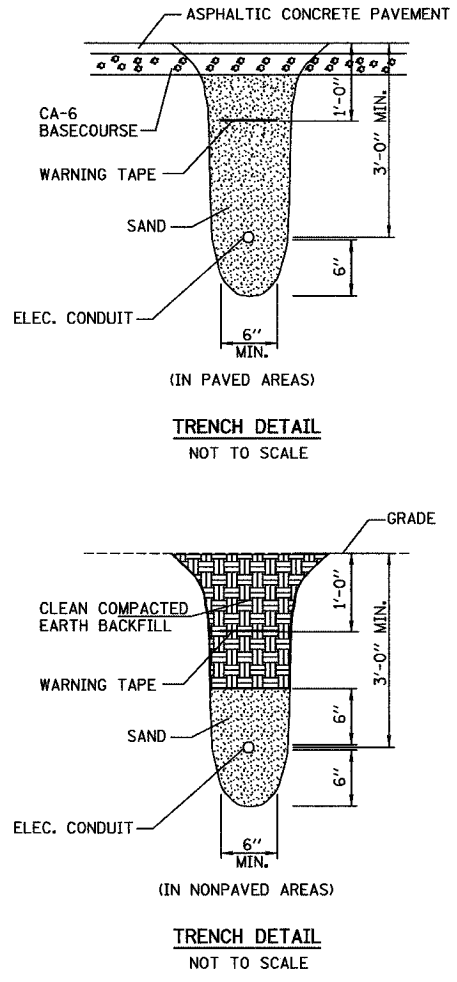
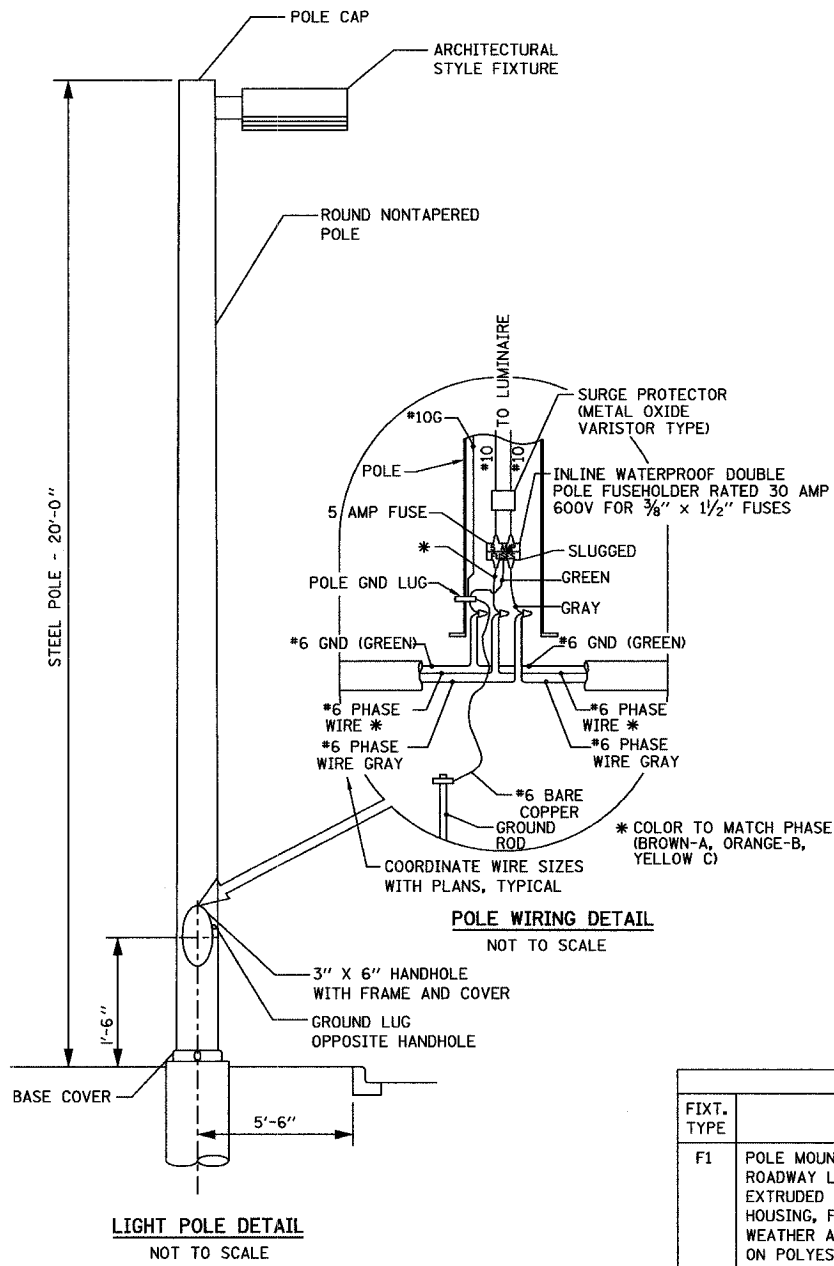
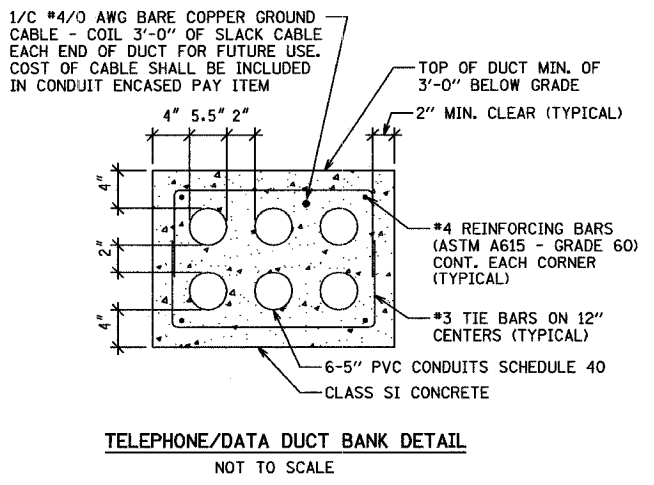

REVISIONS		ILLINOIS DEPARTMENT OF TRANSPORTATION SECTION 04-00001-00-PV DEKALB COUNTY NORTHERN ILLINOIS UNIVERSITY WEST ACCESS ROAD <b>ROADWAY LIGHTING ELECTRICAL DETAILS</b>
NAME	DATE	
		SCALE: VERT. 1"=50'-0" HORIZ. DATE 04/05/05 DRAWN BY ANC CHECKED BY PJT

**HANSON**  
 Hanson Professional Services Inc.  
 Copyright Hanson Professional Services Inc. 2005

LAYOUT	PJT	
DRAWN	ANC	04/14/2005
REVIEWED	PJT	04/05/05