

F.A.P. RTE.	SECTION	COUNTY	TOTAL SHEETS	SHEET NO.
317	***	FULTON	684	56
STA.	TO STA.			
FED. ROAD DIST. NO.	ILLINOIS	FED. AID PROJECT		
*** 181,18BRY&18BRY-1BR,18B-1				

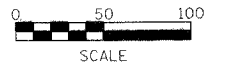

REMOVAL LEGEND

① PAVEMENT REMOVAL		⑨ CONCRETE HEADWALL REMOVAL	
② STRUCTURE REMOVAL		⑩ REMOVE EXISTING CULVERTS	
③ BITUMINOUS SURFACE REMOVAL - BUTT JOINT		⑪ FENCE REMOVAL	
④ GUARDRAIL REMOVAL		⑫ DRIVEWAY PAVEMENT REMOVAL	
⑤ BUILDING REMOVAL		⑬ REMOVE EXISTING INLET	
⑥ REMOVAL INCLUDED IN EARTH EXCAVATION		⑭ CURB AND GUTTER REMOVAL	
⑦ TREE REMOVAL (UNIT)		⑮ ISLAND REMOVAL	
⑧ TREE REMOVAL (ACRES)		⑯ UNDERGROUND STORAGE TANK REMOVAL	

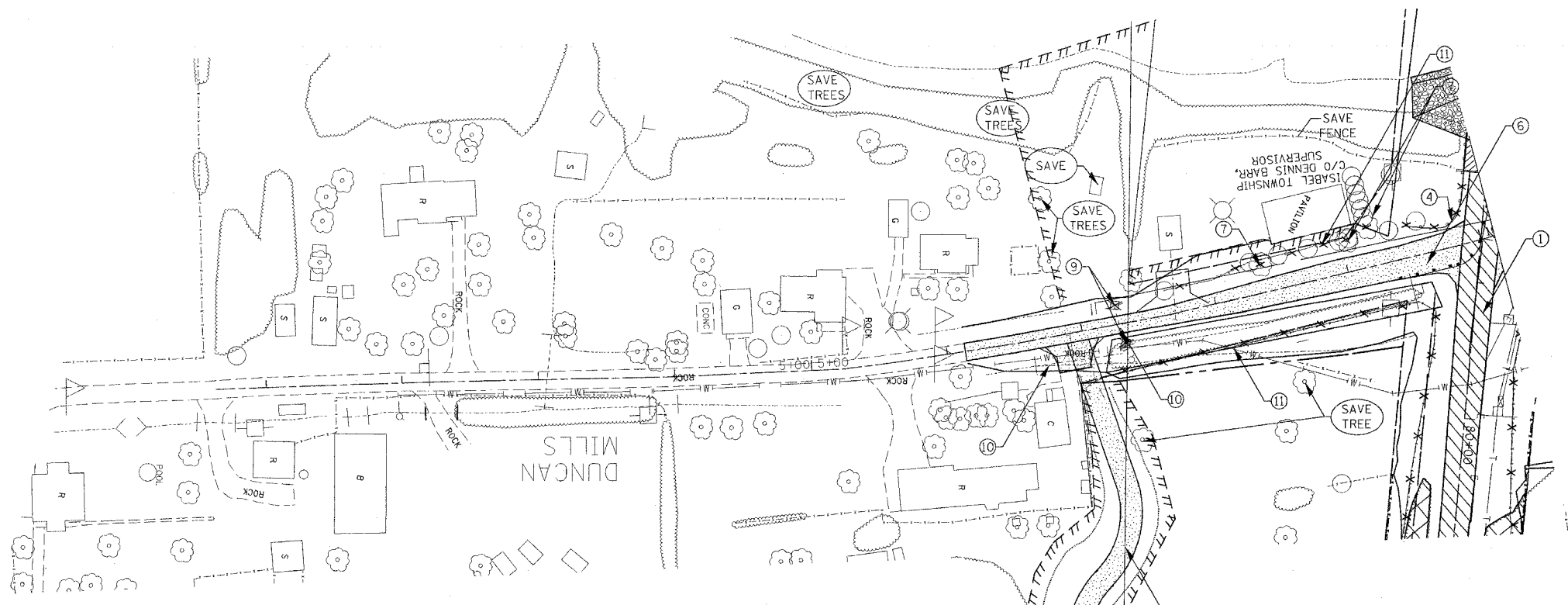
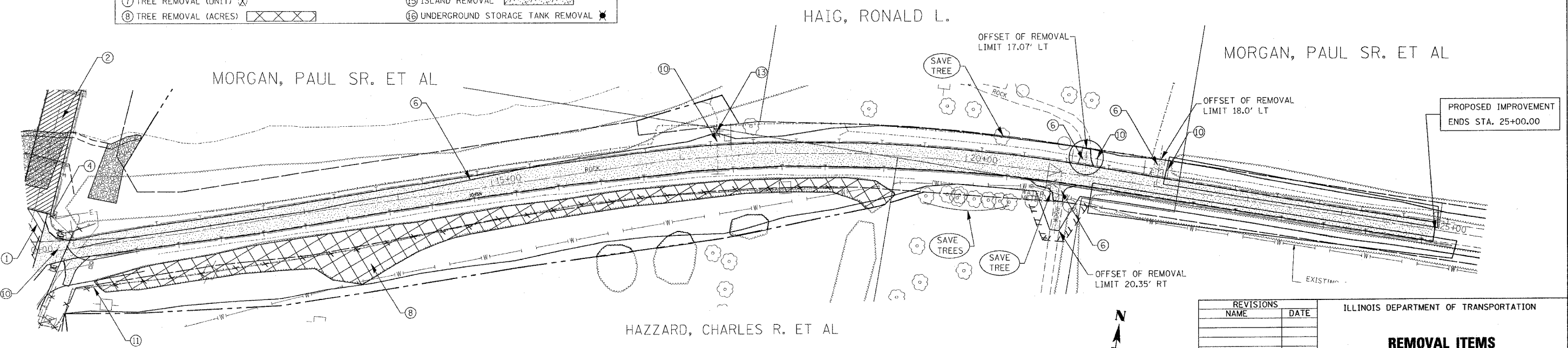

REVISIONS	
NAME	DATE

ILLINOIS DEPARTMENT OF TRANSPORTATION

**REMOVAL ITEMS
COUNTY HIGHWAY 11**

SCALE: VERT. _____
HORIZ. _____

DATE _____

DRAWN BY _____
CHECKED BY _____

PLOT DATE = 4/7/2005
 FILE NAME = I:\projects\181\18BRY\18BRY-1BR\18B-1\18B-1.dwg
 USER NAME = haggard