

F.A.P. RTE.	SECTION	COUNTY	TOTAL SHEETS	SHEET NO.
317	***	FULTON	604	71
STA.		TO STA.		
FED. ROAD DIST. NO.		ILLINOIS		FED. AID PROJECT
***181,(18BRY&18BRY)-D8R,18B-1				

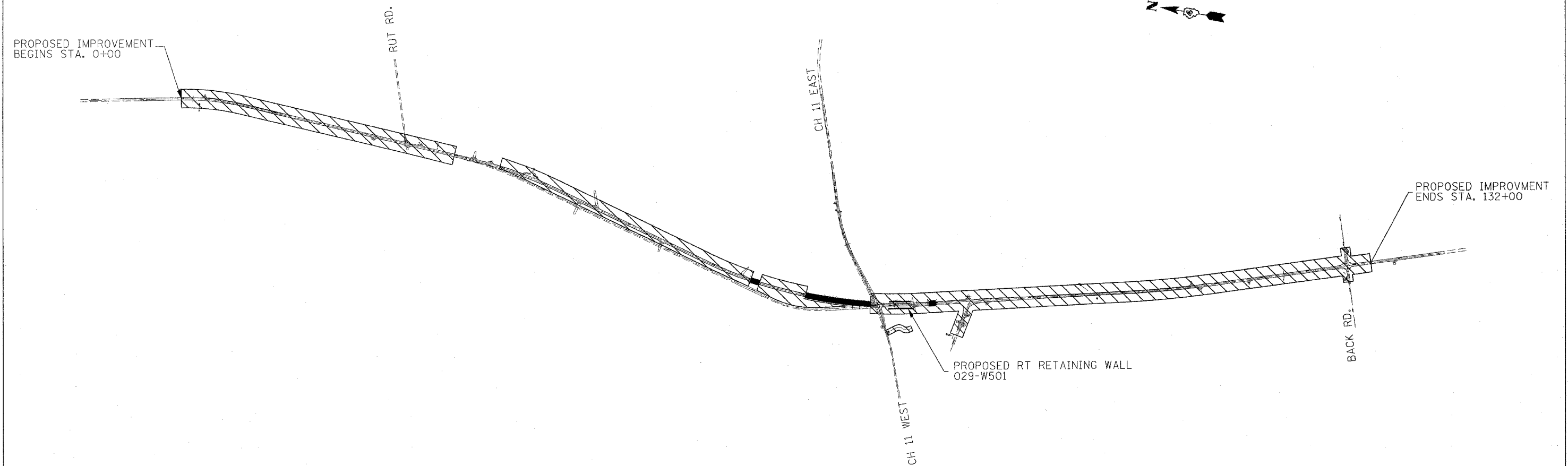

STAGE I

TRAFFIC

TRAFFIC ON EXISTING US24

CONSTRUCTION

- EARTH EXCAVATION AT NORTH & SOUTH ENDS OF THE JOB, DRAINAGE, EROSION CONTROL
- EARTHWORK FOR THE NEW ALIGNMENT
- EARTHWORK FOR DETOUR RUNAROUND AND TEMPORARY STRUCTURE
- COMPLETE RIGHT RETAINING WALL
- LIDWELL AND HAZZARD'S ACCESS DRIVEWAYS
- COMPLETE BEAM REPLACEMENTS ON EXISTING SPOON RIVER STRUCTURE - STAGE IA & IB
- EARTHWORK FOR TEMPORARY CROSSOVER BETWEEN NEW ALIGNMENT AND EXISTING US24
- COMPLETE TEMPORARY HAUL ROAD
- COMPLETE OVERHEAD LIGHTING AT US 24/US 136 INTERSECTION

REVISIONS	
NAME	DATE

ILLINOIS DEPARTMENT OF TRANSPORTATION

STAGE I OVERVIEW

SCALE: VERT. / HORIZ. DATE

DRAWN BY / CHECKED BY

PLOT DATE = 4/7/2005
 FILE NAME = c:\p\projects\us24\spoon.ph\2\stage1\stage1.dgn
 PLOT SCALE = 30.0000 / IN.
 USER NAME = jmg