

F.A.P. RTE.	SECTION	COUNTY	TOTAL SHEETS	SHEET NO.
317	***	FULTON	684	79
STA.		TO STA.		
FED. ROAD DIST. NO.		ILLINOIS FED. AID PROJECT		
***181,18BRY&18BRY-1)BR,18B-1				

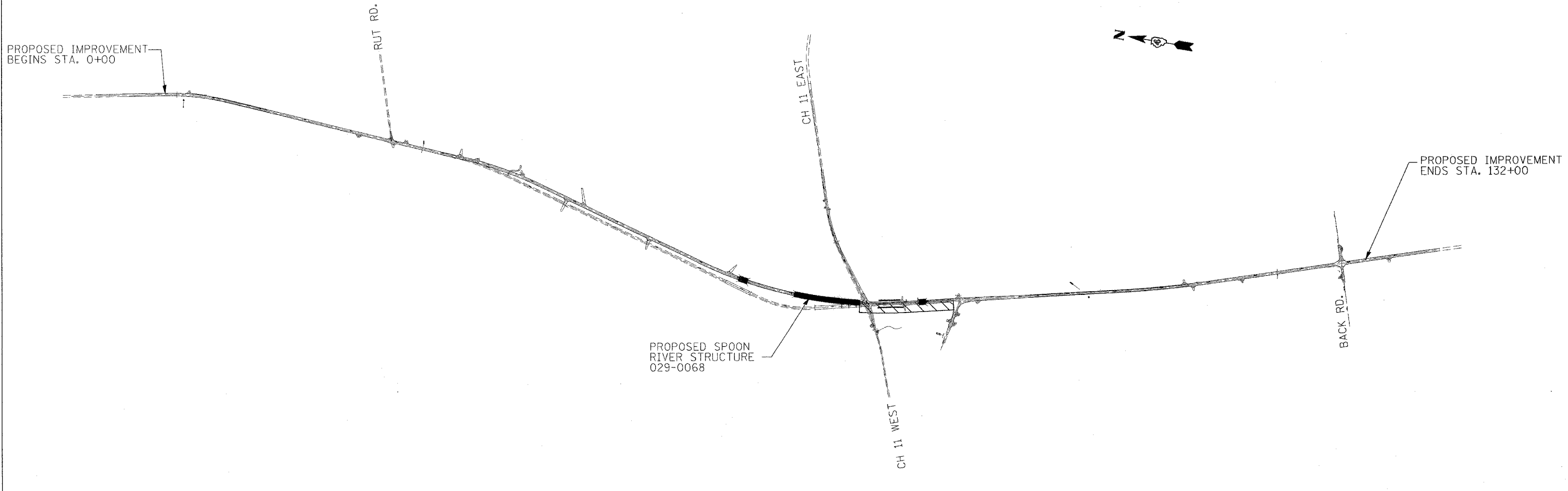

STAGE IV

TRAFFIC

NORTH BOUND LANE IS ON THE NEW ALIGNMENT

SOUTH BOUND LANE IS ON THE EXISTING US24 AND ON THE DETOUR RUN-A-ROUND IN THE DUNCAN MILLS AREA

CONSTRUCTION

SOUTH BOUND LANE BETWEEN PROPOSED SPOON RIVER AND THE 136 INTERSECTION

COMPLETE SPOON RIVER TRIBUTARY STRUCTURE

REVISIONS	
NAME	DATE

ILLINOIS DEPARTMENT OF TRANSPORTATION

STAGE IV OVERVIEW

SCALE: VERT. / HORIZ.
DATE

DRAWN BY / CHECKED BY