

F.A.P. RTE.	SECTION	COUNTY	TOTAL SHEETS	SHEET NO.
317	...	FULTON	684	82
STA.	TO STA.			
FED. ROAD DIST. NO.	ILLINOIS	FED. AID PROJECT		
...181,18BRY&18BRY-1BR,18B-1				

STAGE V CONSTRUCTION

STAGE V TRAFFIC CONTROL

REMOVE TEMPORARY CONCRETE BARRIER AND RECONFIGURE TRAFFIC SIGNALS BETWEEN STA 30+00 AND 38+50

US STD 701306 AND 701006 AS NEEDED PAID FOR AS "TC&P STD 701306" - L SUM

REMOVE DETOUR RUNAROUND AND CONSTRUCT BITUMINOUS SHOULDER BETWEEN RT STA 82+00 TO 88+00.

UTILIZE STD 701311 FOR STRIPING

PERFORM 1/4" COLD MILLING

RECONSTRUCT CH-11 WEST, REMOVE AND REPLACE EXISTING PAVEMENT FROM RT STA 30+00 TO 34+50.

PLACE STRIP REFLECTIVE CRACK CONTROL;

PLACE 2 1/4" BINDER COURSE AND FINAL SURFACE COURSE.

COMPLETE GUARDRAIL INSTALLATION

PLACE TOP LIFT OF AGG SHOULDER,

COMPLETE EMBANKMENT FROM RT STA 30+00 TO 70+60,

REMOVE EXISTING PAVEMENT AND SPOON RIVER STRUCTURE

PERFORM FINAL PAVEMENT MARKINGS AND RAISED REFLECTIVE PAVEMENT MARKERS

BUILD RT WINGWALLS FOR TRIBUTARY STRUCTURE

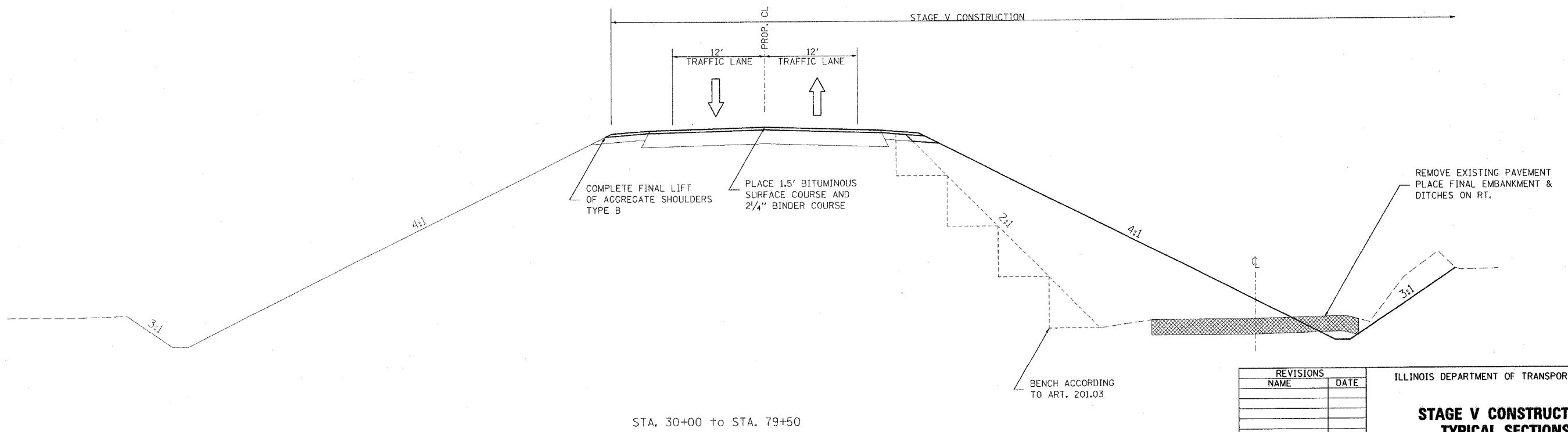
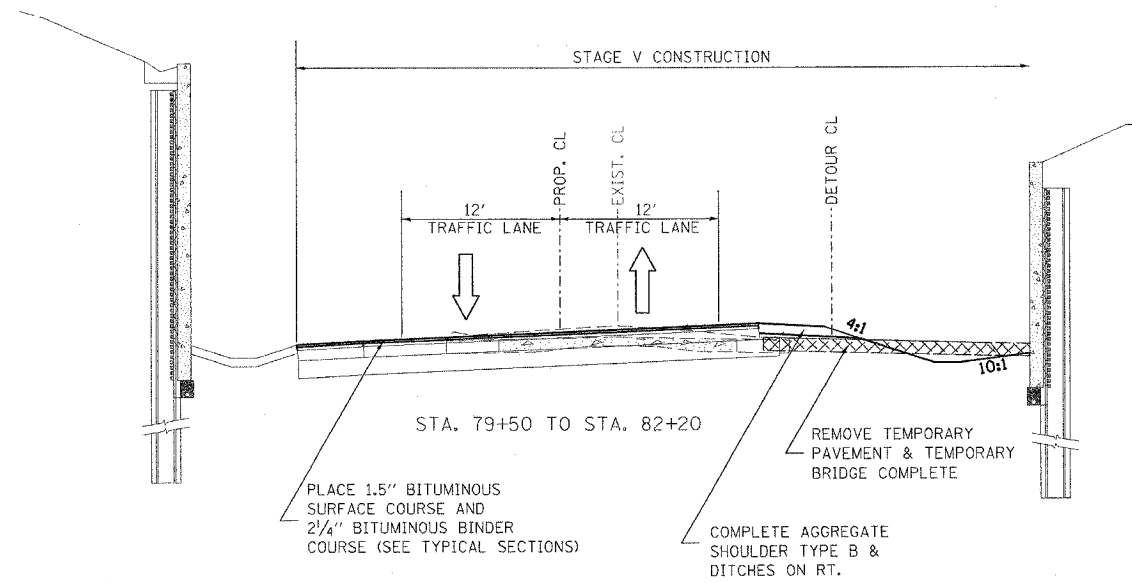

REVISIONS	
NAME	DATE

ILLINOIS DEPARTMENT OF TRANSPORTATION

**STAGE V CONSTRUCTION  
TYPICAL SECTIONS**

SCALE: VERT.  
HORIZ.  
DATE

DRAWN BY  
CHECKED BY

PLOT DATE = 4/7/2005  
FILE NAME = c:\projects\124\spoon\_rh\_2\stageing\typicals.dgn  
PLOT SCALE = 50.0000' / 1" IN.  
USER NAME = hoggiemd