

F.A. RTE.	SECTION	COUNTY	TOTAL SHEETS	SHEET NO.
317	***	FULTON	684	84
STA. 12+00		TO STA. 32+00		
FED. ROAD DIST. NO.	ILLINOIS	FED. AID PROJECT		
*** 181(18BRY&18BRY-1)BR,18B-1 CONTRACT# 88753				

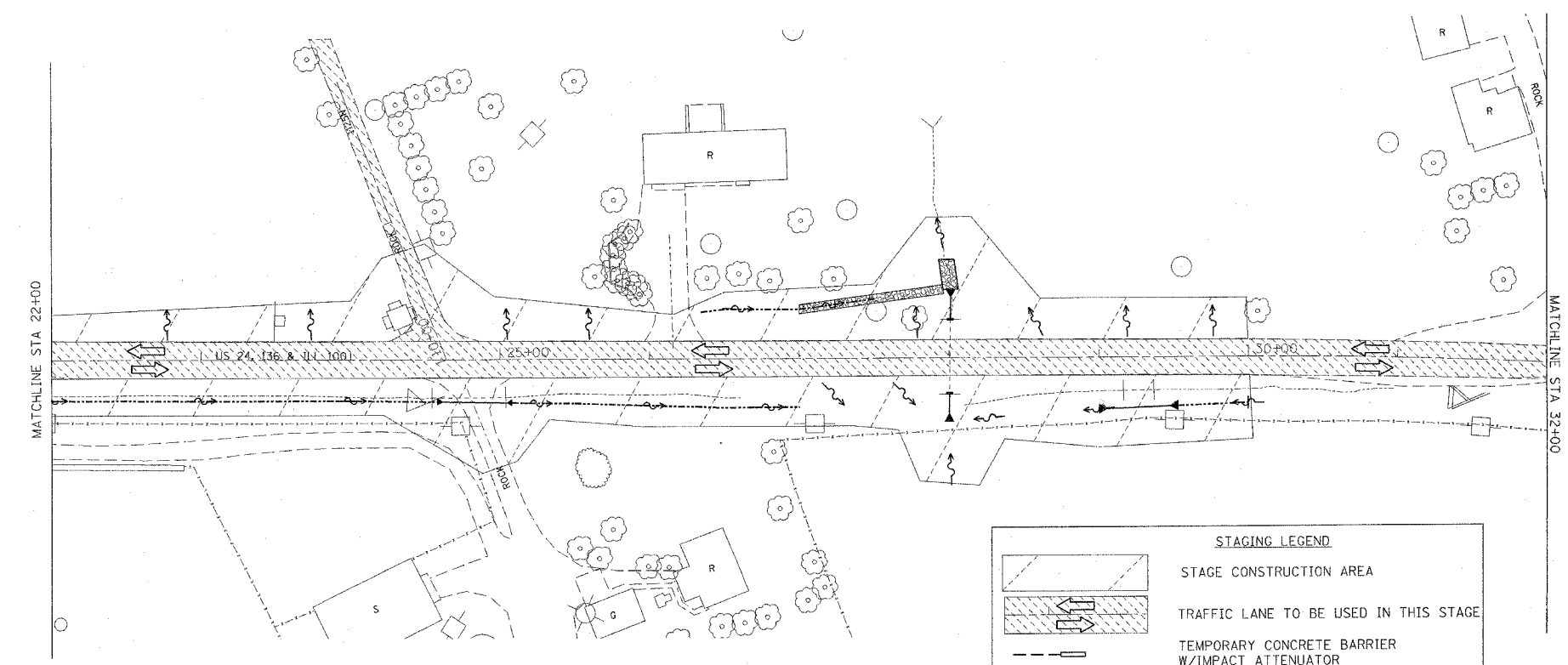
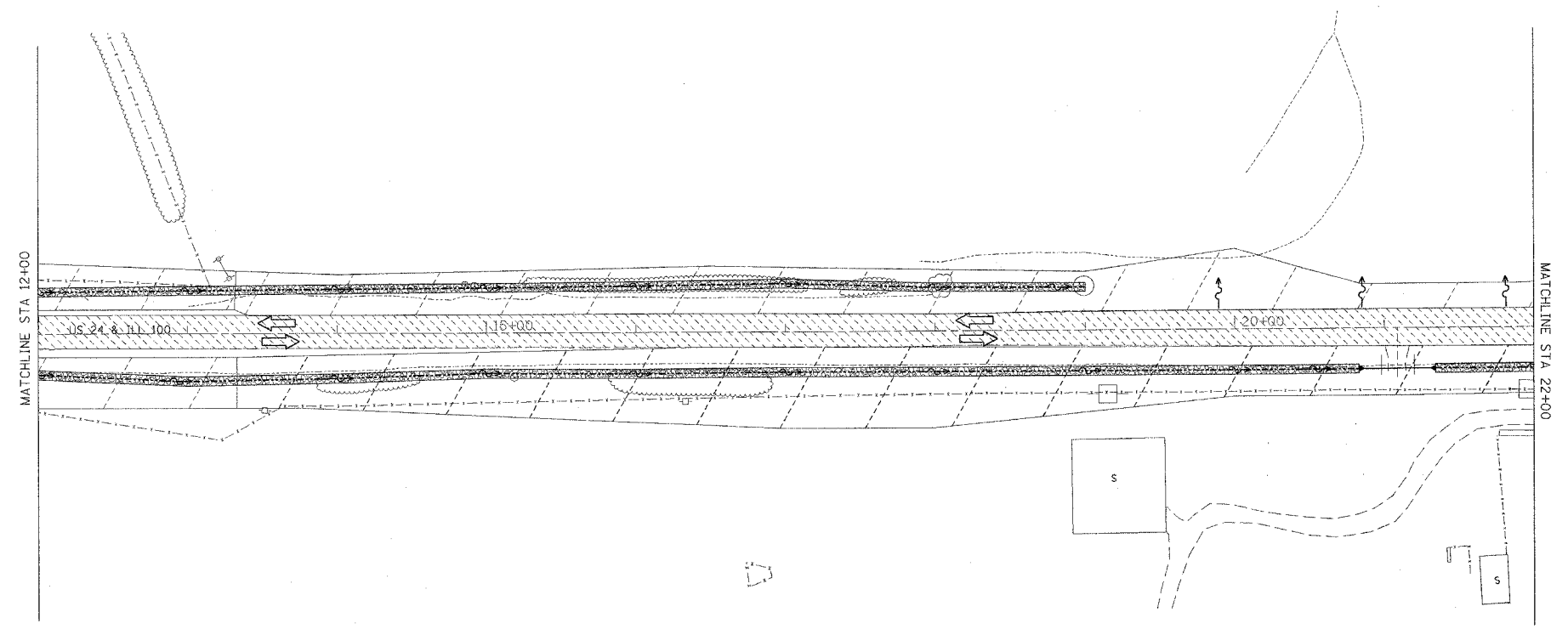

STAGING LEGEND	
	STAGE CONSTRUCTION AREA
	TRAFFIC LANE TO BE USED IN THIS STAGE
	TEMPORARY CONCRETE BARRIER W/IMPACT ATTENUATOR
	PORTABLE TEMPORARY BARRIER SYSTEM

REVISIONS	
NAME	DATE

ILLINOIS DEPARTMENT OF TRANSPORTATION

**US 24 STAGING PLANS
STAGE I
STA 12+00 TO 32+00**

SCALE: VERT. _____
HORIZ. _____

DATE **DATE**

DRAWN BY _____
CHECKED BY _____

PLOT DATE = 4/7/2005
FILE NAME = c:\projects\us24staging\us24staging\stage1\st1.dgn
PLOT SCALE = 1"=50'
REFERENCE = 88753
DGN-ONLY