

F.A. RTE. 315/317	SECTION ***	COUNTY FULTON	TOTAL SHEETS 684	SHEET NO. 89
STA. 90+00		TO STA. 120+00		
FED. ROAD DIST. NO.	ILLINOIS FED. AID PROJECT			
*** 181,18BRY&18BRY-1)BR,18B-1 CONTRACT# 88753				

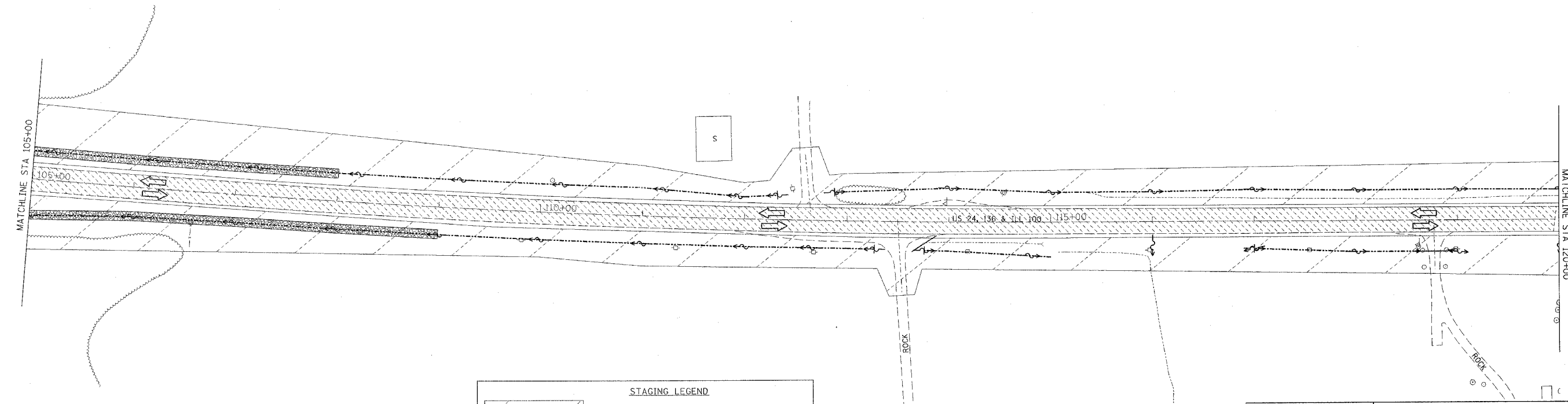

STAGING LEGEND	
	STAGE CONSTRUCTION AREA
	TRAFFIC LANE TO BE USED IN THIS STAGE
	TEMPORARY CONCRETE BARRIER W/IMPACT ATTENUATOR
	PORTABLE TEMPORARY BARRIER SYSTEM

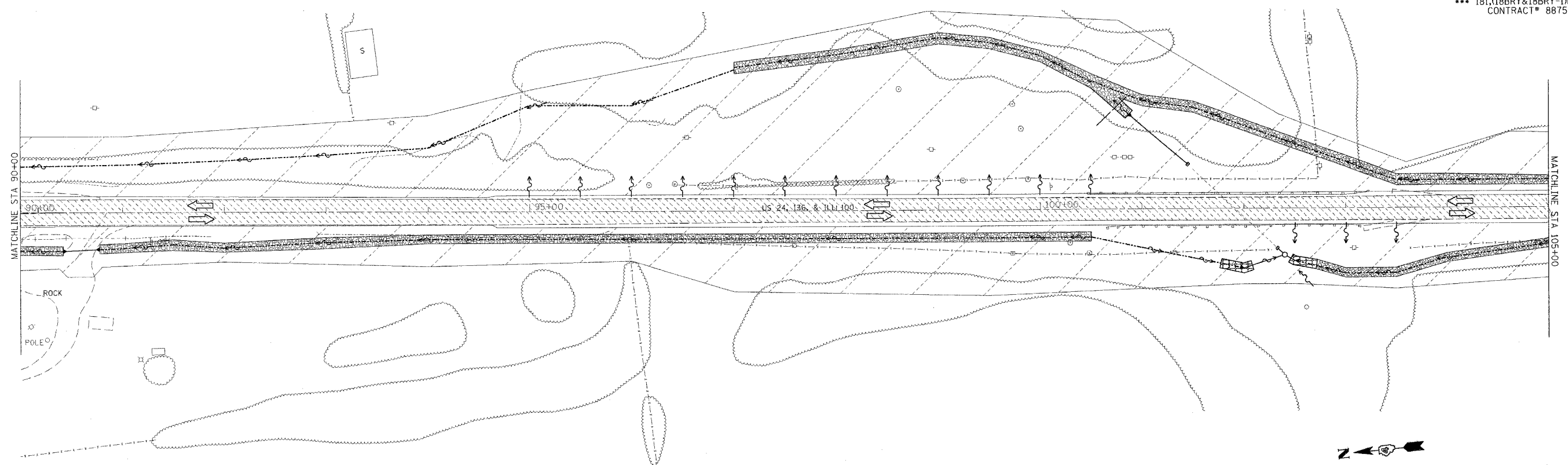

REVISIONS	
NAME	DATE

ILLINOIS DEPARTMENT OF TRANSPORTATION

**US 24 STAGING PLANS
STAGE I
STA 90+00 TO 120+00**

SCALE: VERT. _____
HORIZ. _____
DATE **DATE**

DRAWN BY _____
CHECKED BY _____

DDN-DNL*