

F.A. RTE.	SECTION	COUNTY	TOTAL SHEETS	SHEET NO.
317	***	FULTON	684	94
STA. 76+00	TO STA. 81+00			
FED. ROAD DIST. NO.	ILLINOIS FED. AID PROJECT			
*** 181,188BRY&188BRY-118R,188-1				
CONTRACT# 88753				

NOTES:

THE CONTRACTOR SHALL INSTALL TWO MICROWAVE SENSORS AND TWO ADDITIONAL SIGNAL HEADS ON WOOD POLES TO CONTROL TRAFFIC ON COUNTY HIGHWAY 11 WEST AND EAST. SEE THE SPECIAL PROVISION FOR TEMPORARY BRIDGE TRAFFIC SIGNALS.

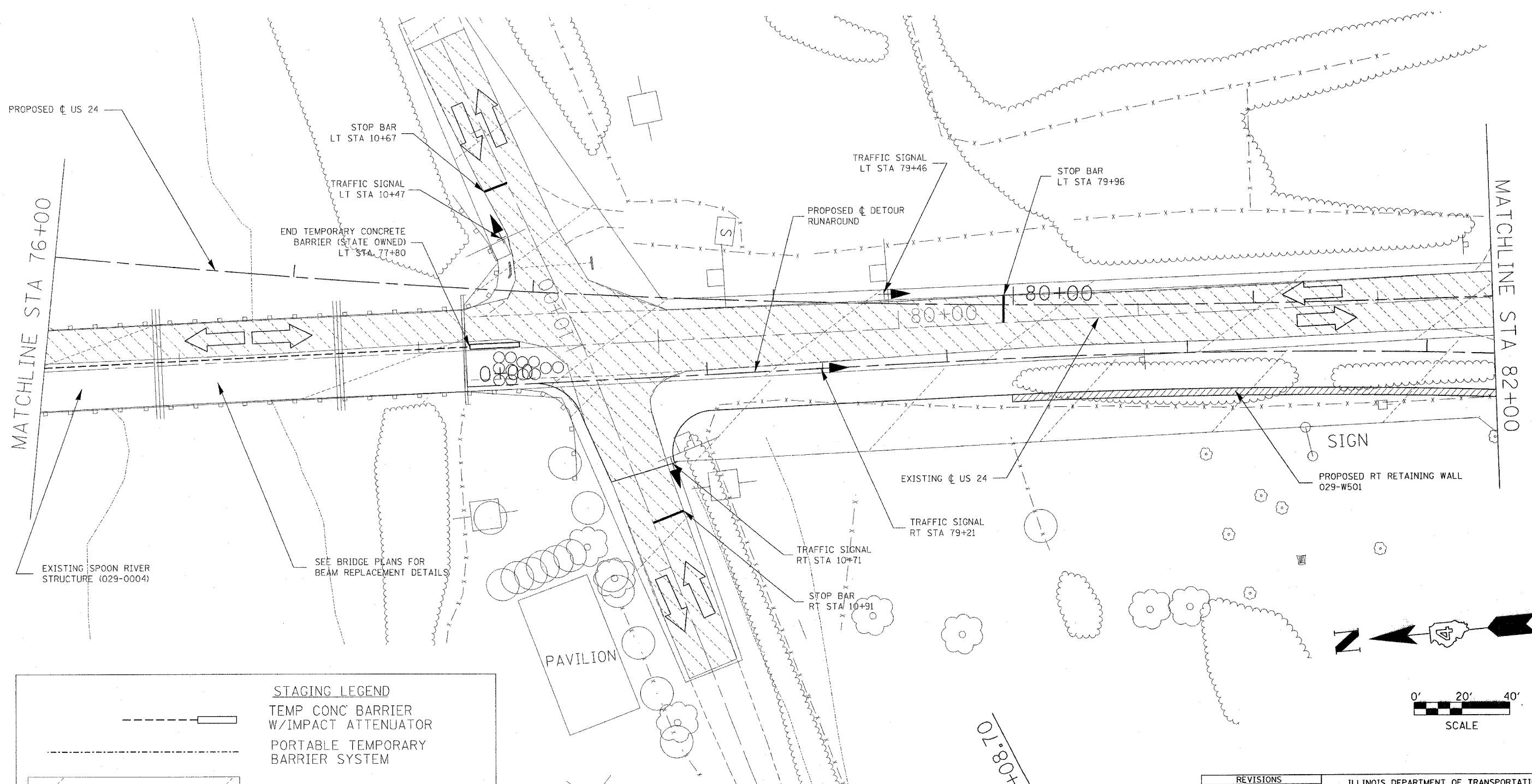

STAGING LEGEND	
	TEMP CONC BARRIER W/IMPACT ATTENUATOR
	PORTABLE TEMPORARY BARRIER SYSTEM
	STAGE CONSTRUCTION AREA
	TRAFFIC LANE

REVISIONS	
NAME	DATE

ILLINOIS DEPARTMENT OF TRANSPORTATION
 US 24 STAGING PLANS
 STAGE IA
 STA 76+00 TO 82+00
 SCALE: VERT. _____
 HORIZ. _____
 DATE **DATE**
 DRAWN BY _____
 CHECKED BY _____

PLOT DATE = 4/7/2005
 PLOT SCALE = 20,000/1 IN.
 REFERENCE = **REF**