

CONTRACT NO. 88753			
F.A.P. RTE.	SECTION	COUNTY	TOTAL SHEETS
317	***	FULTON	684
NO.			108
STA.	TO STA.		
FED. ROAD DIST. NO.	ILLINOIS FED. AID PROJECT		
	*** 181,118BRY&18BRY-11BR,18B-1		

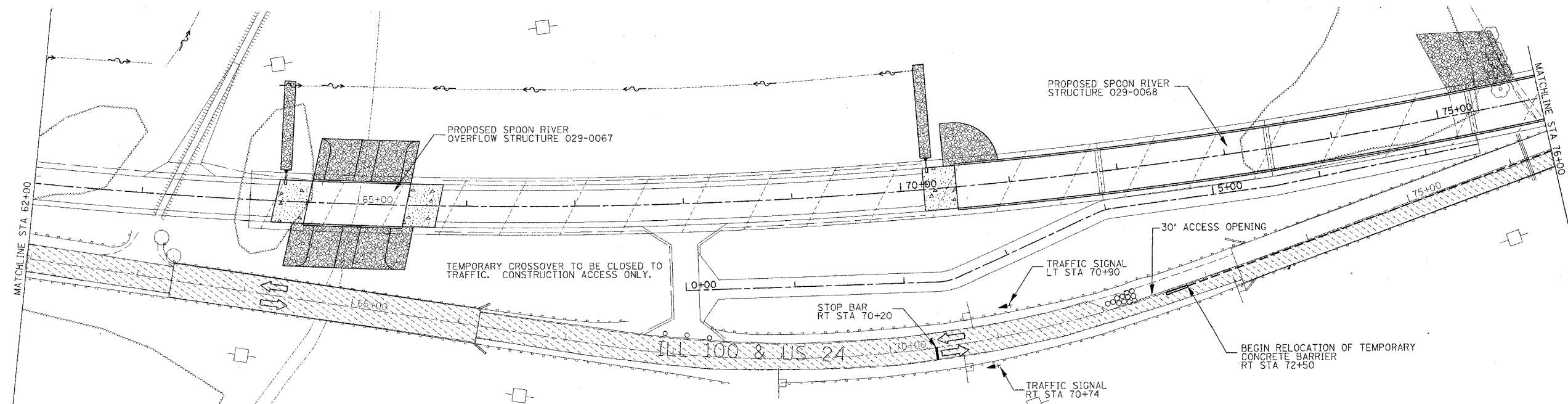
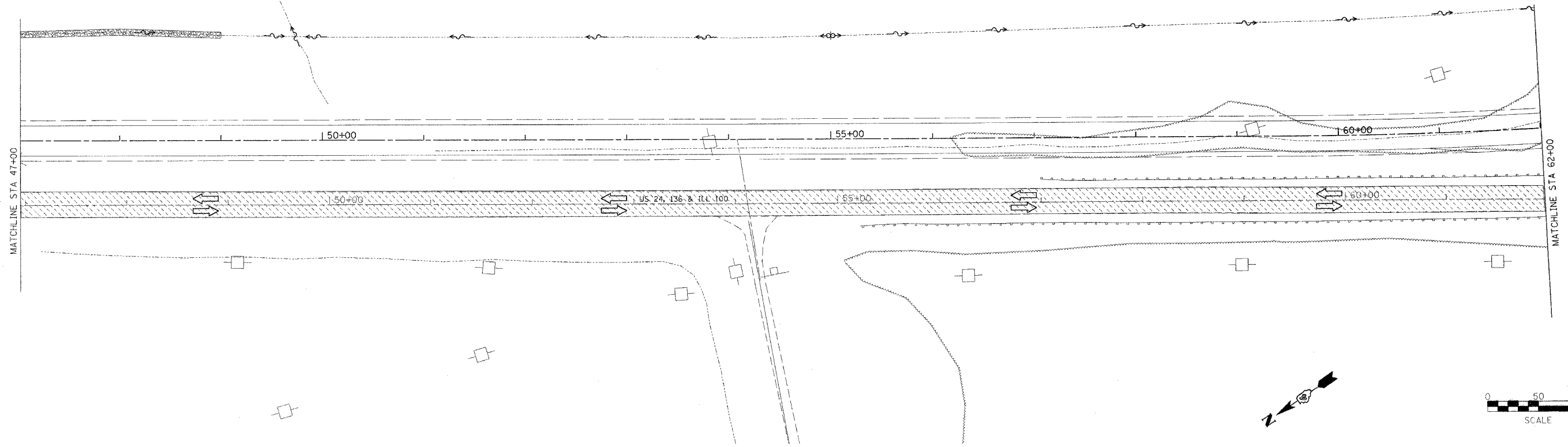

STAGING LEGEND	
	STAGE CONSTRUCTION AREA
	TRAFFIC LANE TO BE USED IN THIS STAGE
	TEMPORARY CONCRETE BARRIER W/IMPACT ATTENUATOR
	PORTABLE TEMPORARY BARRIER SYSTEM

REVISIONS	
NAME	DATE

ILLINOIS DEPARTMENT OF TRANSPORTATION

US 24 STAGING PLANS
STAGE III
STA 47+00 TO 76+00

SCALE: VERT. _____
 HORIZ. _____

DATE _____ DRAWN BY _____
 CHECKED BY _____

PLOT DATE = 4/26/2005
 PLOT SCALE = 1/8"=1'-0"
 USER NAME = kuhfarsch