

STATE OF ILLINOIS
DEPARTMENT OF TRANSPORTATION

ROUTE NO.	SECTION	COUNTY	TOTAL SHEETS	SHEET NO.
F.A.P. 315	(18BRY-1)BR	FULTON	13	2
FED. ROAD DIST. NO. 7	ILLINOIS	FED. AID PROJECT		

Contract #88753

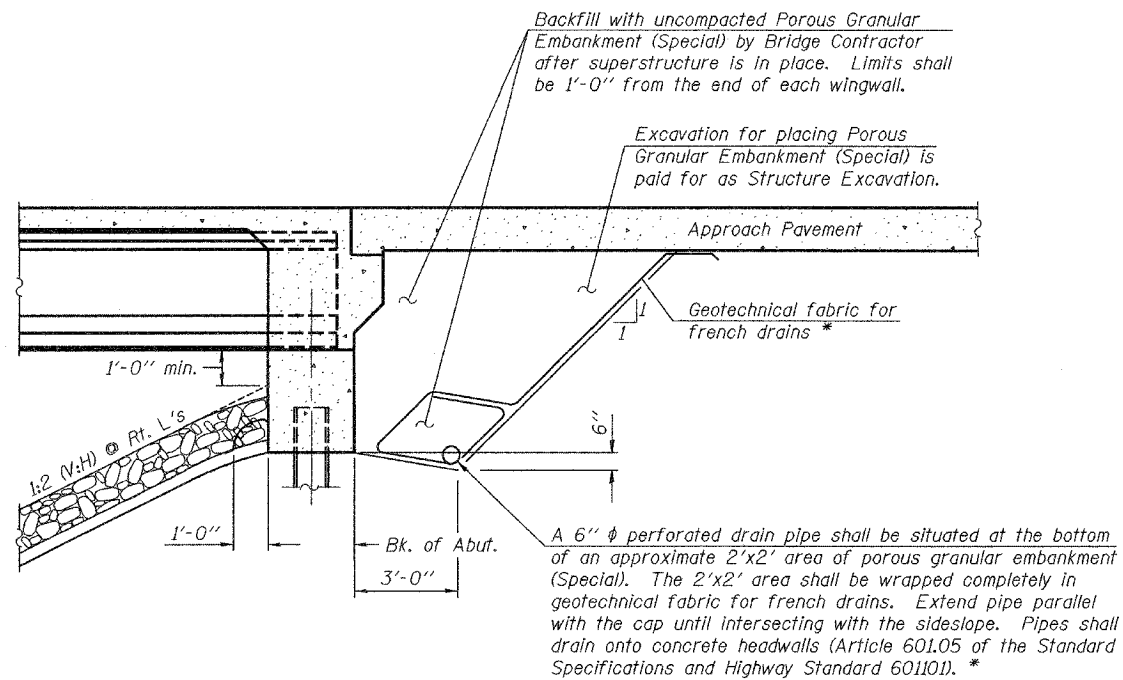

* Included in the cost of Porous Granular Embankment (Special).

SECTION THRU INTEGRAL ABUTMENT

(Horiz. dim. @ Rt. L's)

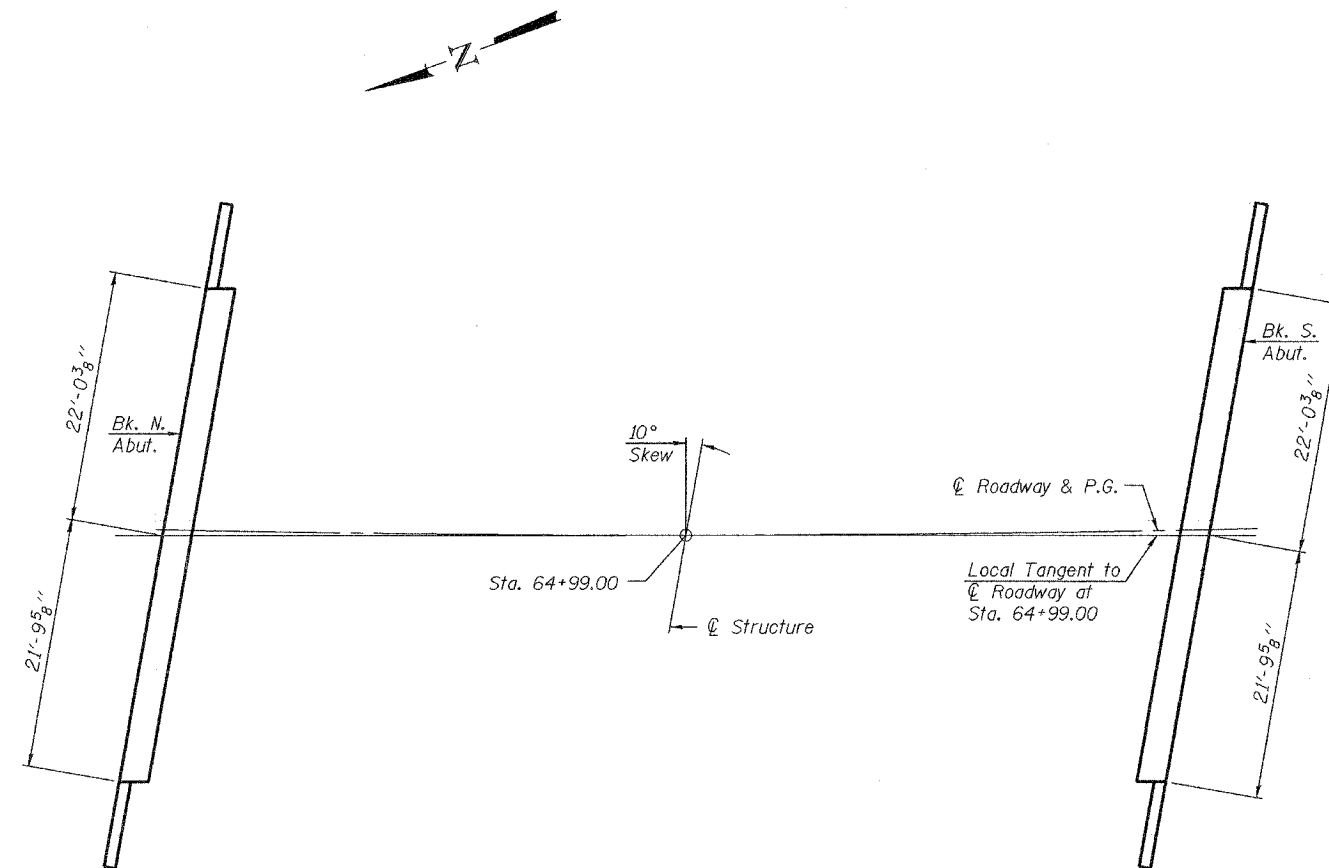

FOOTING LAYOUT

DESIGNED	Alan M. Johnson
CHECKED	Philip E. Coppernoll
DRAWN	Michael B. Mossman
CHECKED	AMJ PEC

EXAMINED	Thomas J. Donagabadi	April 25, 2005
PASSED	Ralph E. Anderson	

GENERAL DETAILS
F.A.P. ROUTE 315 - SECTION (18BRY-1)BR
FULTON COUNTY
STATION 64+99.00
STRUCTURE NO. 029-0067