

STATE OF ILLINOIS
DEPARTMENT OF TRANSPORTATION

ROUTE NO.	SECTION	COUNTY	TOTAL SHEETS	SHEET
FAP 315	(18BRY-1)BR	FULTON		113
FED. ROAD DIST. NO. 7	ILLINOIS	FED. AID PROJECT-		

SHEET NO. 9
46 SHEETS

Contract #88753

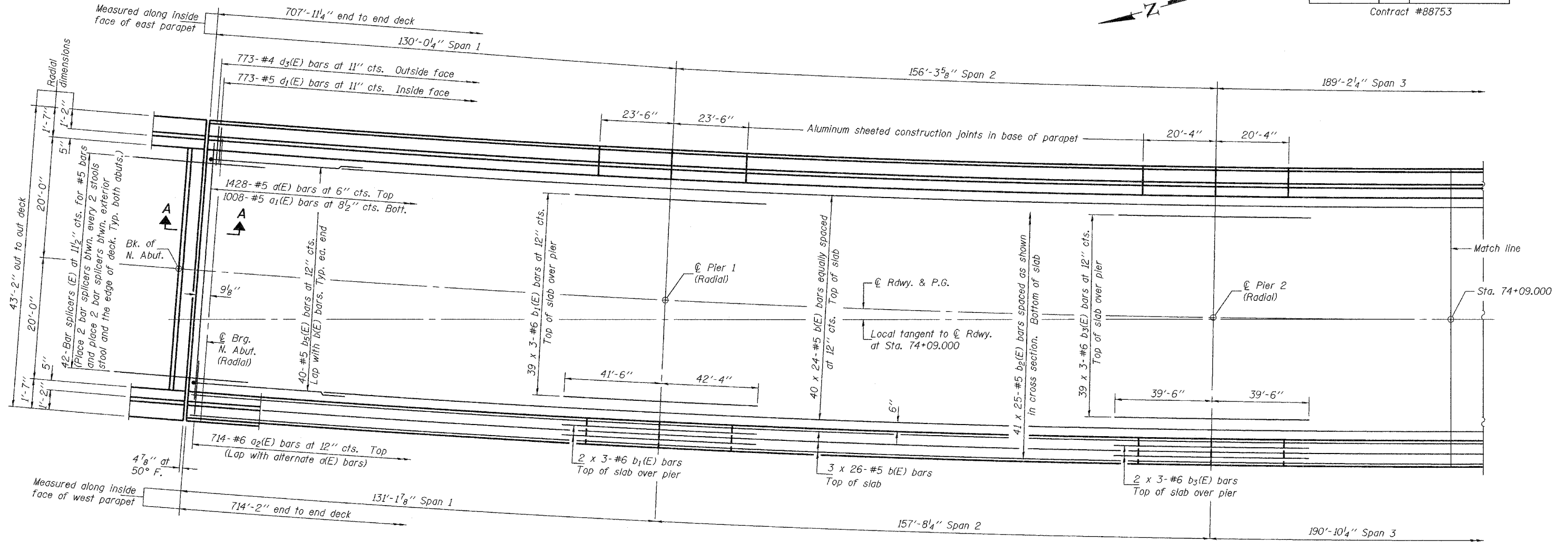

PLAN

Notes: See sheet 1 of 46 for scupper locations.
See sheet 11 of 46 for superstructure details, Bill of Material and Section A-A.
Reinforcement bars designated (E) shall be epoxy coated.
Bars indicated thus 40 x 24-#5 etc. indicates 40 lines of bars with 24 lengths per line.
See sheet 12 of 46 for parapet reinforcement.
Work this sheet with sheets 9 thru 12 of 46.

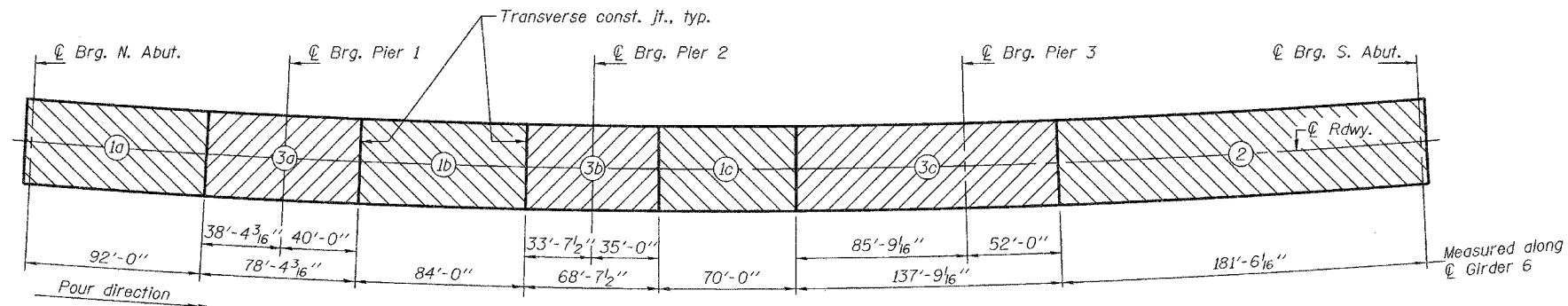

DECK POURING SEQUENCE

The concrete deck slab segments shall be poured in numerical order as shown. See general notes on sheet 2 of 46.

MIN. BAR LAPS

#5 bar = 2'-2"
#6 bar = 2'-7"

SUPERSTRUCTURE

SPANS 1 & 2

F.A.P. RTE. 315 - SEC. (18BRY-1)BR

FULTON COUNTY

STATION 74+09.000

STRUCTURE NO. 029-0068

DESIGNED	MJT
CHECKED	FT
DRAWN	h.t. parsons
CHECKED	MJT/FT/SMR

May 16, 2005

EXAMINED *Thomas J. Demagala*
ENGINEER OF BRIDGE DESIGN

PASSED *Ralph E. Anderson*
ENGINEER OF BRIDGES AND STRUCTURES