

Bench Mark: Chiseled "□" on top of W. side of S. abut. of S.N. 029-0004 (Spoon River Bridge) Elev. 480.75 (146.533)

Existing Structure: None.

Note: Retaining wall to be built during Stage III Construction.

STATE OF ILLINOIS
DEPARTMENT OF TRANSPORTATION

ROUTE NO.	SECTION	COUNTY	SHEET	SHEET NO.
F.A.P. 315	*	FULTON	203	9 SHEETS
FED. ROAD DIST. NO. 7	ILLINOIS	FED. AID PROJECT		

Contract #88753
*18RS-2, 19RS-3, (18BRY & 18BRY-1) BR, 18B-1

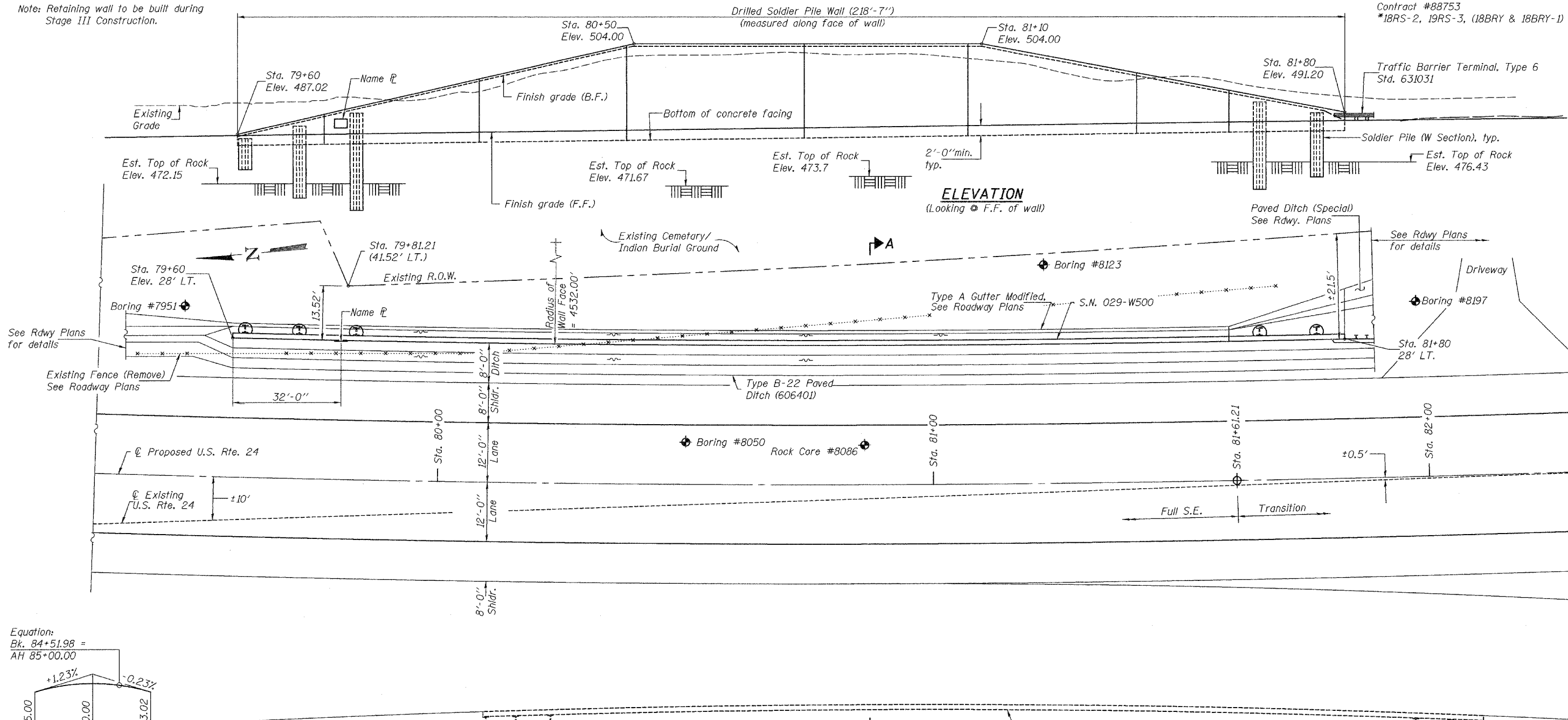

ELEVATION
(Looking @ F.F. of wall)

PLAN

For Section A-A, see sheet 2 of 9.

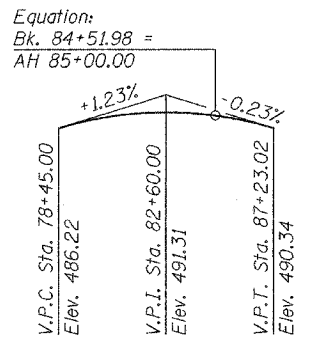

PROFILE GRADE
(along @ roadway)

DESIGNED	Stephen M. Ryan
CHECKED	Mark Shaffer SEM
DRAWN	WDC & BMC
CHECKED	SJR SEM

EXAMINED
PASSED
APRIL 28, 2005
ENGINEER OF BRIDGE DESIGN
ENGINEER OF BRIDGES AND STRUCTURES



EXPIRES 11-30-2006

CURVE DATA
(U.S. Rte. 24)
P.I. Sta. = 71+34.68
 $\Delta = 28^\circ-53'-55.60''$ (LT)
D = 1°-15'-23.35"
R = 4,560.00'
T = 1,175.00'
L = 2,299.97'
E = 148.95'
e = 3.3%
T.R. = 41.28' & 27.93'
S.E. Run = 196.85
P.C. Sta. = 59+59.68
P.T. Sta. = 82+59.64
S.E. Transition = 81+61.21
Normal Crown = 83+86

DESIGN SPECIFICATIONS
2002 AASHTO

DESIGN STRESSES
FIELD UNITS
 $f'_c = 3,500$ psi
 $f_y = 60,000$ psi (reinforcement)
 $f_y = 50,000$ psi (AASHTO M270 Gr. 50 for soldier piles)

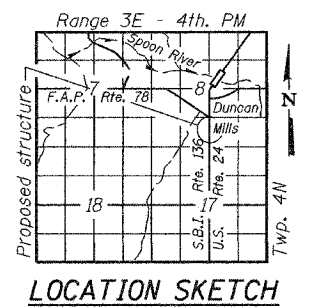

LOCATION SKETCH

GENERAL PLAN
U.S. ROUTE 24
F.A.P. RTE. 315 - SEC. 18RS-2, 19RS-3,
(18BRY & 18BRY-1) BR, 18B-1
FULTON COUNTY
LT. STATION 79+60 to 81+80
STRUCTURE NO. 029-W500