

12+1=13

RTE. NO.	SECTION	COUNTY	TOTAL SHEETS	SHEET NO.
T.R. 291	94-14131-00-BR	VERMILION	12	1
CONTRACT NO. : 91323				

INDEX OF SHEETS

- 1 Cover Sheet
- 2 Summary of Quantities, General Notes, Typical Cross Sections and Details
- 3 Plan and Profile
- 3A Horizontal Layout
- 4-8 Station Cross Sections
- 9 Storm Water Pollution Prevention Plan
- 10-12 Bridge Plans

STATE OF ILLINOIS DEPARTMENT OF TRANSPORTATION DIVISION OF HIGHWAYS PLANS FOR PROPOSED LOCAL AGENCY IMPROVEMENT

LIST OF STANDARDS

- Standard 000001-04 Standard symbols, abbreviations and patterns
- Standard 280001-02 Temporary erosion control systems
- Standard 515001-02 Name plate for bridges
- Standard 630301-03 Shoulder Widening for Type 1 (Special) Guardrail Terminals
- Standard 631026-02 Traffic Barrier Terminal Type 5 & 5A
- Standard 701011-01 Off-road moving operations, 2-l, 2-w, day only, for speeds > 45 mph
- Standard 701201-02 Lane Closure, 2-l, 2-w, day only, for speeds ≥ 45 mph
- Standard 701301-02 Lane closure, 2-l, 2-w, short time operations
- Standard 702001-05 Traffic control devices
- Standard BLR-21-6 Typical application of traffic control devices for Construction on Rural Local Highways
- Standard BLR-22-4 Typical application of traffic control devices 2-l, 2-w, rural, Road closed to Thru Traffic

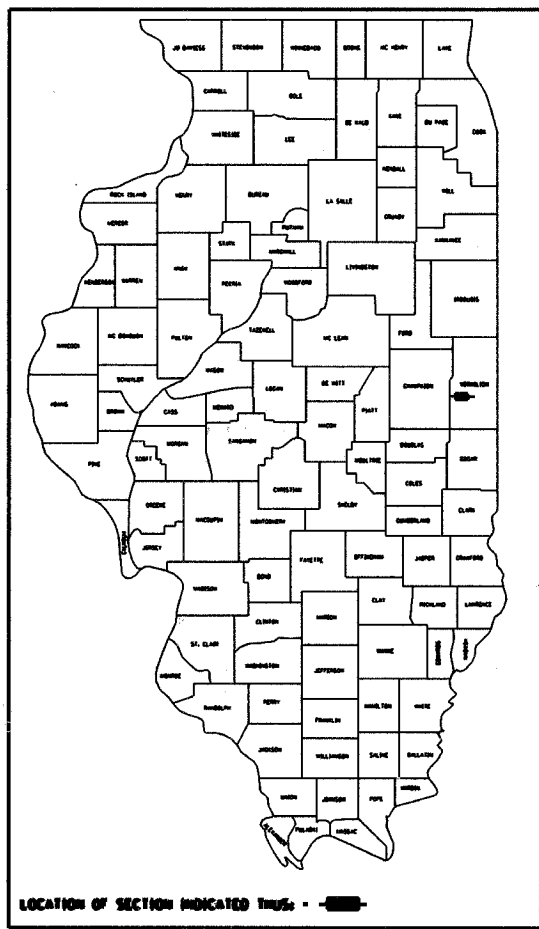
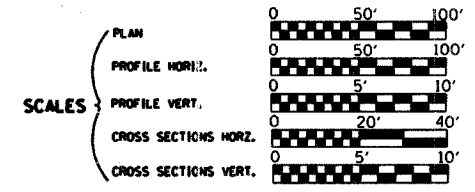

APPROVED 3-23 2005
John S. Hays
ROAD COMMISSIONER

BRIDGE REPLACEMENT AND REHABILITATION PROGRAM T.R. 291 (LINCOLN TRAIL ROAD) OVER STONEY CREEK SECTION 94-14131-00-BR VERMILION COUNTY PROJECT BROS-183(86)

ROADWAY CLASSIFICATION: LOCAL ROAD
CURRENT ADT = 100 (4.0% TRUCKS)
DESIGN YEAR ADT = 125
DESIGN SPEED: 30 MPH
DESIGN GUIDELINES: RURAL
VARIANCES GRANTED: SUPERELEVATION ELIMINATED

C-95-323-04

R13W, 2nd P.M.

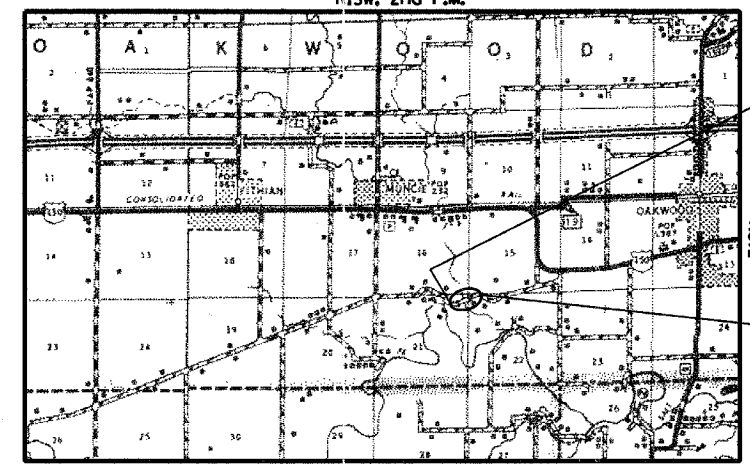

IMPROVEMENT BEGINS
STA. 11+00.00

IMPROVEMENT ENDS
STA. 19+00.00

JOINT UTILITY LOCATING INFORMATION FOR EXCAVATORS
J.U.L.I.E. Telephone No. Toll Free 1-800-892-0123

CONTRACT NO. : 91323

URS
3040 N. UNIVERSITY AVE., SUITE ONE
DECATUR, ILLINOIS 62526-1343
PH. 217-875-4800

IMPROVEMENT CONSISTS OF THE REMOVAL OF A SINGLE-SPAN PRATT THRU TRUSS BRIDGE ON MASONRY ABUTMENTS, ±15'-7" O.-O. DECK, 100'-0" BK.-BK. ABUTMENTS AND THE CONSTRUCTION OF A SINGLE SPAN PREFABRICATED STEEL TRUSS SUPERSTRUCTURE ON CONCRETE SPILL-THRU ABUTMENTS, TOTAL LENGTH = 136'-7 1/2" BK.-BK. ABUTMENTS, WIDTH = 30'-0" O.-O. DECK AND NECESSARY APPROACH ROADWAY WORK. EXIST. STR. NO. 092-3178. PROP. STR. NO. 092-3488.

LAYOUT

Approximate Scale: miles

Total and Net Length of Improvement 800.00 Feet = 0.152 Miles

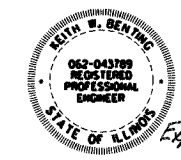

Keith W. Bestine
Illinois Professional No. 43789

APPROVED March 23 2005
Robert B. Andrews
COUNTY ENGINEER

APPROVED 3/29
Dell Sudd
DISTRICT ENGINEER OF LOCAL ROADS AND STREETS

APPROVED March 29 2005
John S. Hays
REGIONAL ENGINEER

STATE OF ILLINOIS
DEPARTMENT OF TRANSPORTATION

3/22/2005
Date