

RTE.	SECTION	COUNTY	TOTAL SHEETS	SHEET NO.
TR 291	94-14131-00-BR	VERMILION	12	9
STA. 8+07.90 TO STA. 20+94.16		CONTRACT NO. 91323		
FED. ROAD DIST. NO.		BLKMS	PROJECT	BROS-183186
SCALE IN FEET				

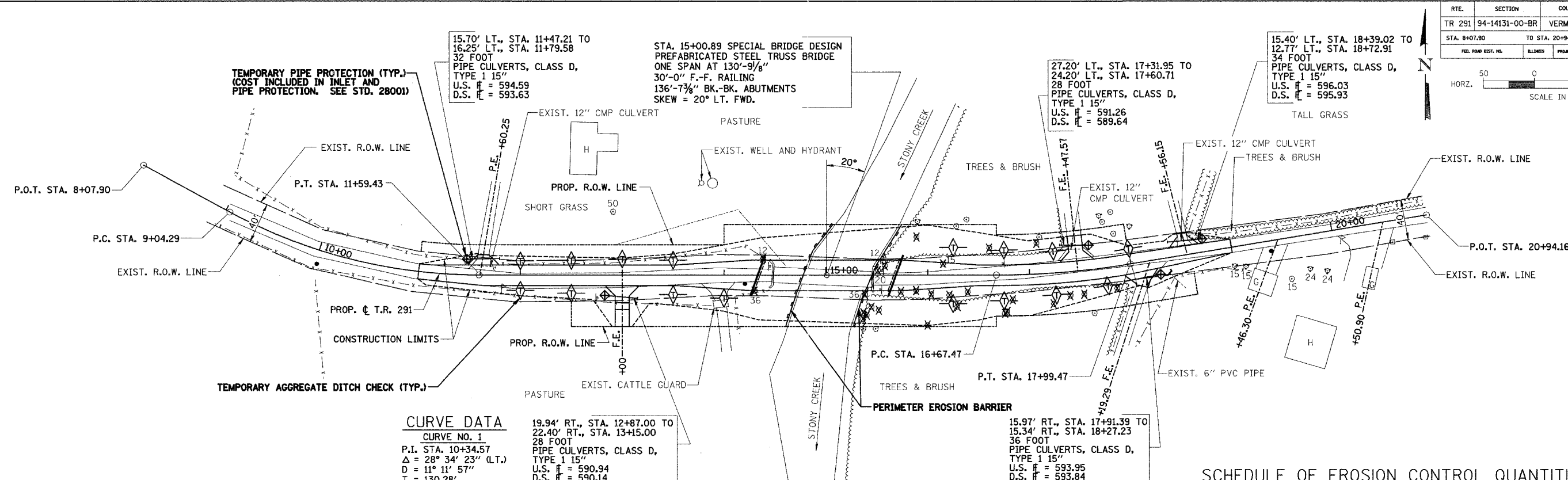

SCHEDULE OF EROSION CONTROL QUANTITIES

EARTH EXCAVATION FOR EROSION CONTROL
TOTAL = 80 CU. YD.

TEMPORARY EROSION CONTROL SEEDING
100 LBS/ACRE X 0.7 ACRES = 70 POUNDS

SEEDING, CLASS 2
AREA INSIDE OF CONSTRUCTION LIMITS, LESS ROADWAY.
TOTAL = 0.7 ACRES

NITROGEN FERTILIZER NUTRIENT
TOTAL = 63 POUNDS

PHOSPHORUS FERTILIZER NUTRIENT
TOTAL = 63 POUNDS

POTASSIUM FERTILIZER NUTRIENT
TOTAL = 63 POUNDS

MULCH, METHOD 2
TOTAL = 0.7 ACRES

INLET AND PIPE PROTECTION
15.70' LT., STA. 11+47.21 = 1 EACH
19.94' RT., STA. 12+87.00 = 1 EACH
24.20' LT., STA. 17+60.71 = 1 EACH
15.34' RT., STA. 18+27.23 = 1 EACH
12.77' LT., STA. 18+72.91 = 1 EACH
TOTAL = 5 EACH

PERIMETER EROSION BARRIER
TO BE CONSTRUCTED AT LOCATIONS SHOWN ON PLANS. LAYOUT MAY VARY AS DIRECTED BY THE ENGINEER.
TOTAL = 223 FOOT

TEMPORARY DITCH CHECK
STA. 12+00, RT. & LT. = 2 EACH
STA. 12+50, RT. & LT. = 2 EACH
STA. 13+00, LT. = 1 EACH
STA. 13+50, RT. & LT. = 2 EACH
STA. 14+00, RT. = 1 EACH
STA. 16+25, RT. & LT. = 2 EACH
STA. 16+75, RT. & LT. = 2 EACH
STA. 17+25, RT. & LT. = 2 EACH
STA. 17+75, RT. = 1 EACH
STA. 18+00, LT. = 1 EACH
TOTAL = 16 EACH

CURVE DATA
CURVE NO. 1
P.I. STA. 10+34.57
Δ = 28° 34' 23" (LT.)
D = 11° 11' 57"
T = 130.28'
R = 511.61'
L = 255.14'
E = 16.33'
P.C. STA. 9+04.29
P.T. STA. 11+59.43

19.94' RT., STA. 12+87.00 TO
22.40' RT., STA. 13+15.00
28 FOOT
PIPE CULVERTS, CLASS D,
TYPE 1 15"
U.S. # = 590.94
D.S. # = 590.14

CURVE DATA
CURVE NO. 2
P.I. STA. 17+33.62
Δ = 9° 27' 13" (LT.)
D = 7° 09' 43"
T = 66.15'
R = 800.00'
L = 132.00'
E = 2.73'
P.C. STA. 16+67.47
P.T. STA. 17+99.47
S.E. = 4.0Z
S.E. ATTAINED STA. 16+00.80
TO STA. 17+00.80
S.E. REMOVED STA. 17+66.14
TO STA. 18+66.14

LEGEND

- TEMPORARY AGGREGATE DITCH CHECK (TYP.) (COST INCLUDED IN TEMPORARY DITCH CHECK, SEE STD. 280001)
 - PERIMETER EROSION BARRIER
 - TEMPORARY PIPE PROTECTION
- ALL ITEMS SHALL BE CONSTRUCTED AS SHOWN ON STANDARD 280001 AND AS DIRECTED BY THE ENGINEER. MAINTENANCE AND CLEANING OF THE EROSION CONTROL ITEMS SHALL BE INCLUDED IN THE RESPECTIVE EROSION CONTROL PAY ITEM.

STORM WATER POLLUTION PREVENTION PLAN

DESCRIPTION OF INTENDED SEQUENCE FOR MAJOR CONSTRUCTION ACTIVITIES:

1. ISOLATED TREE REMOVAL AS SHOWN ON THE PLANS, TREES TO REMAIN WILL BE PROTECTED AGAINST DAMAGE.
2. REMOVAL OF EXISTING STRUCTURE.
3. EXCAVATION WILL BE COMPLETED ALONG THE ENTIRE LENGTH OF THE JOB TO REMOVE THE EXISTING ROADWAY AND GRADE THE PROPOSED DITCHES.
4. NECESSARY EMBANKMENT WILL BE PLACED ALONG THE ENTIRE LENGTH OF THE JOB FOR THE PROPOSED ROADWAY.
5. PLACEMENT, MAINTENANCE, REMOVAL AND PROPER CLEAN-UP OF TEMPORARY EROSION CONTROL ITEMS, SUCH AS EROSION BARRIER, AGGREGATE DITCH CHECKS, INLET AND PIPE PROTECTION, TEMPORARY SEEDING AND OTHER MISCELLANEOUS EROSION CONTROL MEASURES.
6. CONSTRUCT NEW BRIDGE.
7. PLACEMENT OF PERMANENT EROSION CONTROL ITEMS, INCLUDING RIPRAP AND SEEDING.
8. PLANTING OF REPLACEMENT TREES.
9. FINAL GRADING AND OTHER MISCELLANEOUS ITEMS.

NOTES:

FOR LAYOUT OF GROUTED RIPRAP AT BRIDGE, SEE SHT. 10 OF 12.

ALL ITEMS SHALL BE CONSTRUCTED AS SHOWN ON STANDARD 280001 AND AS DIRECTED BY THE ENGINEER. MAINTENANCE AND CLEANING OF THE EROSION CONTROL ITEMS SHALL BE INCLUDED IN THE RESPECTIVE EROSION CONTROL PAY ITEM.

DATE	BY	NO.

DATE	BY	NO.