

RTE.	SECTION	COUNTY	TOTAL SHEETS	SHEET NO.
C.H. 40	*	SANGAMON	33	11
PROJECT				

* 00-00021-02-BR

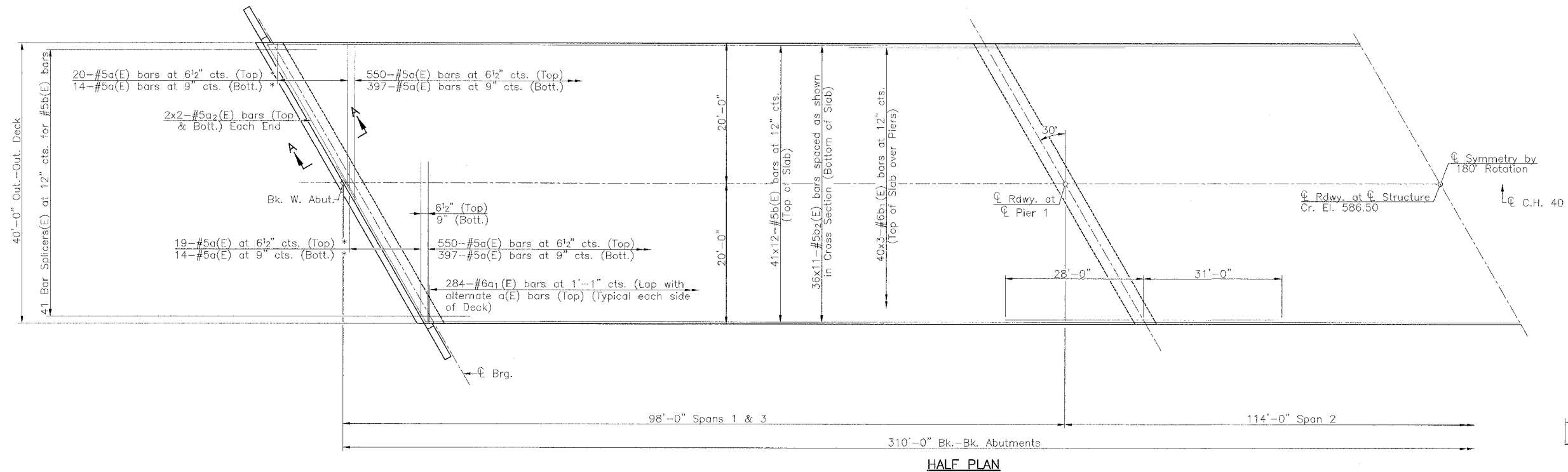

* Order a(E) bars full length. Cut to fit and use remainder of bars in opposite end.

Note: See Sheet 15 of 33 for superstructure details & Section A-A. Bars indicated thus 40 x 16-#5 etc. indicates 40 lines of bars with 16 lengths per line. Reinforcement bars designated (E) shall be epoxy coated. See Sheet 8 of 33 for Deck Pouring Sequence.

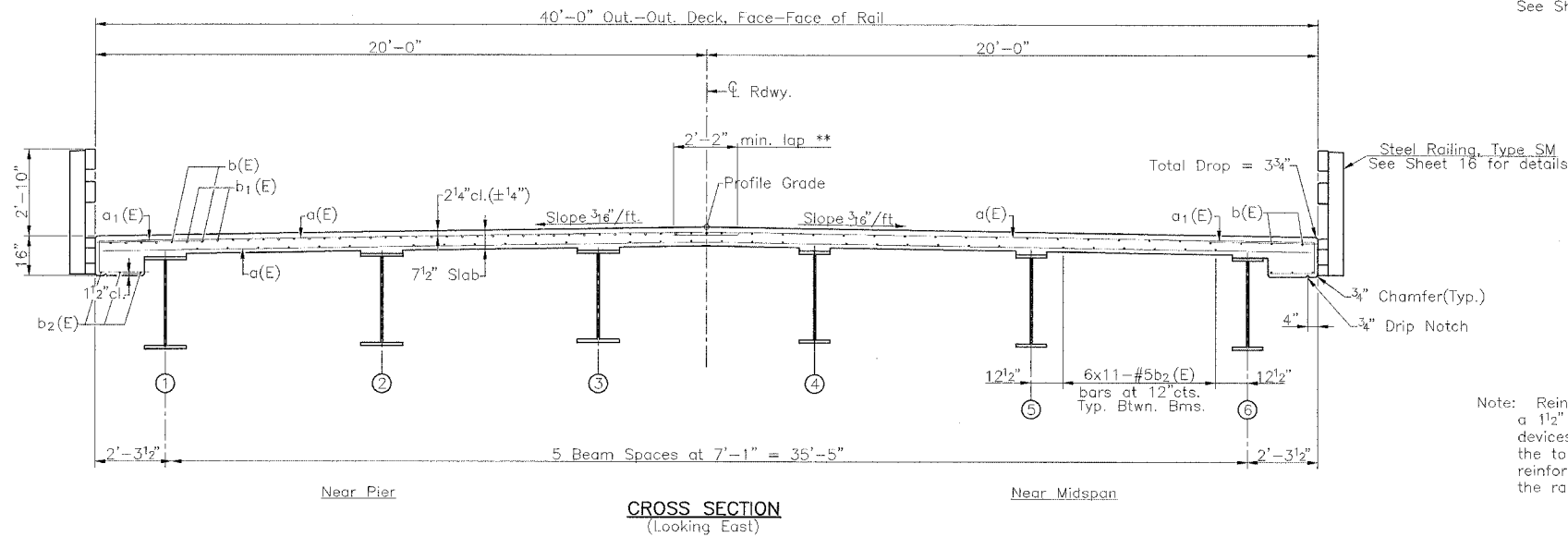
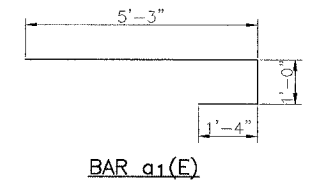

MIN. BAR LAPS
 #5 bars = 2'-2"
 #6 bars = 2'-7"

Note: Reinforcement in the top of the deck may be placed with a 1 1/2" minimum clearance in the area of the rail post anchor devices. The studs of the anchor devices shall be placed below the top reinforcement bars and outermost longitudinal reinforcement bar shall be placed directly above the studs of the rail post anchor device.

** Bars shall be lapped with double the number of ties normally used.

SUPERSTRUCTURE BILL OF MATERIAL

Bar	No.	Size	Length	Shape
a(E)	1961	#5	20'-11"	—
a1(E)	568	#6	7'-7"	—
a2(E)	16	#5	24'-0"	—
b(E)	492	#5	27'-10"	—
b1(E)	240	#6	21'-6"	—
b2(E)	396	#5	30'-2"	—
m(E)	8	#6	24'-3"	—
m1(E)	12	#6	24'-3"	—
m2(E)	24	#6	10'-10"	—
m3(E)	10	#6	7'-10"	—
s(E)	82	#5	4'-11"	—
s1(E)	82	#5	10'-4"	—
u(E)	16	#5	7'-5"	—
Reinforcement Bars, Epoxy Coated			Pound	86810
Concrete Superstructures			Cu. Yd.	360.9
Protective Coat			Sq. Yd.	1378

SUPERSTRUCTURE
 C.H. 40 OVER HORSE CREEK
 SECTION 00-00021-02-BR
 SANGAMON COUNTY