

FINAL SURVEY	SURVEYED	BY	DATE
NOTE BOOK NO.	PLOTTED		
	DATE		
	AREAS CHECKED		

ORIGINAL SURVEY	SURVEYED	BY	DATE
NOTE BOOK NO.	PLOTTED		
	DATE		
	AREAS CHECKED		

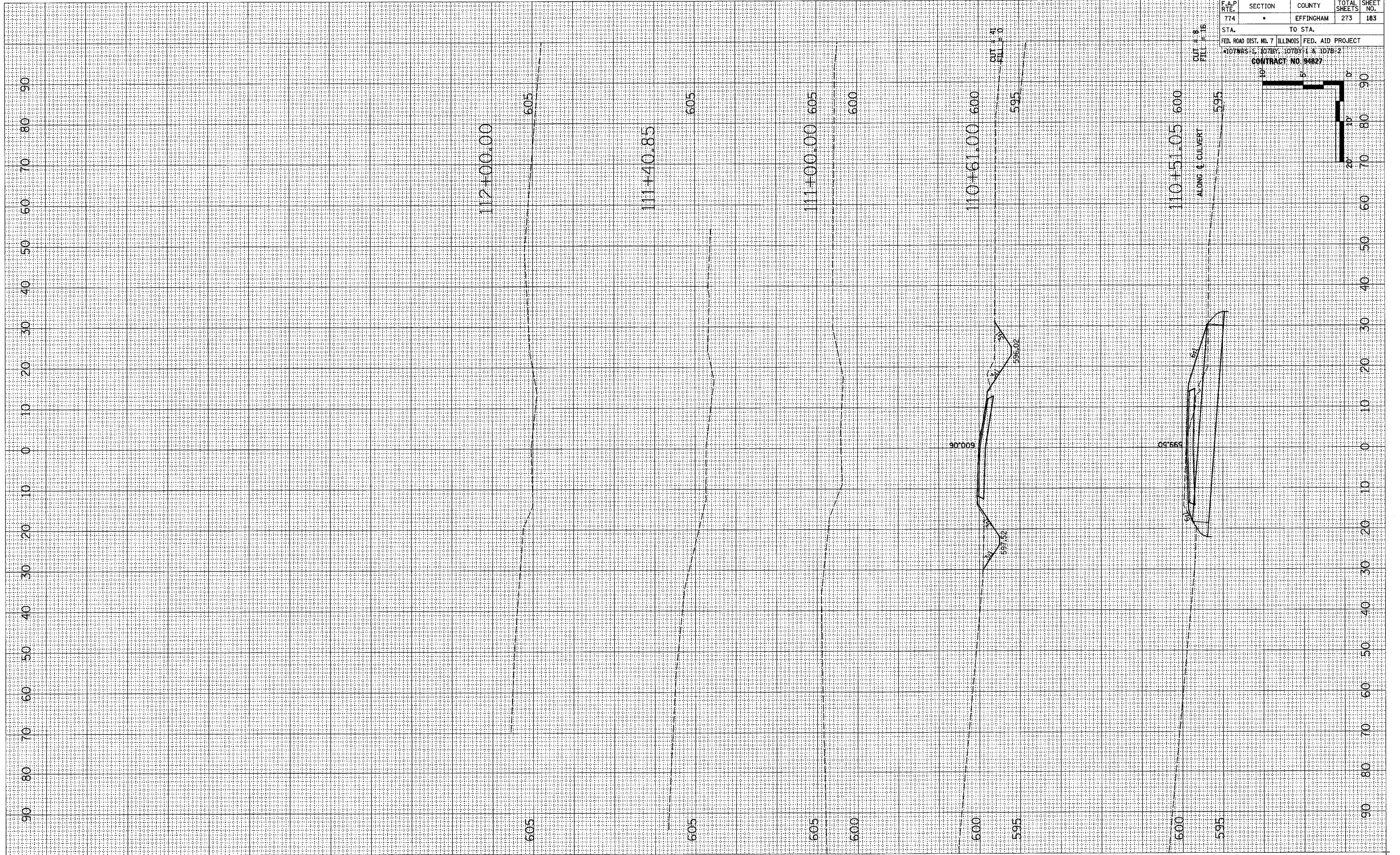

F.A.P. RTE.	SECTION	COUNTY	TOTAL SHEETS	SHEET NO.
774	.	EFFINGHAM	273	183
STA.		TO STA.		
FED. ROAD DIST. NO. 7 ILLINOIS FED. AID PROJECT				
4107WRS-1, 107BY, 107BY-1 & 107B-2				
CONTRACT NO. 94827				

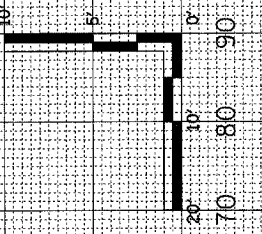

LEPRECHAUN LANE
EFFINGHAM COUNTY