

steffenmk
3/29/2005
c:\projects\948600\d04301pa.dgn

FAI REV.	SECTION	COUNTY	TOTAL SHEETS	SHEET NO.
64	•	JEFFERSON	19	11

FED. ROAD DIST. NO. 7
ILLINOIS
FED. AID PROJECT NO.
CONTRACT NO. 94860
• (41-6,41-6-1)RS-1



CURVE DATA
PI STA. = 3403+33.42
 $\Delta = 23^\circ 38' 00''$
 $D = 0^\circ 28' 00''$
 $R = 12,277.67'$
 $T = 2,568.67'$
 $L = 5,064.29'$
 $E = 565.82'$
P.C. STA. = 3377+64.75
P.T. STA. = 1867+73.26
S.E. = 0.016 FT./FT.
ATTAINED IN 200'
STA. 3376+31.4 TO STA. 3378+31.4
STA. 1867+06.7 TO STA. 1869+06.7

EQUATION:
STA 3423+00.8K =
STA 1862+44.22 MH

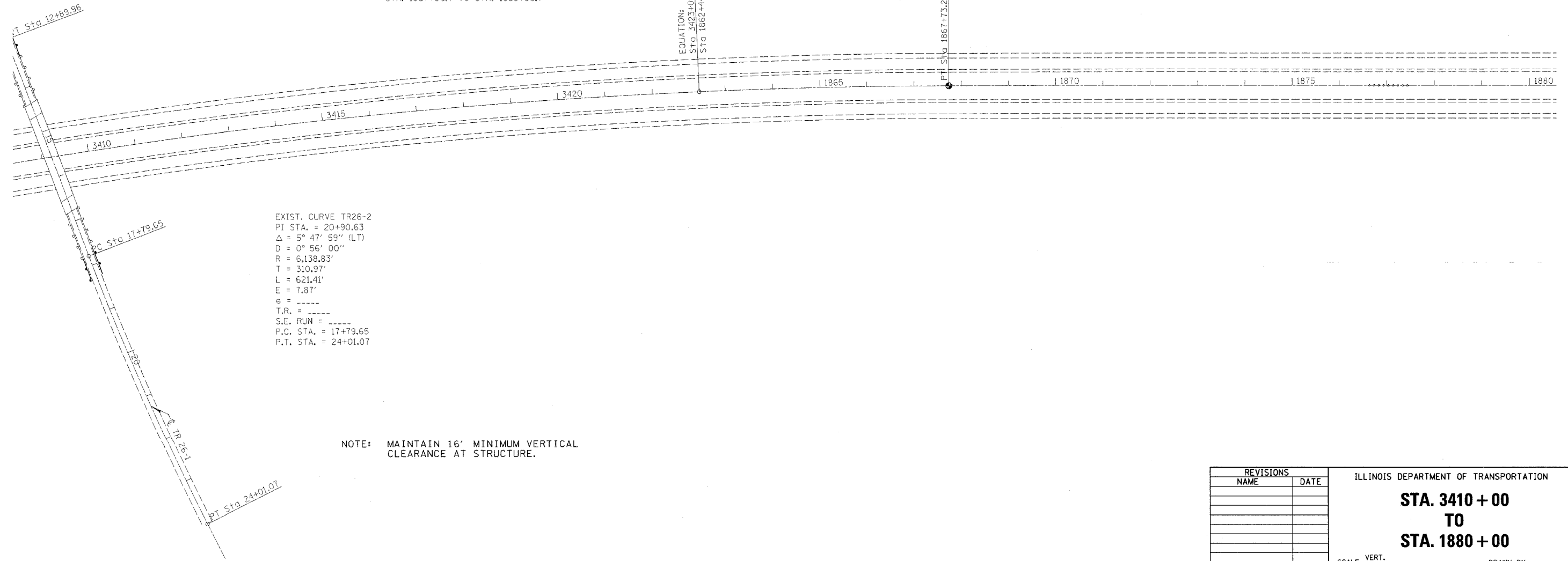

EXIST. CURVE TR26-2
PI STA. = 20+90.63
 $\Delta = 5^\circ 47' 59''$ (LT)
 $D = 0^\circ 56' 00''$
 $R = 6,138.83'$
 $T = 310.97'$
 $L = 621.41'$
 $E = 7.87'$
 $e = \text{-----}$
T.R. = -----
S.E. RUN = -----
P.C. STA. = 17+79.65
P.T. STA. = 24+01.07

NOTE: MAINTAIN 16' MINIMUM VERTICAL CLEARANCE AT STRUCTURE.

REVISIONS	
NAME	DATE

ILLINOIS DEPARTMENT OF TRANSPORTATION
**STA. 3410 + 00
TO
STA. 1880 + 00**
SCALE: VERT. _____
DATE: _____ HORIZ. _____
DRAWN BY _____
CHECKED BY _____