

94860

FAI R/L	SECTION	COUNTY	TOTAL SHEETS	SHEET NO.
64		JEFFERSON	19	1

ILLINOIS FED. AID PROJECT NO.
 (41-6,41-6-1)RS-1
D-97-043-01

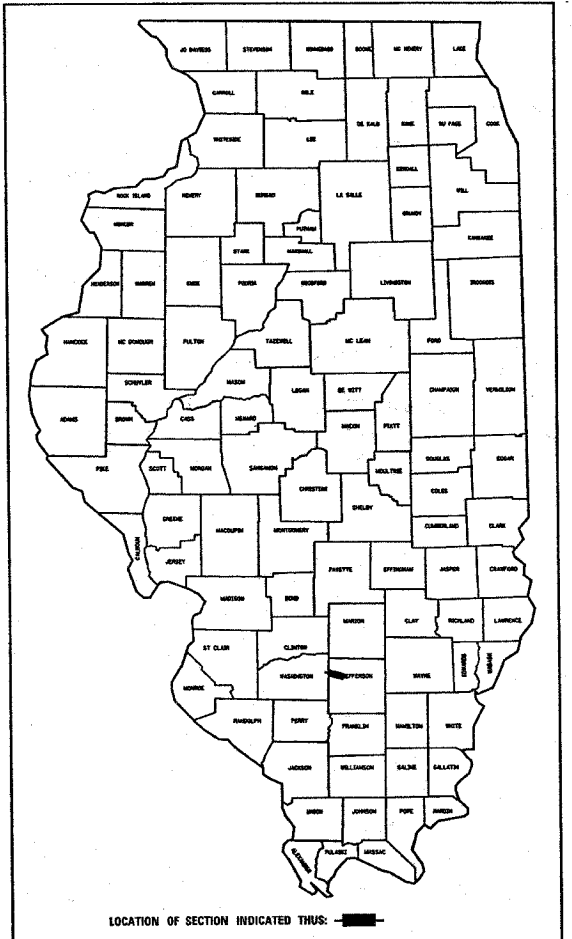

STATE OF ILLINOIS
DEPARTMENT OF TRANSPORTATION
DIVISION OF HIGHWAYS
PROPOSED
HIGHWAY PLANS
FAI ROUTE 64 (I-64)
SECTION (41-6,41-6-1)RS-1
PROJECT: IM-064-3(083)060
INTERSTATE RESURFACING
JEFFERSON COUNTY

C-97-009-05

SEE SHEET 2 FOR INDEX OF SHEETS

BRIDGE OMISSIONS

SN 041-0077
 I-64 EB OVER TR 108A/ BUR NORTHERN
 LENGTH = 257 FT
 STA 2031+94.04

SN 041-0078
 I-64 WB OVER TR 108A/ BUR NORTHERN
 LENGTH = 257 FT
 STA 2031+94.04

SN 041-0085
 I-64 EB OVER RAYSE CREEK
 LENGTH = 131.5 FT
 STA 1890+94

SN 041-0086
 I-64 WB OVER RAYSE CREEK
 LENGTH = 131.5 FT
 STA 1890+94

STATION EQUATION
 STA 3423+00 BK = STA 1862+44.22 AH

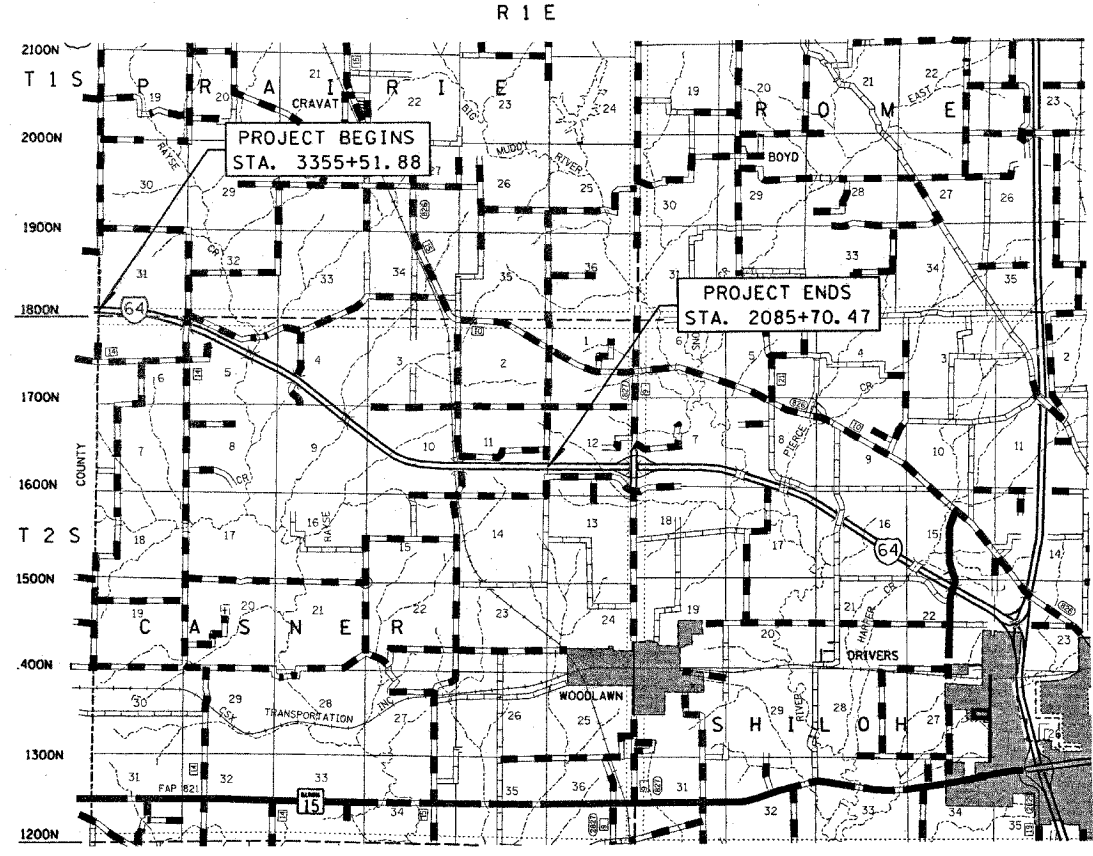

STATE OF ILLINOIS
 DEPARTMENT OF TRANSPORTATION
 DIVISION OF HIGHWAYS

SUBMITTED MARCH 29 20 05

Christine M. Sand DISTRICT ENGINEER

_____ 20 _____

ENGINEER OF PROJECT DEVELOPMENT AND IMPLEMENTATION

May 13 20 05
Mike Sine ENGINEER OF DESIGN AND ENVIRONMENT

May 13 20 05
Victor Modest DIRECTOR, DIVISION OF HIGHWAYS

PRINTED BY THE AUTHORITY OF
 THE STATE OF ILLINOIS

SEAL

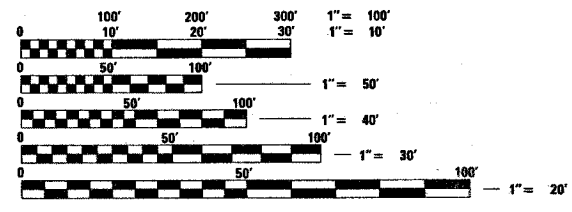

FULL SIZE PLANS HAVE BEEN PREPARED USING STANDARD ENGINEERING SCALES, REDUCED SIZED PLANS WILL NOT CONFORM TO STANDARD SCALES, IN MAKING MEASUREMENTS ON REDUCED PLANS, THE ABOVE SCALES MAY BE USED.

J.U.L.I.E.
 JOINT UTILITY LOCATION INFORMATION FOR EXCAVATION
 1-800-892-0123

CONTRACT NO. 94860

TOWNSHIP : GRAND PRAIRIE, CASNER

ADT (2003) = 20,900

GROSS LENGTH = 29074.37 FEET = 5.51 MILES
 NET LENGTH = 28685.87 FEET = 5.43 MILES

PROJECT ENGINEER : MARK DAUGHERTY
 SQUAD LEADER : KRISTI SANDSCHAFER
 DESIGNER : KRISTI SANDSCHAFER
 TELEPHONE : 217/342-3951 EX 313
 steffemk
 3/29/2005
 c:\projects\94860\d\04301pa.dgn

steffenmk
 3/29/2005
 c:\proJects\94860\d04301pa.dgn
INDEX

ATE.	SECTION	COUNTY	TOTAL SHEETS	SHEET NO.
64	*	JEFFERSON	19	2
FED. ROAD DIST. NO. 7		BLDGNO.	FED. AID PROJECT NO.	

CONTRACT NO. 94860
 • (41-6,41-6-1RS-1

INDEX OF SHEETS

SHEET NO.	ITEM
1	COVER SHEET
2	INDEX OF SHEETS AND HIGHWAY STANDARDS
3	GENERAL NOTES
4	SUMMARY OF QUANTITIES
5	TYPICAL SECTION
6	RESURFACING DETAILS
7	RESURFACING, PATCHING & PAVEMENT MARKING SCHEDULES
8	PIPE UNDERDRAIN AND GUARDRAIL SCHEDULES
9-18	PLAN SHEETS
19	TYPICAL APPLICATIONS OF INTERCHANGE PAVEMENT MARKING

THE FOLLOWING STANDARDS ARE A PART OF THESE PLANS AND ARE INCLUDED AFTER SHEET NO. 19:

STD. NO.	DESCRIPTION
000001-04	STANDARD SYMBOLS, ABBREVIATIONS, AND PATTERNS
001001	AREAS OF REINFORCEMENT BARS
001006	DECIMAL OF AN INCH AND A FOOT
442001-02	CLASS A PATCHES
601001	SUB-SURFACE DRAINS
601101	CONCRETE HEADWALL FOR PIPE DRAIN
630001-05	STEEL PLATE BEAM GUARDRAIL
630101-05	GUARDRAIL MOUNTED ON EXISTING CULVERTS
630201-03	PCC/BITUMINOUS STABILIZATION AT STEEL PLATE BEAM GUARDRAIL
630301-03	SHOULDER WIDENING FOR TYPE 1 (SPECIAL) GUARDRAIL TERMINALS
631031-05	TRAFFIC BARRIER TERMINAL, TYPE 6
635001	DELINEATORS
635006-02	REFLECTOR AND TERMINAL MARKER PLACEMENT
635011-01	REFLECTOR MARKER AND MOUNTING DETAILS
642001	SHOULDER RUMBLE STRIPS
701006-02	OFF-ROAD OPERATIONS, 2L, 2W, 15' TO 24" FROM PAVEMENT EDGE
701101-01	OFF-ROAD OPERATIONS, MULTILANE, 15' TO 24" FROM PAVEMENT EDGE
701106-01	OFF-ROAD OPERATIONS, MULTILANE, MORE THAN 15' AWAY
701201-02	LANE CLOSURE, 2L, 2W, DAY ONLY, FOR SPEEDS >=45MPH
701400-02	APPROACH TO LANE CLOSURE, FREEWAY/EXPRESSWAY
701401-03	LANE CLOSURE, FREEWAY/EXPRESSWAY
701406-04	LANE CLOSURE, FREEWAY/EXPRESSWAY, DAY OPERATIONS ONLY
701426-02	LANE CLOSURE, MULTILANE, INTERMITTENT OR MOVING OPER., FOR SPEEDS >=45 MPH
702001-05	TRAFFIC CONTROL DEVICES
720011	METAL POSTS FOR SIGNS, MARKERS & DELINEATORS
780001-01	TYPICAL PAVEMENT MARKINGS
781001-02	TYPICAL APPLICATIONS RAISED REFLECTIVE PAVEMENT MARKERS

REVISIONS	
NAME	DATE

ILLINOIS DEPARTMENT OF TRANSPORTATION

INDEX OF SHEETS

SCALE: VERT. _____
 HORIZ. _____
 DATE _____

DRAWN BY _____
 CHECKED BY _____

steffernk
3/29/2005
c:\projects\94860\d04301pa.dgn
GEN

FAI RTE.	SECTION	COUNTY	TOTAL SHEETS	SHEET NO.
64	*	JEFFERSON	19	3
FED. ROAD DIST. NO. 1		ILLINOIS	FED. AID PROJECT NO.	

CONTRACT NO. 94860
• (41-6,41-6-1)RS-1

GENERAL NOTES

THIS SECTION SHALL BE CONSTRUCTED IN ACCORDANCE WITH THE PLANS; THE "STANDARD SPECIFICATIONS FOR ROAD AND BRIDGE CONSTRUCTION", ADOPTED JANUARY 1, 2002; THE "SUPPLEMENTAL SPECIFICATIONS AND RECURRING SPECIAL PROVISIONS" INDICATED ON THE CHECK SHEET, AND "THE SPECIAL PROVISIONS" INCLUDED IN THE PROPOSAL

THE WORK INCLUDED IN THIS SECTION CONSISTS OF REHABILITATING APPROXIMATELY 5.5 MILES OF INTERSTATE 64 BY UNDERDRAIN REPLACEMENT, GUARDRAIL IMPROVEMENTS, PATCHING, MILLING, AND RESURFACING, AND OTHER WORK NECESSARY TO COMPLETE THIS SECTION.

THE PROPOSED PROJECT BEGINS AT THE WASHINGTON/JEFFERSON COUNTY LINE AND EXTENDS APPROXIMATELY 5.5 MILES TO 1 MILE WEST OF THE WOODLAWN INTERCHANGE.

BITUMINOUS SURFACE REMOVAL - BUTT JOINT WILL NOT BE PAID FOR SEPARATELY. THE COST SHALL BE INCLUDED IN THE UNIT PRICE FOR BITUMINOUS SURFACE REMOVAL 3 1/4".

BITUMINOUS MATERIALS (PRIME COAT) SHALL BE EITHER RC-70 OR AN EMULSIFIED POLYMER PRIME SS-1HP.

THE CONTRACTOR SHALL PROVIDE INTERNET ACCESS TO THE BITUMINOUS PLANT QUALITY CONTROL LAB SO THAT BITUMINOUS PLANT REPORTS CAN BE E-MAILED TO THE DISTRICT HEADQUARTERS. THIS WORK SHALL BE INCLUDED IN THE COST OF ALL BITUMINOUS ITEMS.

A PORTION OF THE EXISTING SHOULDER NEAR STRUCTURES 041-0077, 041-0078, 041-0085 & 041-0086 IS PORTLAND CEMENT CONCRETE WIDENING. THE SHOULDER SHALL BE MILLED APPROXIMATELY 1". THE PORTION OF THE SHOULDER THAT IS PCC SHALL ALSO BE MILLED AND WILL NOT BE PAID FOR SEPARATELY. THE COST SHALL BE INCLUDED IN THE UNIT PRICE FOR BITUMINOUS SURFACE REMOVAL, 1". THE QUANTITY OF BITUMINOUS SURFACE REMOVAL 1" THAT IS PCC WIDENING IS 2852 SQUARE YARDS IN THE EASTBOUND LANES AND 2840 SQUARE YARDS IN THE WESTBOUND LANES.

AN ESTIMATED QUANTITY OF 30 EACH FOR WOOD POSTS HAS BEEN INCLUDED IN THE PLANS. AN ESTIMATED QUANTITY OF 3 EACH FOR REMOVAL OF WOOD POST HAS BEEN INCLUDED IN THE PLANS. IT IS THE SOLE RESPONSIBILITY OF THE ENGINEER TO DETERMINE WHICH EXISTING WOOD POSTS NEED REPLACING IN THE MEDIAN.

PROPOSED RELIEF JOINTS SHOULD MATCH THE LOCATIONS OF THE EXISTING RELIEF JOINTS.

SIXTEEN FOOT MINIMUM VERTICAL CLEARANCE SHALL BE MAINTAINED UNDER THE OVERHEAD STRUCTURE.

ANY EXCAVATION REQUIRED FOR BITUMINOUS SHOULDER STABILIZATION AT STEEL PLATE BEAM GUARDRAIL AND TERMINAL SECTIONS SHALL BE INCLUDED IN THE COST OF BITUMINOUS SHOULDERS. EXCAVATED MATERIAL SHALL BE USED TO CONSTRUCT THE SHOULDER WIDENING AS SHOWN ON STANDARD 630301. ANY ADDITIONAL MATERIAL REQUIRED SHALL BE PAID FOR AS AGGREGATE SHOULDERS.

ALL NEW MAINLINE GUARDRAIL SHALL BE CONSTRUCTED WITH THE FACE OF RAIL AT THE EDGE OF BITUMINOUS SHOULDER (EXCEPT TYPE 1 SPECIALS, WHICH ARE TAPERED AT A RATE OF 50:1).

THE MATERIAL USED FOR AGGREGATE SHOULDERS, TYPE B SHALL BE CRUSHED STONE WITH AN IBR > OR = 80.

PIPE UNDERDRAINS 6" AND PIPE UNDERDRAINS 6" (SPECIAL) SHALL BE CONSTRUCTED IN ACCORDANCE WITH SECTION 601 OF THE STANDARD SPECIFICATIONS. ANY EXISTING UNDERDRAINS ENCOUNTERED DURING EXCAVATION FOR THE NEW PIPE UNDERDRAIN 6" OR PIPE UNDERDRAIN 6" (SPECIAL) SHALL BE REMOVED. THE REMOVAL SHALL BE INCLUDED IN THE COST PER FOOT FOR PIPE UNDERDRAINS 6" AND PIPE UNDERDRAINS 6" (SPECIAL) AND NO ADDITIONAL COMPENSATION WILL BE ALLOWED. THE MATERIAL REMOVED IN THE EXCAVATION FOR THE UNDERDRAIN INSTALLATION MUST BE REMOVED OFF THE PROJECT.

PREFORMED PLASTIC PAVEMENT MARKINGS, TYPE B SHALL BE APPLIED IN ACCORDANCE WITH THE REQUIREMENTS OF TYPE A AS SPECIFIED IN ARTICLE 780.07(a) OF THE STANDARD SPECIFICATIONS FOR ROAD AND BRIDGE CONSTRUCTION. CENTERLINE MARKINGS SHALL BE 6 INCHES WIDE. PREFORMED PLASTIC PAVEMENT MARKING, TYPE B - LINE 6" = 14343 FEET OF WHITE, EPOXY PAVEMENT MARKING - LINE 4" = 57372 FEET OF WHITE AND 57372 FEET OF YELLOW.

RAISED REFLECTIVE PAVEMENT MARKERS SHALL BE PLACED IN THE DOUBLE LANE LINE MARKERS PATTERN AS SHOWN ON STANDARD 781001.

THE RESIDENT ENGINEER SHALL BE THE SOLE JUDGE CONCERNING THE CURING TIME FOR THE VARIOUS BITUMINOUS LIFTS.

THE FOLLOWING MIXTURE REQUIREMENTS ARE APPLICABLE FOR THIS PROJECT:

MIXTURE USE:	SURFACE COURSE	MIXTURE USE(S):	SHOULDERS
PG GRADE:	SBS PG 70-22	PG GRADE:	PG 58-22
RAP%:	0%	RAP%:	30%
DESIGN AIR VOIDS:	4.0% @ NDESIGN = 105	DESIGN AIR VOIDS:	2.0% @ NDESIGN = 30
MIXTURE COMPOSITION:	IL-9.5	MIXTURE COMPOSITION:	IL-9.5
FRICTION AGGREGATE:	MIXTURE D	FRICTION AGGREGATE:	N/A

MIXTURE USE(S):	BINDER COURSE
PG GRADE:	SBS PG 70-22
RAP%:	0%
DESIGN AIR VOIDS:	4.0% @ NDESIGN = 105
MIXTURE COMPOSITION:	IL-19.0
FRICTION AGGREGATE:	N/A

THE EXISTING PAVEMENT SHALL BE PATCHED IN ACCORDANCE WITH SECTION 442 OF THE "STANDARD SPECIFICATIONS FOR ROAD AND BRIDGE CONSTRUCTION". THE QUANTITIES OF PATCHING ARE ESTIMATES ONLY AND THE FINAL QUANTITIES AND PATCH LOCATIONS SHALL BE DETERMINED BY THE ENGINEER. ONLY A NON-CHLORIDE ACCELERATOR SHALL BE ALLOWED FOR PAVEMENT PATCHING. NO BITUMINOUS CONCRETE SURFACE COURSE SHALL BE LAID UNTIL ALL PATCHING IS COMPLETE, INCLUDING THE ADJACENT LANE AND SHOULDER.

THE FOLLOWING RATES OF APPLICATION HAVE BEEN USED IN CALCULATING PLAN QUANTITIES:

AGGREGATE SHOULDERS, TYPE B	3.24 TONS/CU YD
BITUMINOUS MATERIALS (PRIME COAT)	0.10 GAL/SQ YD
AGGREGATE (PRIME COAT)	4.00 LBS/SQ YD
BITUMINOUS CONCRETE	112 LBS/SQ YD/INCH

THE EXISTING PAVEMENT REINFORCEMENT ON FAI ROUTE 64 IS 3/4 INCHES IN DIAMETER.

THE FOLLOWING RATES OF APPLICATION SHALL BE USED FOR SEEDING AND MULCHING ALL AREAS DISTURBED BY CONSTRUCTION OF PIPE UNDERDRAIN (SPECIAL) AND CONCRETE HEADWALL FOR PIPE DRAINS:

NITROGEN FERTILIZER NUTRIENT	90 LB/ACRE
PHOSPHORUS FERTILIZER NUTRIENT	90 LB/ACRE
POTTASIAM FERTILIZER NUTRIENT	90 LB/ACRE
AGRICULTURAL GROUND LIMESTONE	2 TON/ACRE
MULCH	2 TON/ACRE

REVISIONS	
NAME	DATE

ILLINOIS DEPARTMENT OF TRANSPORTATION

GENERAL NOTES

SCALE: VERT. _____
HORIZ. _____

DATE _____

DRAWN BY _____
CHECKED BY _____

stef fenmk
3/29/2005
c:\projects\94860d\04301pa.dgn



SUMMARY OF QUANTITIES

FBI	SECTION	COUNTY	TOTAL SHEETS	SHEET NO.
64	*	JEFFERSON	19	4

FBI PROJ. DIST. NO. 7
BLANKET
FBI. AD. PROJECT NO.
CONTRACT NO. 94860
* (41-6,41-6-1)RS-1

SUMMARY OF QUANTITIES			90% FED. 10% STATE TOTAL QUANTITIES	CONSTRUCTION TYPE CODE		
CODE NO	ITEM	UNIT		1000		
60100077	SHOULDER REMOVAL AND REPLACEMENT 11. 1/4"	FOOT	115555	115555		
40600100	BITUMINOUS MATERIALS (PRIME COAT)	GALLON	15299	15299		
40600300	AGGREGATE (PRIME COAT)	TON	306	306		
40600895	CONSTRUCTING TEST STRIP	EACH	2	2		
40600990	TEMPORARY RAMP	SQ YD	320	320		
44000004	BITUMINOUS SURFACE REMOVAL 1"	SQ YD	102434	102434		
44200553	CLASS A PATCHES, TYPE II, 10 INCH	SQ YD	611	611		
44200557	CLASS A PATCHES, TYPE III, 10 INCH	SQ YD	1090	1090		
44200559	CLASS A PATCHES, TYPE IV, 10 INCH	SQ YD	1899	1899		
44213000	PATCHING REINFORCEMENT	SQ YD	3600	3600		
44213200	SAW CUTS	FOOT	13062	13062		
45000130	RELIEF JOINT 4"	FOOT	192	192		
48101200	AGGREGATE SHOULDERS, TYPE B	TON	1721	1721		
48202000	BITUMINOUS SHOULDERS SUPERPAVE	TON	8765	8765		
60100060	CONCRETE HEADWALL FOR PIPE DRAINS	EACH	256	256		
60107700	PIPE UNDERDRAINS 6"	FOOT	114743	114743		
60108200	PIPE UNDERDRAINS 6" (SPECIAL)	FOOT	5120	5120		
* 63000000	STEEL PLATE BEAM GUARD RAIL, TYPE A	FOOT	1325	1325		
* 63100085	TRAFFIC BARRIER TERMINAL, TYPE 6	EACH	4	4		
* 63100167	TRAFFIC BARRIER TERMINAL TYPE 1, SPECIAL (TANGENT)	EACH	14	14		
63200310	GUARDRAIL REMOVAL	FOOT	1007.5	1007.5		
63500105	DELINEATORS	EACH	144	144		
63500120	DELINEATOR REMOVAL	EACH	186	186		
64200105	SHOULDER RUMBLE STRIP	FOOT	114743	114743		
67000400	ENGINEER'S FIELD OFFICE, TYPE A	CAL MO	10	10		
67100100	MOBILIZATION	L SUM	1	1		
70100305	TRAFFIC CONTROL AND PROTECTION, STANDARD 701400	L SUM	1	1		
70100450	TRAFFIC CONTROL AND PROTECTION, STANDARD 701201	L SUM	1	1		
70100700	TRAFFIC CONTROL AND PROTECTION, STANDARD 701406	L SUM	1	1		
70100800	TRAFFIC CONTROL AND PROTECTION, STANDARD 701401	L SUM	1	1		
70103815	TRAFFIC CONTROL SURVEILLANCE	CAL DA	37	37		
70300100	SHORT-TERM PAVEMENT MARKING	FOOT	20654	20654		
70300220	TEMPORARY PAVEMENT MARKING - LINE 4"	FOOT	114744	114744		

SUMMARY OF QUANTITIES			90% FED. 10% STATE TOTAL QUANTITIES	CONSTRUCTION TYPE CODE		
CODE NO	ITEM	UNIT		1000		
70300240	TEMPORARY PAVEMENT MARKING - LINE 6"	FOOT	14343	14343		
70301000	WORK ZONE PAVEMENT MARKING REMOVAL	SQ FT	3442	3442		
78003130	PREFORMED PLASTIC PAVEMENT MARKING, TYPE B - LINE 6"	FOOT	14343	14343		
* 78005110	EPOXY PAVEMENT MARKING - LINE 4"	FOOT	114744	114744		
* 78100100	RAISED REFLECTIVE PAVEMENT MARKER	EACH	1436	1436		
* 78200410	GUARDRAIL MARKERS, TYPE A	EACH	70	70		
* 78201000	TERMINAL MARKER - DIRECT APPLIED	EACH	14	14		
* X0300247	REMOVE WOOD POST	EACH	3	3		
X0322729	MATERIAL TRANSFER DEVICE	TON	32128	32128		
X0349800	CONCRETE HEADWALL FOR PIPE UNDERDRAIN REMOVAL	EACH	216	216		
X4066530	POLYMERIZED BITUMINOUS CONCRETE SURFACE COURSE, SUPERPAVE, MIX "D", N105	TON	12851	12851		
X4066660	POLYMERIZED BITUMINOUS CONCRETE BINDER COURSE, SUPERPAVE, IL-19.0, N105	TON	19277	19277		
X4409420	BITUMINOUS SURFACE REMOVAL 3 1/4"	SQ YD	152991	152991		
Z0075310	TIE BARS 3/4"	EACH	676	676		
⊙ Z0076600	TRAINEES	HOUR	500	500		
Z0077800	WOOD POST	EACH	30	30		

⊙ Y080
* SPECIALTY ITEMS

REVISIONS	
NAME	DATE

ILLINOIS DEPARTMENT OF TRANSPORTATION

SUMMARY OF QUANTITIES

SCALE: VERT. _____
HORIZ. _____
DATE _____
DRAWN BY _____
CHECKED BY _____

steffennk
3/29/2005
c:\projects\94860d\d04301pa.dgn

FAI NO.	SECTION	COUNTY	TOTAL SHEETS	SHEET NO.
64	.	JEFFERSON	19	5
FED. ROAD DIST. NO. 7		BLDG. NO.	FED. AID PROJECT NO.	
CONTRACT NO. 94860 • (41-6,41-6-1)RS-1				

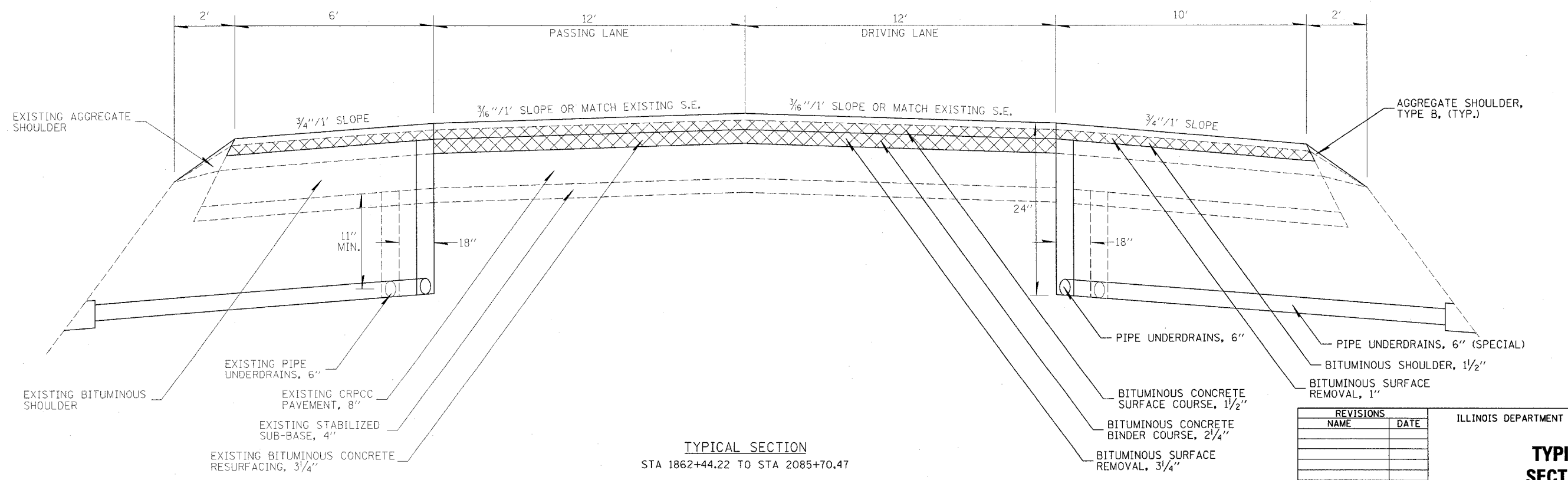
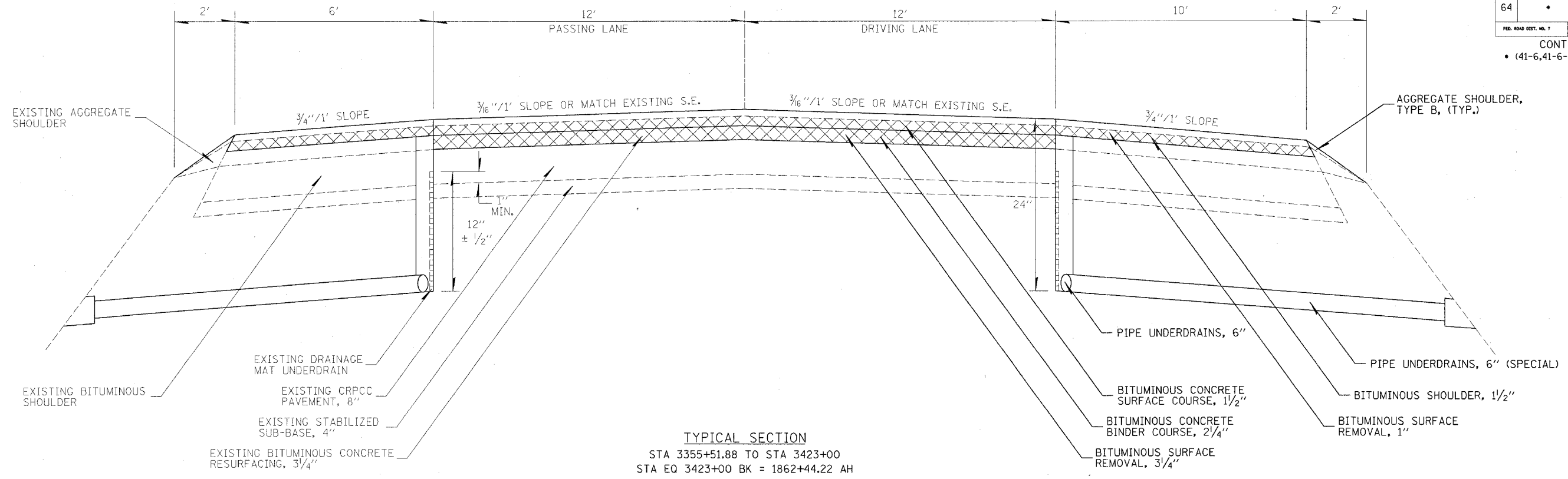

REVISIONS	
NAME	DATE

ILLINOIS DEPARTMENT OF TRANSPORTATION

TYPICAL SECTIONS

SCALE: VERT. _____
HORIZ. _____

DATE _____

DRAWN BY _____
CHECKED BY _____

steffemk
3/29/2005
c:\projects\94860d\d04301pa.dgn
RES DET

FAI ATE	SECTION	COUNTY	TOTAL SHEETS	SHEET NO.
64	.	JEFFERSON	19	6

FED. ROAD DIST. NO. 7 ILLINOIS FED. AID PROJECT NO.
CONTRACT NO. 94860
• (41-6,41-6-1)RS-1

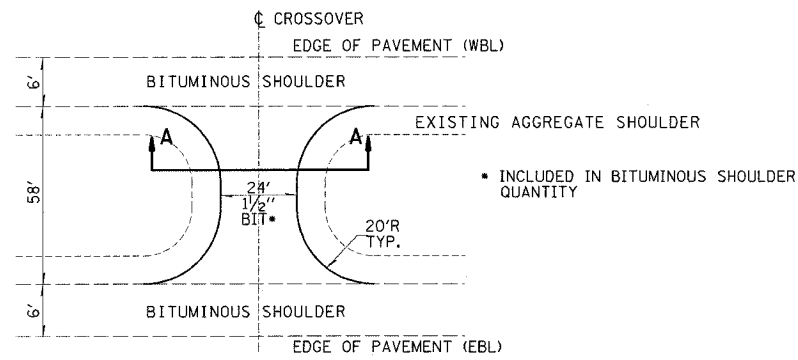

PLAN VIEW

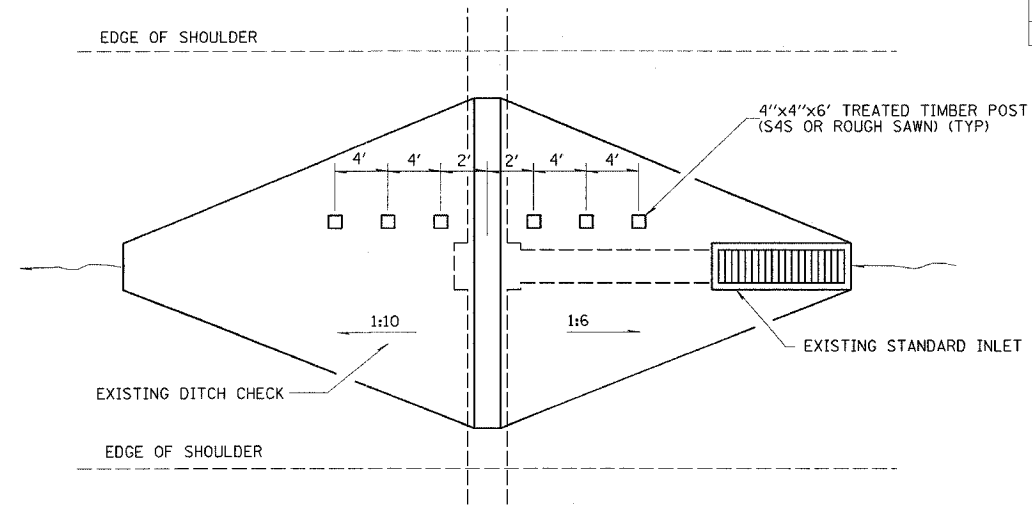

PLAN VIEW

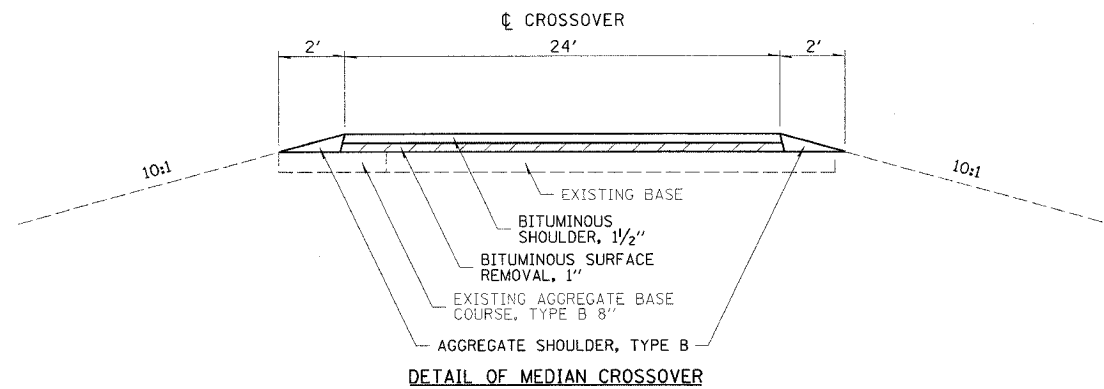

DETAIL OF MEDIAN CROSSOVER

SECTION A-A
STA. 2006+82
STA. 2082+06

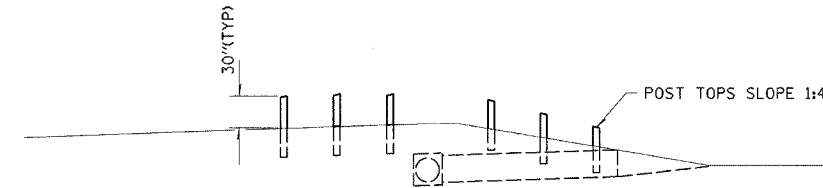

PROFILE VIEW

DETAIL OF WOOD POST BARRIER

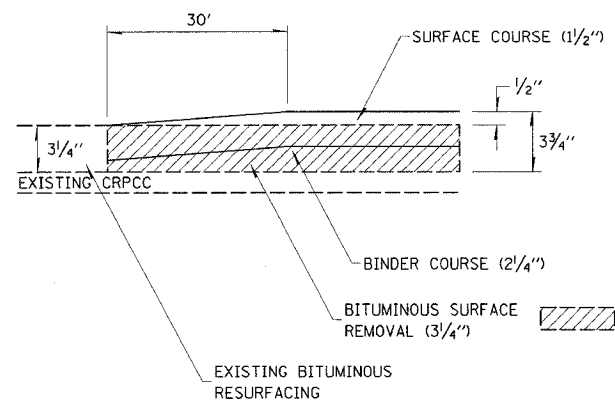

BUTT JOINT DETAIL

LOCATION	WOOD POSTS		
	EXISTING POSTS EACH	QUANTITY REMOVED EACH	QUANTITY ADDED EACH
3369+50	0	0	6
3380+50	3	0	6
3402+90	4	0	6
1877+00	8	0	6
1902+40	3	0	6
1910+85	5	0	6
1922+50	13	3	6
1936+20	4	0	6
1944+50	5	0	6
1970+85	5	0	6
2021+55	4	0	6
2045+50	4	0	6
2059+35	4	0	6
2070+40	4	0	6
TOTAL	6	3	30

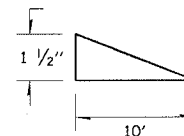

TEMPORARY RAMP DETAILS

EASTBOUND	WESTBOUND
STA 3355+51.88 TO STA 3355+81.88	STA 3355+51.88 TO STA 3355+81.88
STA 1889+97.00 TO STA 1890+27.00	STA 1889+97.00 TO STA 1890+27.00
STA 1891+58.50 TO STA 1891+88.50	STA 1891+58.50 TO STA 1891+88.50
STA 2030+89.62 TO STA 2031+19.62	STA 2030+84.69 TO STA 2031+14.69
STA 2033+76.62 TO STA 2034+06.62	STA 2033+71.69 TO STA 2034+01.69
STA 2085+40.47 TO STA 2085+70.47	STA 2085+40.47 TO STA 2085+70.47

EASTBOUND	WESTBOUND
STA 3355+51.88 TO STA 3355+61.88	STA 3355+51.88 TO STA 3355+61.88
STA 1890+17.00 TO STA 1890+27.00	STA 1890+17.00 TO STA 1890+27.00
STA 1891+58.50 TO STA 1891+68.50	STA 1891+58.50 TO STA 1891+68.50
STA 2031+09.62 TO STA 2031+19.62	STA 2031+04.69 TO STA 2031+14.69
STA 2033+76.62 TO STA 2034+86.62	STA 2033+71.69 TO STA 2034+81.69
STA 2085+60.47 TO STA 2085+70.47	STA 2085+60.47 TO STA 2085+70.47

REVISIONS	
NAME	DATE

ILLINOIS DEPARTMENT OF TRANSPORTATION

**RESURFACING
DETAILS**

SCALE: VERT.
HORIZ.
DATE

DRAWN BY
CHECKED BY

steffenmk
3/29/2005
c:\projects\94860d\d04301pa.dgn

SCH

FBI	SECTION	COUNTY	TOTAL SHEETS	SHEET NO.
64	*	JEFFERSON	19	7

FED. ROAD DIST. NO. 7 ILLINOIS FED. AID PROJECT NO.
CONTRACT NO. 94860
* (41-6,41-6-1)RS-1

PAVEMENT MARKING SCHEDULE											
STATION TO STATION	LENGTH	EPOXY PAVEMENT MARKING - LINE 4" (YELLOW)	EPOXY PAVEMENT MARKING - LINE 4" (WHITE)	PERFORMED PLASTIC PAVEMENT MARKING, TYPE B - LINE 6"	SHORT-TERM PAVEMENT MARKING	WORK ZONE PAVEMENT MARKING REMOVAL	TEMPORARY PAVEMENT MARKING - LINE 4" (YELLOW)	TEMPORARY PAVEMENT MARKING - LINE 4" (WHITE)	TEMPORARY PAVEMENT MARKING - LINE 6" (WHITE)	RAISED REFLECTIVE PAVEMENT MARKER	DELINEATORS
	FEET	FEET	FEET	FEET	FEET	SQ FT	FEET	FEET	FEET	EACH	EACH
I-64 EB 3355+51.88 3423+00.00 Sta EQ 3423+00.00 1862+44.22 1862+44.22 1890+27.00 1890+27.00 1891+58.50 Bridge Omission 1891+58.50 2031+19.62 2031+19.62 2033+76.62 Bridge Omission 2033+76.62 2085+70.47	6748.12	6748.1	6748.1	1687	2429.3	404.9	6748.1	6748.1	1687	169	17
I-64 WB 3355+51.88 3423+00.00 Sta EQ 3423+00.00 1862+44.22 1862+44.22 1890+27.00 1890+27.00 1891+58.50 Bridge Omission 1891+58.50 2031+14.69 2031+14.69 2033+71.69 Bridge Omission 2033+71.69 2085+70.47	6748.12	6748.1	6748.1	1687	2429.3	404.9	6748.1	6748.1	1687	169	17
TOTALS	57372	57372	57372	14343	20654	3442	57372	57372	14343	1436	144

PATCHING SCHEDULE						
LOCATION	CLASS A PATCHES, TYPE II, 10"	CLASS A PATCHES, TYPE III, 10"	CLASS A PATCHES, TYPE IV, 10"	PATCHING REINFORCEMENT	SAW CUTTING	TIE BARS
I-64 EBDL EDPL WBDL WBPL	161.2 0.0 331.9 117.3	530.7 0.0 480.0 78.7	1073.2 0.0 752.2 73.3	1765.1 0.0 1564.1 269.3	5865.5 0.0 5974.0 1222.5	383 0 267 26
TOTALS	611	1090	1899	3599	13062	676

PAVING SCHEDULE												
STATION TO STATION	LENGTH	EXISTING PAVEMENT WIDTH	AREA	BITUMINOUS MATERIALS (PRIME COAT)	AGGREGATE (PRIME COAT)	POLYMERIZED BITUMINOUS CONCRETE, BINDER COURSE, SUPERPAVE, IL-19.0, N105	POLYMERIZED BITUMINOUS CONCRETE, SURFACE COURSE, SUPERPAVE, MIX "D", N105	BITUMINOUS SURFACE REMOVAL 3 1/4"	BITUMINOUS SURFACE REMOVAL 1"	SHOULDER RUMBLE STRIP	BITUMINOUS SHOULDERS SUPERPAVE	AGGREGATE SHOULDERS, TYPE B
	LIN FT	FEET	SQ YD	GALLON	TON	TON	TON	SQ YD	SQ YD	FOOT	TON	TON
EASTBOUND 3355+51.88 TO 3423+00.00 STA EQ 3423+00.00 BK = 1862+44.22 AH 1862+44.22 TO 1890+27.00 1890+27.00 TO 1891+58.50 BRIDGE OMISSION 1891+58.50 TO 2031+19.62 2031+19.62 TO 2033+76.62 BRIDGE OMISSION 2033+76.62 TO 2085+70.47 TOTAL EASTBOUND	6748.12	24	17995	1799	36	2267	1512	17995	11997	13496	1008	202
WESTBOUND 3355+51.88 TO 3423+00.00 STA EQ 3423+00.00 BK = 1862+44.22 AH 1862+44.22 TO 1890+27.00 1890+27.00 TO 1891+58.50 BRIDGE OMISSION 1891+58.50 TO 2031+14.69 2031+14.69 TO 2033+71.69 BRIDGE OMISSION 2033+71.69 TO 2085+70.47 TOTAL WESTBOUND	6748.12	24	17995	1799	36	2267	1512	17995	11997	13496	1008	202.4
PROJECT TOTAL	57371.74		152991	15299	306	19277	12851	152991	102048	114743	8572	1721

RELIEF JOINT	
EAST BOUND STATION	LENGTH
1889+79	24
1891+86	24
2030+95	24
2034+05	24
SUB TOTAL	96
WEST BOUND STATION	LENGTH
1889+79	24
1891+86	24
2030+95	24
2034+05	24
SUB TOTAL	96
TOTAL	192 FEET

DELINEATOR REMOVAL	
LOCATION	QUANTITY (EACH)
I-64 EB	93
I-64 WB	93
TOTAL	186

BITUMINOUS SHOULDERS SUPERPAVE FOR MEDIAN CROSSOVER	
LOCATION	QUANTITY (TONS)
STA 2006+82	16
STA 2082+06	16
TOTAL	32 TONS

REVISIONS	
NAME	DATE

ILLINOIS DEPARTMENT OF TRANSPORTATION
RESURFACING, PATCHING, & PAVEMENT MARKING SCHEDULES
SCALE: VERT. _____
DATE _____ HORIZ. _____
DRAWN BY _____
CHECKED BY _____

stefenmk
3/29/2005
c:\projects\94860d\04301p.dgn

FAI SHEET	SECTION	COUNTY	TOTAL SHEETS	SHEET NO.
64	*	JEFFERSON	19	9
FED. ROAD DIST. NO. 7		ILLINOIS	FED. AID PROJECT NO.	

CONTRACT NO. 94860
* (41-6,41-6-1)RS-1

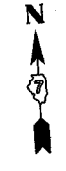

REVISIONS	
NAME	DATE

ILLINOIS DEPARTMENT OF TRANSPORTATION
**STA. 3355 + 00
TO
STA. 3380 + 00**
SCALE: VERT. DRAWN BY
 HORIZ. CHECKED BY
DATE

steffenmk
3/29/2005
c:\projects\94860d\0430\pa.dgn

2

FAI RTE.	SECTION	COUNTY	TOTAL SHEETS	SHEET NO.
64	*	JEFFERSON	19	10

FED. ROAD DIST. NO. 7 BLINDS FED. AID PROJECT NO.

CONTRACT NO. 94860
* (41-6,41-6-1)RS-1



CURVE DATA
 PI STA. = 3403+33.42
 $\Delta = 23^\circ 38' 00''$
 $D = 0^\circ 28' 00''$
 $R = 12,277.67'$
 $T = 2,568.67'$
 $L = 5,064.29'$
 $E = 565.82'$
 P.C. STA. = 3377+64.75
 P.T. STA. = 1867+73.26
 $S.E. = 0.016 \text{ FT./FT.}$
 ATTAINED IN 200'
 STA. 3376+31.4 TO STA. 3378+31.4
 STA. 1867+06.7 TO STA. 1869+06.7

EXIST. CURVE TR26-1
 PI STA. = 10+00.00
 $\Delta = 5^\circ 25' 00'' \text{ (RT)}$
 $D = 0^\circ 56' 00''$
 $R = 6,138.83'$
 $T = 290.39'$
 $L = 580.35'$
 $E = 6.86'$
 $e = \text{-----}$
 $T.R. = \text{-----}$
 $S.E. \text{ RUN} = \text{-----}$
 P.C. STA. = 7+09.61
 P.T. STA. = 12+89.96



REVISIONS	
NAME	DATE

ILLINOIS DEPARTMENT OF TRANSPORTATION
STA. 3380 + 00
TO
STA. 3410 + 00
 SCALE: VERT. DRAWN BY
 HORIZ. CHECKED BY
 DATE

steffenmk
3/29/2005
c:\projects\948600\d04301pa.dgn

FBI ATE.	SECTION	COUNTY	TOTAL SHEETS	SHEET NO.
64	•	JEFFERSON	19	11

FED. ROAD DIST. NO. 7
ILLINOIS
FED. AID PROJECT NO.
CONTRACT NO. 94860
• (41-6,41-6-1)RS-1



CURVE DATA
PI STA. = 3403+33.42
 $\Delta = 23^\circ 38' 00''$
 $D = 0^\circ 28' 00''$
 $R = 12,277.67'$
 $T = 2,568.67'$
 $L = 5,064.29'$
 $E = 565.82'$
P.C. STA. = 3377+64.75
P.T. STA. = 1867+73.26
S.E. = 0.016 FT./FT.
ATTAINED IN 200'
STA. 3376+31.4 TO STA. 3378+31.4
STA. 1867+06.7 TO STA. 1869+06.7

EQUATION:
STA 3423+00.8K =
STA 1862+44.22 AH

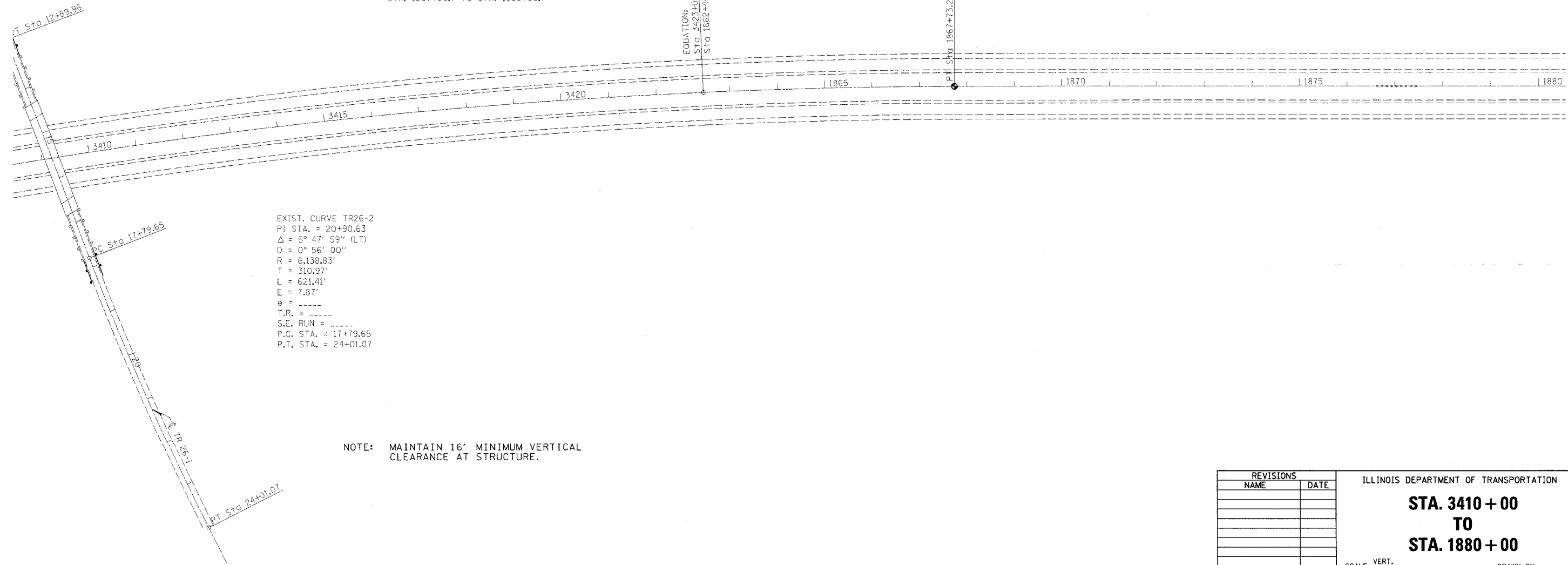

EXIST. CURVE TR26-2
PI STA. = 20+90.63
 $\Delta = 5^\circ 47' 59''$ (LT)
 $D = 0^\circ 56' 00''$
 $R = 6,138.83'$
 $T = 310.97'$
 $L = 621.41'$
 $E = 7.87'$
 $e = \text{-----}$
T.R. = -----
S.E. RUN = -----
P.C. STA. = 17+79.65
P.T. STA. = 24+01.07

NOTE: MAINTAIN 16' MINIMUM VERTICAL CLEARANCE AT STRUCTURE.

REVISIONS	
NAME	DATE

ILLINOIS DEPARTMENT OF TRANSPORTATION
**STA. 3410 + 00
TO
STA. 1880 + 00**
SCALE: VERT. _____
DATE: _____ HORIZ. _____
DRAWN BY _____
CHECKED BY _____

stef fenmk
 3/29/2005
 c:\projects\94860\d\04301pa.dgn

FAI RTE.	SECTION	COUNTY	TOTAL SHEETS	SHEET NO.
64	.	JEFFERSON	19	12

FED. ROAD DIST. NO. 7
 ILLINOIS
 FED. AID PROJECT NO.
 CONTRACT NO. 94860
 • (41-6,41-6-1)RS-1

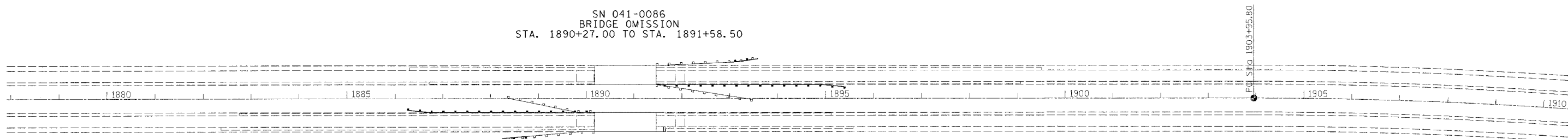

REVISIONS	
NAME	DATE

ILLINOIS DEPARTMENT OF TRANSPORTATION

**STA. 1880 + 00
 TO
 STA. 1910 + 00**

SCALE: VERT.
 HORIZ.
 DATE

DRAWN BY
 CHECKED BY

steffennk
 3/29/2005
 c:\projects\94860d\40430\pa.dgn

FAI NO.	SECTION	COUNTY	TOTAL SHEETS	SHEET NO.
64	•	JEFFERSON	19	13

FED. ROAD DIST. NO. 7 ILLINOIS FED. AID PROJECT NO.
 CONTRACT NO. 94860
 • (41-6,41-6-1)RS-1

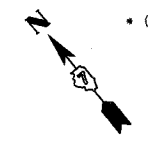

CURVE DATA
 P.I. STA. = 1914+28.38
 $\Delta = 12^\circ 20' 35''$ (RT)
 $D = 0^\circ 36' 00''$
 $R = 9,549.30'$
 $T = 1,032.58'$
 $L = 2,057.18'$
 $E = 55.66'$
 P.C. STA. = 1903+95.80
 P.T. STA. = 1924+52.98
 $S.E. = 0.017$ FT./FT.
 ATTAINED FROM
 STA. 1902+62 TO STA. 1904+62
 STA. 1923+86 TO STA. 1925+86

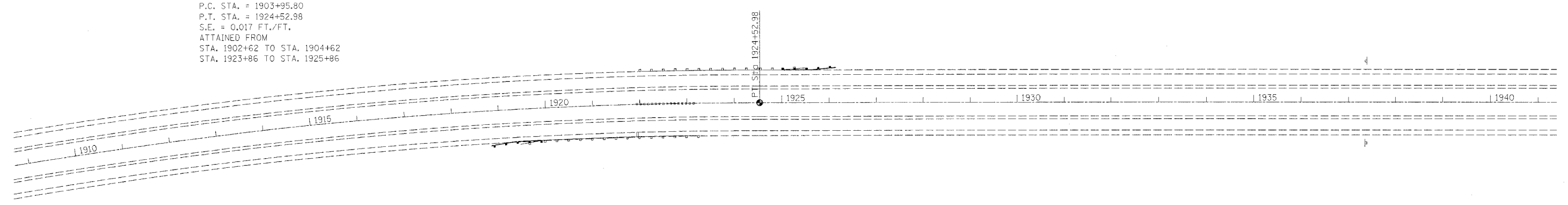

REVISIONS	
NAME	DATE

ILLINOIS DEPARTMENT OF TRANSPORTATION
**STA. 1910 + 00
 TO
 STA. 1940 + 00**
 SCALE: VERT. _____
 DATE _____ HORIZ. _____
 DRAWN BY _____
 CHECKED BY _____

steffemk
 3/29/2005
 c:\projects\94860d\04301pa.dgn

FAI RTE.	SECTION	COUNTY	TOTAL SHEETS	SHEET NO.
64	*	JEFFERSON	19	14

FED. ROAD DIST. NO. 1 BILLINGS FED. AID PROJECT NO.
 CONTRACT NO. 94860
 (41-6,41-6-1)RS-1

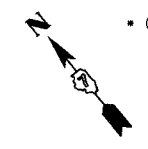

REVISIONS	
NAME	DATE

ILLINOIS DEPARTMENT OF TRANSPORTATION
**STA. 1940 + 00
 TO
 STA. 1970 + 00**
 SCALE: VERT. DRAWN BY
 HORIZ. CHECKED BY
 DATE

steffenmk
 3/29/2005
 c:\projects\94860d\0430\pa.dgn

FAI RTE.	SECTION	COUNTY	TOTAL SHEETS	SHEET NO.
64	•	JEFFERSON	19	15
FED. ROAD DIST. NO. 1	ILLINOIS	FED. AID PROJECT NO.		

CONTRACT NO. 94860
 • (41-6,41-6-1RS-1)

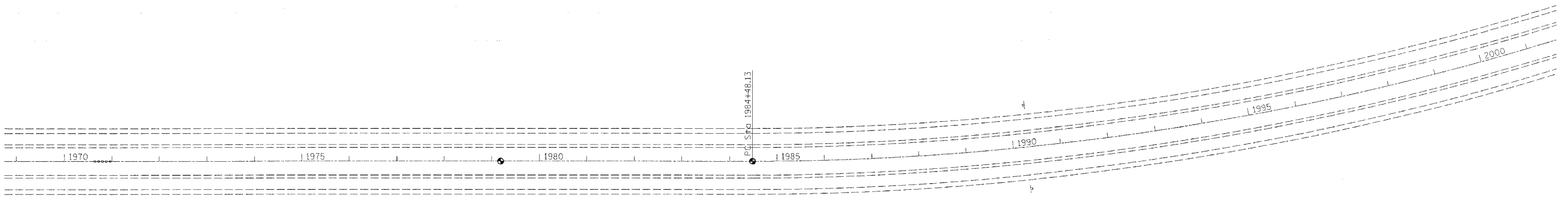
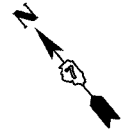

REVISIONS	
NAME	DATE

ILLINOIS DEPARTMENT OF TRANSPORTATION

**STA. 1970 + 00
 TO
 STA. 2000 + 00**

SCALE: VERT. _____
 HORIZ. _____

DATE _____ DRAWN BY _____
 CHECKED BY _____

steffenmk
 3/29/2005
 c:\projects\94860d\04301pa.dgn

FAI ATE.	SECTION	COUNTY	TOTAL SHEETS	SHEET NO.
64	*	JEFFERSON	19	16
FED. ROAD DIST. NO. 1		BILLINGS	FED. AID PROJECT NO.	

CONTRACT NO. 94860
 (41-6,41-6-1RS-1)



CURVE DATA
 P.I. STA. = 2004+56.16
 $\Delta = 38^\circ 37' 40''$ (LT)
 $D = 1^\circ 00' 00''$
 $R = 5,729.58'$
 $T = 2,008.03'$
 $L = 3,862.78'$
 $E = 341.69'$
 P.C. STA. = 1984+48.13
 P.T. STA. = 2023+10.91
 S.E. = 0.0279 FT./FT.
 ATTAINED FROM
 STA. 1983+15 TO STA. 1985+15
 STA. 2022+44 TO STA. 2024+44

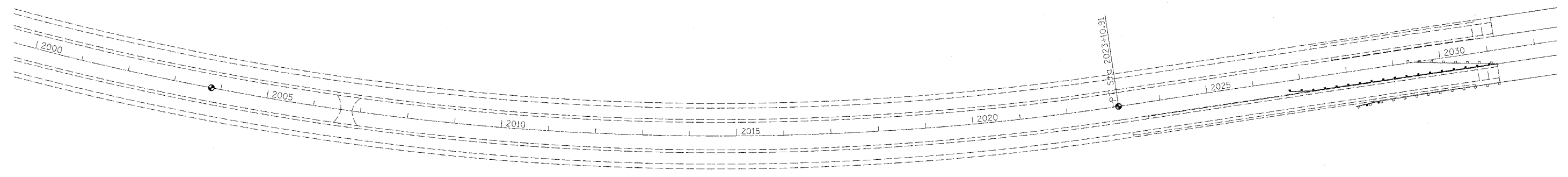

REVISIONS	
NAME	DATE

ILLINOIS DEPARTMENT OF TRANSPORTATION
STA. 2000 + 00
TO
STA. 2030 + 00
 SCALE: VERT. _____
 DATE: _____ HORIZ. _____
 DRAWN BY _____
 CHECKED BY _____

steffenmk
 3/29/2005
 c:\projects\94860d\04301pa.dgn

FAI RTE.	SECTION	COUNTY	TOTAL SHEETS	SHEET NO.
64	*	JEFFERSON	19	17

FED. ROAD DIST. NO. 7
 ILLINOIS
 FED. AID PROJECT NO.
 CONTRACT NO. 94860
 • (41-6,41-6-1)RS-1



SN 041-0078
 BRIDGE OMISSION
 STA. 2031+14.69 TO STA. 2033+71.69



SN 041-0077
 BRIDGE OMISSION
 STA. 2031+19.62 TO STA. 2033+76.62

REVISIONS	
NAME	DATE

ILLINOIS DEPARTMENT OF TRANSPORTATION
STA. 2030 + 00
TO
STA. 2060 + 00
 SCALE: VERT. _____
 HORIZ. _____
 DATE _____
 DRAWN BY _____
 CHECKED BY _____

stef fenmk
3/29/2005
c:\projects\94860\d0430\pa.dgn

10

FBI RTE.	SECTION	COUNTY	TOTAL SHEETS	SHEET NO.
64	•	JEFFERSON	19	18

FED. ROAD DIST. NO. 1 ILLINOIS FED. AID PROJECT NO.
CONTRACT NO. 94860
• (41-6,41-6-1)RS-1



REVISIONS	
NAME	DATE

ILLINOIS DEPARTMENT OF TRANSPORTATION
**STA. 2060 + 00
TO
STA. 2090 + 00**
SCALE: VERT. _____
DATE _____ HORIZ. _____
DRAWN BY _____
CHECKED BY _____

steffenmk
3/29/2005
c:\projects\94860\d04301pa.dgn
ETIPM

FAT NO.	SECTION	COUNTY	TOTAL SHEETS	SHEET NO.
64	*	JEFFERSON	19	19

FED. ROAD DIST. NO. 1 ILLINOIS FED. AID PROJECT NO.
CONTRACT NO. 94860
• (41-6,41-6-1)RS-1

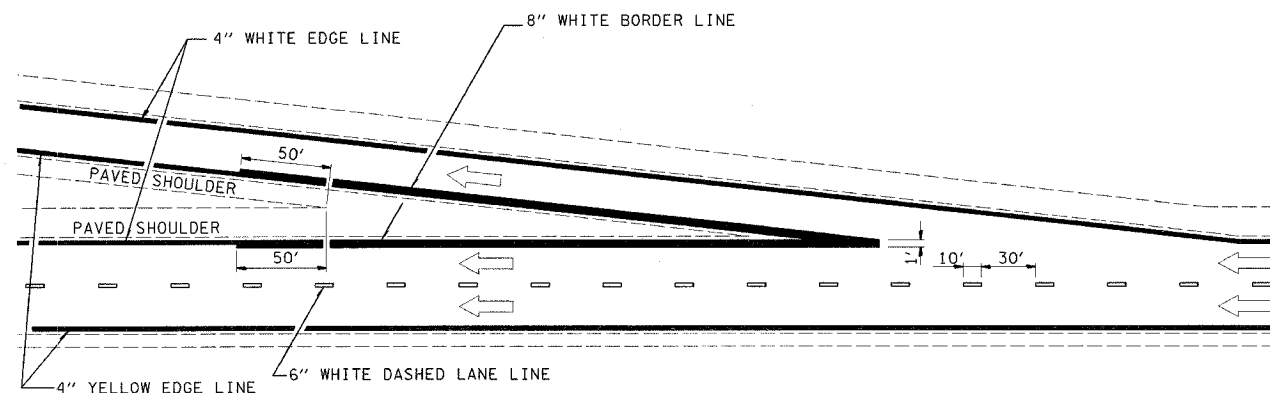

TYPICAL EXIT RAMP MARKING

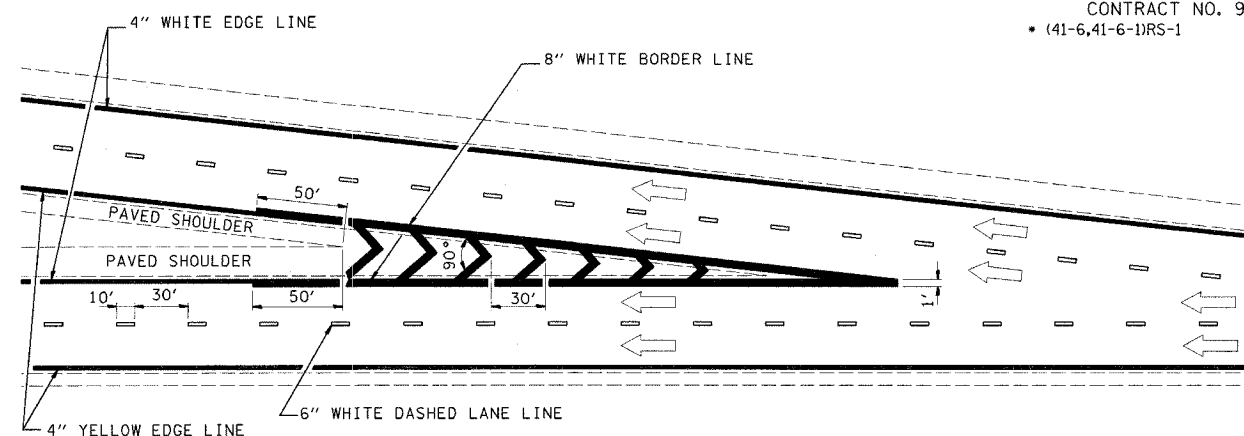

TYPICAL DIVERGENCE MARKING

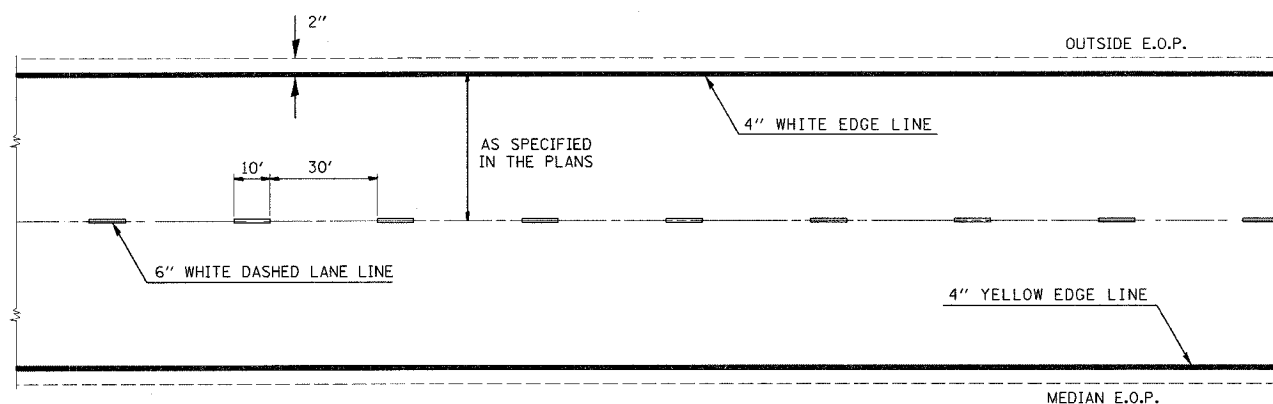

TYPICAL CENTERLINE & EDGELINE MARKINGS

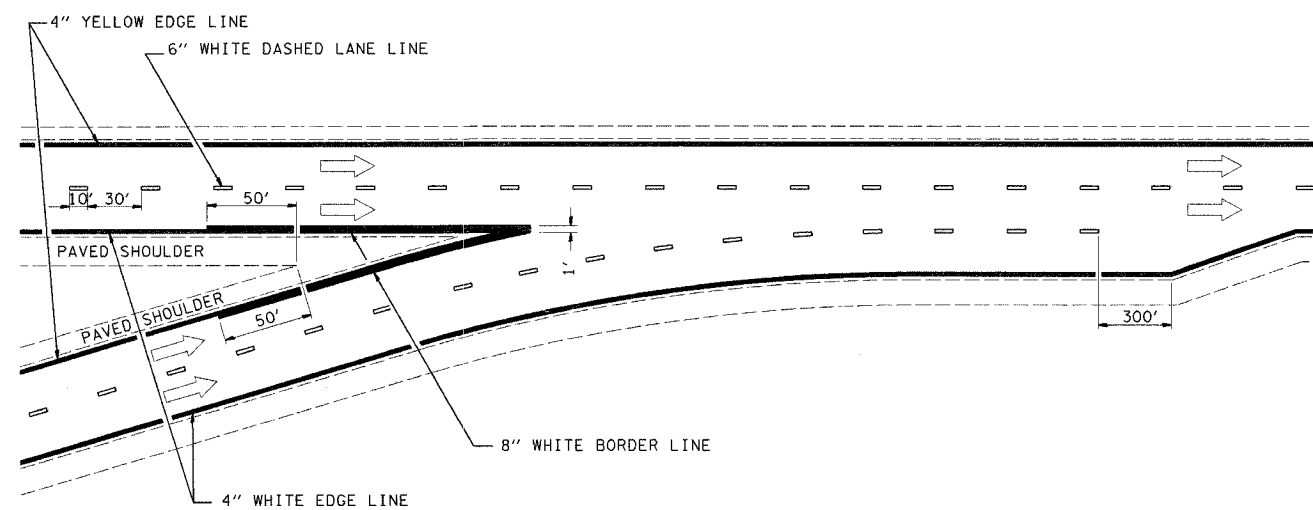

TYPICAL CONVERGENCE MARKING

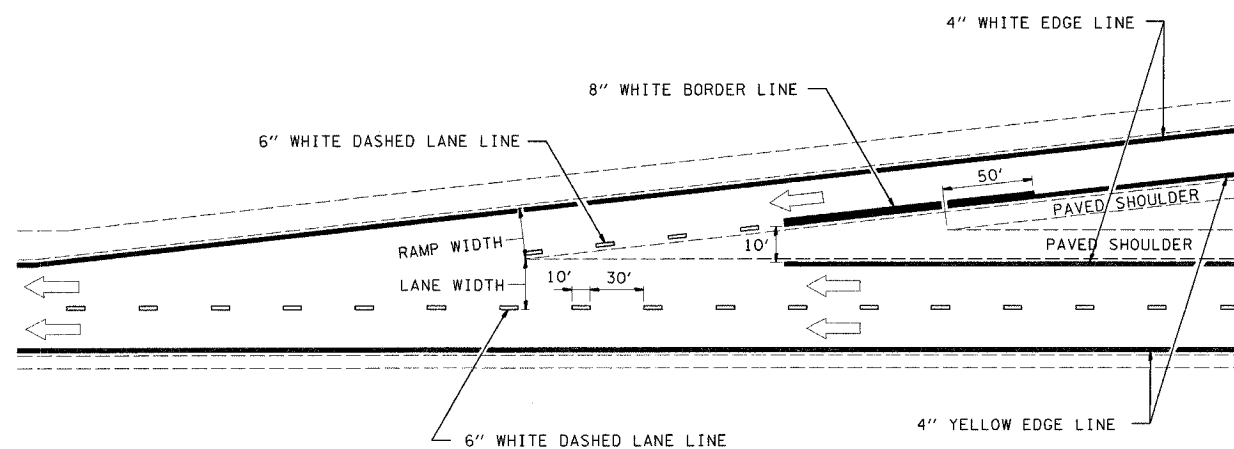

TYPICAL ENTRANCE RAMP MARKING

NOT TO SCALE

REVISIONS	
NAME	DATE
MMO	12-99
DRM	08-04

ILLINOIS DEPARTMENT OF TRANSPORTATION
**TYPICAL APPLICATIONS OF
INTERCHANGE
PAVEMENT MARKING**

SCALE: VERT. HORIZ. DATE ISSUED: 05-01-96 DRAWN BY CHECKED BY