

**STATE OF ILLINOIS
DEPARTMENT OF TRANSPORTATION
DIVISION OF HIGHWAYS
PLANS FOR PROPOSED
BRIDGE REPLACEMENT AND
REHABILITATION PROGRAM
AND
TOWNSHIP BRIDGE PROGRAM**

ROUTE NO.	SECTION	COUNTY	TOTAL SHEETS	SHEET NO.
T.R. 181	03-01112-00-BR	MARION	12	1
FED. ROAD DIST. NO.		ILLINOIS	PROJECT	

CONTRACT NO. 95428

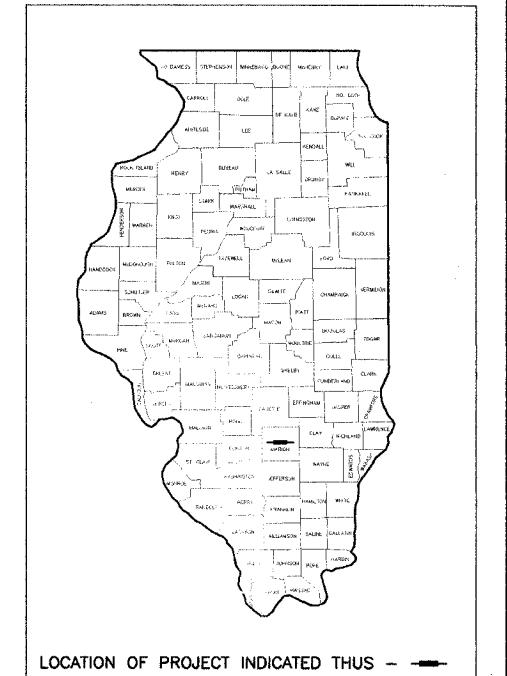

INDEX OF SHEETS

1	COVER SHEET
2	TYPICAL CROSS SECTION, GENERAL NOTES AND SUMMARY OF QUANTITIES
3	PLAN AND PROFILE SHEET
4-11	BRIDGE PLANS
12	CROSS SECTIONS
STANDARD 000001-04	STANDARD SYMBOLS, ABBREVIATIONS AND PATTERNS
STANDARD 280001-02	TEMPORARY EROSION CONTROL SYSTEMS
STANDARD 702001-05	TRAFFIC CONTROL DEVICES
STANDARD B.L.R. 21-6	TYPICAL APPLICATION OF TRAFFIC CONTROL DEVICES FOR CONSTRUCTION ON RURAL LOCAL HIGHWAYS



**SECTION 03-01112-00-BR
PROJECT NO. BROS-121(41)
MARION COUNTY
JOB NO. C-97-030-05
ALMA ROAD DISTRICT**

STA. 50+00 - CONSTRUCT SINGLE SPAN PRECAST PRESTRESSED CONCRETE DECK BEAM BRIDGE (51.59' BK. TO BK. ABUTMENTS) WITH SPILL THRU ABUTMENTS ON STEEL H PILES, 15' SKEW, 24' ROADWAY EXISTING STRUCTURE NO. 061-3098 PROPOSED STRUCTURE NO. 061-3298

END SECTION 03-01112-00-BR
STA. 50+30.80

BEGIN SECTION 03-01112-00-BR
STA. 49+69.21

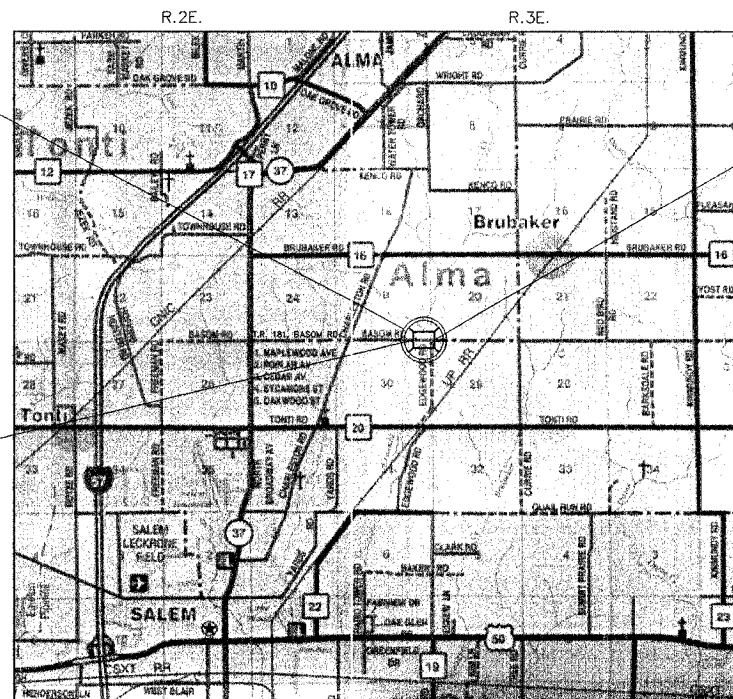

THE ACCEPTANCE OF THIS PROJECT IS BASED ON THE MINIMUM DESIGN CRITERIA FOR A FEDERAL-AID BRIDGE REPLACEMENT AND REHABILITATION PROGRAM

Maureen E. Koehl
DISTRICT ENGINEER OF LOCAL ROADS AND STREETS

STATE OF ILLINOIS
DEPARTMENT OF TRANSPORTATION

APPROVED *Jerry E. Conifera* 03-09-05 2005
LOCAL AGENCY REPRESENTATIVE

PASSED *Maureen E. Koehl* 4/1, 2005
DISTRICT ENGINEER OF LOCAL ROADS AND STREETS

APPROVED *Christine M. Reed* 4/1, 2005
CHRISTINE M. REED, P.E.
DEPUTY DIRECTOR OF HIGHWAYS
REGION FOUR ENGINEER

PLANS PREPARED BY CLARK ENGINEERS, INC.
DATE 3/2, 2005

Michael R. Quandt
MICHAEL R. QUANDT, P.E.



REVIEWED 3/3, 2005

BY *Jerry E. Conifera*
COUNTY ENGINEER
MARION COUNTY, ILLINOIS

REVIEWED 3-3, 2005

BY *Jerry Adams*
ROAD COMMISSIONER
ALMA ROAD DISTRICT
MARION COUNTY, ILLINOIS

48 HOURS PRIOR TO EXCAVATION CALL J.U.L.I.E.: 1-800-892-0123

CLASS ROAD: RURAL LOCAL ROAD
A.D.T. = 75
DESIGN SPEED = NONE

LOCATION MAP

APPROXIMATE SCALE - 1" = 1.0 MILES
NET LENGTH OF IMPROVEMENTS = 61.59 FOOT = 0.012 MILE

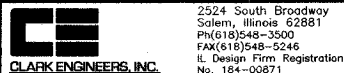

CE JOB NO. MAHD007