

NORTH BRIEGEL STREET

SOUTH BRIEGEL STREET

F.A. RTE.	SECTION	COUNTY	TOTAL SHEETS	SHEET NO.
9303	01-00032-05-PV	MONROE	23	13
STA.		TO STA.		
FED. ROAD DIST. NO.		ILLINOIS	FED. AID PROJECT	
INTERSECTION DETAILS				
CONTRACT NO. 97250				

POINT	STATION	DISTANCE, OFFSET	EOP ELEVATION (FEET)	REMARKS
1	94+96.84	13.00' LT	485.30	END OF RADIUS
2	95+29.82	13.00' LT	484.18	
3	95+62.84	13.00' LT	482.91	END OF RADIUS
4	95+10.98	18.86' LT	484.74	
5	95+29.83	18.86' LT	484.20	
6	95+48.70	18.86' LT	483.49	
7	95+16.84	33.00' LT	484.44	
8	95+29.84	33.00' LT	484.26	
9	95+42.84	33.00' LT	483.78	
10	95+17.85	53.00' LT	483.92	MATCH EXISTING
11	95+29.85	53.00' LT	484.34	MATCH EXISTING
12	95+41.85	53.00' LT	483.89	MATCH EXISTING
13	94+96.84	33.00' LT		CENTER OF 20' RADIUS
14	95+62.84	33.00' LT		CENTER OF 20' RADIUS

POINT	STATION	DISTANCE, OFFSET	EOP ELEVATION (FEET)	REMARKS
1	94+97.38	13.00' RT	485.28	END OF RADIUS
2	95+29.49	13.00' RT	484.19	
3	95+63.37	13.00' RT	482.89	
4	95+11.52	18.86' RT	484.82	
5	95+29.75	18.86' RT	484.27	
6	95+49.23	18.86' RT	483.53	
7	95+15.86	25.35' RT	484.70	EOP AT INLET
8	95+17.38	33.00' RT	484.72	
9	95+30.38	33.00' RT	484.47	
10	95+43.37	33.00' RT	483.94	
11	95+21.25	53.00' RT	484.75	MATCH EXISTING
12	95+31.28	53.00' RT	484.68	MATCH EXISTING
13	95+43.27	53.00' RT	484.06	MATCH EXISTING
14	94+97.38	33.00' RT		CENTER OF 20' RADIUS
15	95+63.37	33.00' RT		CENTER OF 20' RADIUS

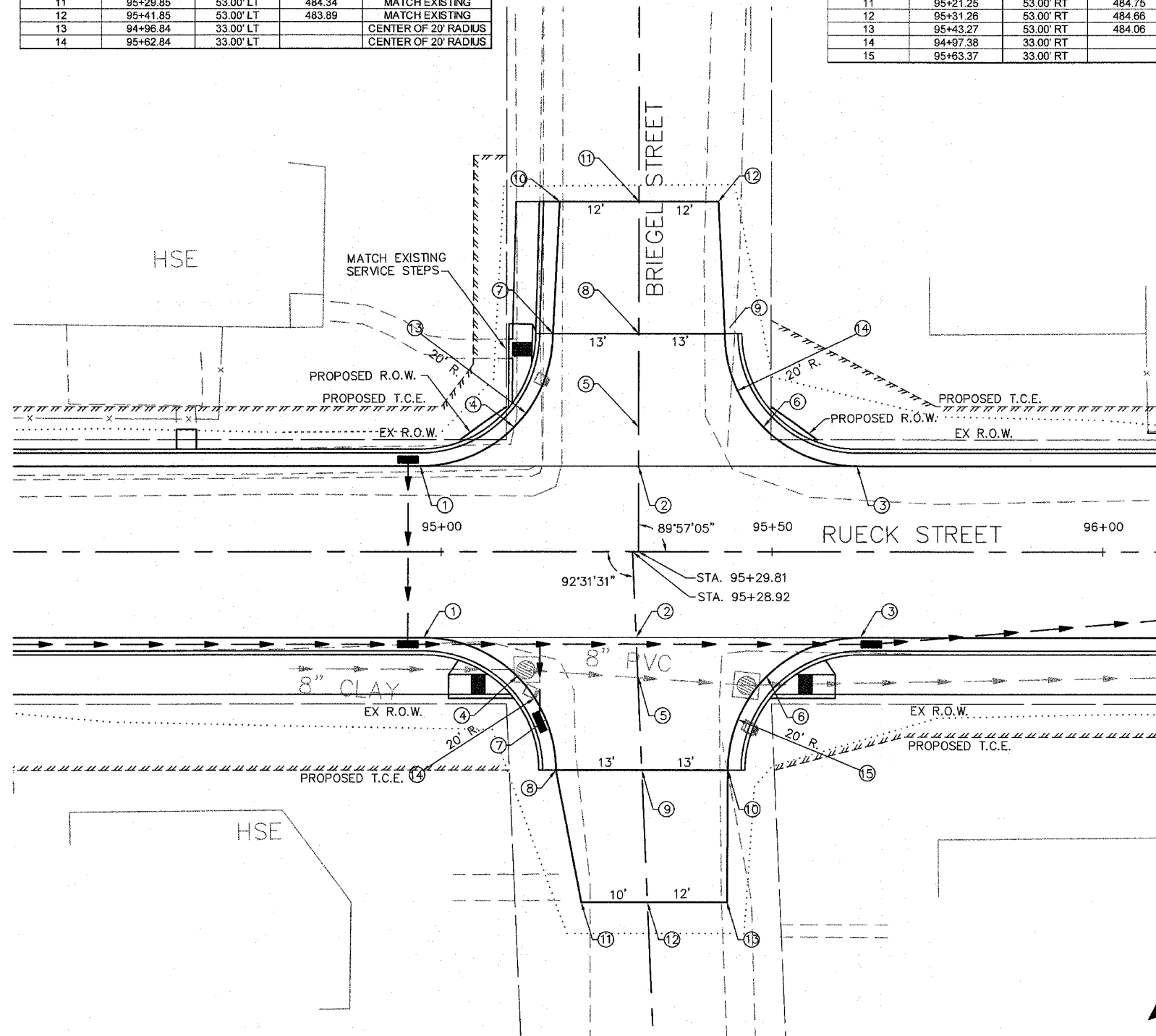

INTERSECTION LAYOUT AT BRIEGEL STREET & RUECK STREET

SCALE 1" = 10'

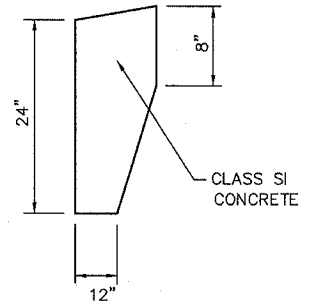
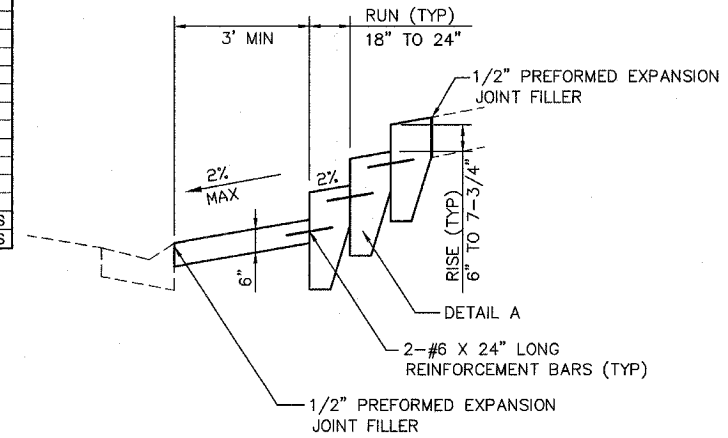

DETAIL A

* NUMBER AND DIMENSIONS OF STEPS TO BE DETERMINED BY THE ENGINEER IN THE FIELD

SEE SIDEWALK SCHEDULE FOR LOCATION

CONCRETE STEPS
(NOT TO SCALE)

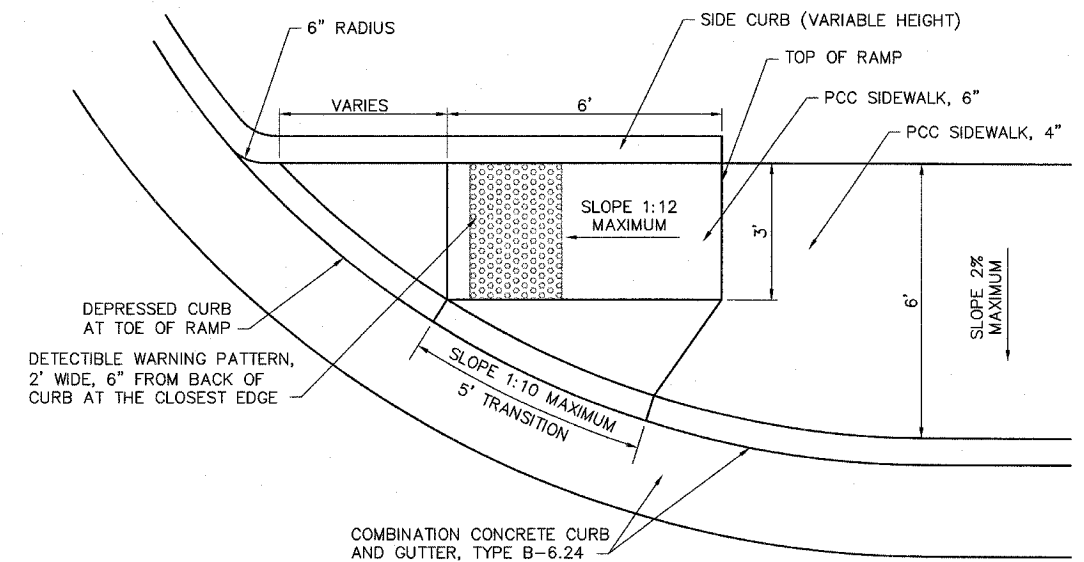

SEE PLANS FOR LOCATION

SIDEWALK RAMPS
(NOT TO SCALE)