

F. A. U. ROUTE	SECTION	COUNTY	TOTAL SHEETS	SHEET NUMBER
9732	00-00102-00-FP	JACKSON	27	7
JOB NO. C-99-033-03	PROJECT NO. M-5008(17)			
CITY OF CARBONDALE	CONTRACT NO. 99175			

DANIEL S. DOOLITTLE & PAMELA M. DOOLITTLE
BOOK 893 / PAGE 730

DANIEL S. DOOLITTLE & PAMELA M. DOOLITTLE
BOOK 893 / PAGE 730

C. DAVID PONCE-CAMPOS & BETH ANN PONCE
BOOK 0700 / PAGE 858

ROBERT A. & BETTY CRAWSHAW
BOOK 588 / PAGE 294

KENNETH J. KESSLER, JR. & CONSTANCE L. KESSLER
BOOK 550 / PAGE 417

H. LEDN BAGLEY & VICKIE E. BAGLEY
BOOK 615 / PAGE 628

JOSHUA BLACKBURN

UNION PLANTERS
BK787 / PG447

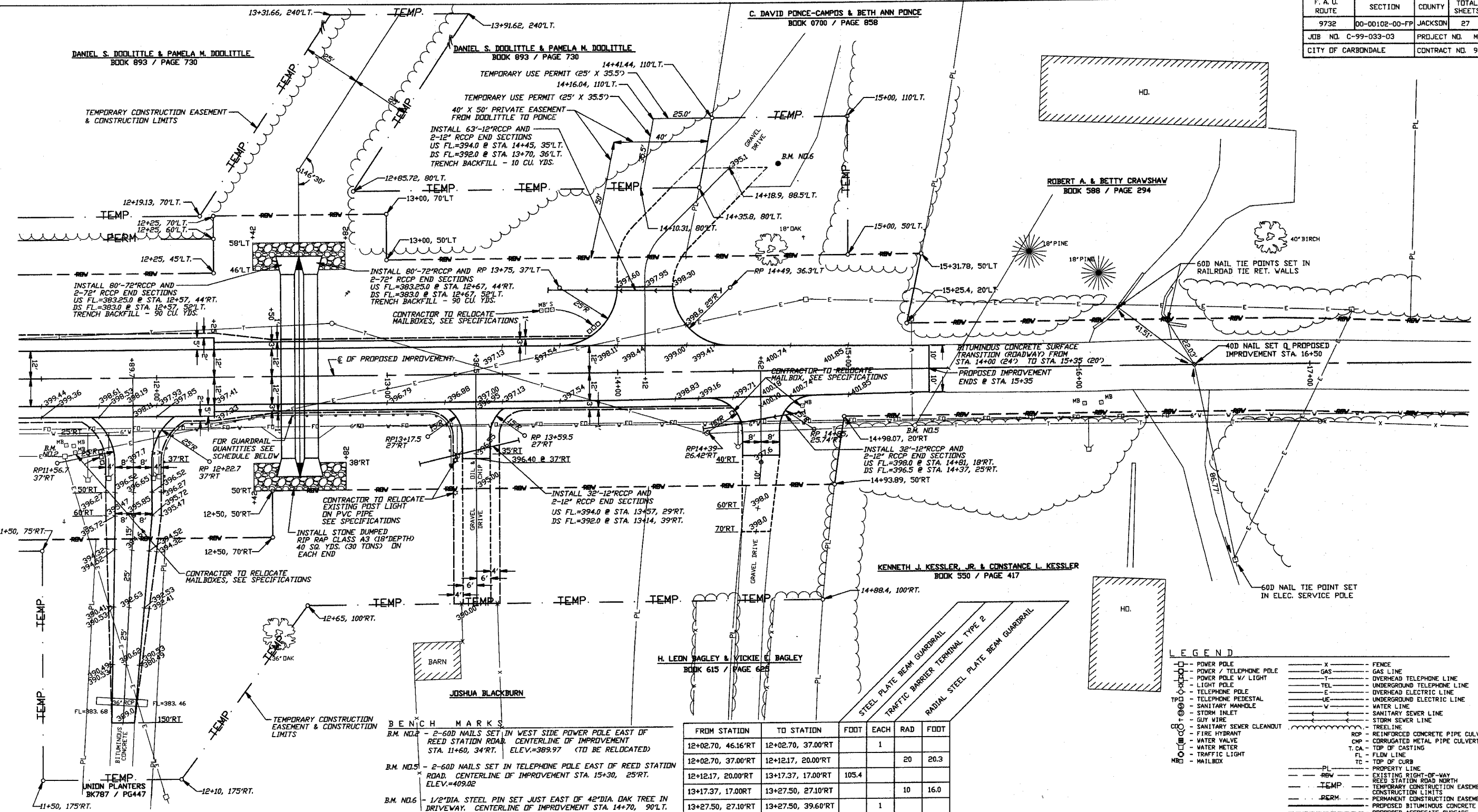

- BENCH MARKS**
- B.M. NO. 2 - 2-60D NAILS SET IN WEST SIDE POWER POLE EAST OF REED STATION ROAD. CENTERLINE OF IMPROVEMENT STA. 11+60, 34'RT. ELEV.=389.97 (TO BE RELOCATED)
 - B.M. NO. 5 - 2-60D NAILS SET IN TELEPHONE POLE EAST OF REED STATION ROAD. CENTERLINE OF IMPROVEMENT STA. 15+30, 25'RT. ELEV.=409.02
 - B.M. NO. 6 - 1/2" DIA. STEEL PIN SET JUST EAST OF 42" DIA. OAK TREE IN DRIVEWAY. CENTERLINE OF IMPROVEMENT STA. 14+70, 90'LT. ELEV.=396.98 (TO BE RELOCATED)

FROM STATION	TO STATION	FOOT	EACH	RAD	FOOT
12+02.70, 46.16'RT	12+02.70, 37.00'RT		1		
12+02.70, 37.00'RT	12+12.17, 20.00'RT			20	20.3
12+12.17, 20.00'RT	13+17.37, 17.00'RT	105.4			
13+17.37, 17.00'RT	13+27.50, 27.10'RT			10	16.0
13+27.50, 27.10'RT	13+27.50, 39.60'RT		1		

- LEGEND**
- POWER POLE
 - POWER / TELEPHONE POLE
 - UNDERGROUND TELEPHONE LINE
 - TELEPHONE POLE
 - TELEPHONE PEDESTAL
 - SANITARY MANHOLE
 - GUY WIRE
 - SANITARY SEWER CLEANOUT
 - FIRE HYDRANT
 - WATER VALVE
 - WATER METER
 - TRAFFIC LIGHT
 - MAILBOX
 - FENCE
 - GAS LINE
 - OVERHEAD TELEPHONE LINE
 - UNDERGROUND TELEPHONE LINE
 - OVERHEAD ELECTRIC LINE
 - UNDERGROUND ELECTRIC LINE
 - WATER LINE
 - SANITARY SEWER LINE
 - STORM SEWER LINE
 - TREELINE
 - RCP - REINFORCED CONCRETE PIPE CULVERT
 - CMP - CORRUGATED METAL PIPE CULVERT
 - TOP OF CASTING
 - FL - FLOW LINE
 - TC - TOP OF CURB
 - PL - PROPERTY LINE
 - REED STATION ROAD NORTH
 - EXISTING RIGHT-OF-WAY
 - TEMP - TEMPORARY CONSTRUCTION EASEMENT AND CONSTRUCTION LIMITS
 - PERM - PERMANENT CONSTRUCTION EASEMENT
 - PROPOSED BITUMINOUS CONCRETE PAVEMENT
 - PROPOSED AGGREGATE SURFACE
 - PROPOSED EARTH SHOULDER
 - PROPOSED SPOT ELEVATION
 - DECIDUOUS TREE
 - CONIFEROUS TREE
 - BUSH

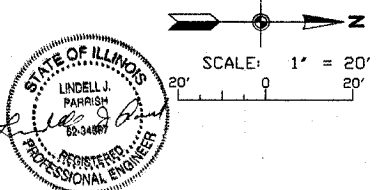
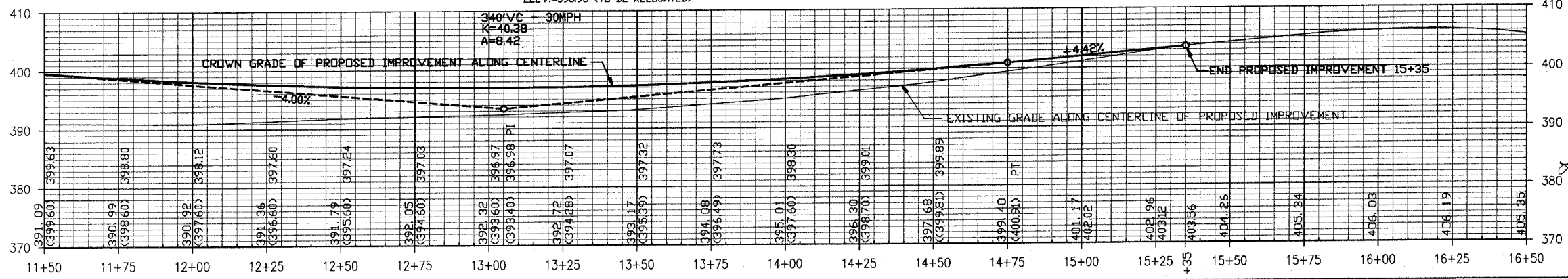

CIP NO. ST0107 - REED STATION ROAD NORTH
PLAN AND PROFILE
STA. 11+50 TO STA. 15+50