

# STATE OF ILLINOIS DEPARTMENT OF TRANSPORTATION DIVISION OF HIGHWAYS PLANS FOR PROPOSED BRIDGE REPLACEMENT AND REHABILITATION PROGRAM

ROUTE NO.	SECTION	COUNTY	TOTAL SHEETS	SHEET NO.
T.R. 90	02-01175-00-BR	UNION	18	1
FED. ROAD DIST. NO.		ILLINOIS	FED. AID PROJECT - BROS-181(29)	
CONTRACT NO. 99213				

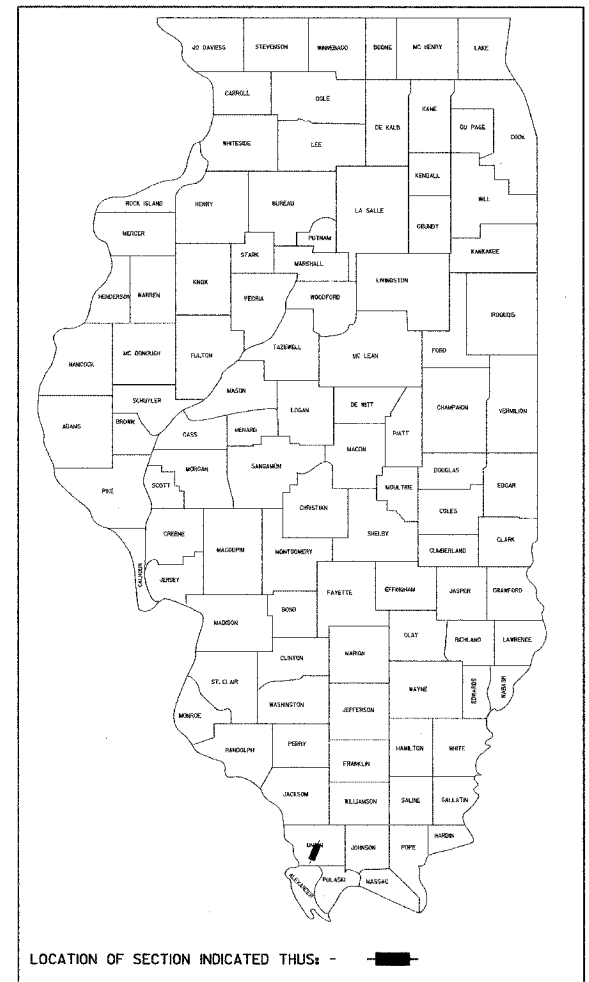

- INDEX OF SHEETS**
1. COVER SHEET
  2. SUMMARY OF QUANTITIES AND GENERAL NOTES
  3. TYPICAL SECTIONS
  4. PLAN AND PROFILE
  - 5.-12. STATION CROSS SECTIONS
  - 13.-17. BRIDGE PLANS
  18. BORINGS

SCALES

PLAN	0' = 50'
PROFILE HORIZ.	0' = 50'
PROFILE VERT.	0' = 5'
CROSS SECTIONS	0' = 5'

## PROJECT BROS-181(29) SECTION 02-01175-00-BR UNION COUNTY T.R. 90 / LINGLE CREEK ROAD C-99-543-04

- HIGHWAY STANDARDS:**
- 515001-02 NAME PLATE FOR BRIDGES
  - 630001-05 STEEL PLATE BEAM GUARDRAIL
  - 631026-02 TRAFFIC BARRIER TERMINAL, TYPE 5 & 5A
  - 702001-05 TRAFFIC CONTROL DEVICES
  - BLR 21-6 TYPICAL APPLICATION OF TRAFFIC CONTROL DEVICES FOR CONSTRUCTION ON RURAL LOCAL HIGHWAYS
  - BLR 23-1 TRAFFIC BARRIER TERMINAL TYPE 1

**UTILITIES**

SOUTHERN ILLINOIS ELECTRIC CO-OP  
7420 U.S. HIGHWAY 515  
DONGOLA, ILLINOIS 62926

VERIZON  
608 WEST UNION  
MARION, ILLINOIS 62959

DESIGN FUNCTIONAL CLASSIFICATION:  
LOCAL ROAD 0-250 ADT  
DESIGN TRAFFIC: 200 ADT  
DESIGN SPEED: 30 M.P.H.

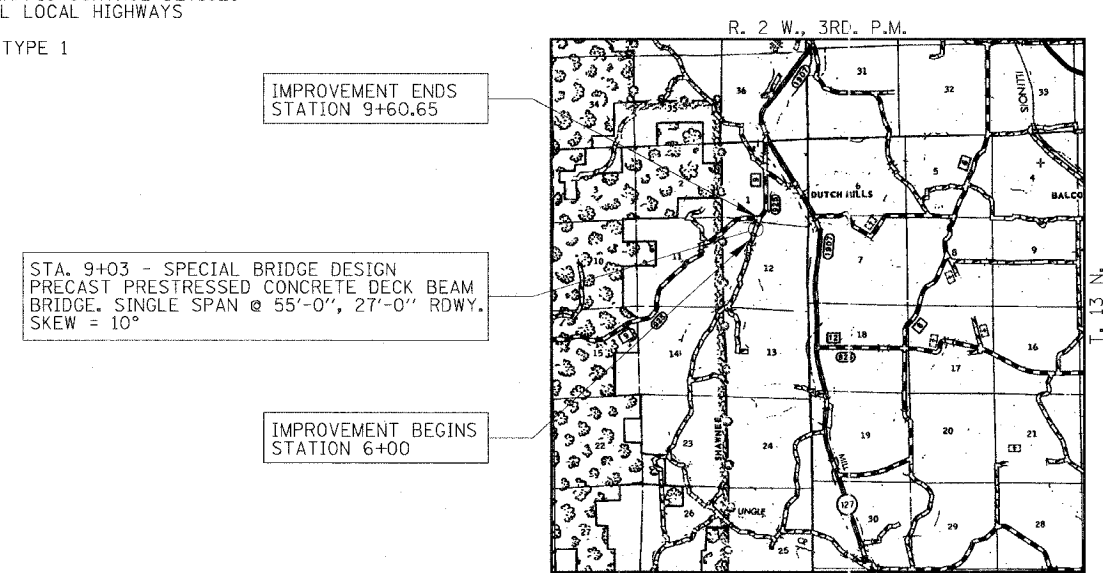

**LAYOUT**

APPROXIMATE SCALE: 0 1 MILE

MAINLINE LENGTH OF SECTION = 360.65 FEET = 0.068 MILES  
SIDEROAD LENGTH OF SECTION = 400.00 FEET = 0.076 MILES  
GROSS LENGTH OF SECTION = 760.65 = 0.144 MILES

DEPT. OF TRANSPORTATION  
RECEIVED  
FEB 14 2005  
CARBONDALE  
DISTRICT 9 OFFICE



APPROVED *February 14 2005*  
*Bruce R. Boyd, P.E.*  
COUNTY ENGINEER

PASSED *February 16 2005*  
*Demi W. Hillbre*  
DISTRICT ENGINEER OF LOCAL ROADS & STREETS

APPROVED *Feb. 24 2005*  
*Mary C. Lamie*  
MARY C. LAMIE, P.E.  
DEPUTY DIRECTOR OF HIGHWAYS  
REGION FIVE ENGINEER  
STATE OF ILLINOIS  
DEPARTMENT OF TRANSPORTATION

DATE: *February 2, 2005*

BY: *Steven W. Magnuson*

LICENSE EXPIRES: NOVEMBER 30, 2005

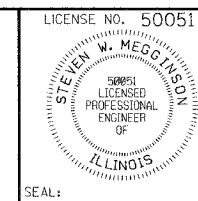

**RLR**  
Rice, Berry and Associates  
A Division of Hampton, Lenzini and Renwick, Inc.  
Civil & Structural Engineers  
801 S. Durkin Drive  
Springfield, Illinois 62704  
217-546-3400  
P.O. Box 1036  
DuQuoin, Illinois 62832  
618-790-4637