

CONTRACT NO. 99213

**SUMMARY OF QUANTITIES**

CODE NO	ITEM	CONSTRUCTION CODE X080-2A	
		UNIT	QUANTITY
20100500	TREE REMOVAL, ACRES	ACRE	0.1
20200100	EARTH EXCAVATION	CU YD	245
20300100	CHANNEL EXCAVATION	CU YD	130
20400800	FURNISHED EXCAVATION	CU YD	915
> 25001000	SEEDING, CLASS 2 (SPECIAL)	ACRE	0.6
28000300	TEMPORARY DITCH CHECKS	EACH	5
> 28100807	STONE DUMPED RIPRAP, CLASS A4	TON	310
40200800	AGGREGATE SURFACE COURSE, TYPE B	TON	725
50100100	REMOVAL OF EXISTING STRUCTURES	EACH	1
50300225	CONCRETE STRUCTURES	CU YD	19.0
> 50400405	PRECAST PRESTRESSED CONCRETE DECK BEAMS (21" DEPTH)	SQ FT	1,485
50800105	REINFORCEMENT BARS	POUND	2,620
> 50901305	STEEL RAILING, TYPE S1 (SPECIAL)	FOOT	118
51201400	FURNISHING STEEL PILES HP10X42	FOOT	144
51204315	CONCRETE ENCASEMENT	CU YD	2.0
51500100	NAME PLATES	EACH	1
54200220	PIPE CULVERTS, CLASS D, TYPE 1, 15"	EACH	22
> 63000135	STEEL PLATE BEAM GUARDRAIL, TYPE B (SPECIAL)	FOOT	125
> 63100205	TRAFFIC BARRIER TERMINAL, TYPE 5A (SPECIAL)	EACH	4
> LR631020	TRAFFIC BARRIER TERMINAL TYPE 1	EACH	4
> XX004981	DEGRADING ROADWAY	SQ YD	450
> Z0000990	AGGREGATE FOR TEMPORARY ACCESS	TON	80
> Z0065000	SETTING PILES IN ROCK	EACH	8

SEE SPECIAL PROVISIONS

**GENERAL NOTES**

- ALL CONSTRUCTION SHALL BE DONE IN ACCORDANCE WITH THE STATE OF ILLINOIS "STANDARD SPECIFICATIONS FOR ROAD AND BRIDGE CONSTRUCTION ADOPTED JANUARY 1, 2002," THESE PLANS AND THE SPECIAL PROVISIONS INCLUDED IN THE CONTRACT DOCUMENTS.
- ALL CLEARING AND GRUBBING AND REMOVAL OF EXISTING DRAINAGE STRUCTURES SHALL BE CONSIDERED INCIDENTAL TO EARTH EXCAVATION. THE REMOVAL OF THE EXISTING BITUMINOUS SURFACE WILL BE PAID FOR AS EARTH EXCAVATION. ALL BITUMINOUS MATERIAL SHALL BE PROPERLY DISPOSED OF BY THE CONTRACTOR IN A METHOD APPROVED BY THE ENGINEER. PROPER DISPOSAL OF BITUMINOUS MATERIAL SHALL BE CONSIDERED INCIDENTAL TO EARTH EXCAVATION AND NO ADDITIONAL COMPENSATION WILL BE ALLOWED.
- THE LOCATION OF EXISTING GAS MAINS, ELECTRIC POWER LINES, TELEPHONE LINES AND OTHER UTILITIES AS SHOWN ON THE PLANS ARE BASED ON CAREFUL FIELD INVESTIGATION AND THE BEST INFORMATION AVAILABLE, BUT THE LOCATIONS ARE NOT GUARANTEED. IT SHALL BE THE CONTRACTOR'S RESPONSIBILITY TO ASCERTAIN THEIR EXACT LOCATION FROM THE INDIVIDUAL UTILITY COMPANIES AND BY FIELD INSPECTION.
- WHERE SECTION OR SUBSECTION MONUMENTS ARE ENCOUNTERED, THE ENGINEER SHALL BE NOTIFIED BEFORE SUCH MONUMENTS ARE REMOVED. THE CONTRACTOR SHALL PROTECT AND CAREFULLY PRESERVE ALL PROPERTY MARKS AND MONUMENTS UNTIL THE OWNER, AN AUTHORIZED SURVEYOR OR AGENT HAS WITNESSED OR OTHERWISE REFERENCED THEIR LOCATION.
- THE CONTRACTOR SHALL CONSULT THE ENGINEER IN REGARD TO THE EXACT LENGTH OF PIPE CULVERTS BEFORE ORDERING THESE ITEMS.
- THE FOLLOWING RATES OF APPLICATION HAVE BEEN USED IN CALCULATING PLAN QUANTITIES.  

AGGREGATE SURFACE COURSE	2.05 TON/CU YD
STONE DUMPED RIPRAP	1.75 TON/CU YD
- THE AREA TO BE SEEDED SHALL CONSIST OF ALL DISTURBED EARTH SURFACES WITHIN THE R.O.W. AS DIRECTED BY THE ENGINEER.  

SEEDING, CLASS 2 (SPECIAL)	0.6 ACRES
----------------------------	-----------
- TREES WITHIN THE RIGHT-OF-WAY WHICH INTERFERE WITH CONSTRUCTION SHALL BE REMOVED ONLY AT THE DIRECTION OF THE ENGINEER.
- EXISTING ROADWAY AND BRIDGE SHALL REMAIN OPEN TO LOCAL TRAFFIC AT ALL TIMES UNTIL THE PROPOSED ROADWAY AND BRIDGE ARE OPEN TO TRAFFIC.

**EARTHWORK SCHEDULE**

LOCATION	EARTH EXCAVATION (CU YD)	SHRINKAGE FACTOR	PERCENT USED	AVAILABLE EXCAVATION (CU YD)	EMBANKMENT REQUIRED (CU YD)	EARTHWORK BALANCE (CU YD)
MAINLINE - LINGLE CREEK ROAD						
STA. 6+00 TO STA. 8+74.82	128	25%	100%	96	848	-752
STA. 8+74.82 TO STA. 9+31.18	-	25%	100%	-	-	-
STA. 9+31.18 TO STA. 9+50.65	0	25%	100%	0	35	-35
SIDEROAD - OLD CAPE ROAD						
STA. 102+00 TO STA. 106+00	114	25%	100%	86	257	-171
CHANNEL EXCAVATION ENTRANCES	130	25%	70%	68	24	68
TOTAL	242			250	1164	-914
USE:	245					915

\* AVAILABLE EXCAVATION = EXC. x (1-SHRINKAGE FACTOR) x % USED (FURN. EXC.)

**TRAFFIC BARRIER TERMINAL, TYPE 5A (SPL.)**

LOCATION	EACH
14.0' RT. STA. 8+60.2 TO 14.5' RT. STA. 8+72.8	1
14.0' LT. STA. 8+60.8 TO 12.9' LT. STA. 8+74.7	1
12.8' RT. STA. 9+28.8 TO 18.4' RT. STA. 9+40.7	1
14.2' LT. STA. 9+33.6 TO 20.3' LT. STA. 9+44.9	1
TOTAL	4

(SHOP CURVE 25'-0" R)  
(SHOP CURVE 16'-0" R)

**STEEL PLATE BEAM GUARD RAIL, TYPE B (SPL.)**

LOCATION	FOOT
14.0' RT. STA. 8+12.8 TO 14.0' RT. STA. 8+60.2	50
14.0' LT. STA. 8+47.6 TO 14.0' LT. STA. 8+60.8	12.5
M.L. 18.4' RT. STA. 9+40.7 TO S.R. 14.4' RT. STA. 104+14.8	12.5
M.L. 20.3' LT. STA. 9+44.9 TO S.R. 14.0' RT. STA. 103+60.0	8.6
S.R. 14.0' RT. STA. 103+60.0 TO 14.0' RT. STA. 103+20.5	41.4
TOTAL	125

(SHOP CURVE 21'-0" R)  
(SHOP CURVE 16'-0" R)

**TRAFFIC BARRIER TERMINAL, TYPE 1**

LOCATION	EACH
18.0' RT. STA. 7+89.5 TO 14.0' RT. STA. 8+12.8	1
18.0' LT. STA. 8+21.3 TO 14.0' LT. STA. 8+47.6	1
S.R. 14.4' RT. STA. 104+14.8 TO 17.9' RT. STA. 104+38.1	1
S.R. 18.0' RT. STA. 102+96.0 TO 14.0' RT. STA. 103+20.5	1
TOTAL	4

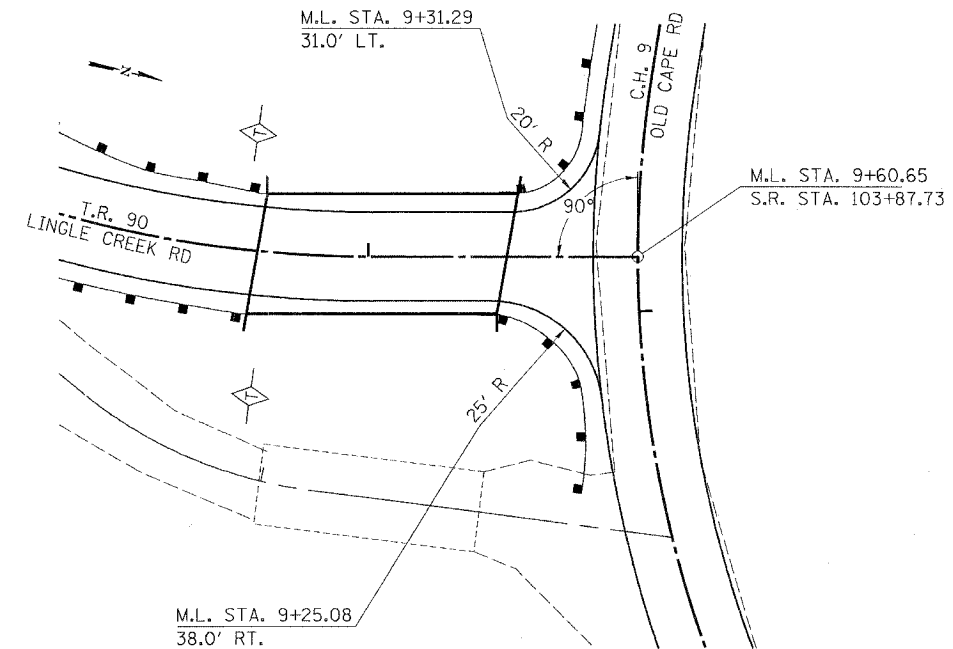

**INTERSECTION DETAIL**

**HLR**  
Rice, Berry and Associates  
A Division of Hampton, Lenzini and Renwick, Inc.  
Civil & Structural Engineers  
801 S. Durkin Drive  
Springfield, Illinois 62704  
217-546-3400  
P.O. Box 1036  
Dubuque, Illinois 62832  
618-190-4637  
Account Number 12-92-0006-1  
Date: 02/02/05  
DESIGNED: T.P.L. CHECKED: S.W.M. DRAWN: D.T.M.

**SUMMARY OF QUANTITIES AND QUANTITY SCHEDULES**

SECTION 02-01175-00-BR  
COUNTY UNIT ROAD DISTRICT  
UNION COUNTY