

TIE DOWN NOTES

NEW TIE DOWNS WILL BE INSTALLED AT THE LOCATIONS SHOWN ON THIS SHEET IN ACCORDANCE WITH THE DETAILS ON THE FOLLOWING SHEET.

THE PERIMETER OF EACH PROPOSED TIE DOWN SHALL BE SAWED.

TIE DOWN CASTINGS SHALL BE NEENAH R-3490A OR EQUAL.

CONCRETE SHALL MEET THE REQUIREMENTS OF 610 - STRUCTURAL CONCRETE.

THE PROPOSED TIE DOWN MARKING WILL BE IN ACCORDANCE WITH THE DETAIL ON THE FOLLOWING SHEET AND THE SPECIFICATIONS.

THE TIE DOWNS WILL BE PAID FOR UNDER ITEM:
AR510510 "TIE DOWN" _____ 36 EA.



PROJ.: DXB-3467

HEI Project No.	803-05APND
Filename	R-152MRK
Scale	1" = 30'
Date	02/09/05
LAYOUT	JMB 02/09/05
DRAWN	JMB 02/09/05
REVIEWED	CAH ??/??/??

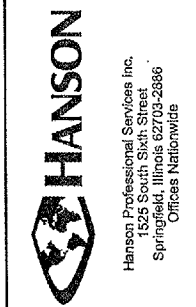

RECONSTRUCT WEST APRON
PROPOSED MARKING AND TIE DOWN PLAN

04\28\2005 01:01 PM DPE
I:\AIRPORTS\DEKALB\803-05APNVAIRPORT\SHETS\R-152MRK.DGN

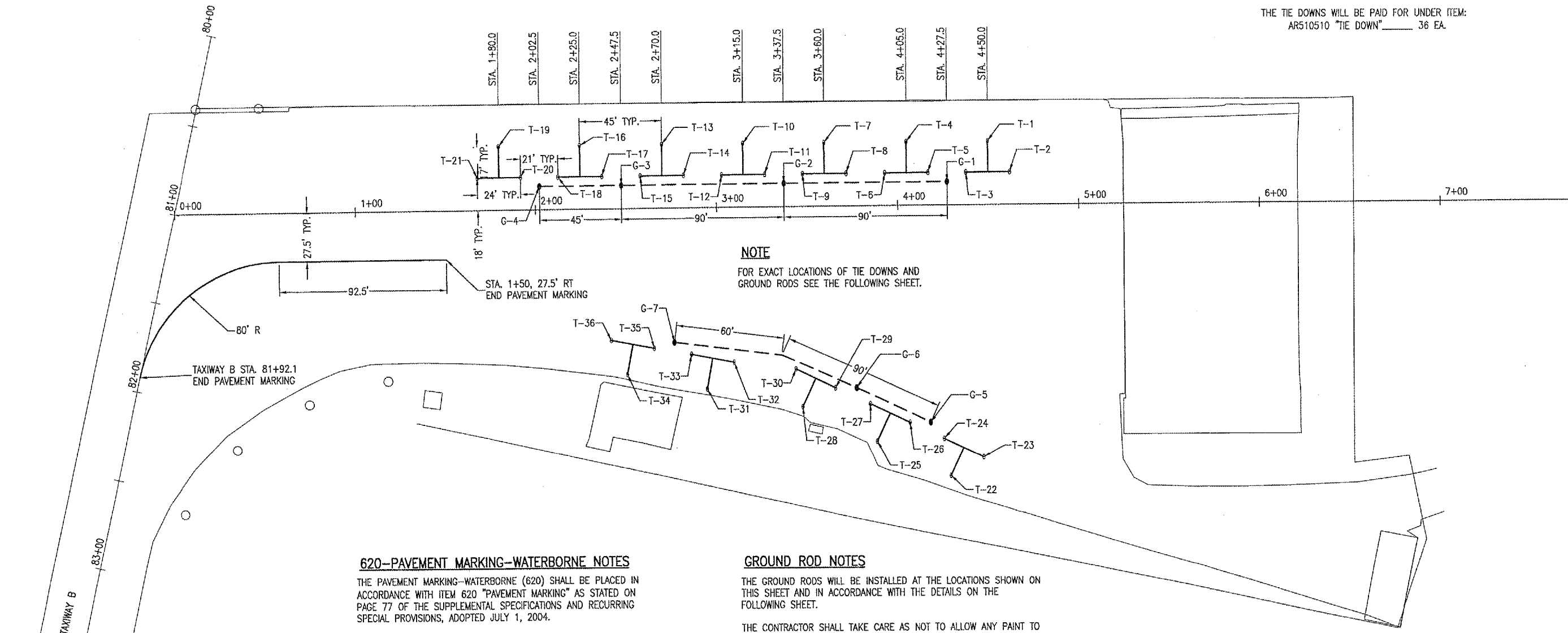

NOTE
FOR EXACT LOCATIONS OF TIE DOWNS AND GROUND RODS SEE THE FOLLOWING SHEET.

620-PAVEMENT MARKING-WATERBORNE NOTES

THE PAVEMENT MARKING-WATERBORNE (620) SHALL BE PLACED IN ACCORDANCE WITH ITEM 620 "PAVEMENT MARKING" AS STATED ON PAGE 77 OF THE SUPPLEMENTAL SPECIFICATIONS AND RECURRING SPECIAL PROVISIONS, ADOPTED JULY 1, 2004.

THIS ITEM SHALL CONSIST OF CENTERLINE, TIE DOWN, AND GROUND ROD MARKING. ALL APRON MARKING WILL BE YELLOW IN COLOR WITH A 6" BLACK OUTLINE. THE PROPOSED PAVEMENT MARKING WILL BE APPLIED IN TWO APPLICATIONS.

ANY MATERIAL DELIVERED THAT FAILS TO MEET THE SPECIFICATIONS SHALL BE DISPOSED OF BY THE VENDOR AND IMMEDIATELY REPLACED WITH ACCEPTABLE MATERIAL ENTIRELY AT THE VENDOR'S EXPENSE, INCLUDING HANDLING AND TRANSPORTATION CHARGES.

ALL PROPOSED MARKING WILL BE COMPLETED IN ACCORDANCE WITH THE DETAILS SHOWN ON THE CONSTRUCTION PLANS.

GLASS BEADS SHALL BE REQUIRED ONLY ON THE SECOND APPLICATION.

CUT-OFF SHEETS WILL BE REQUIRED TO INSURE STRAIGHT EDGES.

THE PROPOSED MARKING WILL BE PAID FOR UNDER ITEM:
AR620520 PAVEMENT MARKING-WATERBORNE _____ 1,472 S.F.

GROUND ROD NOTES

THE GROUND RODS WILL BE INSTALLED AT THE LOCATIONS SHOWN ON THIS SHEET AND IN ACCORDANCE WITH THE DETAILS ON THE FOLLOWING SHEET.

THE CONTRACTOR SHALL TAKE CARE AS NOT TO ALLOW ANY PAINT TO ADHERE TO THE GROUND ROD.

THE CONTRACTOR SHALL INSTALL A #8 BARE COPPER WIRE IN THE PROPOSED SAWED JOINT AS INDICATED ON THIS SHEET. THE SAW CUT WILL BE CUT 2" DEEP TO FACILITATE THE INSTALLATION OF THE PROPOSED GROUNDING CABLE. THE SAWING AND SEALING WILL BE CONSIDERED INCIDENTAL TO THE INSTALLATION OF THE PROPOSED GROUNDING CABLE AND NO ADDITIONAL COMPENSATION WILL BE ALLOWED. THE CONTRACTOR WILL SEAL THE SAW CUT WITH COLD POUR MATERIAL AFTER THE GROUNDING CABLE IS INSTALLED.

THE PROPOSED GROUND RODS AND GROUNDING CABLE WILL BE PAID FOR UNDER THE FOLLOWING ITEMS:
AR510515 "GROUND ROD" _____ 7 EA.
AR108758 "1/C #8 GROUND" _____ 375 L.F.

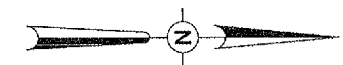
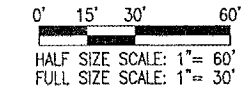

LEGEND

- EXISTING PAVEMENT
- PROPOSED MARKING
- PROPOSED 1/C #8 GROUND ROD CABLE
- PROPOSED TIE DOWN
- PROPOSED GROUND ROD
- EXISTING STAKE MOUNTED LIGHT