

LE036

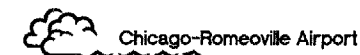

HANSON PROFESSIONAL SERVICES INC.

815 Commerce Drive, Suite 200
Oak Brook, Illinois 60523
Telephone: 630.990.3800
Fax: 630.990.3801



JOLIET REGIONAL PORT DISTRICT

1 Hangar Road
Romeoville, Illinois 60446
Telephone: 815.838.9497
Fax: 815.838.9524

SOUTHWEST CORPORATE AREA,
GRADING AND DRAINAGE, PHASE 1

AIP PROJECT NO. 3-17-0140-B39
IDA PROJECT NO. LOT-3498

NOTES:

1. ALL STAKING PLAN ELEVATIONS ARE AT CROSS SECTION STATIONS UNLESS NOTED OTHERWISE.
2. STATIONING BASED ON ALIGNMENTS AS SHOWN. ENGINEER WILL PROVIDE BENCHMARKS WITH STATION, OFFSET, AND ELEVATION FOR CONTRACTOR'S USE.
3. THE TOPSOIL STOCKPILE BY OTHERS WILL BE USED FOR BERM CONSTRUCTION AND TOPSOIL PLACEMENT.
4. SEE DRAINAGE DETAILS FOR STORM SEWER SCHEDULE.

ALIGNMENT DATA

DESCRIPTION	BEGINNING OF ALIGNMENT 600	END OF ALIGNMENT 600
STATION	591+00	603+20
NORTHING	1,795,639.09	1,796,825.06
EASTING	1,048,148.03	1,048,434.17

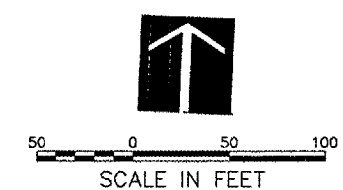

LEGEND

- >—> EXISTING UNDERDRAIN
- x—x— EXISTING STORM SEWER
- - - - - EXISTING ELECTRIC
- x—x— EXISTING SWALE
- - - - - EXISTING FENCE
- x—x— PROPOSED STORM SEWER
- x—x— PROPOSED SWALE
- EXISTING STORM SEWER MANHOLE
- ▽ EXISTING FLARED END SECTION
- ▽ PROPOSED FLARED END SECTION

No.	Drawing Issue Description	Date	By

STAKING PLAN - ALIGNMENT 600

840-048042
Project Number
SJM 04/20/05
Loynt By Date
SJM 04/20/05
Designed By Date
RMH/TMM 04/22/05
Reviewed By Date
SJM
Drawn By Sheet No.

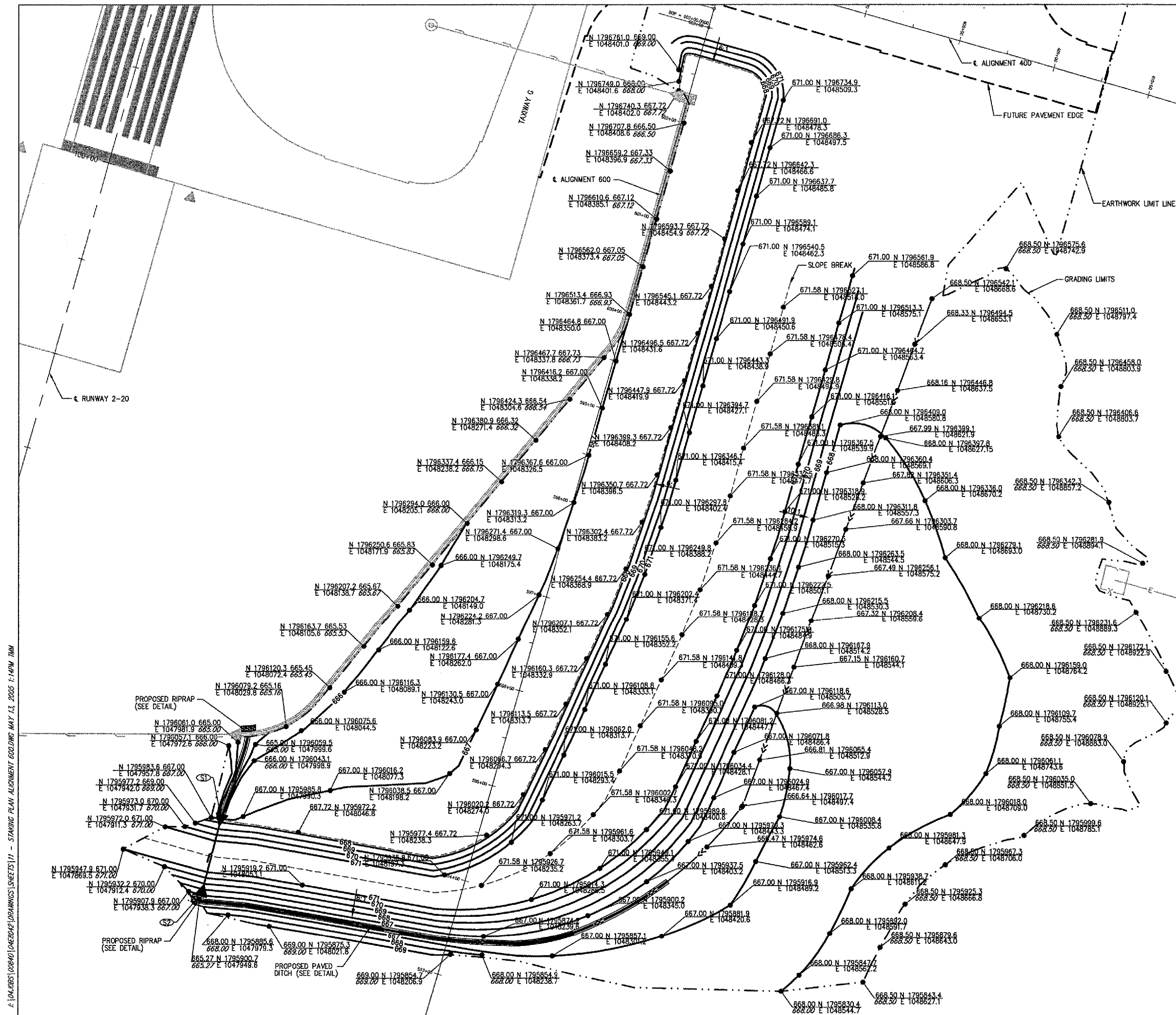

P:\04\0801\02801\048042\DRAWINGS\048042\048042_01.dwg 1:14PM TMM