

REVISIONS		
NUMBER	BY	DATE

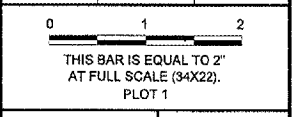

LEGEND

- 7-1 LIGHT POLE WITH LUMINAIRE(S) AND LIGHT POLE SCHEDULE # (SEE LIGHT POLE SCHEDULE SHEET)
- E --- PROPOSED CONDUIT
- ELC EXISTING ELECTRICAL HANDHOLE OR MANHOLE
- TBR EXISTING LIGHT POLE TO BE REMOVED
- EXISTING LIGHT POLE TO REMAIN

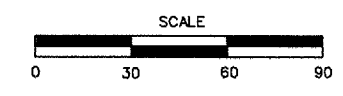

LIGHTING PLAN NOMENCLATURE

- 1 EXISTING HANDHOLE #13. SEE LIGHTING HOMERUN PLAN FOR ROUTING BACK TO EXISTING PARKING LOT LIGHTING CONTROLLER
- 2 THREE #4 (480V), ONE #6 GROUND IN 1-1/2" SCHEDULE 40 PVC CONDUIT.
- 3 TWO #4 (480V), ONE #6 GROUND IN 1-1/4" SCHEDULE 40 PVC CONDUIT.
- 4 THIS IS AN ALTERNATE LOCATION FOR FIXTURE 7-4 DEPENDING ON THE ACTUAL LOCATIONS OF EXISTING UTILITIES IN THE AREA.

NOTE: ALL DUCT INSTALLED IN PARKING LOT SHALL BE REINFORCED CONCRETE ENCASED. ALL DUCT INSTALLED FOR ROADWAY LIGHTING SHALL BE REINFORCED CONCRETE ENCASED UNDER TRAVELED SURFACES.

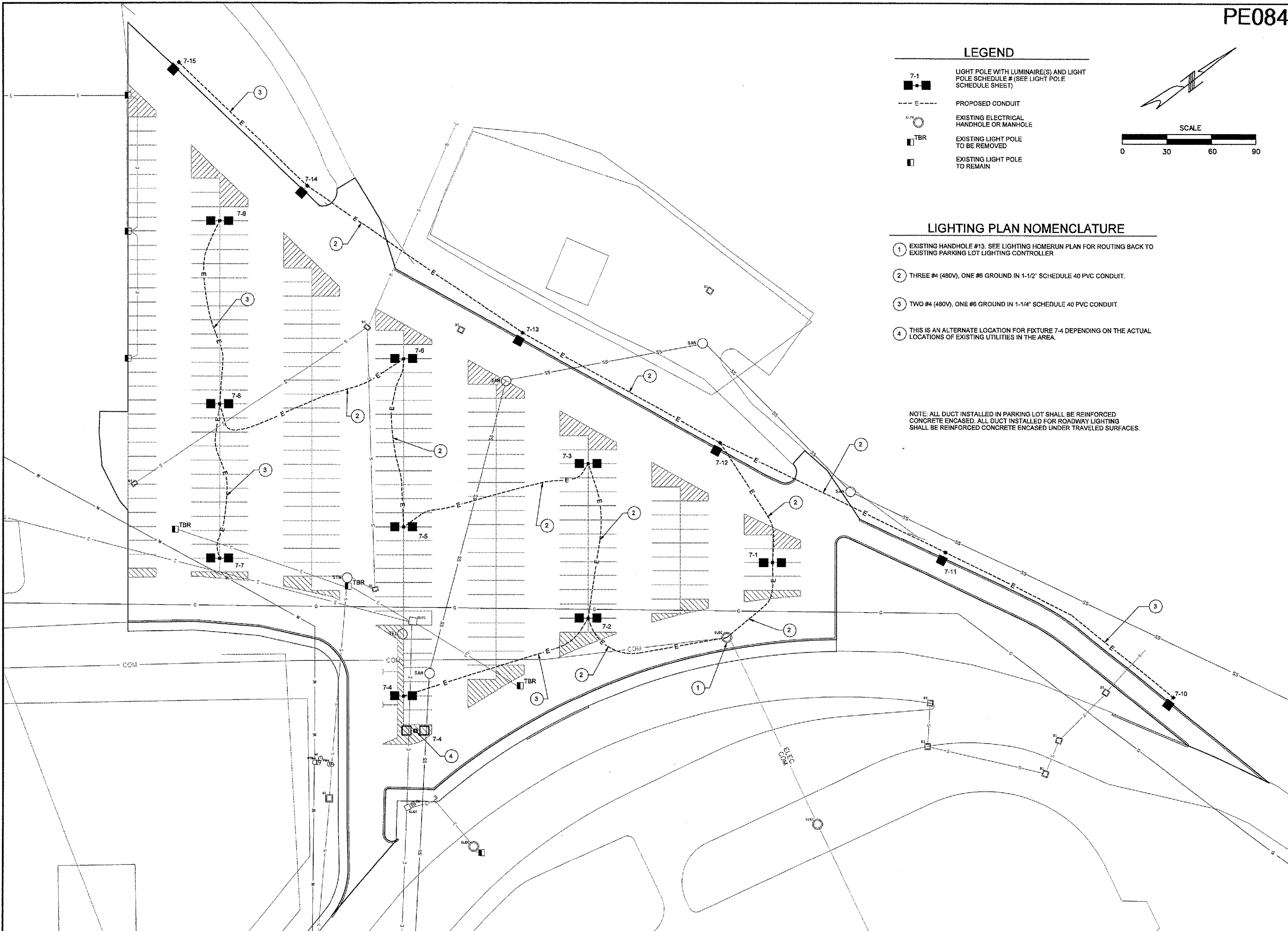

CONSTRUCT, LIGHT & MARK WEST LONG TERM PARKING LOT

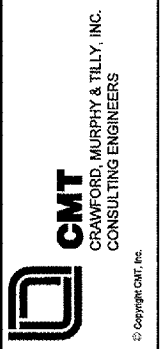

IL PROJECT NUMBER PIA-3385
FILE:
DESIGN BY: WDP
DRAWN BY: JSP
CHECKED BY: BWG
APPROVED BY: CET
DATE: JUNE 17, 2005
JOB No: 05081-03-00