

TA001

WIDTH OF CONCRETE SLAB SHALL BE THE SAME AS THE TRENCH WIDTH IN ACCORDANCE WITH IDOT SEC. 550 OF THE STANDARD SPECIFICATIONS.

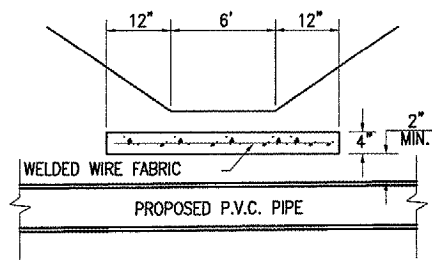

DETAIL "A"
"NOT TO SCALE"

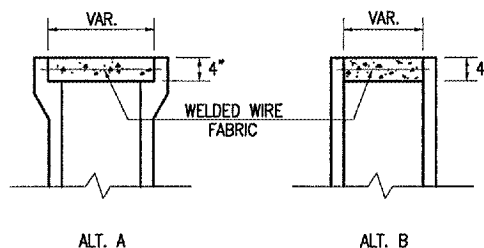

ALT. A ALT. B

DIMENSIONS WILL VARY TO MATCH NOMINAL SIZE OF PROPOSED P.V.C. PIPE.

REINFORCED CONCRETE LID DETAIL

"NOT TO SCALE"

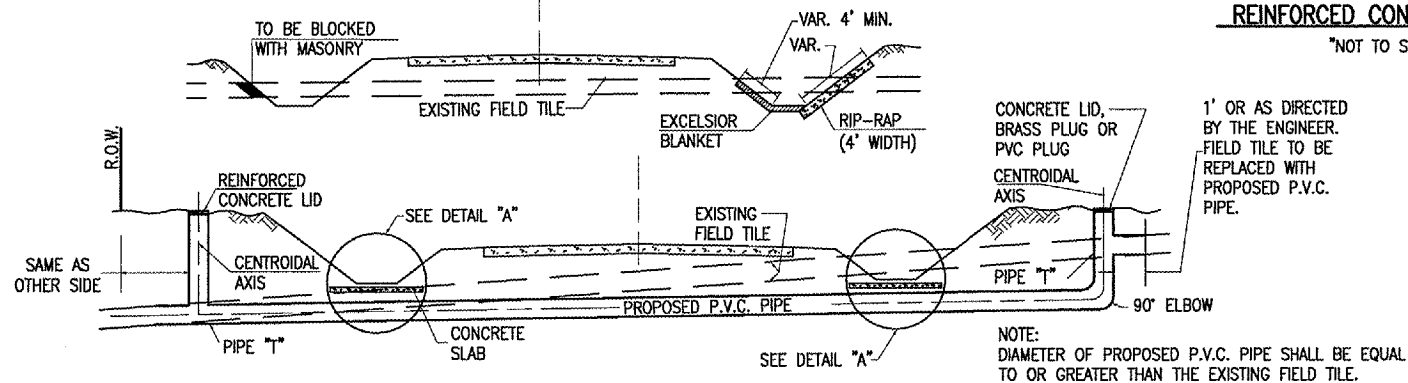

NOTE: DIAMETER OF PROPOSED P.V.C. PIPE SHALL BE EQUAL TO OR GREATER THAN THE EXISTING FIELD TILE.

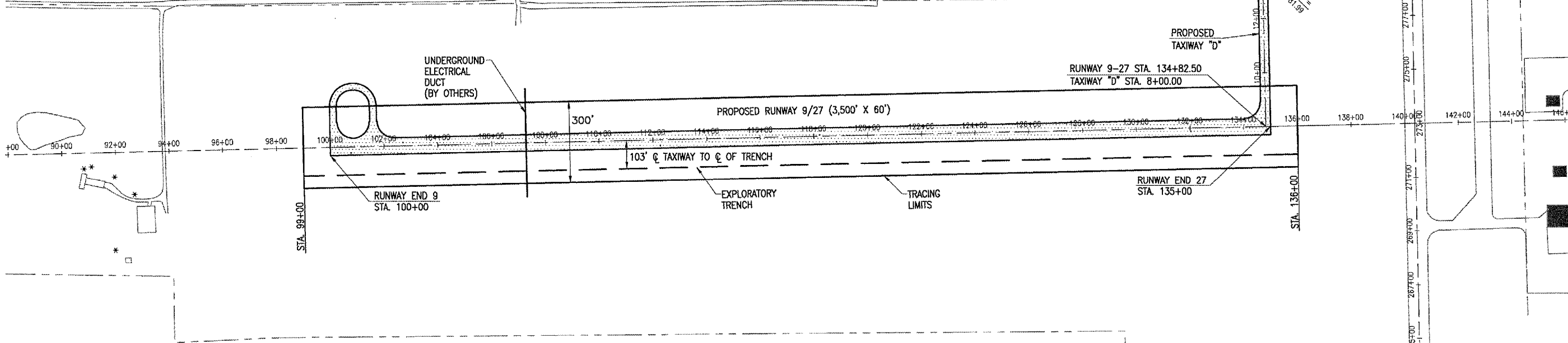

LEGEND

- EXISTING IMPROVEMENTS
- PROPOSED IMPROVEMENTS
- EXISTING BUILDINGS

NOTES

EXISTING FIELD TILE SHALL BE LOCATED BOTH HORIZONTALLY AND VERTICALLY BY THE USE OF AN EXPLORATION TRENCH. THIS TRENCH SHALL BE NOT LESS THAN 54 INCHES IN DEPTH, MEASURED FROM THE EXISTING GROUND ELEVATION. THE WIDTH OF THE TRENCH SHALL BE SUFFICIENT TO ALLOW PROPER INVESTIGATION OF THE EXISTING TRENCH. THE TRENCH SHALL BE APPROXIMATELY 103' RT. FROM THE PROPOSED RUNWAY CENTERLINE.

THE EXISTING TILE DRAINAGE SYSTEM SHALL BE MAINTAINED IN A FUNCTIONAL CONDITION BY IMMEDIATE CONSTRUCTION OF THE NEW P.V.C. PIPE SYSTEM OR BY REPAIRING THE CUT TILE WITH NEW TILE OF THE SAME DIAMETER UNTIL SUCH TIME AS THE NEW SYSTEM IS COMPLETED.

GENERAL NOTES

- THE P.V.C. PIPE WILL BE USED TO REPLACE EXISTING FIELD TILE.
- DIAMETER OF THE P.V.C. PIPE SHALL BE EQUAL TO OR GREATER THAN THE EXISTING FIELD TILE REMOVED.
- WELDED WIRE FABRIC SHALL BE 6" X 6" MESH, #4 GAUGE, 58 LBS. PER 100 SQ. FT. CONFORMING TO REQUIREMENTS OF A.S.T.M. A158.
- ALL EXISTING FIELD TILE SHALL BE REPLACED WITH P.V.C. PIPE OF THE TYPE REQUIRED FOR THE DEPTH OF COVER. THE LINEAL FOOT MEASUREMENT WILL BE MADE ALONG THE CENTROIDAL AXIS AND INCLUDE ALL BENDS, ELBOWS, OR PIPE TEE'S WHICH ARE REQUIRED.
- THE LID SHALL BE CONCRETE, REINFORCED, USING EITHER AN S.I. CONCRETE MIX OR PRECAST. THE LID MAY ALSO BE A BRASS PLUG SECURED BY USE OF A RUBBER GROMMET, OR A THREADED PVC PLUG.
- ALL EXISTING FIELD TILE THAT WILL BE ABANDONED SHALL BE BLOCKED WITH MASONRY OR CRUSHED AS SHOWN ON PLANS OR AS DIRECTED BY THE ENGINEER, OR REMOVED WHERE NECESSARY FOR OTHER CONSTRUCTION.
- SHOULD FIELD TILE BE ENCOUNTERED WITHIN THE LIMITS OF THE SECTION, REPLACEMENT SHALL BE MADE IN ACCORDANCE WITH THIS DETAIL.
- THE COST OF THE EXPLORATION TRENCH WILL BE PAID FOR AT THE CONTRACT UNIT PRICE PER LINEAL FOOT FOR EXPLORATION TRENCH 54" DEPTH.

FIELD TILE TRACING

UPON COMPLETION OF THE EXPLORATORY TRENCHING ALL EXISTING FIELD TILE ENCOUNTERED WILL BE TRACED. THE CONTRACTOR WILL TRACE THE EXISTING FIELD TILE TO THE LIMITS SHOWN ON THIS SHEET. IF AT ANY TIME IN THE TRACING OPERATION THE CONTRACTOR WOULD HAVE TO EXPOSE AND BREAK THE EXISTING FIELD TILE TO CONTINUE THE TRACING OPERATION THE EXISTING FIELD TILE WILL BE REPAIRED INPLACE AT THAT LOCATION IMMEDIATELY CONCLUDING THE TRACING OPERATION. COST OF REPAIRING SUCH BREAKS WILL BE CONSIDERED INCIDENTAL TO THE TRACING OPERATION AND NO ADDITIONAL COMPENSATION WILL BE ALLOWED.

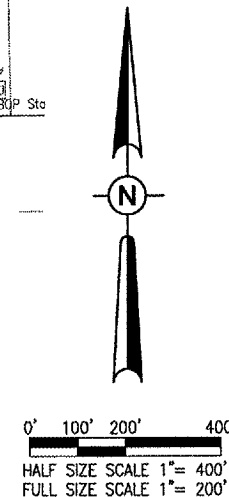

| REVISION | DATE | BY |
|----------|------|----|
| | | |
| | | |
| | | |

TAYLORVILLE MUNICIPAL AIRPORT
TAYLORVILLE, ILLINOIS

| | |
|---------------------------------|----------|
| HD Project No. 828-03RWYGD.0800 | 02/05/04 |
| Filename R-133DRN.DWG | BAK |
| Scale 1" = 200' | BAK |
| Date 02/05/04 | CAH |
| LAYOUT | |
| DRAWN | |
| REVIEWED | |

Hanson Professional Services Inc.
1625 South Sixth Street
Springfield, Illinois 62703-2896
Offices Nationwide

CONSTRUCT
RUNWAY 9-27
PROPOSED
FIELD TILE INVESTIGATION

APR 22, 2005 10:42 AM RAW H:\AIRPORTS\TAYLORVILLE\828-03RWYGD\AIRPORT SHEETS\R-133DRN.DWG - FIELD TILE INVESTIGATION