

MAY 04, 2005 2:07 PM RAW  
 I:\AIRPORTS\TAYLORVILLE\828-03RWY\CD\AIRPORT\SHEETS\R-701-RWY.DWG - STA. 96+00 TO STA. 110+00

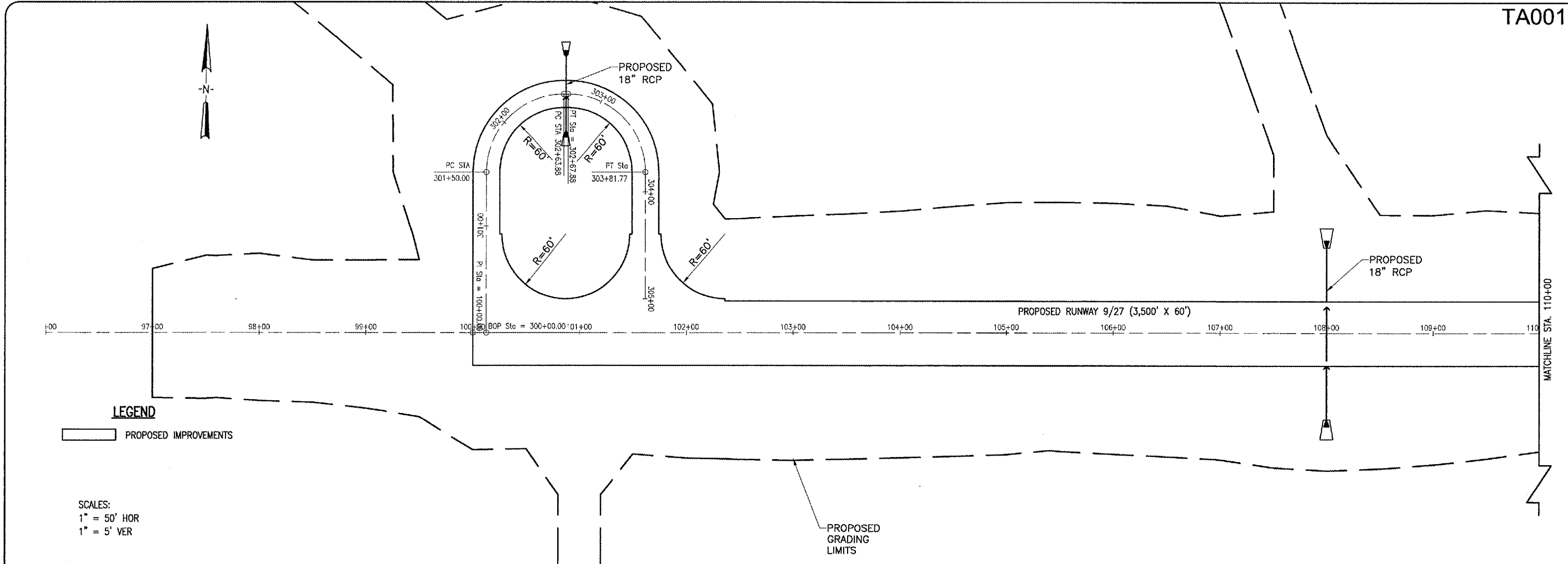

**LEGEND**

PROPOSED IMPROVEMENTS

SCALES:  
 1" = 50' HOR  
 1" = 5' VER

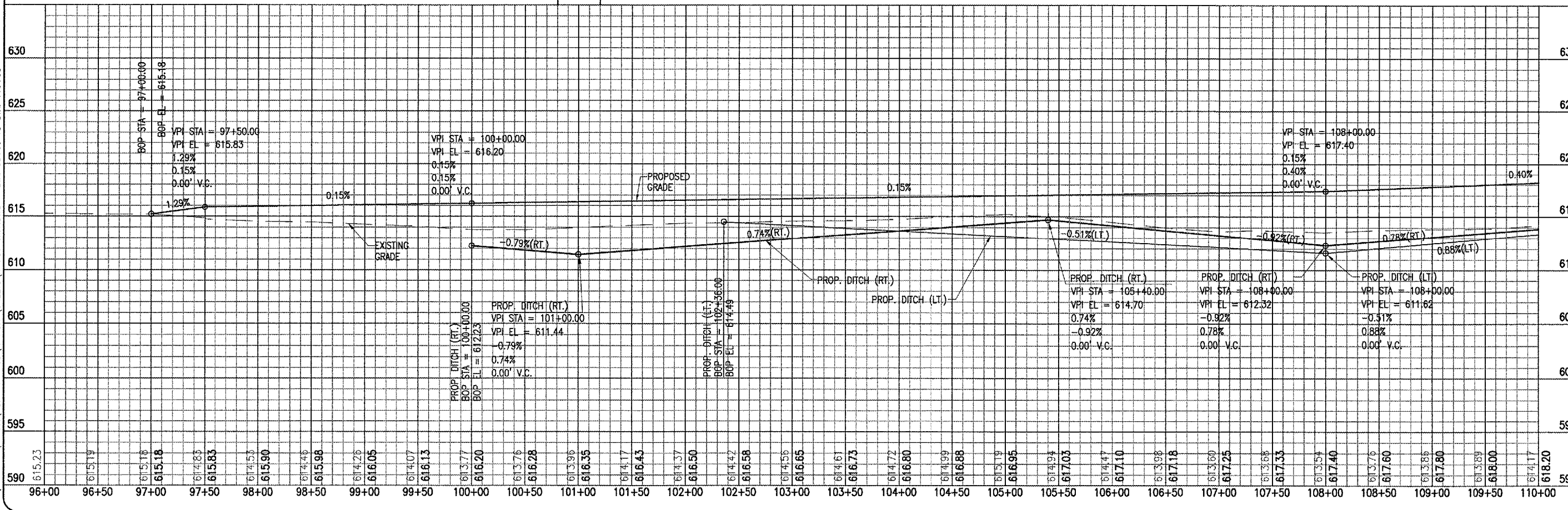

TA001

DATE	REVISION	BY

**TAYLORVILLE MUNICIPAL AIRPORT**  
**TAYLORVILLE, ILLINOIS**

IL. PROJ.: TAZ-3166 A.I.P. PROJ.: 3-17-0100-B7

LAYOUT	RAW	BHK	CAH
	02/16/05	02/16/05	03/28/05

ILL. Project No. 828-03RWY/CD-0800  
 Drawing R-701-RWY.DWG  
 Scale H. 1"=50' V. 1"=5'  
 Date 02/16/05



**CONSTRUCT**  
**RUNWAY 9-27**

PROPOSED  
 RUNWAY 9-27 PLAN & PROFILE  
 STA. 96+00 TO STA. 110+00