

LEGEND

- PROPOSED PAVEMENT
- PROPOSED INSPECTION HOLE
- PROPOSED UNDERDRAIN
- PROPOSED RCP
- PROPOSED END SECTION

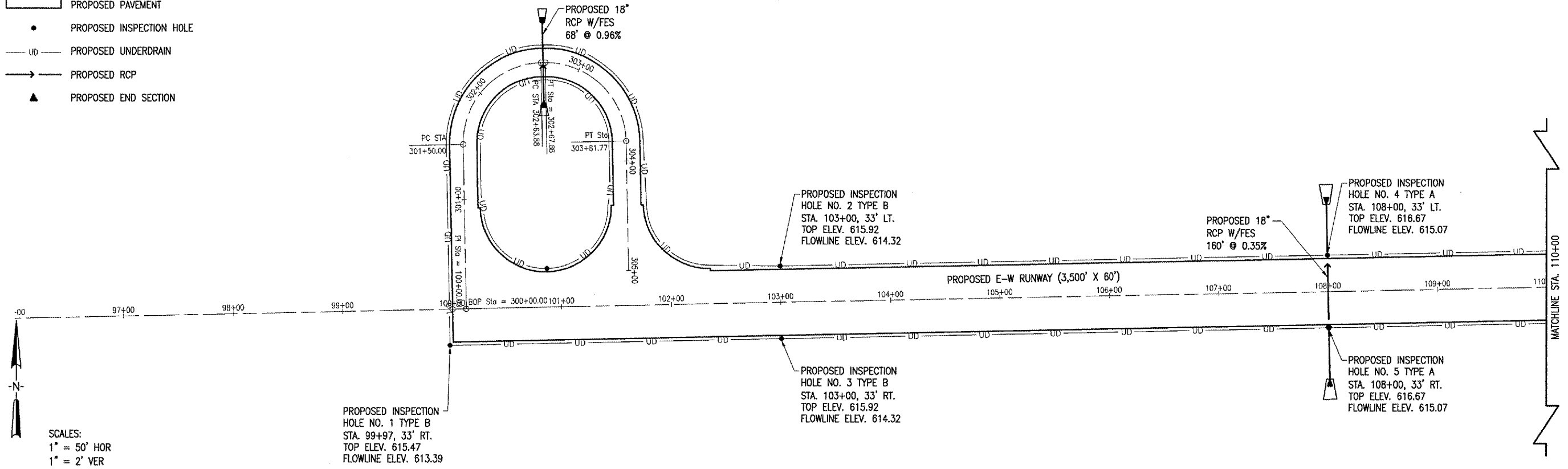

SCALES:
 1" = 50' HOR
 1" = 2' VER

PROPOSED INSPECTION HOLE NO. 1 TYPE B
 STA. 99+97, 33' RT.
 TOP ELEV. 615.47
 FLOWLINE ELEV. 613.39

PROPOSED INSPECTION HOLE NO. 3 TYPE B
 STA. 103+00, 33' RT.
 TOP ELEV. 615.92
 FLOWLINE ELEV. 614.32

PROPOSED INSPECTION HOLE NO. 2 TYPE B
 STA. 103+00, 33' LT.
 TOP ELEV. 615.92
 FLOWLINE ELEV. 614.32

PROPOSED 18" RCP W/FES
 160' @ 0.35%

PROPOSED INSPECTION HOLE NO. 4 TYPE A
 STA. 108+00, 33' LT.
 TOP ELEV. 616.67
 FLOWLINE ELEV. 615.07

PROPOSED INSPECTION HOLE NO. 5 TYPE A
 STA. 108+00, 33' RT.
 TOP ELEV. 616.67
 FLOWLINE ELEV. 615.07

MAY 04, 2005 4:19 PM RAW I:\AIRPORTS\TAYLORVILLE\B28-03RWYGD\AIRPORT\SHEETS\R-711-RWY-UND.DWG - STA. 96+00 TO STA. 110+00

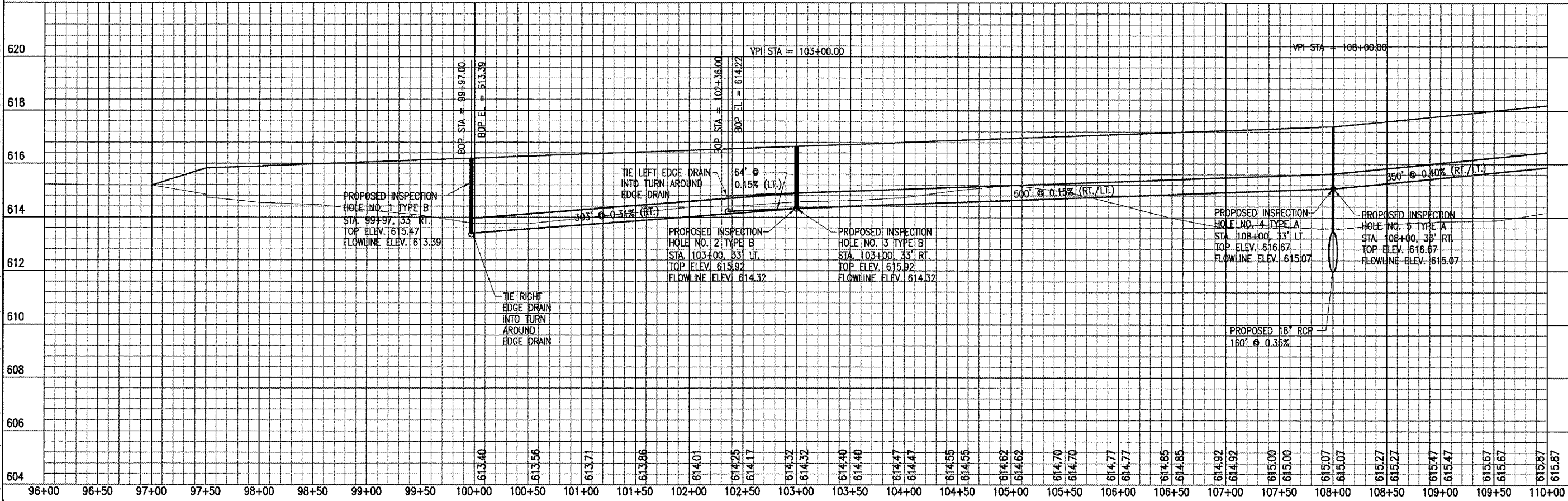

DATE	REVISION	BY

TAYLORVILLE MUNICIPAL AIRPORT
TAYLORVILLE, ILLINOIS

LAYOUT	RAW	BAK	CAH	DATE



CONSTRUCT RUNWAY 9-27
PROPOSED RUNWAY UNDERDRAIN PLAN & PROFILE
 STA. 96+00 TO STA. 110+00