



HANSON PROFESSIONAL SERVICES INC.

815 Commerce Drive, Suite 200  
Oak Brook, Illinois 60523  
Telephone: 630.990.3800  
Fax: 630.990.3801



Waukegan Regional Airport  
Waukegan Regional Port District

3580 North McAree Road  
Waukegan, Illinois 60087  
Phone: 847.244.0055  
Fax: 847.244.3813

### REPAIR SELECTED PAVEMENT AREAS, REHABILITATE HANGAR TAXILANES AND SERVICE ROAD, AND CONSTRUCT NEW HANGAR PAVEMENTS

A.I.P. PROJ.: 3-17-0105-B30  
I.L. PROJ.: UGN-3449

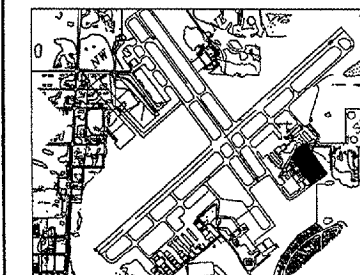

KEY MAP

No.	Drawing Issue Description	Date	By

Date

MAY 06, 2005

Sheet Title

STAKING PLAN  
TAXILANE ALIGNMENT 50

831-04TXD  
Project Number

AAP 02/28/05  
Layout By Date

AAP 02/28/05  
Designed By Date

TMM 05/05/05  
Reviewed By Date

AAP  
Drawn By

Sheet No.

29

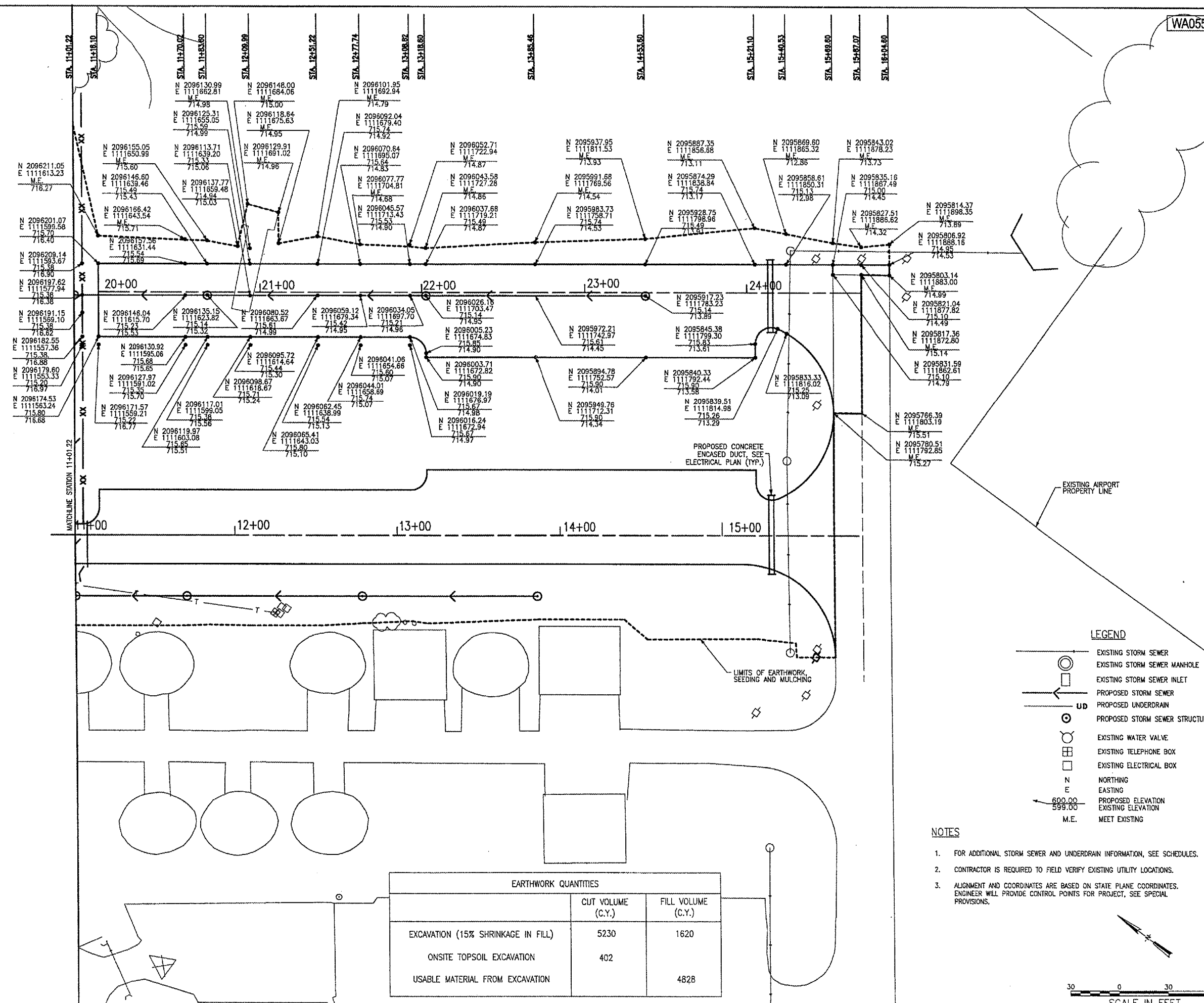

- LEGEND**
- EXISTING STORM SEWER
  - EXISTING STORM SEWER MANHOLE
  - EXISTING STORM SEWER INLET
  - PROPOSED STORM SEWER
  - PROPOSED UNDERDRAIN
  - PROPOSED STORM SEWER STRUCTURE
  - EXISTING WATER VALVE
  - EXISTING TELEPHONE BOX
  - EXISTING ELECTRICAL BOX
  - NORTHING
  - EASTING
  - PROPOSED ELEVATION
  - EXISTING ELEVATION
  - MEET EXISTING

- NOTES**
- FOR ADDITIONAL STORM SEWER AND UNDERDRAIN INFORMATION, SEE SCHEDULES.
  - CONTRACTOR IS REQUIRED TO FIELD VERIFY EXISTING UTILITY LOCATIONS.
  - ALIGNMENT AND COORDINATES ARE BASED ON STATE PLANE COORDINATES. ENGINEER WILL PROVIDE CONTROL POINTS FOR PROJECT, SEE SPECIAL PROVISIONS.

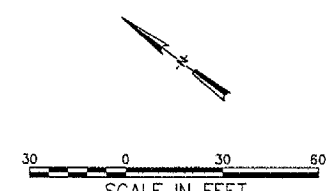

SUSERS  
FILES