

**LEGEND**

- ① TEMPORARY PAVEMENT (SEE SPECIAL PROVISION)
- ② TYPE II BARRICADES WITH STEADY BURNING LIGHTS (50 FT C-C TANGENTS, 25 FT C-C @ TAPERS & 12 FT C-C ALONG RADII)
- ③ VERTICAL PANELS WITH STEADY BURNING LIGHTS @ 50 FT C-C
- ④ WET TEMPORARY PAVEMENT MARKING TAPE
- ⑤ VERTICAL BARRICADES WITH STEADY BURNING LIGHTS (50 FT C-C @ TANGENTS, 25 FT C-C @ TAPERS & 12 FT C-C ALONG RADII)

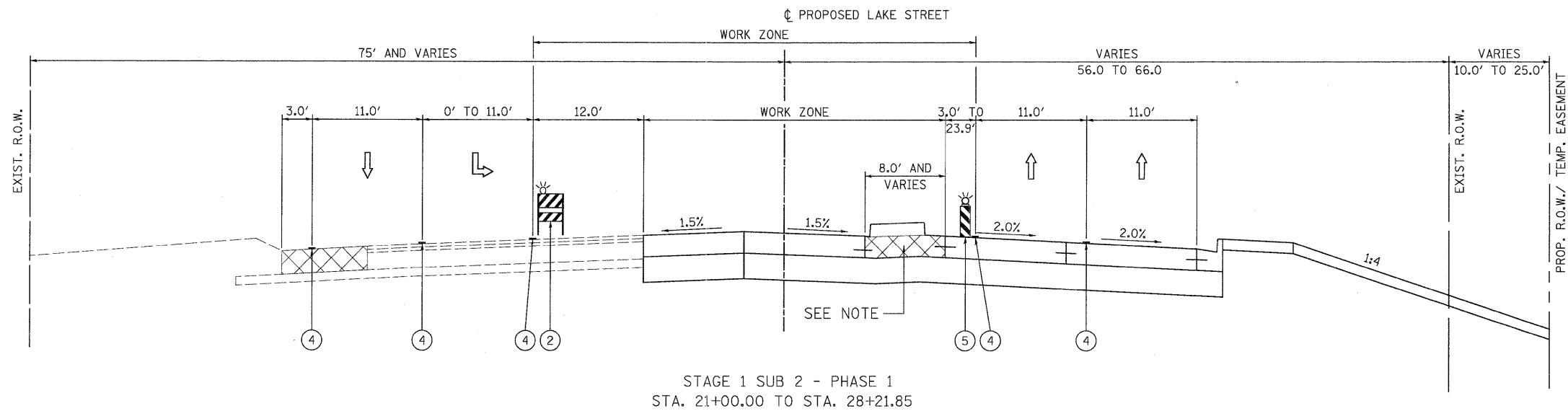

NOTE:  
TEMPORARY PAVEMENT FROM STAGE 1 SUB 1.

<b>PATRICK ENGINEERING</b>	PATRICK ENGINEERING INC. 4970 VARSITY DRIVE LISLE, IL 60532 patrickengineering.com	USER NAME = ckersten(Lisa_R)	DESIGNED - MJV	REVISED -		<b>LAKE STREET</b> <b>SUGGESTED MAINTENANCE OF TRAFFIC</b> <b>TYPICAL SECTIONS - STAGE 1 SUB 2 PHASE 1</b>			F.A. RTE. 2578	SECTION 532B	COUNTY DUPAGE	TOTAL SHEETS 781	SHEET NO. 129
	PLOT CONFIG = PDF(Greg_Large).plt	PLOT SCALE = 1:6,666.67	PLOT DATE = 12/3/2010	DRAWN - EJB		REVISED -	SCALE: 1"=50'	SHEET MOT-23 OF 136	STA. TO STA.	FED. ROAD DIST. NO.	ILLINOIS FED. AID PROJECT	CONTRACT NO. 60477	