

ADVANCE SIGNING DETAIL:

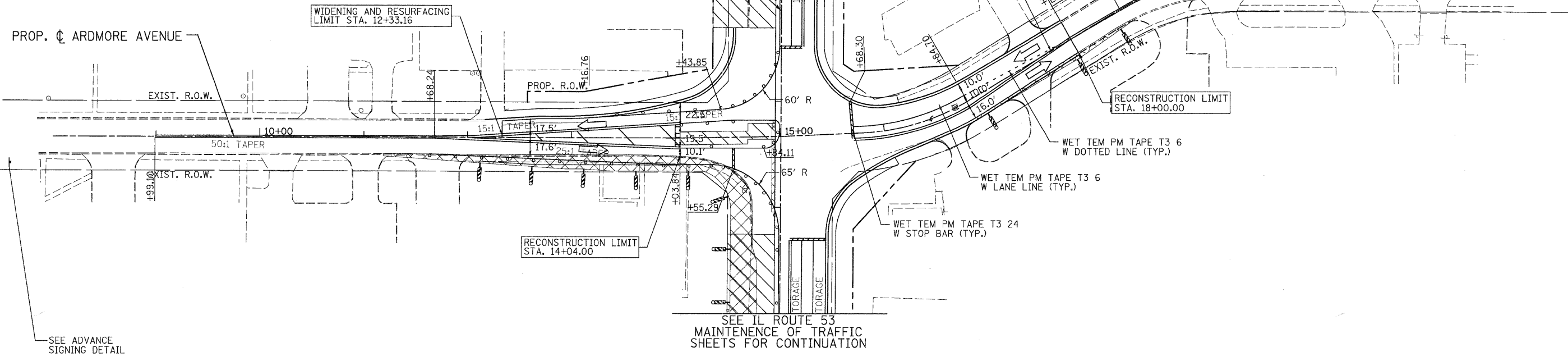
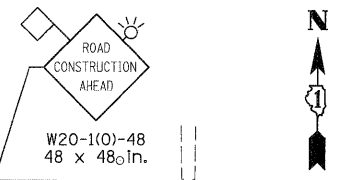
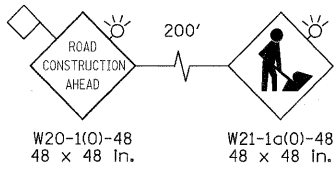

SEE ADVANCE SIGNING DETAIL

SEE IL ROUTE 53 MAINTENANCE OF TRAFFIC SHEETS FOR CONTINUATION

WIDENING AND RESURFACING LIMIT STA. 11+00.82  
RECONSTRUCTION LIMIT STA. 12+45.64

SEE IL ROUTE 53 MAINTENANCE OF TRAFFIC SHEETS FOR CONTINUATION

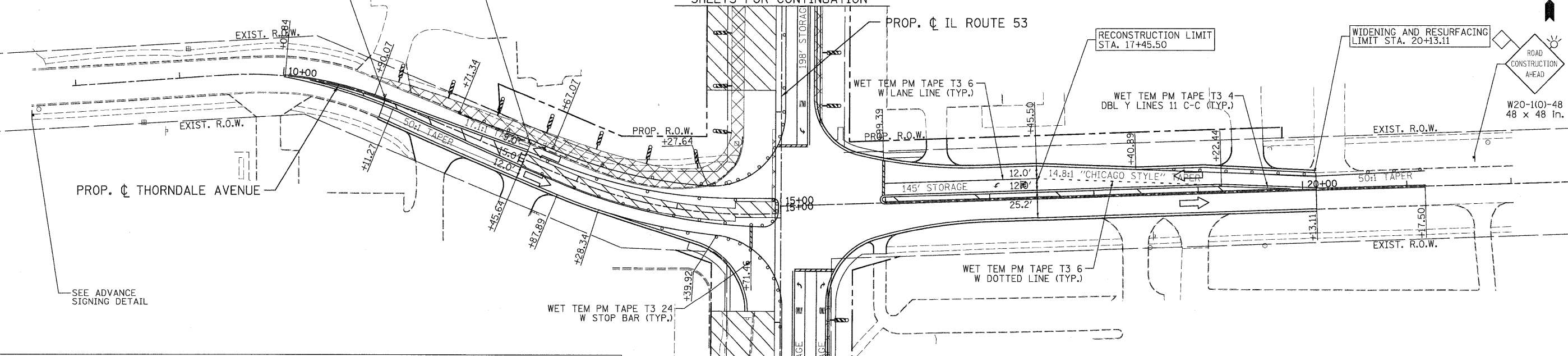

SEE ADVANCE SIGNING DETAIL

SEE IL ROUTE 53 MAINTENANCE OF TRAFFIC SHEETS FOR CONTINUATION

LEGEND	
	TEMPORARY PAVEMENT
	WORK ZONE
	ARROW BOARD
	TYPE II BARRICADES OR DRUMS WITH STEADY BURNING LIGHTS @ 50 FT CENTERS ALONG ROADWAY (TANGENT), 25 FT CENTERS ALONG TAPERS AND 12 FT CENTERS ALONG RADII
	VERTICAL PANEL WITH STEADY BURNING LIGHT 50 FT C-C
	TYPE III BARRICADES WITH FLASHING LIGHTS
	DIRECTION OF TRAFFIC

 PATRICK ENGINEERING INC. 4870 VARSITY DRIVE LISLE, IL 60532 patrickengineering.com	USER NAME = ekersten(Lisle_R)	DESIGNED - MJV	REVISED -
	PLOT CONFIG= PDF(Reg_Large).plt	DRAWN - MJV	REVISED -
	PLOT SCALE = 1/8"	CHECKED - JJC	REVISED -
	PLOT DATE = 12/3/2018	DATE - 12/3/2010	REVISED -

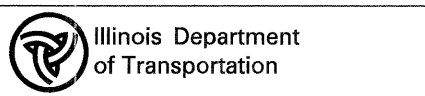

**ARDMORE AVENUE, THORNDALE AVENUE**  
**SUGGESTED STAGES OF CONSTRUCTION & TRAFFIC CONTROL**  
**STAGE 2 SUB-STAGE 2 PHASE 2**

SCALE: 1"=50' SHEET MOT-128 OF 136 STA. TO STA.

F.A. RTE.	SECTION	COUNTY	TOTAL SHEETS	SHEET NO.
2578	532B	DUPAGE	781	234
FED. ROAD DIST. NO. [ILLINOIS] FED. AID PROJECT				CONTRACT NO. 60477

G:\1001\9356\_A8\_IL53\0-awings\CADD\_Sheets\1019139797-sh2-staging\_234.dgn