

- NOTE:
1. FINAL PAVEMENT MARKING ON CONCRETE PAVEMENT SHALL BE POLYUREA PAVEMENT MARKING.
  2. FINAL PAVEMENT MARKING ON HMA PAVEMENT SURFACE SHALL BE THERMOPLASTIC PAVEMENT MARKING.
  3. THE CONTRACTOR SHALL CONTACT DON CHIARUGI AT 847-741-9857 TWO WEEKS PRIOR TO INSTALLING FINAL PAVEMENT MARKINGS.

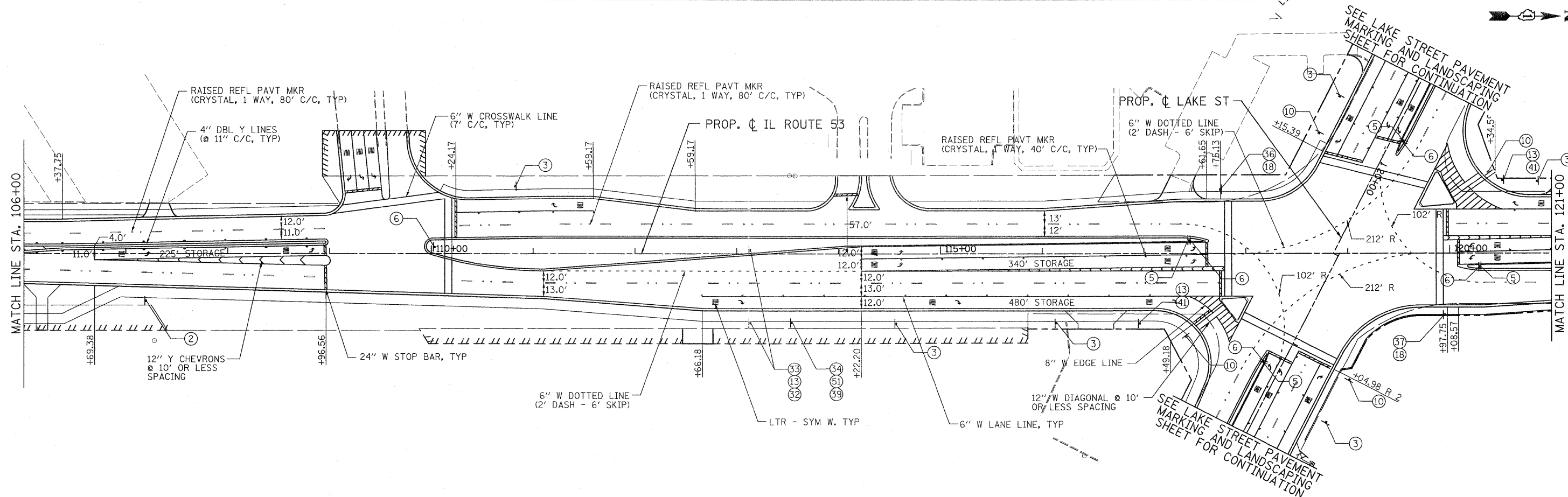
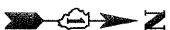

PATRICK ENGINEERING INC.  
4970 VARSITY DRIVE  
LISLE, IL 60532  
patrickengineering.com

USER NAME = ckerstan@lisle.RI  
PLOT CONFIG = PDFtoGrey-Large.plt  
PLOT SCALE = 1:50  
PLOT DATE = 1/27/2011

DESIGNED - EJB  
DRAWN - EJB  
CHECKED - CPK  
DATE - 01/31/2011

REVISED -  
REVISED -  
REVISED -  
REVISED -

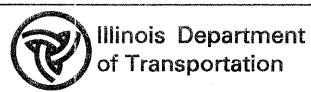

**ILLINOIS ROUTE 53  
PAVEMENT MARKING & SIGNING PLAN**

SCALE: 1"=50'  
SHEET PMK-04 OF 14  
STA. 90+00 TO STA. 120+00

F.A.U. RTE.	SECTION	COUNTY	TOTAL SHEETS	SHEET NO.
2578	532B	DUPAGE	781	325
CONTRACT NO. 60477				
FED. ROAD DIST. NO. ILLINOIS FED. AID PROJECT				

Q:\DOT\9356\_A02\_ILL53\Drawings\CADD Sheets\019139797-shr-pmk\_325.dgn