

LEGEND:

| | | | |
|--|--|--|--|
| | TOPSOIL FURNISH AND PLACE, 4" SODDING, SALT TOLERANT NITROGEN AND POTASSIUM FERTILIZER NUTRIENT | | TOPSOIL FURNISH AND PLACE, 8" SEEDING, CLASS 4 EROSION CONTROL BLANKET (ADJACENT TO WETLANDS) |
| | TOPSOIL FURNISH AND PLACE, 24" SEEDING, CLASS 2A NITROGEN AND POTASSIUM FERTILIZER NUTRIENT EROSION CONTROL BLANKET | | TOPSOIL FURNISH AND PLACE, 12" COMPOST FURNISH AND PLACE, 2" (NOISE WALL LOCATIONS, SEE VINE PLANTING DETAIL) |
| | TOPSOIL FURNISH AND PLACE, 6" SEEDING, CLASS 4 EROSION CONTROL BLANKET | | |

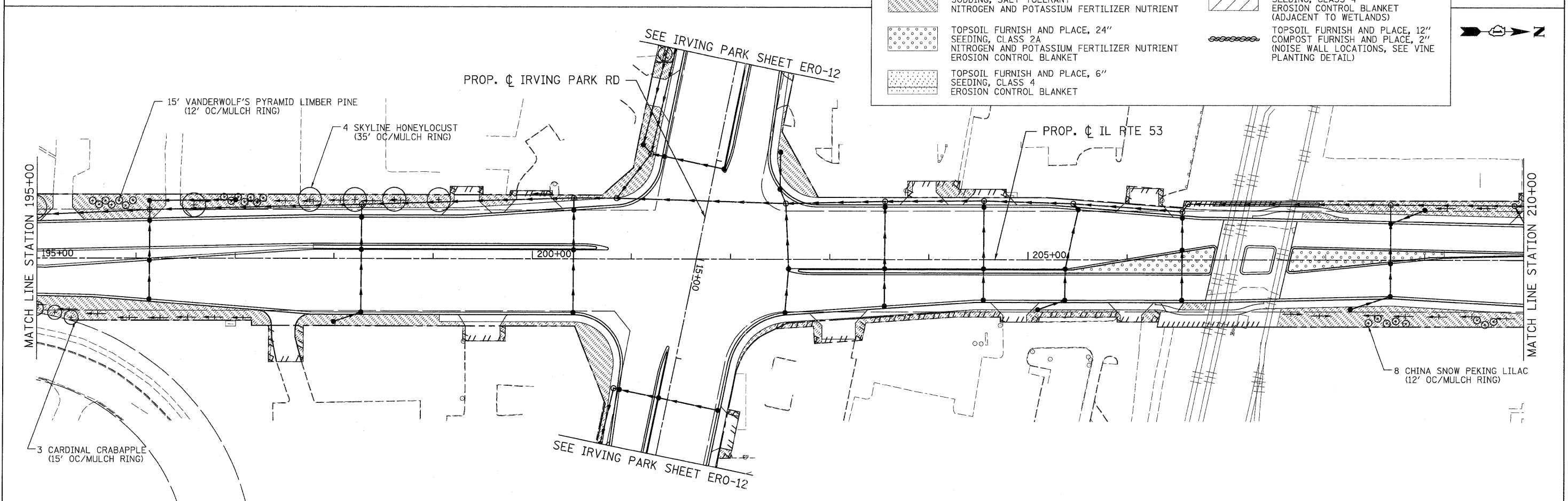

| | | | | | | | | | | | | |
|--|---|---|--|--|---|---|--|---------------------|-----------------|------------------|---------------------|------------------|
| PATRICK ENGINEERING INC. 4670 VARSITY DRIVE LISLE, IL 60532 patrickengineering.com | USER NAME = Rdwj_Lisle PLOT CONFIG = POF01reg.Largel.plt PLOT SCALE = 1:50 PLOT DATE = 12/3/2010 | DESIGNED - D.DOERFLER DRAWN - J.MACKE CHECKED - A.JAMES DATE - 12/3/2010 | REVISED - REVISED - REVISED - REVISED - | Illinois Department of Transportation | ILLINOIS ROUTE 53 LANDSCAPING DETAILS | | | F.A.U. RTE. 2578 | SECTION 532B | COUNTY DUPAGE | TOTAL SHEETS 781 | SHEET NO. 341 |
| | | | | | SCALE: 1"=50' SHEET LCPE-6 OF 13 STA. 180+00 TO STA. 210+00 | FED. ROAD DIST. NO. ILLINOIS FED. AID PROJECT | | CONTRACT NO. 60477 | | | | |

G:\DOT\9356_A0_LL(53)\Drawings\CADD Sheets\19139797-ht-1\ndscp_341.dgn