

WATER MAIN VALVES

WM-V1
12" INSERTION VALVE IN 5' DIA VALVE VAULT

FIRE HYDRANTS

WM-FH1
INSTALL NEW AUXILIARY VALVE AND VALVE BOX (IF THERE IS NO EXISTING AUXILIARY VALVE), AND RELOCATE EXISTING FIRE HYDRANT WITH 13 L.F. OF 6" LEADER PIPE (RJT)

NOTES:

WATER MAIN TO WEST ALONG NORDIC ROAD MUST REMAIN IN SERVICE AT ALL TIMES. COORDINATE EFFORTS WITH VILLAGE OF ITASCA TO ESTABLISH A TEMPORARY WATER MAIN BYPASS AROUND THE WATER MAIN RELOCATION AT THE NORTHWEST CORNER OF ROUTE 53 AND NORDIC ROAD. VILLAGE CAN ESTABLISH THE BYPASS BY CLOSING EXISTING VALVES.

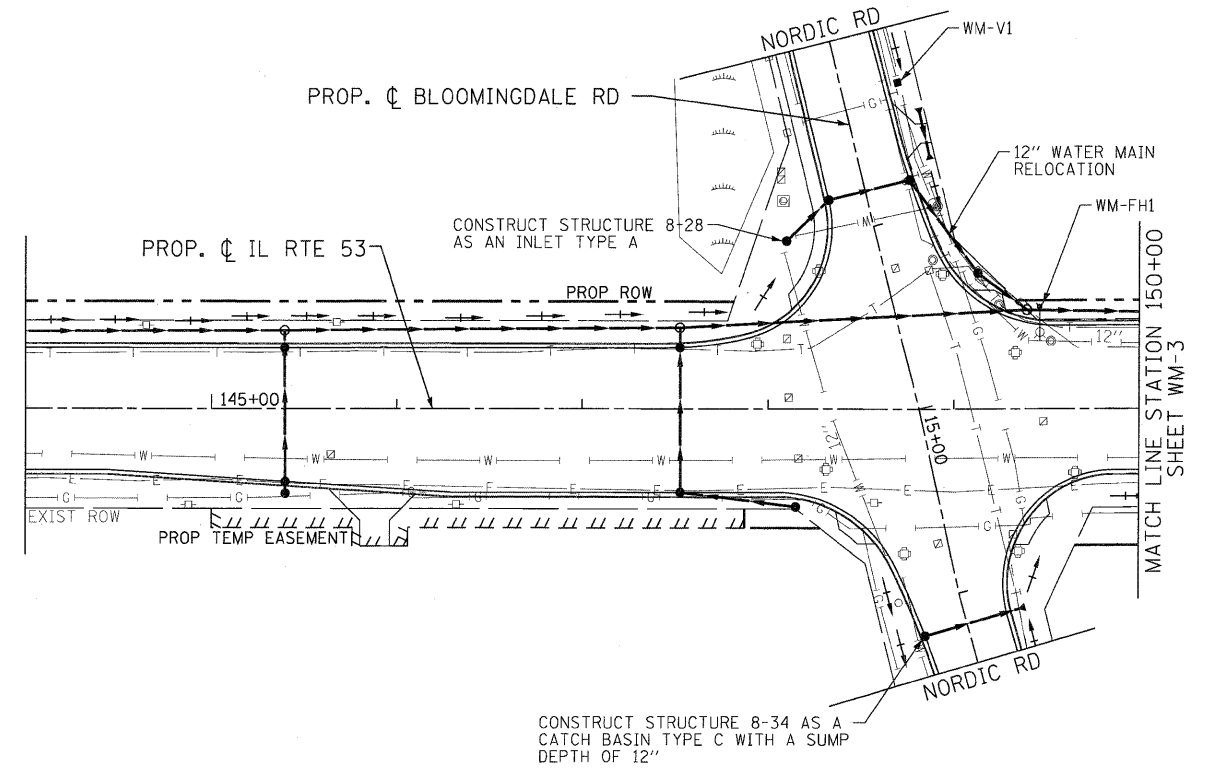

PLAN	REVISION	DATE
NOTE BOOK	ALIGNED	
NO.	CADD FILE NAME	

PROFILE	DATE
NOTE BOOK	
NO.	

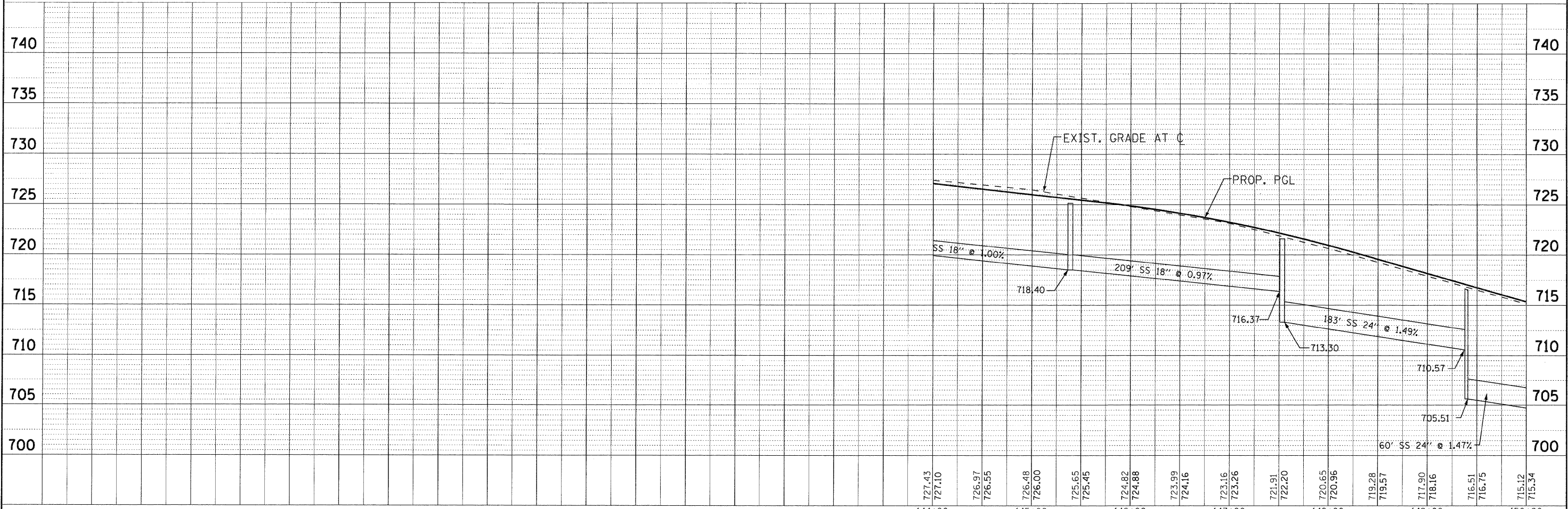

	USER NAME = (username) PLOT CONFIG = PDF22x34.plt PLOT SCALE = 1:50 PLOT DATE = 11/24/2010 8:28:32 AM	DESIGNED - SMV DRAWN - UKB CHECKED - SMV DATE - 7-30-2010	REVISED - 8-27-10 VILLAGE REVIEW REVISED - REVISED - REVISED -		ILLINOIS ROUTE 53 WATER AND SEWER REPLACEMENT PLAN AND PROFILE SCALE: 1"=50' SHEET NO. WM-2 OF 17 STA. 144+00 TO STA. 150+00	F.A.U. RTE. 2578 SECTION 532B COUNTY DUPAGE TOTAL SHEETS 781 SHEET NO. 350 CONTRACT NO. 60477 FED. ROAD DIST. NO. ILLINOIS FED. AID PROJECT
--	--	--	---	--	--	--

I:\Crystal Lake\ITAGV\100547-Rt 53 W and SVCADD-SURVEY\DRAWINGS\GDGNS\B&W-WM-PP-ah.t.263.dgn