

WATER MAIN VALVES

- WM-V20
12" GATE VALVE IN 5' DIA VALVE VAULT
- WM-V21
12" GATE VALVE IN 5' DIA VALVE VAULT
- WM-F22
12" GATE VALVE IN 5' DIA VALVE VAULT
- WM-V23
8" GATE VALVE WITH VALVE BOX
LOCATE VALVE ADJACENT TO THE TEE, BEHIND
THE PROPOSED BACK OF CURB.

WATER MAIN PIPE

- WM-P20
NOT USED
- WM-P21
90 L.F. OF 12" WATER MAIN (RJT)
- WM-P22
770 L.F. OF 12" WATER MAIN
- WM-P23
165 L.F. OF 12" WATER MAIN (RJT)
- WM-P24
95 L.F. OF 12" WATER MAIN
- WM-P25A
80 L.F. OF 8" WATER MAIN (RJT)
INSIDE 80 L.F. OF 24" CASING PIPE
AUGERED AND JACKED OR RAMMED
INTO PLACE.
DETERMINE ELEVATION REQUIRED TO
INSTALL 8" WATER MAIN ON SOUTH SIDE
OF CASING BELOW PROPOSED STORM
SEWERS AND TO ALLOW CONNECTION
TO EXISTING 6" WATER MAIN.
- WM-25B
65 L.F. OF 8" WATER MAIN (RJT)
INSTALL BELOW PROPOSED WATER MAIN
QUALITY PIPE STORM SEWERS

WATER MAIN FITTINGS (RJT)

- WM-F1
SEE SHEET NO WM-6
- WM-F40
12" - SLEEVE
- WM-F41
12" - 45° BEND
WITH CONCRETE THRUST BLOCK
- WM-F42
12" - 45° BEND
- WM-F43
12" x 6" TEE
- WM-F44
12" x 6" TEE
- WM-F45
12" x 8" TEE
- WM-F46
12" x 6" TEE
- WM-F47
12" - 45° BEND
- WM-F48
12" - 45° BEND
- WM-F49
12" - 45° BEND
- WM-F50
12" - 45° BEND

DATE	
BY	
REVIEWED	
DESIGNED	
PLANNED	
NOTED	
NO.	
FILE NAME	

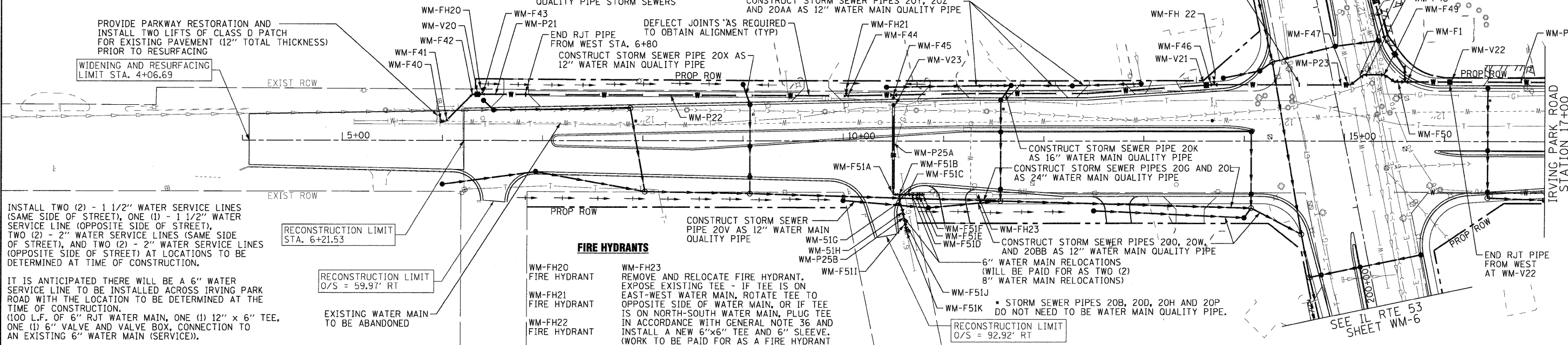

INSTALL TWO (2) - 1 1/2" WATER SERVICE LINES (SAME SIDE OF STREET), ONE (1) - 1 1/2" WATER SERVICE LINE (OPPOSITE SIDE OF STREET), TWO (2) - 2" WATER SERVICE LINES (SAME SIDE OF STREET), AND TWO (2) - 2" WATER SERVICE LINES (OPPOSITE SIDE OF STREET) AT LOCATIONS TO BE DETERMINED AT TIME OF CONSTRUCTION.

IT IS ANTICIPATED THERE WILL BE A 6" WATER SERVICE LINE TO BE INSTALLED ACROSS IRVING PARK ROAD WITH THE LOCATION TO BE DETERMINED AT THE TIME OF CONSTRUCTION. (100 L.F. OF 6" RJT WATER MAIN, ONE (1) 12" x 6" TEE, ONE (1) 6" VALVE AND VALVE BOX, CONNECTION TO AN EXISTING 6" WATER MAIN (SERVICE)).

REPLACE ONE (1) SANITARY SEWER SERVICE LINE AND RELOCATE/LOWER ONE (1) SANITARY SEWER SERVICE LINE WITH LOCATIONS DETERMINED AT THE TIME OF CONSTRUCTION.

FIRE HYDRANTS

- WM-FH20
FIRE HYDRANT
- WM-FH21
FIRE HYDRANT
- WM-FH22
FIRE HYDRANT
- WM-FH23
REMOVE AND RELOCATE FIRE HYDRANT. EXPOSE EXISTING TEE - IF TEE IS ON EAST-WEST WATER MAIN, ROTATE TEE TO OPPOSITE SIDE OF WATER MAIN, OR IF TEE IS ON NORTH-SOUTH WATER MAIN, PLUG TEE IN ACCORDANCE WITH GENERAL NOTE 36 AND INSTALL A NEW 6"x6" TEE AND 6" SLEEVE. (WORK TO BE PAID FOR AS A FIRE HYDRANT AND AUXILIARY VALVE REMOVAL AND AS WATER MAIN FITTINGS). IN EITHER CASE, REINSTALL EXISTING FIRE HYDRANT AS A 90° FIRE HYDRANT CONNECTION, INCLUDING A NEW AUXILIARY VALVE AND BOX.

WATER MAIN FITTINGS (RJT) - (CONT.)

- WM-F51A
8" - 90° BEND WITH CONCRETE THRUST BLOCK
- WM-F51B
8" x 8" TEE WITH CONCRETE THRUST BLOCK
- WM-F51C
8" - 45° BEND ROLLED UP
- WM-F51D
8" - 45° BEND ROLLED DOWN
- WM-F51E
8" x 6" REDUCER
- WM-F51F
6" SLEEVE
- WM-F51G
8" - 11 1/4° BEND WITH CONCRETE THRUST BLOCK
- WM-F51H
8" - 45° BEND ROLLED UP
- WM-F51I
8" - 45° BEND ROLLED DOWN
- WM-F51J
8" x 6" REDUCER
- WM-F51K
6" SLEEVE

DATE	
BY	
REVIEWED	
DESIGNED	
PLANNED	
NOTED	
NO.	
FILE NAME	

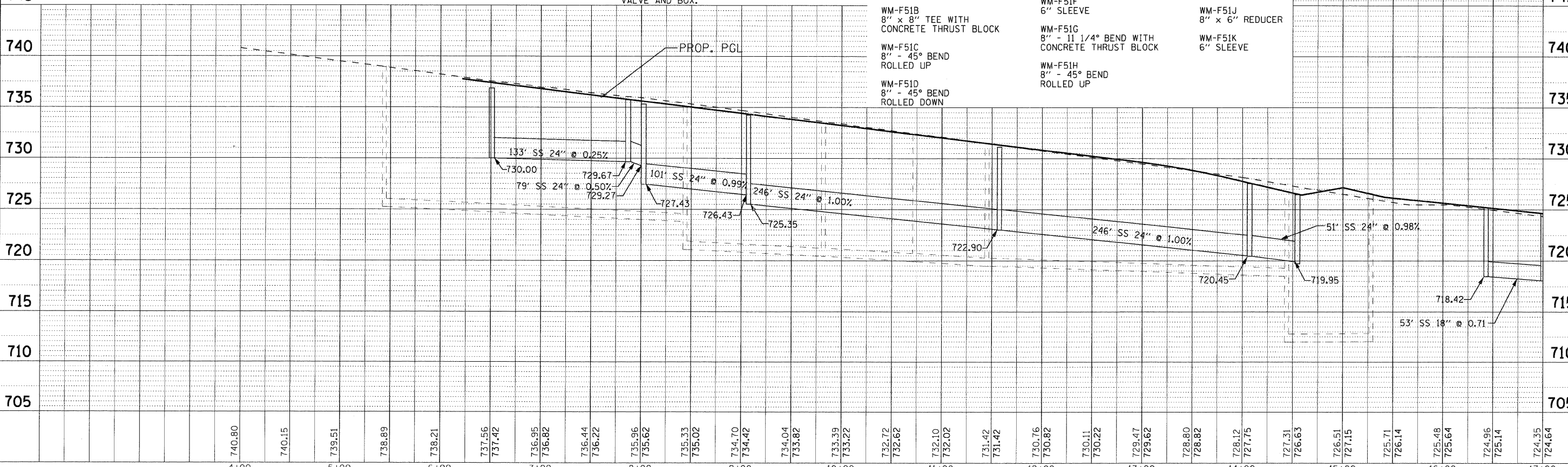

USER NAME = (username)	DESIGNED - SMV	REVISED - 8-27-10 VILLAGE REVIEW
PLOT CONFIG = POF22X34.plt	DRAWN - UKB	REVISED -
PLOT SCALE = 1:50	CHECKED - SMV	REVISED -
PLOT DATE = 11/24/2010 9:13:44 AM	DATE - 7-30-2010	REVISED -

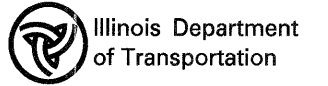

**IRVING PARK ROAD
WATER AND SEWER REPLACEMENT PLAN AND PROFILE**

SCALE: 1"=50' SHEET NO. WM-10 OF 17 STA. 4+44.45 TO STA. 17+00

F.A.U. RTE. NO. 2578	SECTION 532B	COUNTY	TOTAL SHEETS 781	SHEET NO. 358
FED. ROAD DIST. NO. ILLINOIS FED. AID PROJECT		CONTRACT NO. 60477		

I:\Crystal Lake\ITASV\102547-Rt 53 W and S\XCADD-SURVEY\DRAWINGS\DDNS\B&W-WM-PP-snt.275.dgn