

TEMPORARY TRAFFIC SIGNAL LEGEND

⊙ ⊗ TEMPORARY COMBINATION TRAFFIC SIGNAL WOOD POLE

NOTE: THE VIDEO DETECTION ZONES SHOWN ON THE PLANS ARE FOR CONSTRUCTION STAGE 1 - SUBSTAGE 1 AND SHALL BE REDEFINED FOR EACH CONSTRUCTION STAGE AS A PART OF "TEMPORARY TRAFFIC SIGNAL INSTALLATION" WORK.

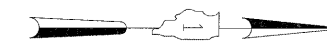

Ⓐ
LEFT ON GREEN ARROW ONLY
R10-5, 24" X 30" (8 REQUIRED)

R10-5 SIGNS SHALL BE MOUNTED, ONE EACH ON SPAN WIRE AND FAR LEFT POLE FOR ALL APPROACHES OF THE INTERSECTION

TEMPORARY RADIO INTERCONNECT TO RAMP G (EAST RAMP) (SEE TEMPORARY INTERCONNECT PLANS)

TEMPORARY RADIO INTERCONNECT TO MALL ENTRANCE (SEE TEMPORARY INTERCONNECT PLANS)

THE TRAFFIC SIGNAL CONTROL EQUIPMENT FOR THIS PROJECT SHALL BE "ECONOLITE" TO MATCH THE EXISTING ADJACENT SYSTEM.

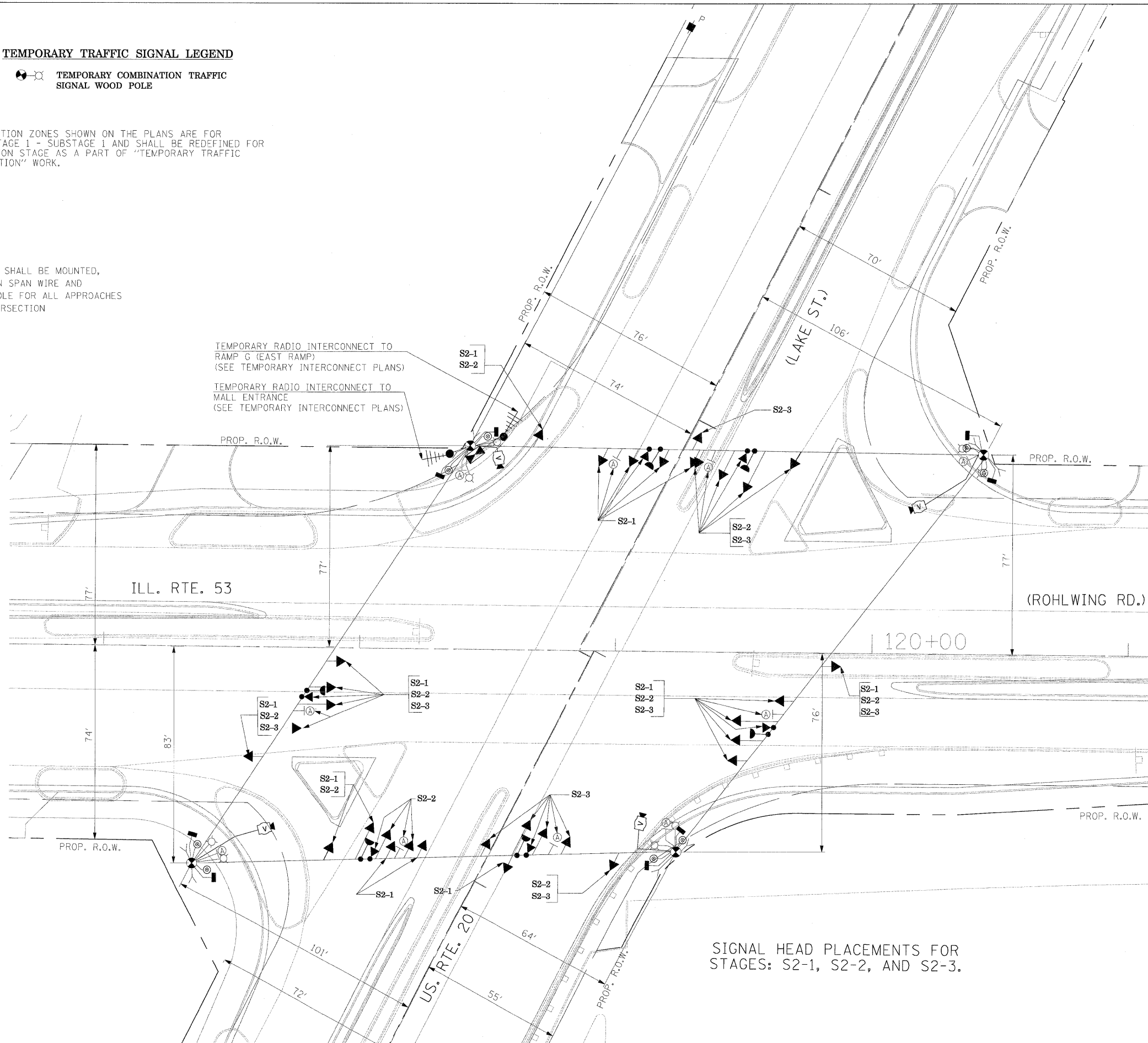

SIGNAL HEAD PLACEMENTS FOR STAGES: S2-1, S2-2, AND S2-3.

FILE NAME = #FILE#	USER NAME = #USER#	DESIGNED - PKG	REVISED -	STATE OF ILLINOIS DEPARTMENT OF TRANSPORTATION	TEMPORARY TRAFFIC SIGNAL INSTALLATION AND REMOVAL PLAN ILLINOIS ROUTE 53 (ROHLWING RD.) AT U.S. ROUTE 20 (LAKE ST.) STAGE 2 (SHEET 3 OF 6)			F.A.P. RTE. 2578	SECTION 532B	COUNTY DuPage	TOTAL SHEETS 781	SHEET NO. 457
	PLOT SCALE = #SCALE#	DRAWN - MAA, EA	REVISED -		SCALE: 1"=20'	SHEET NO.	OF SHEETS	STA.	TO STA.	CONTRACT NO. 60477		
	PLOT DATE = #DATE#	CHECKED - PKG, EA	REVISED -							FED. ROAD DIST. NO. - [ILLINOIS] FED. AID PROJECT		
		DATE - 5/10/2010	REVISED -									