

SIGNAL HEAD PLACEMENTS FOR
STAGE: S2

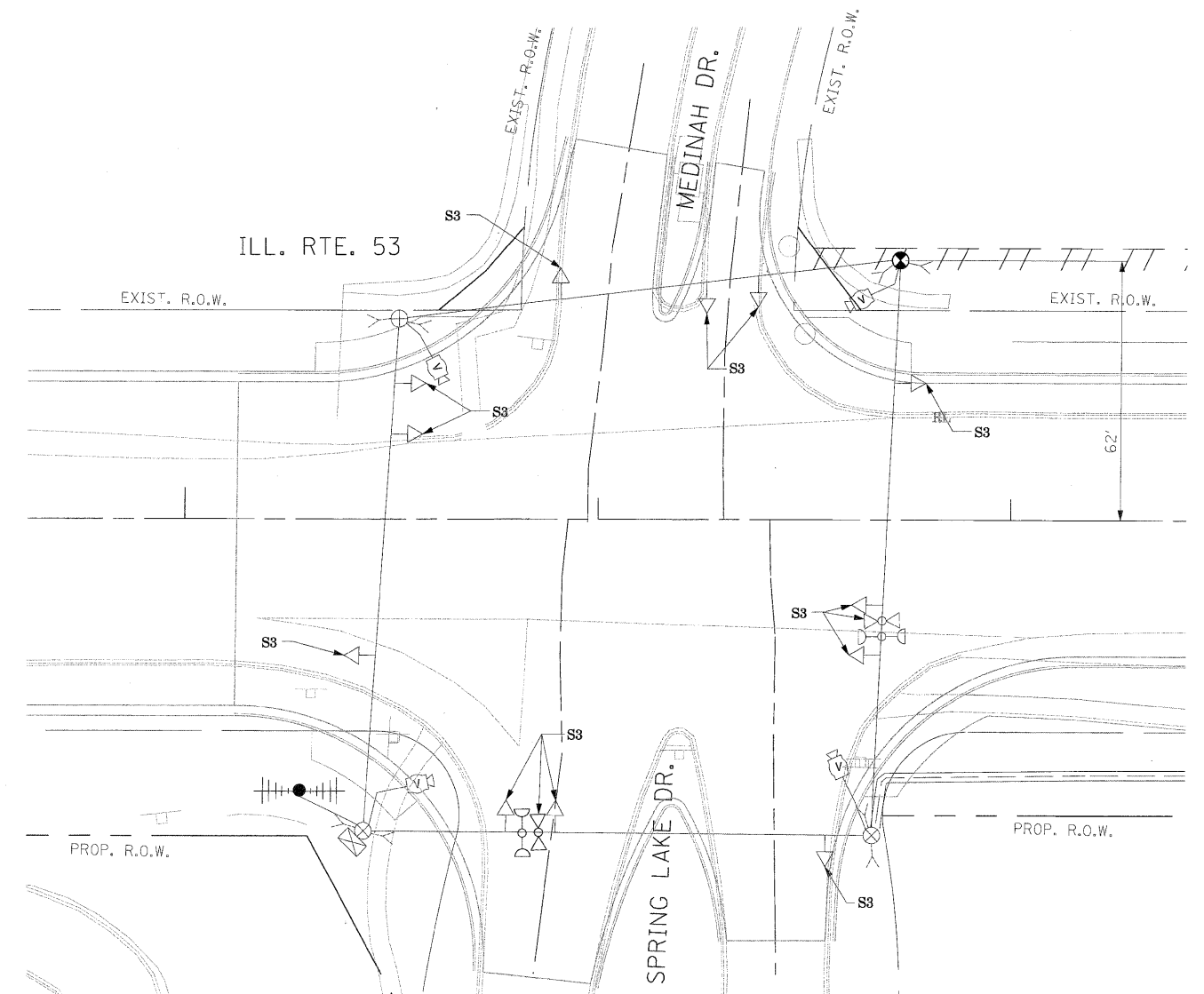

SIGNAL HEAD PLACEMENTS FOR
STAGE: S3

NOTE 1: THE VIDEO DETECTION ZONES SHOWN ON THE PLANS ARE FOR CONSTRUCTION STAGE 1 - YEAR 2 AND SHALL BE REDEFINED FOR EACH CONSTRUCTION STAGE AS A PART OF "TEMPORARY TRAFFIC SIGNAL INSTALLATION" WORK.

NOTE 2: THE SIGNAL HEAD PLACEMENT FOR MEDINAH/SPRING LAKE DRIVE FOR CONSTRUCTION STAGES S2 AND S3 SHALL BE DETERMINED IN FIELD BY THE CONTRACTOR DEPENDING ON THE CONSTRUCTION STAGING USED BY THE CONTRACTOR FOR MEDINAH/SPRING LAKE DRIVE.

THE TRAFFIC SIGNAL CONTROL EQUIPMENT FOR THIS PROJECT SHALL BE "ECONOLITE" TO MATCH THE EXISTING ADJACENT SYSTEM.

FILE NAME = #FILE#	USER NAME = #USER#	DESIGNED - PKG	REVISED -	STATE OF ILLINOIS DEPARTMENT OF TRANSPORTATION	EXISTING TEMPORARY TRAFFIC SIGNAL, MODIFICATION PLAN, AND REMOVAL PLAN ILLINOIS ROUTE 53 (ROHLWING RD.) AT MEDINAH DR./SPRING LAKE DR. STAGE 2 AND STAGE 3 (SHEET 2 OF 3)			F.A.P. RTE. 2578	SECTION 532B	COUNTY DuPage	TOTAL SHEETS 781	SHEET NO. 473
	PLOT SCALE = #SCALE#	DRAWN - MAA, EA	REVISED -		SCALE: 1"=20'	SHEET NO.	OF	SHEETS	STA.	TO STA.	FED. ROAD DIST. NO. - ILLINOIS FED. AID PROJECT	
	PLOT DATE = #DATE#	CHECKED - PKG, EA	REVISED -								CONTRACT NO. 60477	
		DATE - 5/10/2010	REVISED -									